

F.A.P. RTE.	SECTION	COUNTY	TOTAL SHEETS	SHEET NO.
335	119R-2	LAKE	439	46
STA. 432+83.12		TO STA. 470+56.84		
FED. ROAD DIST. NO.		ILLINOIS FED. AID PROJECT		

60B01

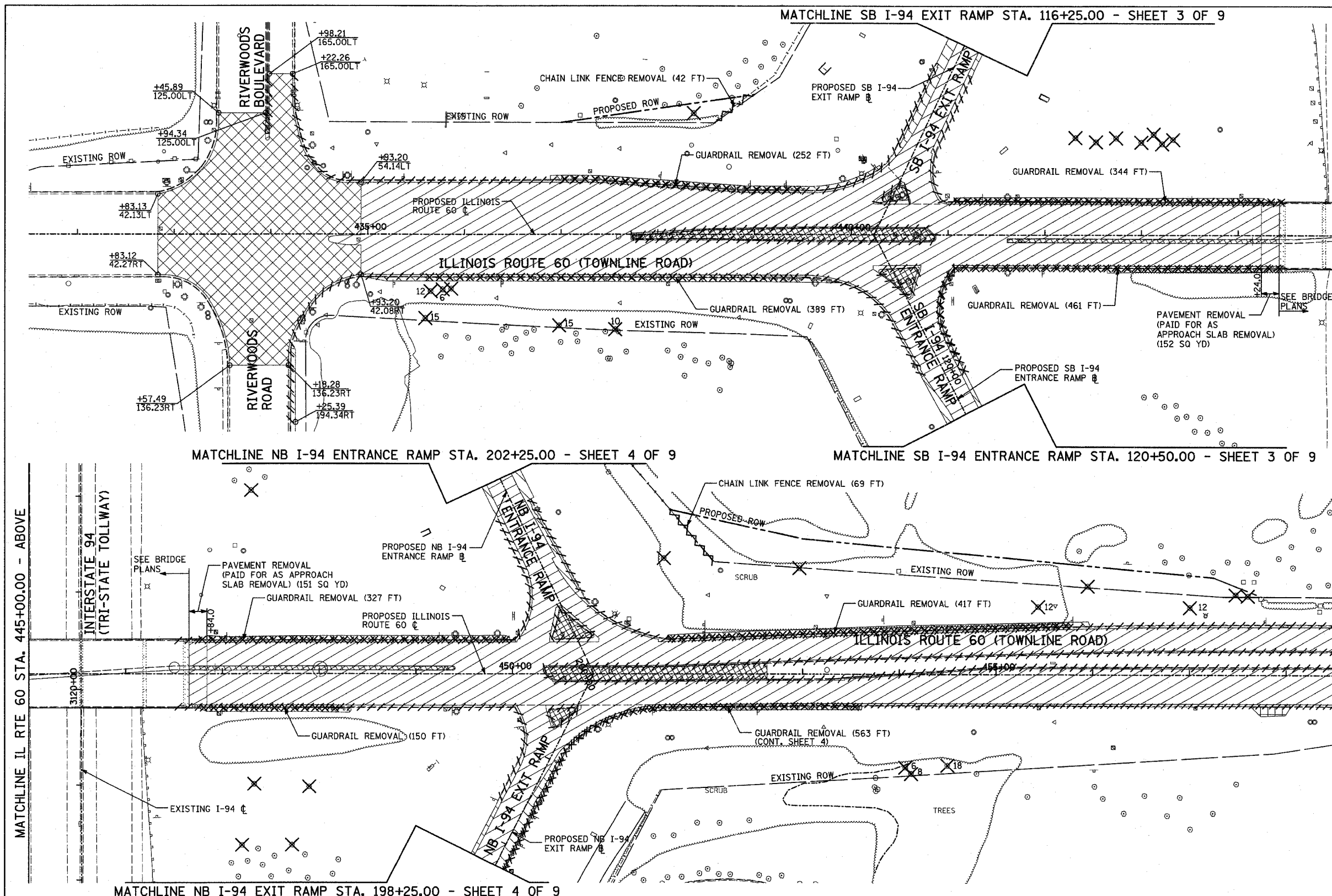

**REMOVAL LEGEND:**

- PAVEMENT REMOVAL
- PAVED SHOULDER REMOVAL
- BITUMINOUS SURFACE REMOVAL, 2 3/4"
- MEDIAN REMOVAL
- DRIVEWAY PAVEMENT REMOVAL
- COMB CONC CURB & GUTTER REMOVAL
- GUARDRAIL REMOVAL
- CHAIN LINK FENCE REMOVAL
- LIGHT POLE FOUNDATION REMOVAL (SEE ROADWAY LIGHTING & SURVEILLANCE PLANS)
- TREE REMOVAL (UNITS) (NO UNIT SHOWN = <6)

**PLAN NOTES:**

- ALL STATION/OFFSET/RADIUS CALLOUTS MEASURED TO EDGE OF PAVEMENT UNLESS OTHERWISE NOTED.

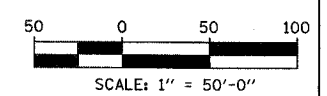
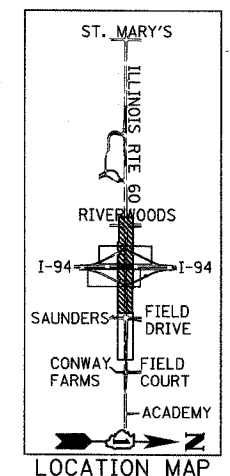

MATCHLINE IL RTE 60 STA. 445+00.00 - ABOVE

MATCHLINE IL RTE 60 STA. 445+00.00 - BELOW

MATCHLINE IL RTE 60 STA. 458+50.00 - SHEET 2 OF 9

MATCHLINE NB I-94 ENTRANCE RAMP STA. 202+25.00 - SHEET 4 OF 9

MATCHLINE SB I-94 ENTRANCE RAMP STA. 120+50.00 - SHEET 3 OF 9

MATCHLINE NB I-94 EXIT RAMP STA. 198+25.00 - SHEET 4 OF 9

REVISIONS	
NAME	DATE

ILLINOIS DEPARTMENT OF TRANSPORTATION  
 ILLINOIS RTE 60 OVER I-94  
 EXISTING CONDITIONS AND REMOVAL PLAN  
 IL RTE 60 STA. 432+83.12 TO 458+50.00  
 SHEET 1 OF 9

SCALE: 1"=50'-0"  
 DATE: MAY 8, 2007

DRAWN BY: CBS  
 CHECKED BY: MPG

**TYLIN** INTERNATIONAL

5/7/2007 8:45:01 AM