

**II-II**  
PRE-STAGE A: NB I-94 EXIT RAMP; STA. 193+35 TO 198+81

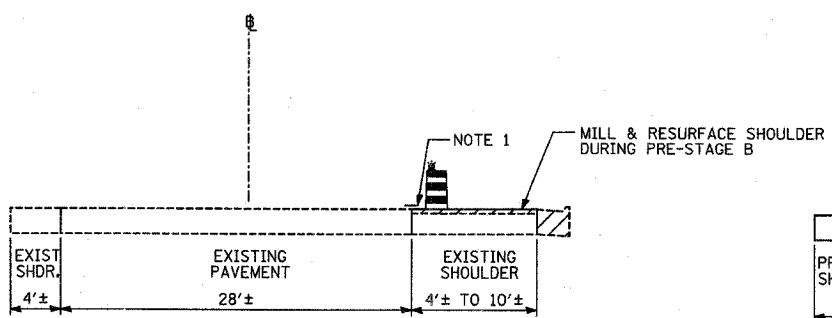

**QQ-QQ**  
PRE-STAGE B: NB I-94 ENTRANCE RAMP; STA. 201+30 TO 202+25

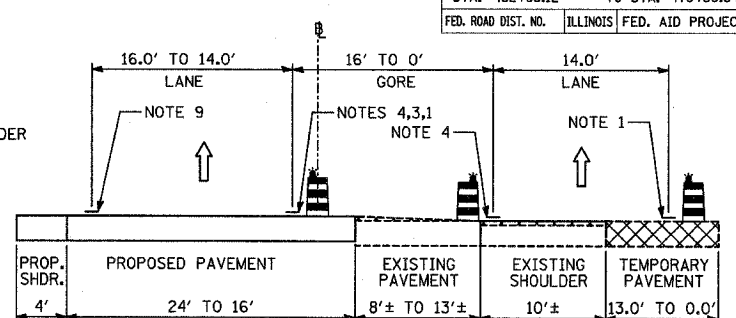

**OO-OO**  
STAGE 1A: NB I-94 ENTRANCE RAMP; STA. 201+00 TO 205+00

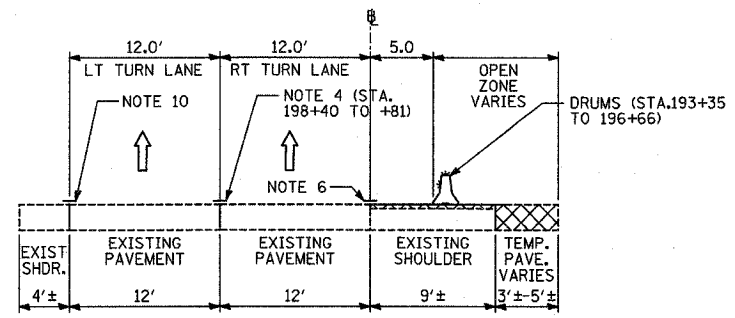

**JJ-JJ**  
PRE-STAGE B, STAGES 1, 1A, 2: NB I-94 EXIT RAMP; STA. 193+35 TO 198+81

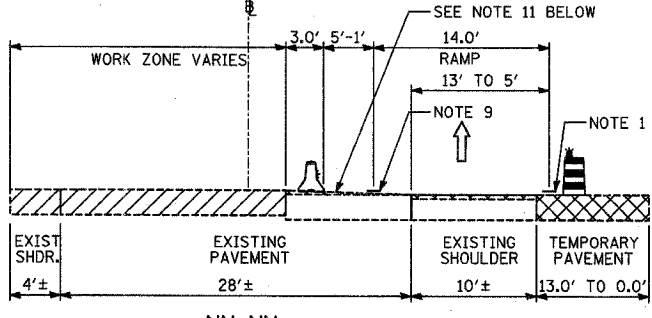

**NN-NN**  
STAGE 1: NB I-94 ENTRANCE RAMP; STA. 201+00 TO 204+00

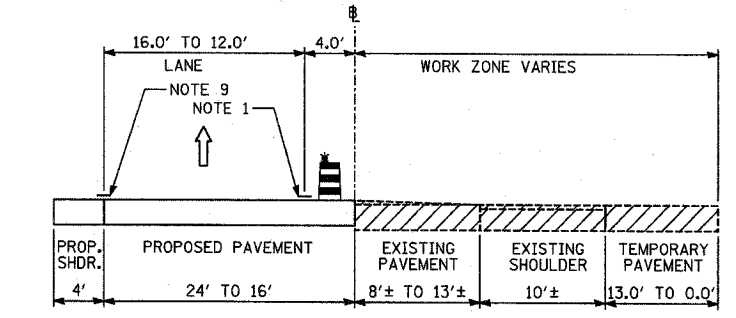

**PP-PP**  
STAGE 2: NB I-94 ENTRANCE RAMP; STA. 201+00 TO 205+00

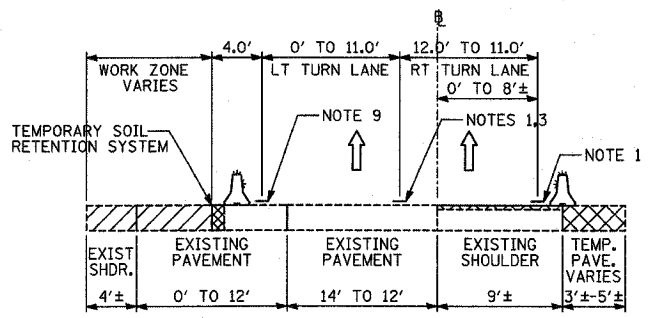

**KK-KK**  
STAGE 3: NB I-94 EXIT RAMP; STA. 190+00 TO 199+00

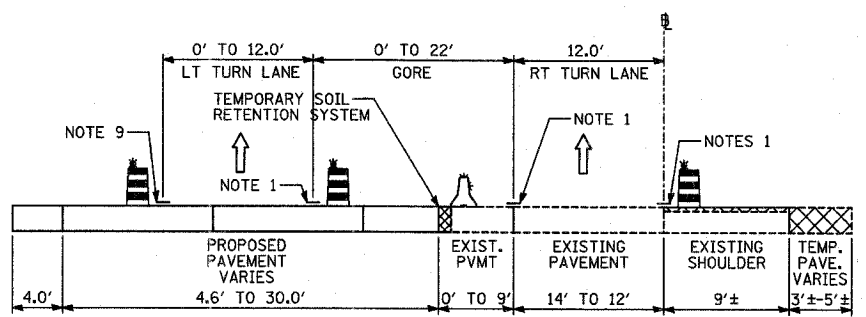

**LL-LL**  
STAGE 3A: NB I-94 EXIT RAMP; STA. 190+00 TO 198+53

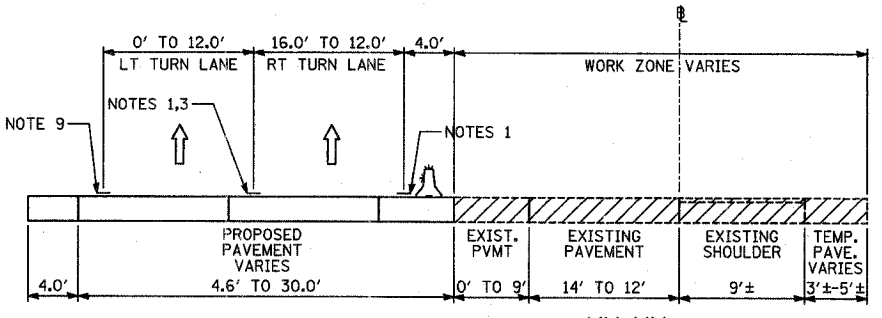

**MM-MM**  
STAGE 4: NB I-94 EXIT RAMP; STA. 190+00 TO 198+53

- NOTES:**
- TEMPORARY PAVEMENT MARKING-LINE 4" (SOLID WHITE)
  - TEMPORARY PAVEMENT MARKING-LINE 4" (10'-30' SKIP-DASH WHITE)
  - TEMPORARY PAVEMENT MARKING-LINE 4" (2'-6' SKIP-DASH WHITE)
  - TEMPORARY PAVEMENT MARKING-LINE 8" (SOLID WHITE)
  - TEMPORARY PAVEMENT MARKING-LINE 4" (SOLID DOUBLE YELLOW)
  - EXISTING PAVEMENT MARKING, (SOLID WHITE)
  - EXISTING PAVEMENT MARKING, (SKIP-DASH WHITE)
  - EXISTING PAVEMENT MARKING, (SOLID DOUBLE YELLOW)
  - TEMPORARY PAVEMENT MARKING-LINE 4" (SOLID YELLOW)
  - EXISTING PAVEMENT MARKING, (SOLID YELLOW)
  - HMA SURFACE COURSE, MIX D, N70 TO BE PLACED AS NEEDED FOLLOWING STAGE 1 FROM STA 202+50 TO 204+00 TO MATCH EXISTING AND PROPOSED PAVEMENT EDGES. SLOPE SHALL NOT BE GREATER THAN 3.0%.

- LEGEND:**
- TEMPORARY CONCRETE BARRIER (WITH REFLECTORS ON TOP AND SIDE FACING TRAFFIC)
  - TRAFFIC MOVEMENT
  - DRUM WITH MONO-DIRECTIONAL STEADY BURNING LIGHT
  - EXISTING BRIDGE PARAPET (WITH REFLECTORS ON TOP AND SIDE FACING TRAFFIC)
  - PAVEMENT REMOVAL AREA
  - TEMPORARY PAVEMENT

| REVISIONS |      |
|-----------|------|
| NAME      | DATE |
|           |      |
|           |      |
|           |      |
|           |      |
|           |      |
|           |      |
|           |      |

ILLINOIS DEPARTMENT OF TRANSPORTATION  
ILLINOIS RTE 60 OVER I-94  
MAINTENANCE OF TRAFFIC  
TYPICAL SECTIONS AND DETAILS  
SHEET 6 OF 7

SCALE: NO SCALE  
DATE: MAY 8, 2007

DRAWN BY: RTM  
CHECKED BY: MPG

05/02/2007 10:24:30 AM