

F.A.P. RTE.	SECTION	COUNTY	TOTAL SHEETS	SHEET NO.
335	119R-2	LAKE	439	90
STA. 432+83.12		TO STA. 470+56.84		
FED. ROAD DIST. NO.		ILLINOIS FED. AID PROJECT		
		60B01		

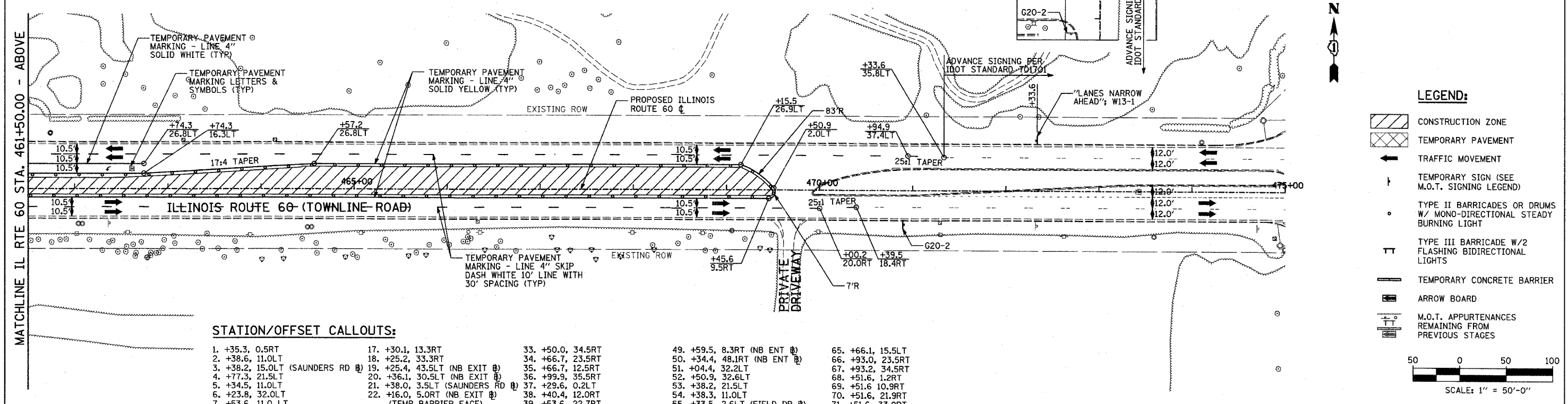

- LEGEND:**
- CONSTRUCTION ZONE
 - TEMPORARY PAVEMENT
 - TRAFFIC MOVEMENT
 - TEMPORARY SIGN (SEE M.O.T. SIGNING LEGEND)
 - TYPE II BARRICADES OR DRUMS W/ MONO-DIRECTIONAL STEADY BURNING LIGHT
 - TYPE III BARRICADE W/2 FLASHING BIDIRECTIONAL LIGHTS
 - TEMPORARY CONCRETE BARRIER
 - ARROW BOARD
 - M.O.T. APPURTENANCES REMAINING FROM PREVIOUS STAGES

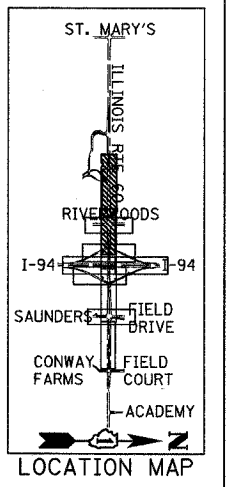
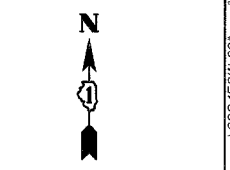
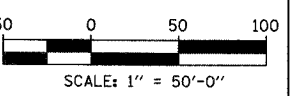

STATION/OFFSET CALLOUTS:

1. +35.3, 0.5RT	17. +30.1, 13.3RT	33. +50.0, 34.5RT	49. +59.5, 8.3RT (NB ENT @)	65. +66.1, 15.5LT
2. +38.6, 11.0LT	18. +25.2, 33.3RT	34. +66.7, 23.5RT	50. +34.4, 48.1RT (NB ENT @)	66. +93.0, 23.5RT
3. +38.2, 15.0LT (SAUNDERS RD @)	19. +25.4, 43.5LT (NB EXIT @)	35. +66.7, 12.5RT	51. +04.4, 32.2LT	67. +93.2, 34.5RT
4. +77.3, 21.5LT	20. +36.1, 30.5LT (NB EXIT @)	36. +99.9, 35.5RT	52. +50.9, 32.6LT	68. +51.6, 1.2RT
5. +34.5, 11.0LT	21. +38.0, 3.5LT (SAUNDERS RD @)	37. +29.6, 0.2LT	53. +38.2, 21.5LT	69. +51.6, 10.9RT
6. +23.8, 32.0LT	22. +16.0, 5.0RT (NB EXIT @)	38. +40.4, 12.0RT	54. +38.3, 11.0LT	70. +51.6, 21.9RT
7. +53.6, 11.0 LT	23. +40.0, 12.3 LT (NB EXIT @)	39. +53.6, 22.7RT	55. +33.5, 2.6LT (FIELD DR @)	71. +51.6, 33.0RT
8. +53.6, 21.5LT	24. +50.5, 0.5RT (NB EXIT @)	40. +06.2, 12.7RT (NB ENT @)	56. +02.5, 18.1RT (FIELD DR @)	72. +42.0, 27.0LT (SAUNDERS RD @)
9. +53.6, 32.1 LT	25. +75.5, 12.0LT (NB EXIT @)	41. +77.7, 26.9RT (NB ENT @)	57. +02.4, 8.1RT (FIELD DR @)	73. +61.2, 1.4LT
10. +75.6, 2.3RT (NB ENT @)	26. +81.5, 11.9LT (NB EXIT @)	42. +27.5, 1.1LT (NB ENT @)	58. +59.2, 18.7RT (FIELD DR @)	74. +33.8, 3.0LT
11. +35.3, 11.0RT	27. +01.3, 4.6RT (NB EXIT @)	43. +25.8, 12.4RT (NB ENT @)	59. +87.1, 2.0LT (FIELD DR @)	75. +06.1, 10.0RT (FIELD DR @)
12. +35.3, 21.5RT	28. +25.5, 4.5LT (NB EXIT @)	44. +92.9, 0.6LT (NB ENT @)	60. +59.1, 8.7RT (FIELD DR @)	76. +06.1, 22.2RT (FIELD DR @)
13. +35.3, 32.6RT	29. +50.2, 22.0RT (NB EXIT @)	45. +93.3, 13.4RT (NB ENT @)	61. +67.9, 14.3LT (FIELD DR @)	77. +08.6, 56.2LT
14. +38.6, 0.5RT	30. +58.1, 9.4RT (NB EXIT @)	46. +91.2, 35.6RT (NB ENT @)	62. +75.2, 22.4LT (FIELD DR @)	
15. +77.3, 21.5RT	31. +86.0, 34.2RT	47. +79.8, 15.7RT (NB ENT @)	63. +58.9, 4.4LT (FIELD DR @)	
16. +29.9, 23.8RT	32. +41.5, 39.4RT	48. +64.9, 12.2RT (NB ENT @)	64. +36.9, 16.3LT	

TYLIN INTERNATIONAL

REVISIONS	
NAME	DATE

ILLINOIS DEPARTMENT OF TRANSPORTATION
ILLINOIS RTE 60 OVER I-94

MAINTENANCE OF TRAFFIC PLAN
IL RTE 60 STA. 446+50.00 TO 475+00.00
PRE-STAGE B - SHEET 2 OF 4

SCALE: 1"=50'-0"
DATE: MAY 8, 2007

DRAWN BY: MFG, CBS
CHECKED BY: JDF

05/02/2007 10:25:28 AM I:\600245011\601\road\60m0b_2.rvt