

F.A.P. RTE.	SECTION	COUNTY	TOTAL SHEETS	SHEET NO.
335	119R-2	LAKE	439	181
STA. 432+83.12		TO STA. 470+56.84		
FED. ROAD DIST. NO.		ILLINOIS FED. AID PROJECT		

60B01

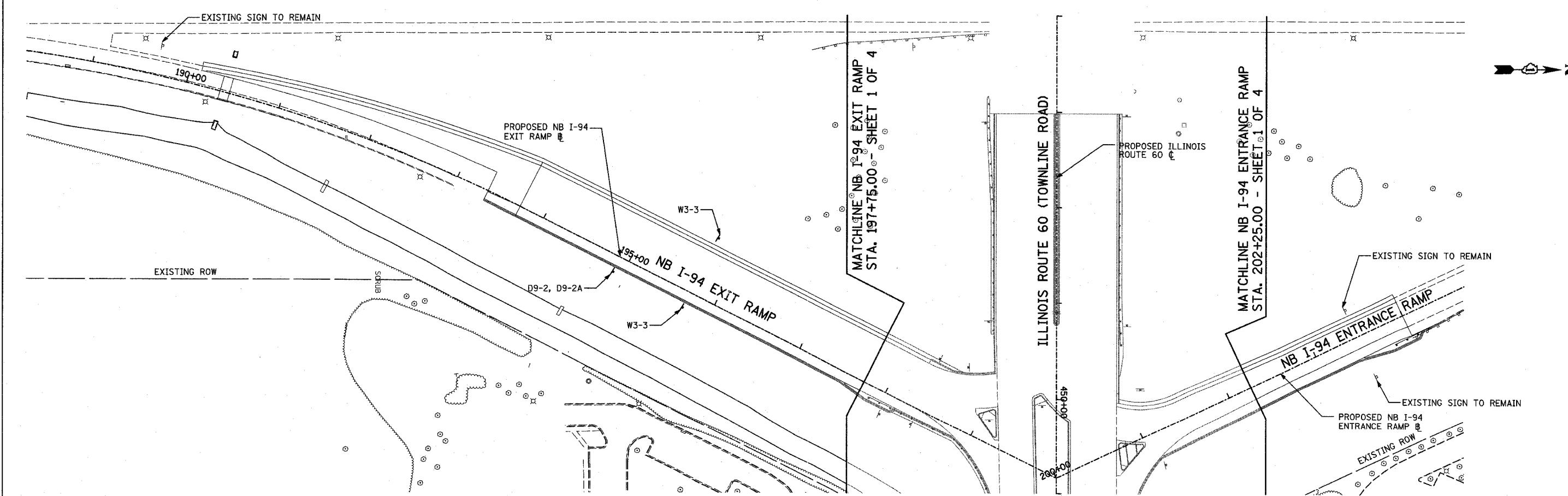

SIGNING LEGEND:

- ◀ EXISTING GROUND MOUNTED SIGN
- ▶ PROPOSED GROUND MOUNTED SIGN

R1-1— SEE PROPOSED SIGNING LEGEND AND SCHEDULE



PROPOSED LARGE SIGN PANEL (SEE SIGN PANEL DETAILS AND SCHEDULE)

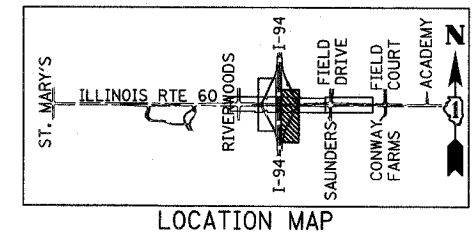
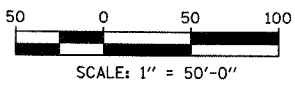

TYLIN INTERNATIONAL

REVISIONS	
NAME	DATE

ILLINOIS DEPARTMENT OF TRANSPORTATION
 ILLINOIS RTE 60 OVER I-94
 PROPOSED SIGNING PLAN
 NORTHBOUND INTERSTATE 94 RAMPS
 SHEET 4 OF 4

SCALE: 1"=50'-0"
 DATE: MAY 8, 2007
 DRAWN BY: AMB
 CHECKED BY: MPG

P:\602458\11602V\road\60b01.dgn 5/8/2007 5:24:57 PM