

F.A.P. RTE.	SECTION	COUNTY	TOTAL SHEETS	SHEET NO.
335	119R-2	LAKE	439	387
STA. 432+83.12		TO STA. 470+56.84		
FED. ROAD DIST. NO.	ILLINOIS	FED. AID PROJECT		
			120	130
			140	150
				60B01

NOTE: PRE-STAGE EARTHWORK ADDITIONS/SUBTRACTIONS ARE NOT INCLUDED IN THE EARTHWORK QUANTITIES FOR EACH CROSS SECTION (SEE EARTHWORK SCHEDULE FOR BREAKDOWN OF QUANTITIES BY STAGE).

EARTHWORK QUANTITIES (SF)	
EXCAVATION	= 77.3
UNSUITABLE	= 207.0
EMBANKMENT	= 1024.6
EXC.(SPECIAL)	= 104.0

EARTHWORK QUANTITIES (SF)	
EXCAVATION	= 71.6
UNSUITABLE	= 225.7
EMBANKMENT	= 1212.0
EXC.(SPECIAL)	= 91.3

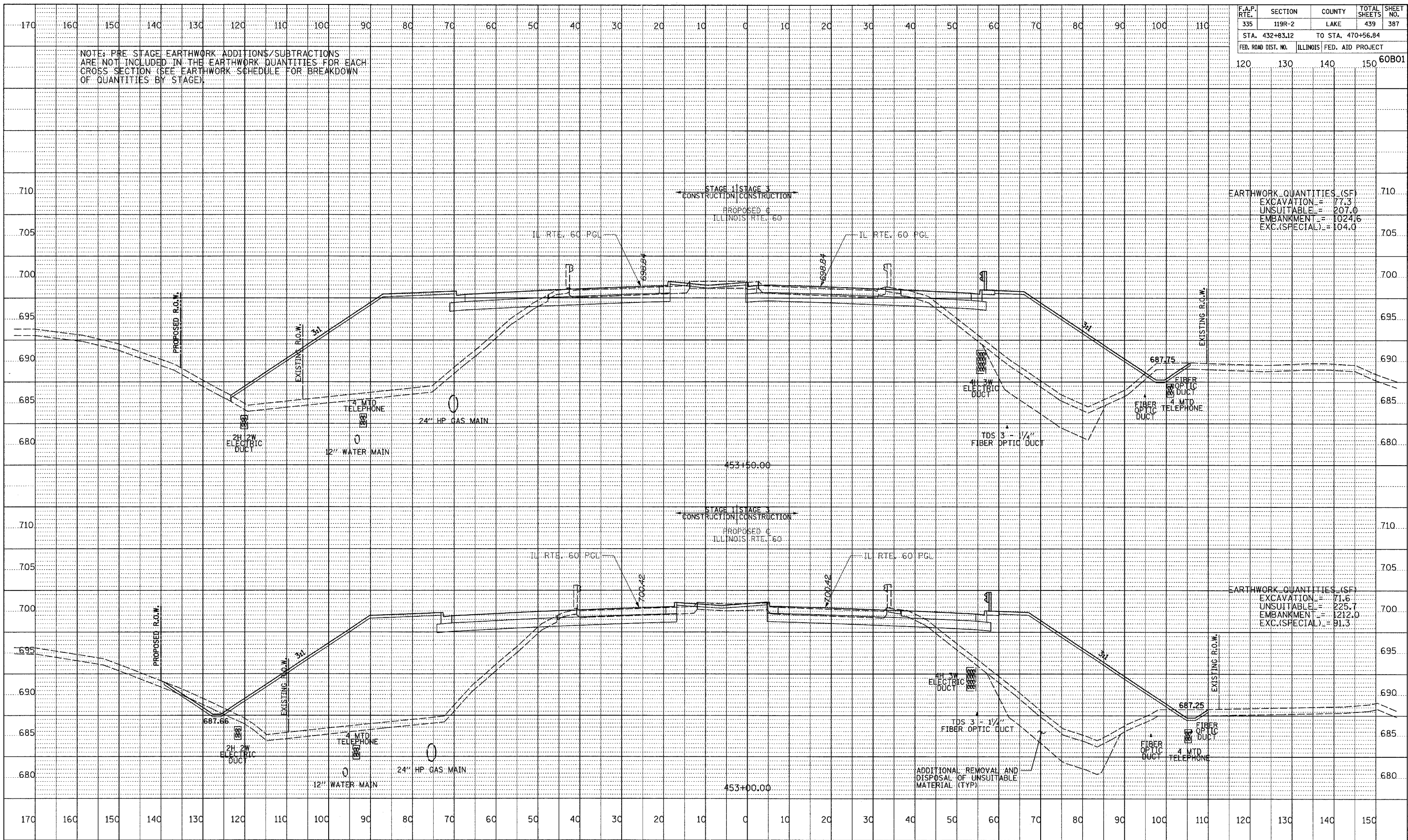

TYLIN INTERNATIONAL

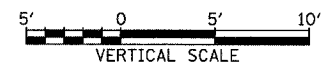
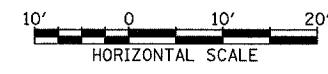

ILLINOIS RTE. 60 (TOWNLIN RD)
STA. 453+00 TO STA. 453+50

6/13/2007 1:36:30 PM