

F.A.P. RTE.	SECTION	COUNTY	TOTAL SHEETS	SHEET NO.
335	119R-2	LAKE	439	390
STA. 432+83.12		TO STA. 470+56.84		
FED. ROAD DIST. NO.		ILLINOIS	FED. AID PROJECT	
			120	130
			140	150
				60B01

NOTE: PRE-STAGE EARTHWORK ADDITIONS/SUBTRACTIONS ARE NOT INCLUDED IN THE EARTHWORK QUANTITIES FOR EACH CROSS SECTION (SEE EARTHWORK SCHEDULE FOR BREAKDOWN OF QUANTITIES BY STAGE)

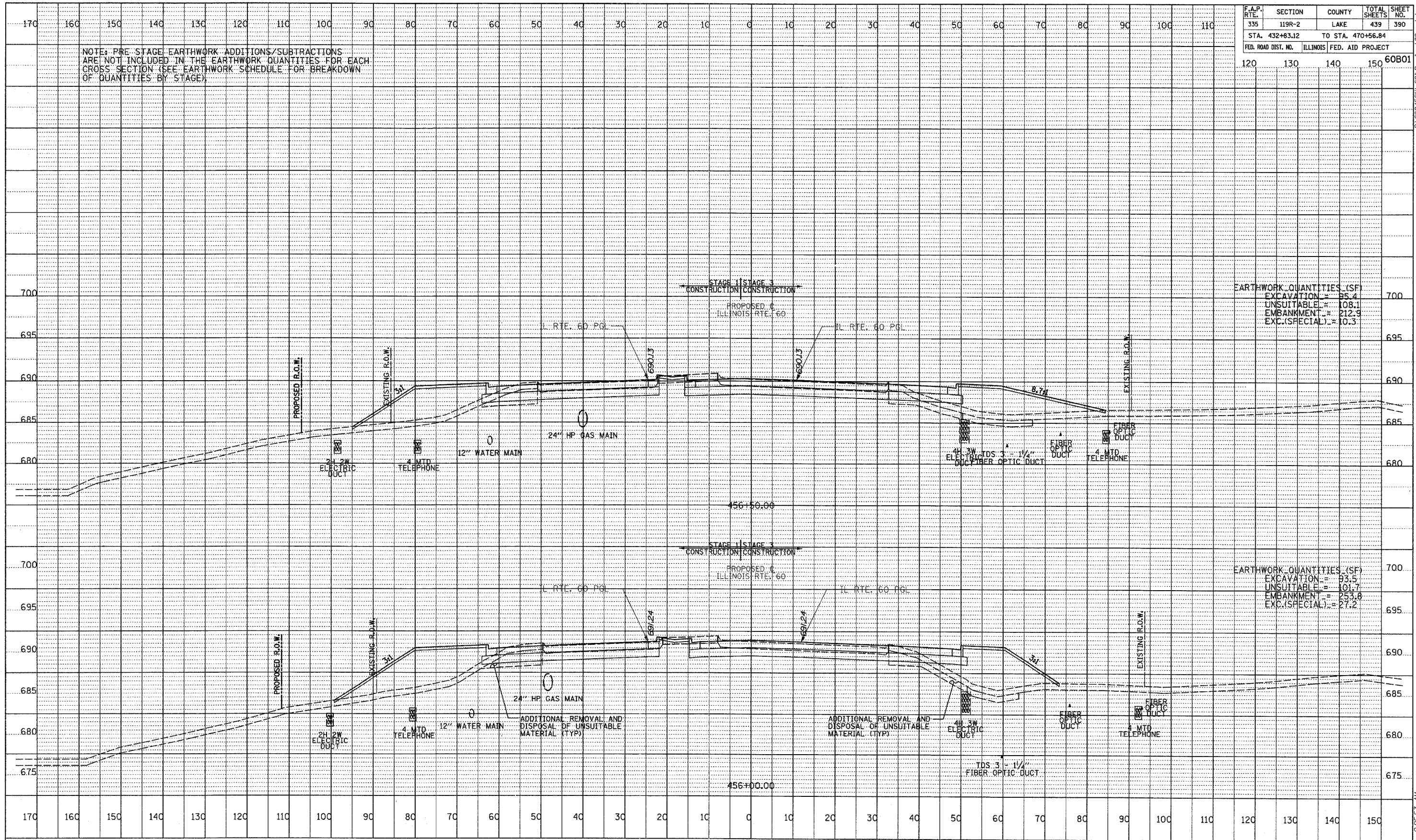

EARTHWORK QUANTITIES (SF)

EXCAVATION	= 95.4
UNSUITABLE	= 108.1
EMBANKMENT	= 212.9
EXC.(SPECIAL)	= 10.3

EARTHWORK QUANTITIES (SF)

EXCAVATION	= 93.5
UNSUITABLE	= 101.7
EMBANKMENT	= 253.8
EXC.(SPECIAL)	= 27.2

DATE	
BY	
PROFILE SURVEYED	
DESIGNED	
NOTE BOOK NO.	
STRUCTURE NOTATION	
NO.	

TYLIN INTERNATIONAL

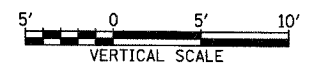
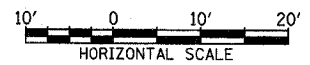

ILLINOIS RTE. 60 (TOWNLIN RD)
STA. 456+00 TO STA. 456+50

F:\602456\11-60\Road\gpk60\sshtg1 5/7/2007 9:25:53 AM