

F.A.P. RTE.	SECTION	COUNTY	TOTAL SHEETS	SHEET NO.
335	119R-2	LAKE	439	404
STA. 432+83.12		TO STA. 470+56.84		
FED. ROAD DIST. NO.	ILLINOIS	FED. AID PROJECT		
120	130	140	150	60B01

DATE	
BY	
PROFILE SURVEYED	
NOTE BOOK NO.	
DATE	
BY	
DESIGNED	
CHECKED	
DATE	
BY	

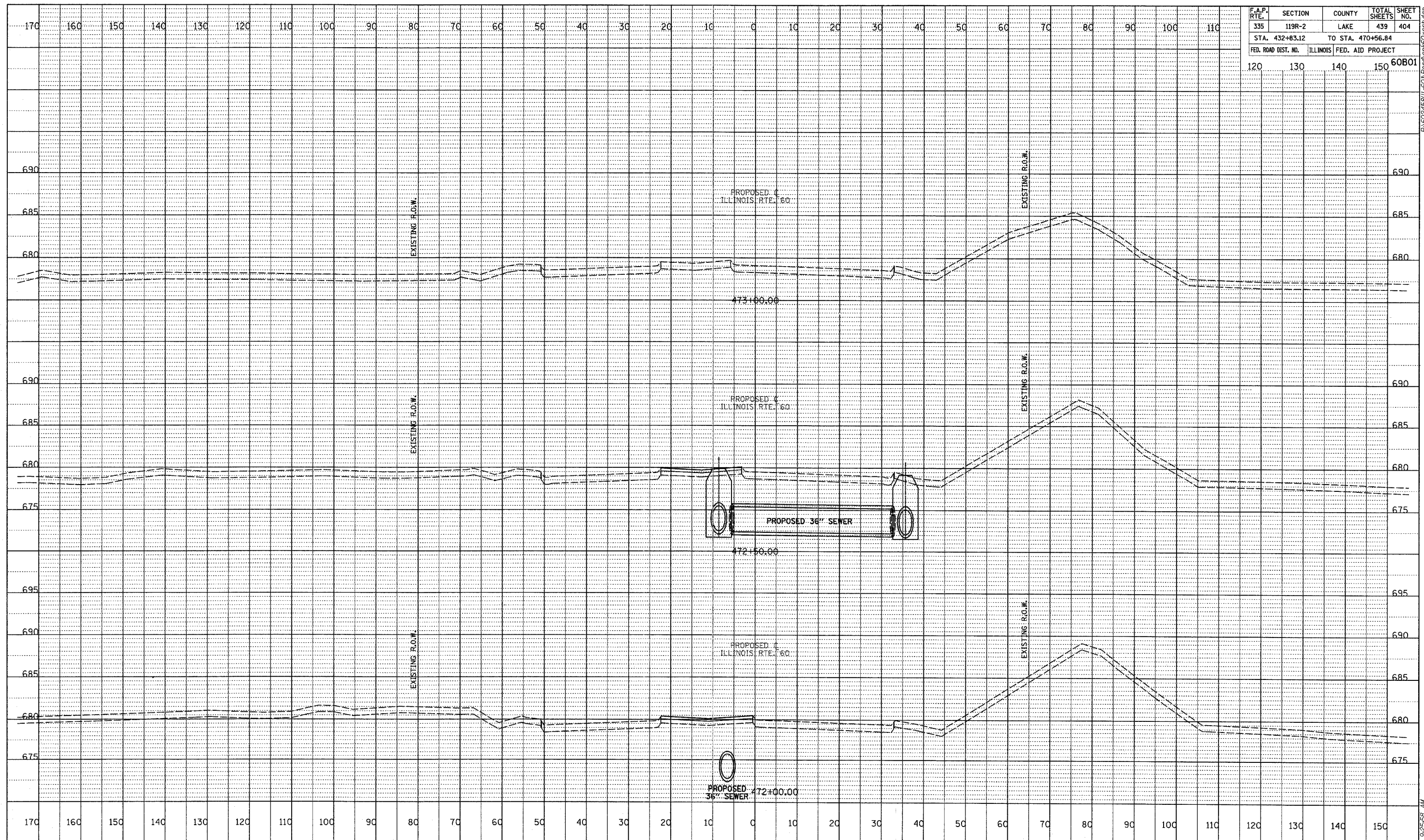

TYLIN INTERNATIONAL

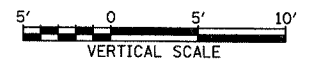

ILLINOIS RTE. 60 (TOWNLIN RD)  
STA. 472+00 TO STA. 473+00

9/7/2007 9:25:58 AM P:\02458\11-60\Road\grd60.ssd\grd