

PROFILE SURVEYED BY DATE
 GRADES CHECKED NO. BY DATE
 NOTE BOOK NO. STRUCTURE ADJUSTING ORDN.

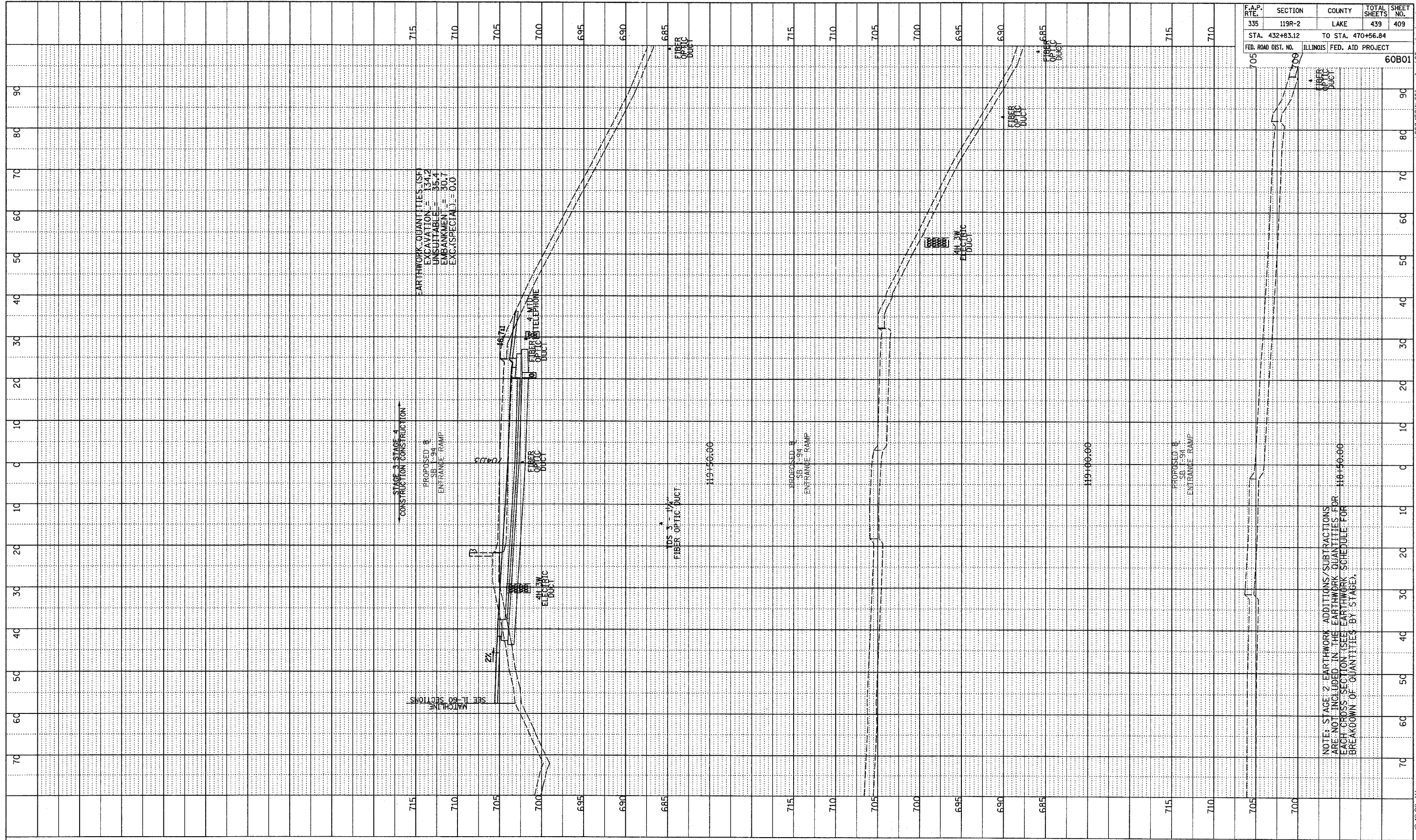

F.A.P. NO.	SECTION	COUNTY	TOTAL SHEETS	SHEET NO.
335	119R-2	LAKE	439	409
STA. 432+83.12		TO STA. 470+56.84		
FED. ROAD DIST. NO.	ILLINOIS	FED. AID PROJECT		60B01

TYLIN INTERNATIONAL

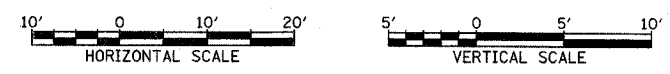

SB I-94 ENTRANCE RAMP
 STA. 118+50 TO STA. 119+50

NOTE: STAGE 2 EARTHWORK ADDITIONS/SUBTRACTIONS ARE NOT INCLUDED IN THE EARTHWORK QUANTITIES FOR EACH CROSS SECTION (SEE EARTHWORK SCHEDULE FOR BREAKDOWN OF QUANTITIES BY STAGE).