

PROFILE SURVEYED BY DATE  
 GRADES CHECKED  
 EARTHWORK NOTED  
 NO. PLANTING MATERIALS ORDERED

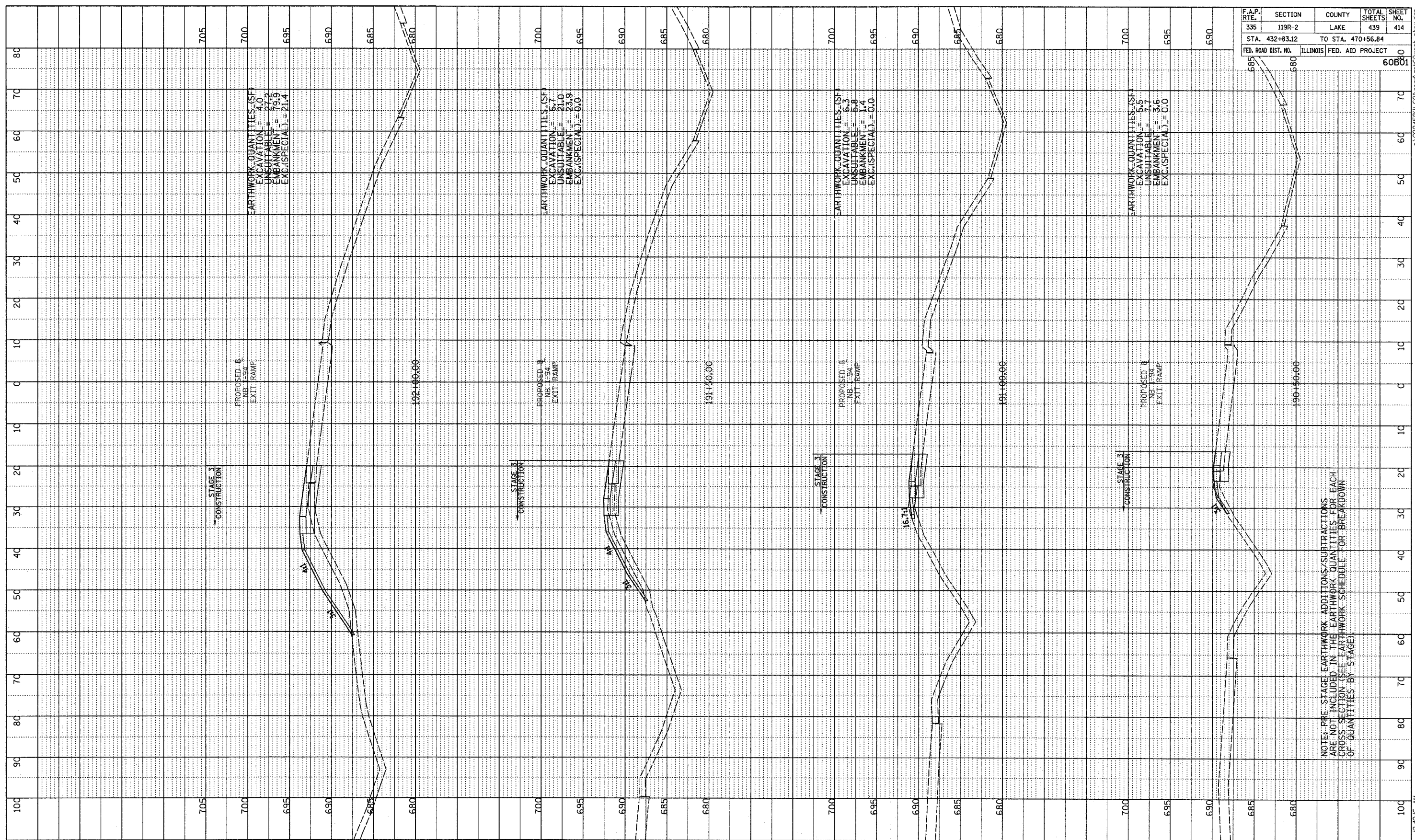

F.A.P. RTE.	SECTION	COUNTY	TOTAL SHEETS	SHEET NO.
335	119R-2	LAKE	439	414
STA. 432+83.12		TO STA. 470+56.84		
FED. ROAD DIST. NO.		ILLINOIS FED. AID PROJECT		60801

TYLIN INTERNATIONAL



NB I-94 EXIT RAMP  
 STA. 190+50 TO STA. 192+00

NOTE: PRE-STAGE EARTHWORK ADDITIONS/SUBTRACTIONS ARE NOT INCLUDED IN THE EARTHWORK QUANTITIES FOR EACH CROSS SECTION (SEE EARTHWORK SCHEDULE FOR BREAKDOWN OF QUANTITIES BY STAGE)