

PROFILE	DATE
BY	
STARTED	
GRADES CHECKED	
NO.	
STRUCTURE NOTATIONS OK'D	

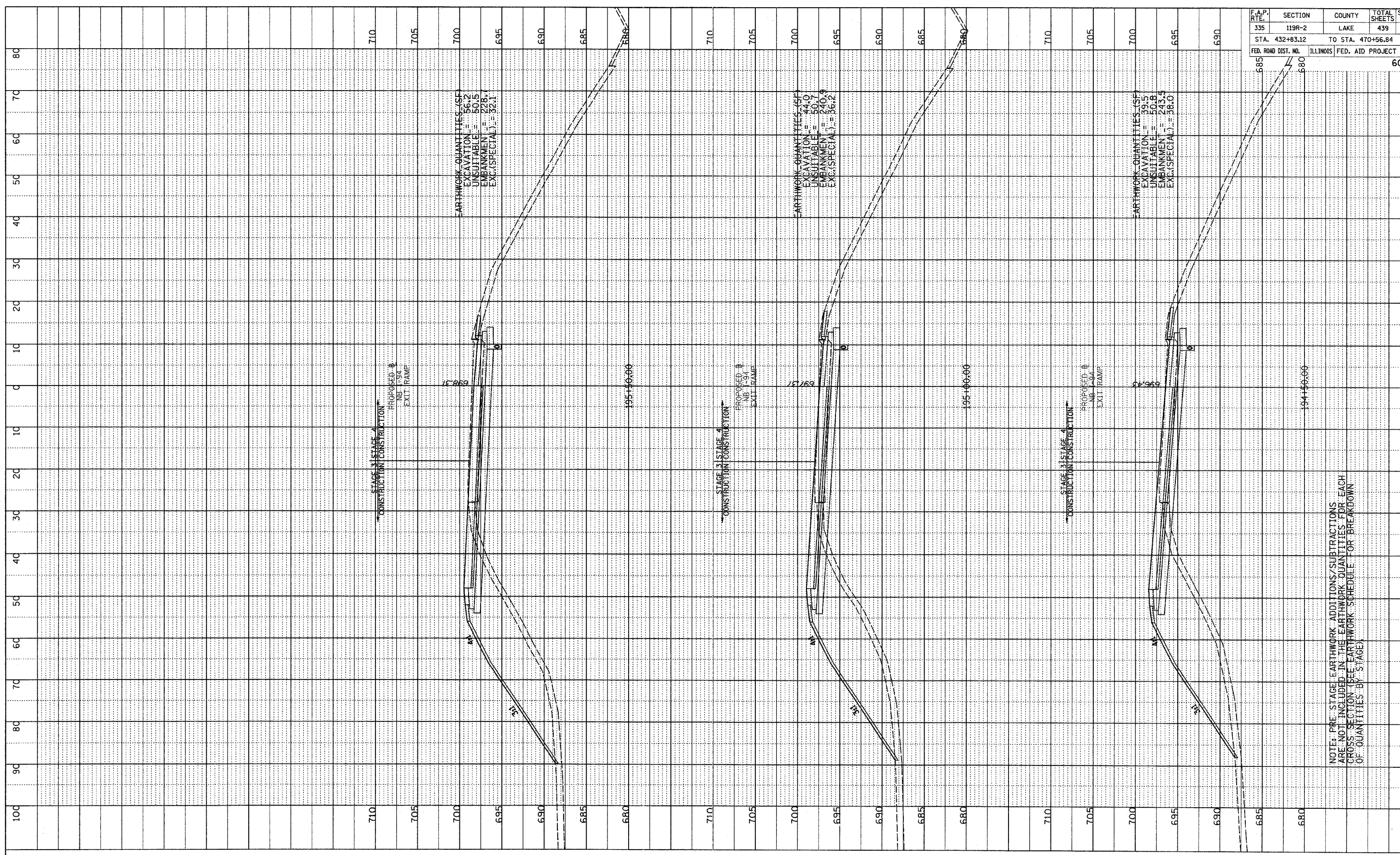

F.A.P. RTE.	SECTION	COUNTY	TOTAL SHEETS	SHEET NO.
335	119R-2	LAKE	439	416
STA. 432+83.12		TO STA. 470+56.84		
FED. ROAD DIST. NO.		ILLINOIS FED. AID PROJECT		60B01

TYLIN INTERNATIONAL

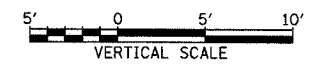
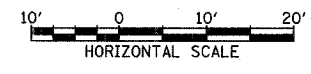

NB I-94 EXIT RAMP
 STA. 194+50 TO STA. 195+50

NOTE: PRE-STAGE EARTHWORK ADDITIONS/SUBTRACTIONS ARE NOT INCLUDED IN THE EARTHWORK QUANTITIES FOR EACH CROSS SECTION (SEE EARTHWORK SCHEDULE FOR BREAKDOWN OF QUANTITIES BY STAGE)

5/7/2009 10:40:17 AM I:\60245811-60\road\gpr60\ssst_nbrx.dgn