

PROFILE	BY	DATE
REVISION		
PLATTED		
NOTE BOOK		
NO.		
STRUCTURE		
NO.		

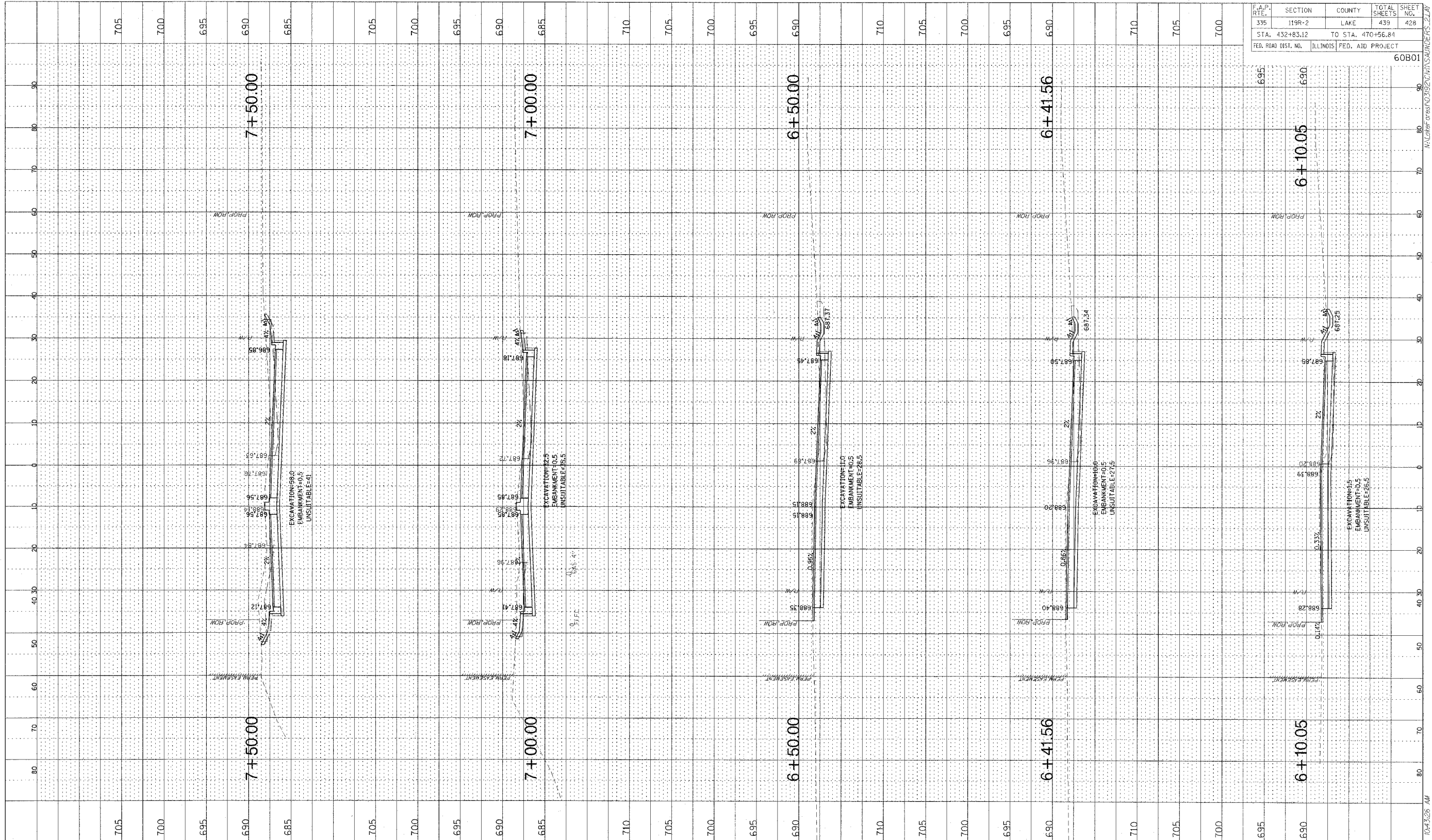

F.A.P. RTE.	SECTION	COUNTY	TOTAL SHEETS	SHEET NO.
335	119R-2	LAKE	439	428
STA. 432+83.12		TO STA. 470+56.84		
FED. ROAD DIST. NO.		ILLINOIS FED. AID PROJECT		

CHRISTOPHER B. BURKE ENGINEERING LTD.
 6275 West Higgins Road, Suite 600
 Rosemont, Illinois 60018
 (847) 833-8500



SAUNDERS ROAD
 STA. 6+10.05 TO STA. 7+50

5/2/2007 10:43:25 AM