

F.A.I. RTE.	SECTION	COUNTY	TOTAL SHEETS	SHEET NO.
55	2007-003 I	WILL	44	16
STA. TO STA.		TO STA.		
FED. ROAD DIST. NO.		ILLINOIS	FED. AID PROJECT	

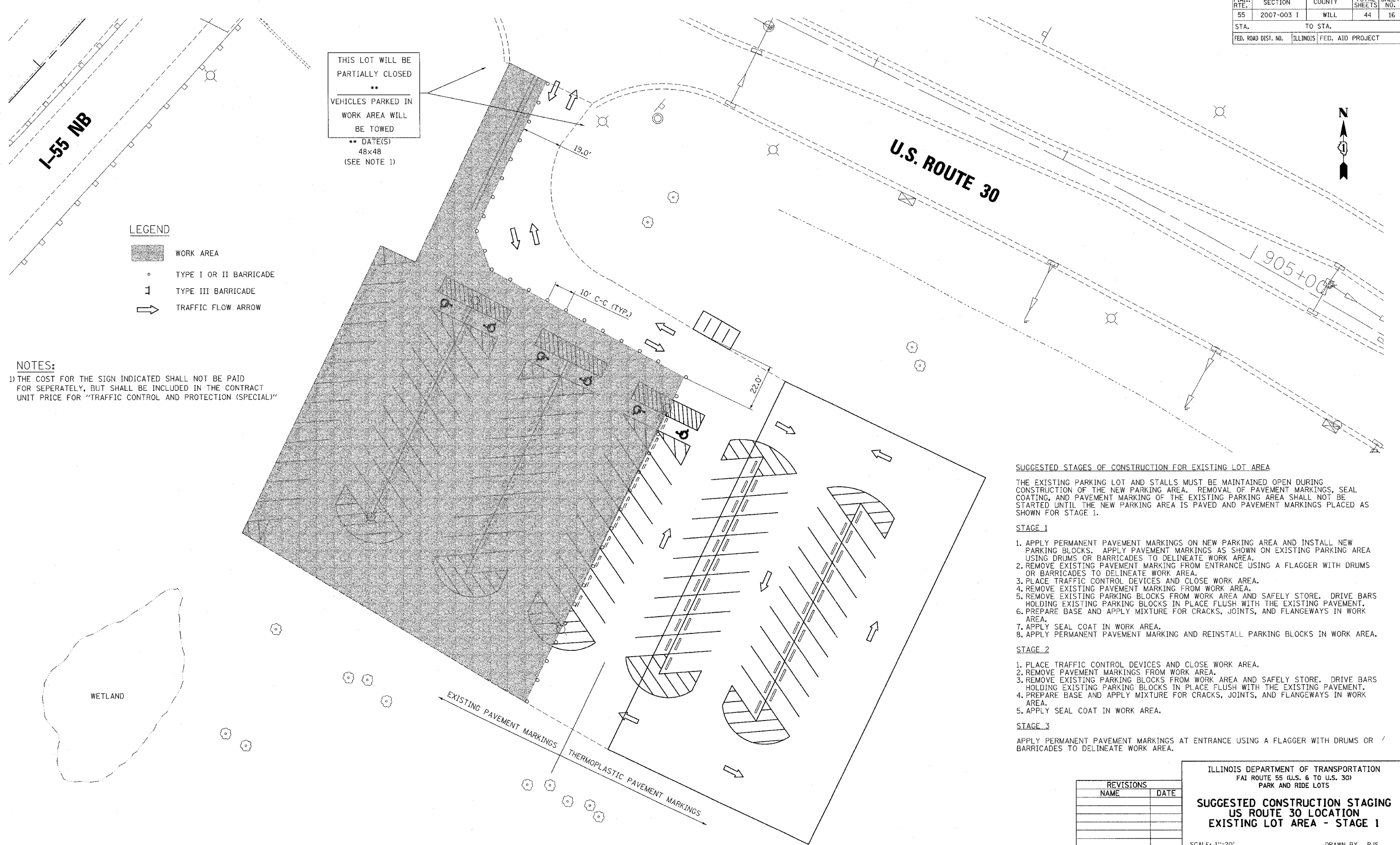

LEGEND

	WORK AREA
	TYPE I OR II BARRICADE
	TYPE III BARRICADE
	TRAFFIC FLOW ARROW

NOTES:
 1) THE COST FOR THE SIGN INDICATED SHALL NOT BE PAID FOR SEPARATELY, BUT SHALL BE INCLUDED IN THE CONTRACT UNIT PRICE FOR "TRAFFIC CONTROL AND PROTECTION (SPECIAL)"

SUGGESTED STAGES OF CONSTRUCTION FOR EXISTING LOT AREA
 THE EXISTING PARKING LOT AND STALLS MUST BE MAINTAINED OPEN DURING CONSTRUCTION OF THE NEW PARKING AREA. REMOVAL OF PAVEMENT MARKINGS, SEAL COATING, AND PAVEMENT MARKING OF THE EXISTING PARKING AREA SHALL NOT BE STARTED UNTIL THE NEW PARKING AREA IS PAVED AND PAVEMENT MARKINGS PLACED AS SHOWN FOR STAGE 1.

- STAGE 1**
1. APPLY PERMANENT PAVEMENT MARKINGS ON NEW PARKING AREA AND INSTALL NEW PARKING BLOCKS. APPLY PAVEMENT MARKINGS AS SHOWN ON EXISTING PARKING AREA USING DRUMS OR BARRICADES TO DELINEATE WORK AREA.
 2. REMOVE EXISTING PAVEMENT MARKING FROM ENTRANCE USING A FLAGGER WITH DRUMS OR BARRICADES TO DELINEATE WORK AREA.
 3. PLACE TRAFFIC CONTROL DEVICES AND CLOSE WORK AREA.
 4. REMOVE EXISTING PAVEMENT MARKING FROM WORK AREA.
 5. REMOVE EXISTING PARKING BLOCKS FROM WORK AREA AND SAFELY STORE. DRIVE BARS HOLDING EXISTING PARKING BLOCKS IN PLACE FLUSH WITH THE EXISTING PAVEMENT.
 6. PREPARE BASE AND APPLY MIXTURE FOR CRACKS, JOINTS, AND FLANGWAYS IN WORK AREA.
 7. APPLY SEAL COAT IN WORK AREA.
 8. APPLY PERMANENT PAVEMENT MARKING AND REINSTALL PARKING BLOCKS IN WORK AREA.

- STAGE 2**
1. PLACE TRAFFIC CONTROL DEVICES AND CLOSE WORK AREA.
 2. REMOVE PAVEMENT MARKINGS FROM WORK AREA.
 3. REMOVE EXISTING PARKING BLOCKS FROM WORK AREA AND SAFELY STORE. DRIVE BARS HOLDING EXISTING PARKING BLOCKS IN PLACE FLUSH WITH THE EXISTING PAVEMENT.
 4. PREPARE BASE AND APPLY MIXTURE FOR CRACKS, JOINTS, AND FLANGWAYS IN WORK AREA.
 5. APPLY SEAL COAT IN WORK AREA.

- STAGE 3**
1. APPLY PERMANENT PAVEMENT MARKINGS AT ENTRANCE USING A FLAGGER WITH DRUMS OR BARRICADES TO DELINEATE WORK AREA.

REVISIONS	
NAME	DATE

ILLINOIS DEPARTMENT OF TRANSPORTATION
 FAI ROUTE 55 (U.S. 6 TO U.S. 30)
 PARK AND RIDE LOTS

**SUGGESTED CONSTRUCTION STAGING
 US ROUTE 30 LOCATION
 EXISTING LOT AREA - STAGE 1**

SCALE: 1"=20'
 DATE: 05/24/07

DRAWN BY: RJJ
 CHECKED BY: DDH

TENG
 TENG & ASSOCIATES, INC.
 ENGINEERS/ARCHITECTS/PLANNERS
 CHICAGO, ILLINOIS

PLOT DATE = #DATE#
 FILE NAME = #FILE#
 USER NAME = #USER#
 \N:\114801.DGN, \N:\114802.DGN, \N:\114803.DGN, \N:\114804.DGN, \N:\114805.DGN, \N:\114806.DGN, \N:\114807.DGN, \N:\114808.DGN, \N:\114809.DGN, \N:\114810.DGN, \N:\114811.DGN, \N:\114812.DGN, \N:\114813.DGN, \N:\114814.DGN, \N:\114815.DGN, \N:\114816.DGN, \N:\114817.DGN, \N:\114818.DGN, \N:\114819.DGN, \N:\114820.DGN, \N:\114821.DGN, \N:\114822.DGN, \N:\114823.DGN, \N:\114824.DGN, \N:\114825.DGN, \N:\114826.DGN, \N:\114827.DGN, \N:\114828.DGN, \N:\114829.DGN, \N:\114830.DGN, \N:\114831.DGN, \N:\114832.DGN, \N:\114833.DGN, \N:\114834.DGN, \N:\114835.DGN, \N:\114836.DGN, \N:\114837.DGN, \N:\114838.DGN, \N:\114839.DGN, \N:\114840.DGN, \N:\114841.DGN, \N:\114842.DGN, \N:\114843.DGN, \N:\114844.DGN, \N:\114845.DGN, \N:\114846.DGN, \N:\114847.DGN, \N:\114848.DGN, \N:\114849.DGN, \N:\114850.DGN, \N:\114851.DGN, \N:\114852.DGN, \N:\114853.DGN, \N:\114854.DGN, \N:\114855.DGN, \N:\114856.DGN, \N:\114857.DGN, \N:\114858.DGN, \N:\114859.DGN, \N:\114860.DGN, \N:\114861.DGN, \N:\114862.DGN, \N:\114863.DGN, \N:\114864.DGN, \N:\114865.DGN, \N:\114866.DGN, \N:\114867.DGN, \N:\114868.DGN, \N:\114869.DGN, \N:\114870.DGN, \N:\114871.DGN, \N:\114872.DGN, \N:\114873.DGN, \N:\114874.DGN, \N:\114875.DGN, \N:\114876.DGN, \N:\114877.DGN, \N:\114878.DGN, \N:\114879.DGN, \N:\114880.DGN, \N:\114881.DGN, \N:\114882.DGN, \N:\114883.DGN, \N:\114884.DGN, \N:\114885.DGN, \N:\114886.DGN, \N:\114887.DGN, \N:\114888.DGN, \N:\114889.DGN, \N:\114890.DGN, \N:\114891.DGN, \N:\114892.DGN, \N:\114893.DGN, \N:\114894.DGN, \N:\114895.DGN, \N:\114896.DGN, \N:\114897.DGN, \N:\114898.DGN, \N:\114899.DGN, \N:\114900.DGN, \N:\114901.DGN, \N:\114902.DGN, \N:\114903.DGN, \N:\114904.DGN, \N:\114905.DGN, \N:\114906.DGN, \N:\114907.DGN, \N:\114908.DGN, \N:\114909.DGN, \N:\114910.DGN, \N:\114911.DGN, \N:\114912.DGN, \N:\114913.DGN, \N:\114914.DGN, \N:\114915.DGN, \N:\114916.DGN, \N:\114917.DGN, \N:\114918.DGN, \N:\114919.DGN, \N:\114920.DGN, \N:\114921.DGN, \N:\114922.DGN, \N:\114923.DGN, \N:\114924.DGN, \N:\114925.DGN, \N:\114926.DGN, \N:\114927.DGN, \N:\114928.DGN, \N:\114929.DGN, \N:\114930.DGN, \N:\114931.DGN, \N:\114932.DGN, \N:\114933.DGN, \N:\114934.DGN, \N:\114935.DGN, \N:\114936.DGN, \N:\114937.DGN, \N:\114938.DGN, \N:\114939.DGN, \N:\114940.DGN, \N:\114941.DGN, \N:\114942.DGN, \N:\114943.DGN, \N:\114944.DGN, \N:\114945.DGN, \N:\114946.DGN, \N:\114947.DGN, \N:\114948.DGN, \N:\114949.DGN, \N:\114950.DGN, \N:\114951.DGN, \N:\114952.DGN, \N:\114953.DGN, \N:\114954.DGN, \N:\114955.DGN, \N:\114956.DGN, \N:\114957.DGN, \N:\114958.DGN, \N:\114959.DGN, \N:\114960.DGN, \N:\114961.DGN, \N:\114962.DGN, \N:\114963.DGN, \N:\114964.DGN, \N:\114965.DGN, \N:\114966.DGN, \N:\114967.DGN, \N:\114968.DGN, \N:\114969.DGN, \N:\114970.DGN, \N:\114971.DGN, \N:\114972.DGN, \N:\114973.DGN, \N:\114974.DGN, \N:\114975.DGN, \N:\114976.DGN, \N:\114977.DGN, \N:\114978.DGN, \N:\114979.DGN, \N:\114980.DGN, \N:\114981.DGN, \N:\114982.DGN, \N:\114983.DGN, \N:\114984.DGN, \N:\114985.DGN, \N:\114986.DGN, \N:\114987.DGN, \N:\114988.DGN, \N:\114989.DGN, \N:\114990.DGN, \N:\114991.DGN, \N:\114992.DGN, \N:\114993.DGN, \N:\114994.DGN, \N:\114995.DGN, \N:\114996.DGN, \N:\114997.DGN, \N:\114998.DGN, \N:\114999.DGN, \N:\115000.DGN