

ROUTE	SECTION	COUNTY	TOTAL SHEETS	SHEET NUMBER
FAI 290 & FAP 339	2007-006I	COOK	23	1

CONTRACT NO. 60C37

D-91-206-07

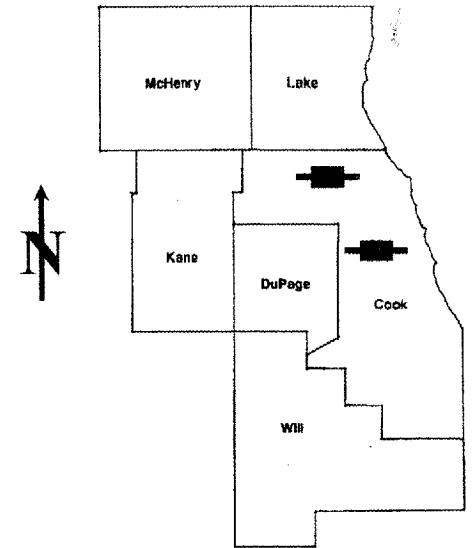

LOCATION OF IMPROVEMENT INDICATED THUS:

**STATE OF ILLINOIS
DEPARTMENT OF TRANSPORTATION
DIVISION OF HIGHWAYS
DISTRICT ONE
PROPOSED HIGHWAY PLANS**

LOC 1) FAI 290: I-290 (EISENHOWER EXPWY)
AT US 12/20/45 (MANNHEIM RD.)
LOC 2) FAP 339: IL 62 (ALGONQUIN RD.)
AT IL 59 (NEW SUTTON RD.)
SECTION: 2007-006I
EROSION CONTROL

COOK COUNTY
C-91-206-07

FOR INDEX OF SHEETS SEE SHEET 2

**IMPROVEMENTS ARE LOCATED IN
THE VILLAGES OF HILLSIDE AND
BARRINGTON HILLS**

TRAFFIC DATA

LOC 1

I-290
SPEED LIMIT = 55 MPH
2007 ADT = 204,200
US 12/20/45 (MANNHEIM RD.)
SPEED LIMIT = 35 MPH
2007 ADT = 42800

LOC 2

IL 62
SPEED LIMIT = 45 MPH
2007 ADT = 33,300
IL 59
SPEED LIMIT = 45 MPH
2007 ADT = 20,400

LOCATION 1
IMPROVEMENT

R 12 E

T39N

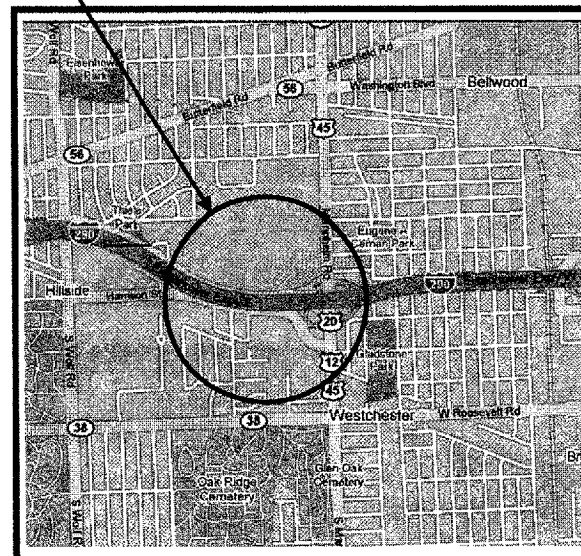

PROVISO TOWNSHIP

LOCATION 2
IMPROVEMENT

R 9 E

T42N

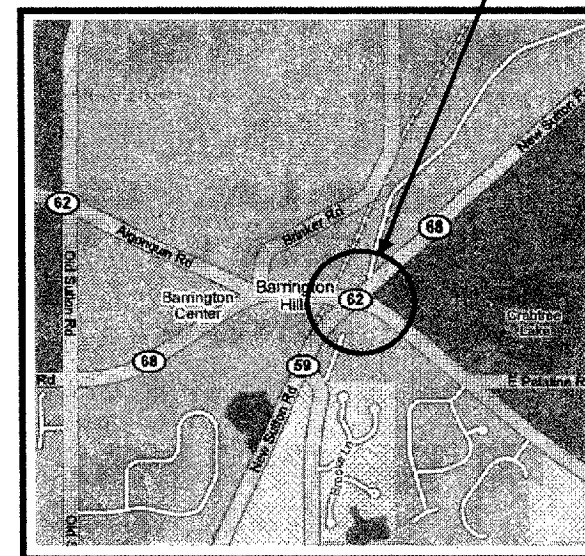

BARRINGTON TOWNSHIP

**STATE OF ILLINOIS
DEPARTMENT OF TRANSPORTATION
DIVISION OF HIGHWAYS**

SUBMITTED: May 29 2007
Diane O'Keefe
DEPUTY DIRECTOR OF HIGHWAYS, REGION ENGINEER

June 29, 2007
Eric E. Harn
Interim ENGINEER OF DESIGN AND ENVIRONMENT

June 29 2007
Milton R. Sees, P.E.
DIRECTOR OF HIGHWAYS, CHIEF ENGINEER

**PRINTED BY THE AUTHORITY
OF THE STATE OF ILLINOIS**

**J.U.L.I.E.: JOINT UTILITY LOCATION
INFORMATION FOR EXCAVATION
(800)892-0123**

DISTRICT ONE - DESIGN - PLAN PREPARATION ENGINEER:
KEN ENG / ROBERT BORO (847) 705-4178

ROUTE	SECTION	COUNTY	TOTAL SHEETS	SHEET NUMBER
FAI 290 & FAP 339	2007-006 I	COOK	23	2

CONTRACT NO. 60C37

INDEX OF SHEETS

- 1 TITLE SHEET
- 2 INDEX OF SHEETS, STATE STANDARDS AND GENERAL NOTES
- 3 SUMMARY OF QUANTITIES
- 4-14 LOCATION 1 (I-290 @ US 12/20/45)
- 15-21 LOCATION 2 (IL 62 @ IL 59)
- 22 TRAFFIC CONTROL AND PROTECTION AT TURN BAYS
(TO REMAIN OPEN TO TRAFFIC)
- 23 TRAFFIC CONTROL FOR SHOULDER CLOSURE
AND PARTIAL RAMP CLOSURES

STATE STANDARDS

- 701101-01 OFF-RD OPERATIONS, MULTILANE, 15' TO 24' FROM PAVEMENT EDGE
- 701106-01 OFF-RD OPERATIONS, MULTILANE, MORE THAN 15' AWAY
- 701301-02 LANE CLOSURE, 2L, 2W, SHORT TIME OPERATIONS
- 701601-04 URBAN LANE CLOSURE, MULTILANE, 1W OR 2W WITH
TRANSVERSABLE MEDIAN
- 702001-06 TRAFFIC CONTROL DEVICES

GENERAL NOTES

BEFORE STARTING ANY EXCAVATION THE CONTRACTOR SHALL CALL "J.U.L.I.E." AT (800) 892-0123 FOR FIELD LOCATIONS OF BURIED ELECTIRC, TELEPHONE AND GAS UTILITIES. 48 HOUR NOTIFICATION IS REQUIRED.

THE CONTRACTOR SHALL COORDINATE CONSTRUCTION ACTIVITIES WITH UTILITY COMPANIES

IT SHALL BE THE CONTRACTOR'S RESPONSIBILITY TO VERIFY ALL DIMENSIONS AND CONDITIONS EXISTING IN THE FIELD PRIOR TO CONSTRUCTION AND ORDERING OF MATERIALS.

THE CONTRACTOR SHALL CONTACT THE DISTRICT ONE TRAFFIC CONTROL SUPERIVISOR AT (847)705-4470 (FOR ARTERIALS) AND (847)705-4151 (FOR EXPRESSWAYS) A MINIMUM OF 72 HOURS IN ADVANCE OF BEGINNING WORK.

THESE PLANS HAVE BEEN PREPARED FROM NOTES RECEIVED FORM THE BUREAU OF MAINTAINENCE.

DO NOT SCALE PLANS FOR CONSTRUCTION DIMENSIONS.

THE CONTRACTOR SHALL NOT BE ALLOWED TO SET UP A YARD OR FIELD OFFICE ON STATE PROPERTY WITHOUT WRITTEN PERMISSION FROM THE DEPARTMENT.

ANY AREAS EXPOSED LONGER THAN 14 DAYS SHALL REQUIRE TEMPORARY GROUND STABILIZATION AT THE CONTRACTOR'S EXPENSE. METHOD OF GROUND STABILIZATION TO BE APPROVED BY THE ENGINEER.

ILLINOIS DEPARTMENT OF TRANSPORTATION

INDEX OF SHEETS
STATE STANDARDS
GENERAL NOTES

SUMMARY OF QUANTITIES

ROUTE	SECTION	COUNTY	TOTAL SHEETS	SHEET NUMBER
FAI 290 & FAP 339	2007-006 I	COOK	23	3

CONTRACT 60C37

CODE NUMBER	DESCRIPTION	UNIT	TOTAL QUANTITY	CONSTRUCTION TYPE CODE SFTY-2A	
				LOC 1) I-290	LOC 2) IL 62
20200100	EARTH EXCAVATION	CU YD	69	62	7
20201006	GRADING AND SHAPING SHOULDERS	UNIT	5	5	
20400800	FURNISHED EXCAVATION	CU YD	621	113	508
21101615	TOPSOIL FURNISH AND PLACE, 4"	SQ YD	714	574	140
21101625	TOPSOIL FURNISH AND PLACE, 6"	SQ YD	144	144	
25000210	SEEDING, CLASS 2A	ACRE	0.15	0.12	0.03
25000310	SEEDING, CLASS 4	ACRE	0.04	0.04	
25100630	EROSION CONTROL BLANKET	SQ YD	194	54	140
28000300	TEMPORARY DITCH CHECK	EACH	20	20	
28100109	STONE RIPRAP, CLASS A5	SQ YD	86		86
28100807	STONE DUMPED RIPRAP, CLASS A4	TON	132		132
28200200	FILTER FABRIC	SQ YD	250		250
48102100	AGGREGATE WEDGE SHOULDER, TYPE B	TON	55	55	
67100100	MOBILIZATION	L SUM	1	0.5	0.5
67000400	ENGINEER'S FIELD OFFICE, TYPE A	CAL MO	2	1	1
70101800	TRAFFIC CONTROL AND PROTECTION (SPECIAL)	L SUM	1		1
X0322467	TEMPORARY INFORMATION SIGNING FOR LANE CLOSURES	SQ FT	48		48
X7011015	TRAFFIC CONTROL AND PROTECTION (EXPRESSWAYS)	L SUM	1	1	
Z0076800	TURF REINFORCEMENT MAT	SQ YD	556	556	

Rev.

ILLINOIS DEPARTMENT OF TRANSPORTATION
SUMMARY OF QUANTITIES

ROUTE	SECTION	COUNTY	TOTAL SHEETS	SHEET NUMBER
FAI 290 & FAP 339	2007-0061	COOK		4

CONTRACT 60C37

SHEET 1 OF 11

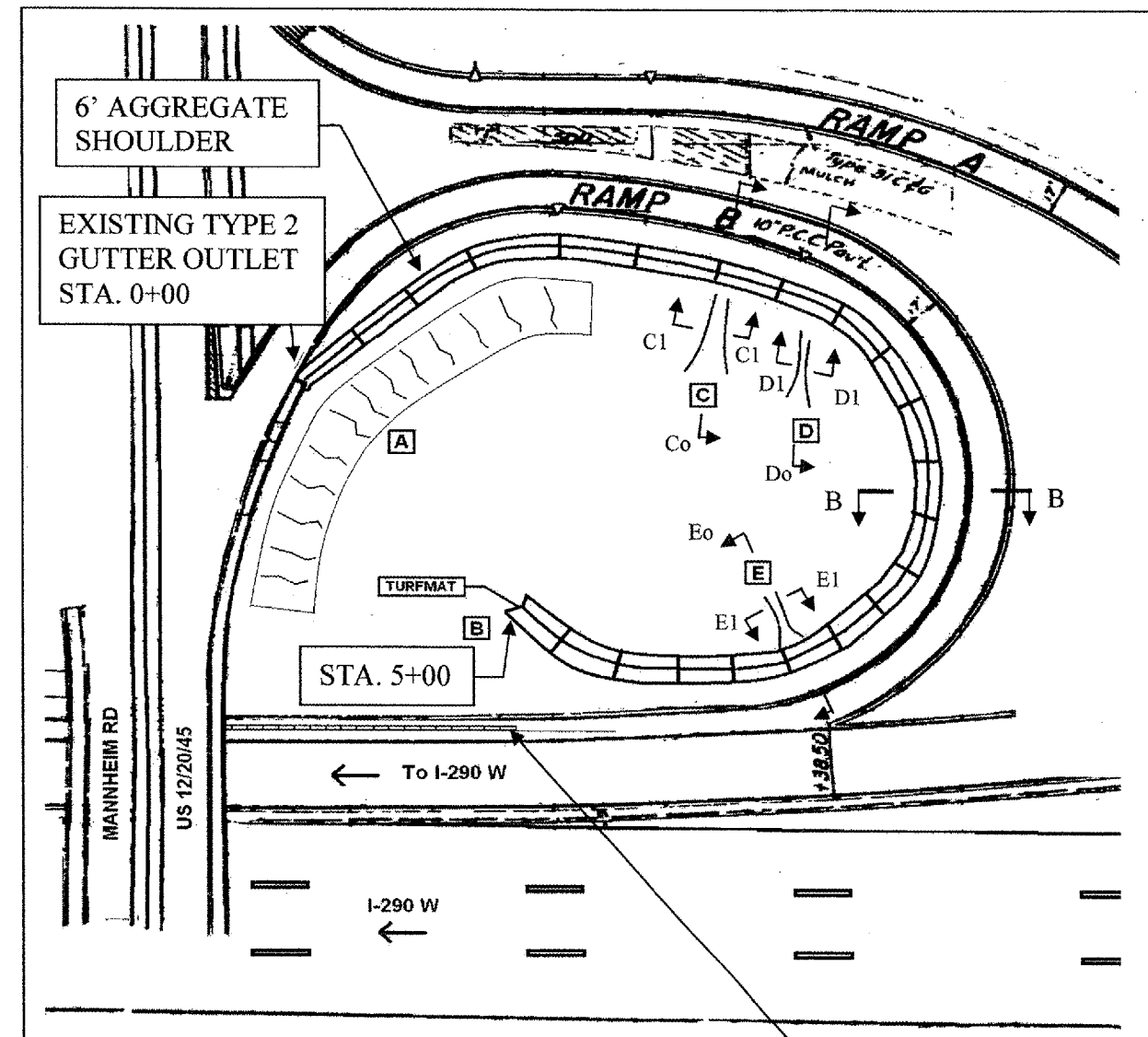
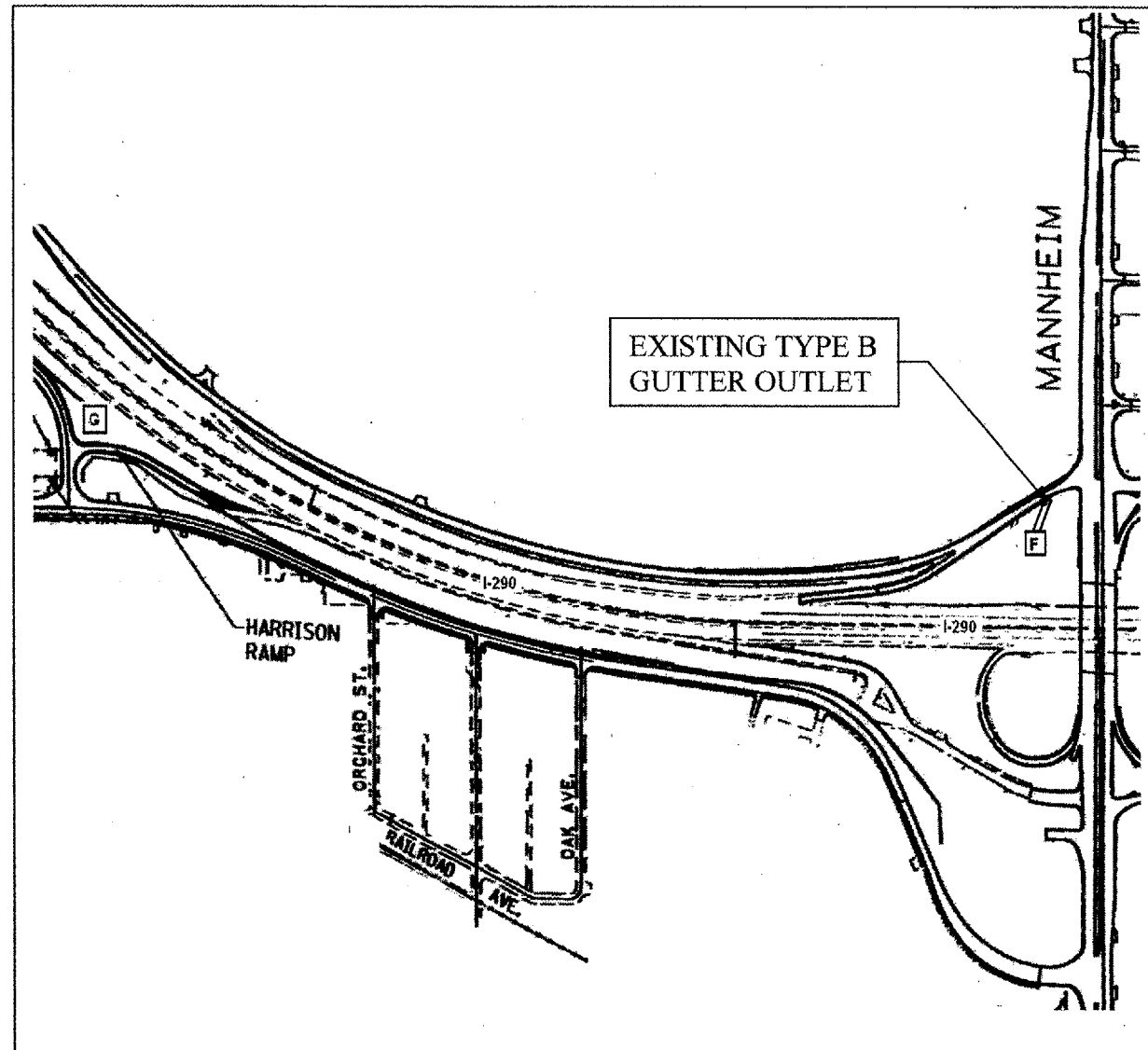

WHERE [A], [B], [C], [D], [E], [F] & [G] REPRESENTS IMPROVEMENT AREAS

ILLINOIS DEPARTMENT OF TRANSPORTATION
 PLAN VIEW
 LOCATION 1
 I-290 AT US 12/20/45 (MANNHEIM RD)

ROUTE	SECTION	COUNTY	TOTAL SHEETS	SHEET NUMBER
I-290 & IL 62	2007-0061	COOK	23	5

SHEET 2 OF 11

Plan No.	Field No.	Dist. No.	Total Length
062	1954	14	66'

SECTION 062-3636 MFT.
062-3636 MFT.

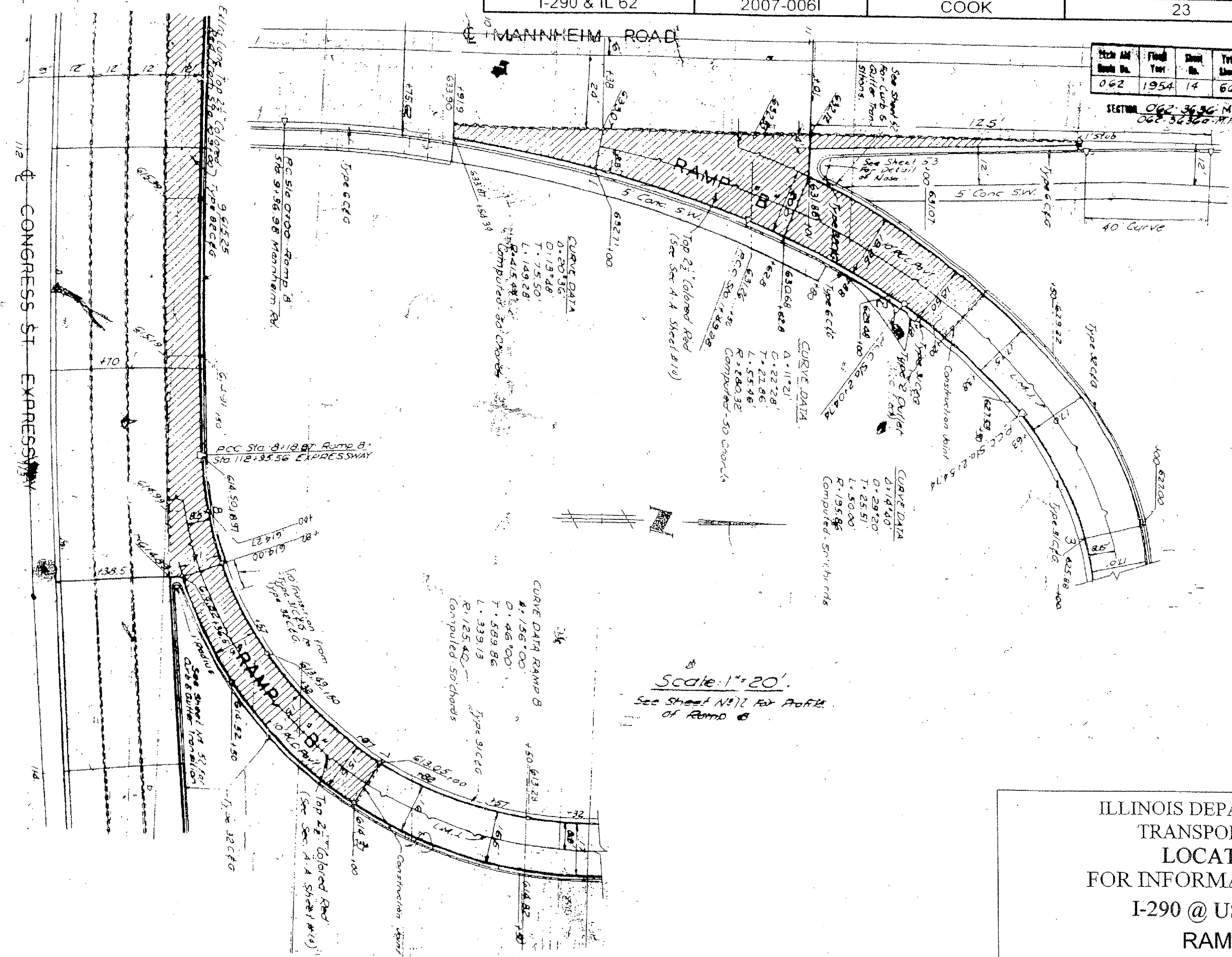

ILLINOIS DEPARTMENT OF
TRANSPORTATION
LOCATION 1
FOR INFORMATION ONLY
I-290 @ US 12/20/45
RAMP B

ROUTE	SECTION	COUNTY	TOTAL SHEETS	SHEET NUMBER
FAI 290 & FAP 339	2007-006I	COOK	23	6

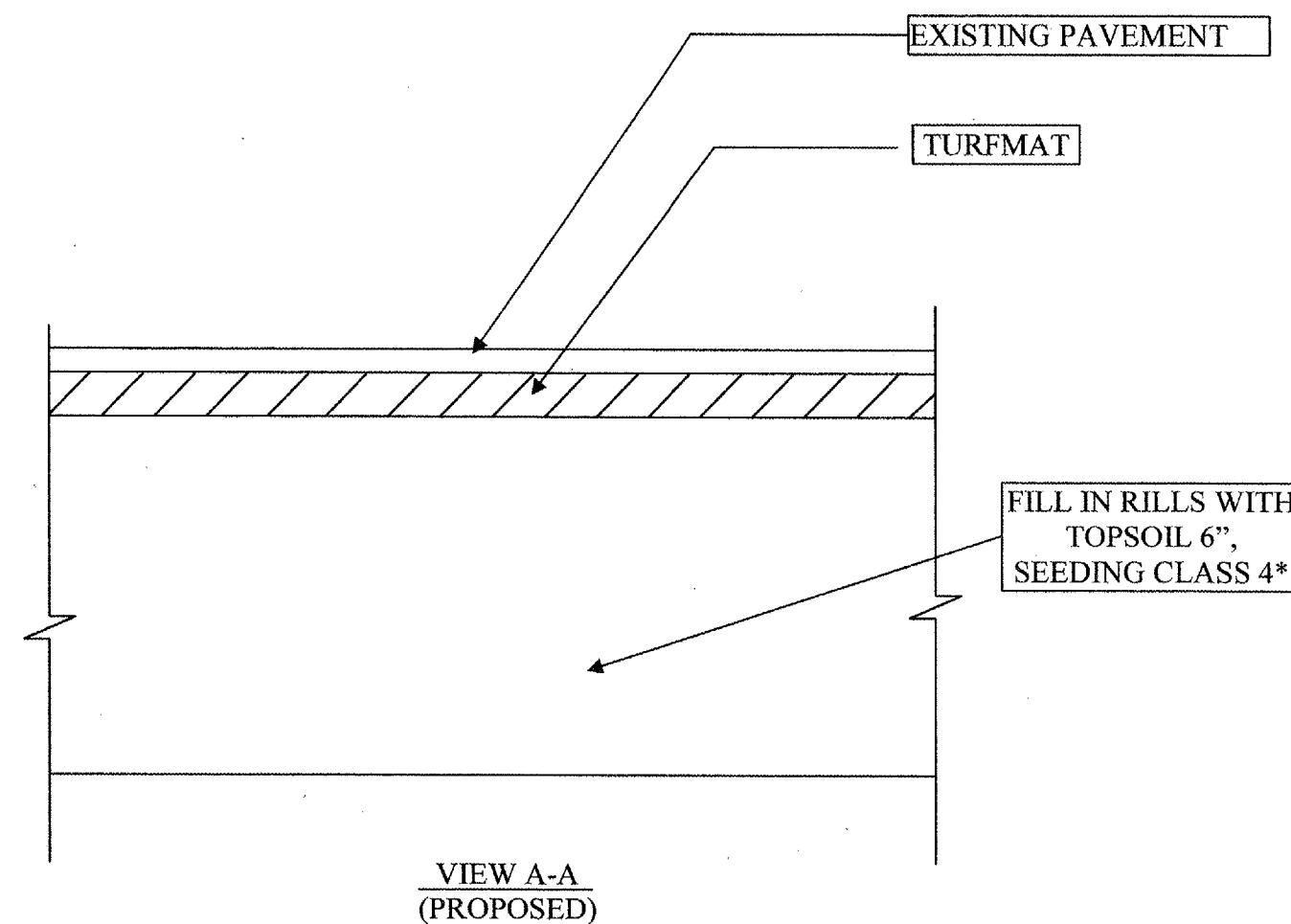
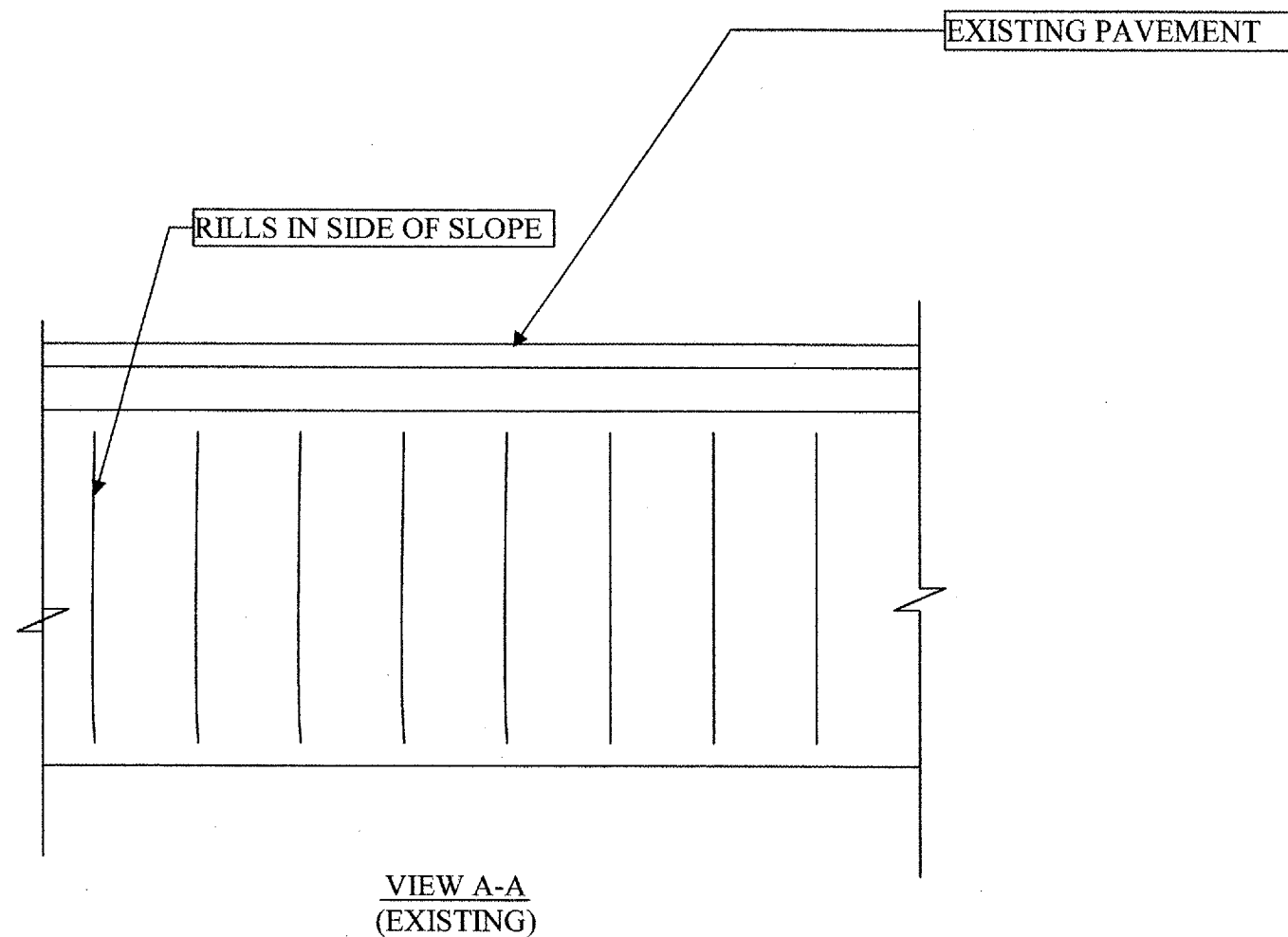

*INCLUDES EROSION CONTROL BLANKET
FERTILIZER INTENTIONALLY OMITTED

ILLINOIS DEPARTMENT OF
TRANSPORTATION

LOCATION 1
I-290W AT US 12/20/45
LOCATION A

ROUTE	SECTION	COUNTY	TOTAL SHEETS	SHEET NUMBER
FAI 290 & FAP 339	2007-0061	COOK	23	7

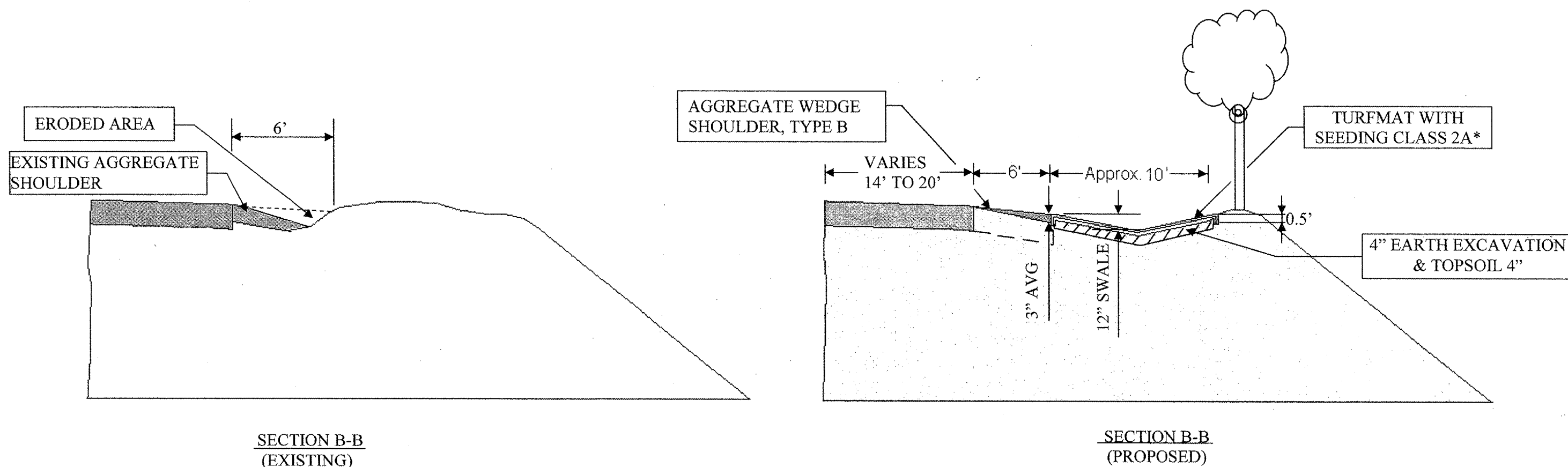

* FERTILIZER INTENTIONALLY OMITTED
 SEE SHEET 6 OF 11 FOR TURFMAT INSTALATION DETAILS

ILLINOIS DEPARTMENT OF
 TRANSPORTATION
 LOCATION 1
 I-290 AT US 12/20/45
 SECTION B-B
 AREA B

ROUTE	SECTION	COUNTY	TOTAL SHEETS	SHEET NUMBER
FAI 290 & FAP 339	2007-0061	COOK	23	8

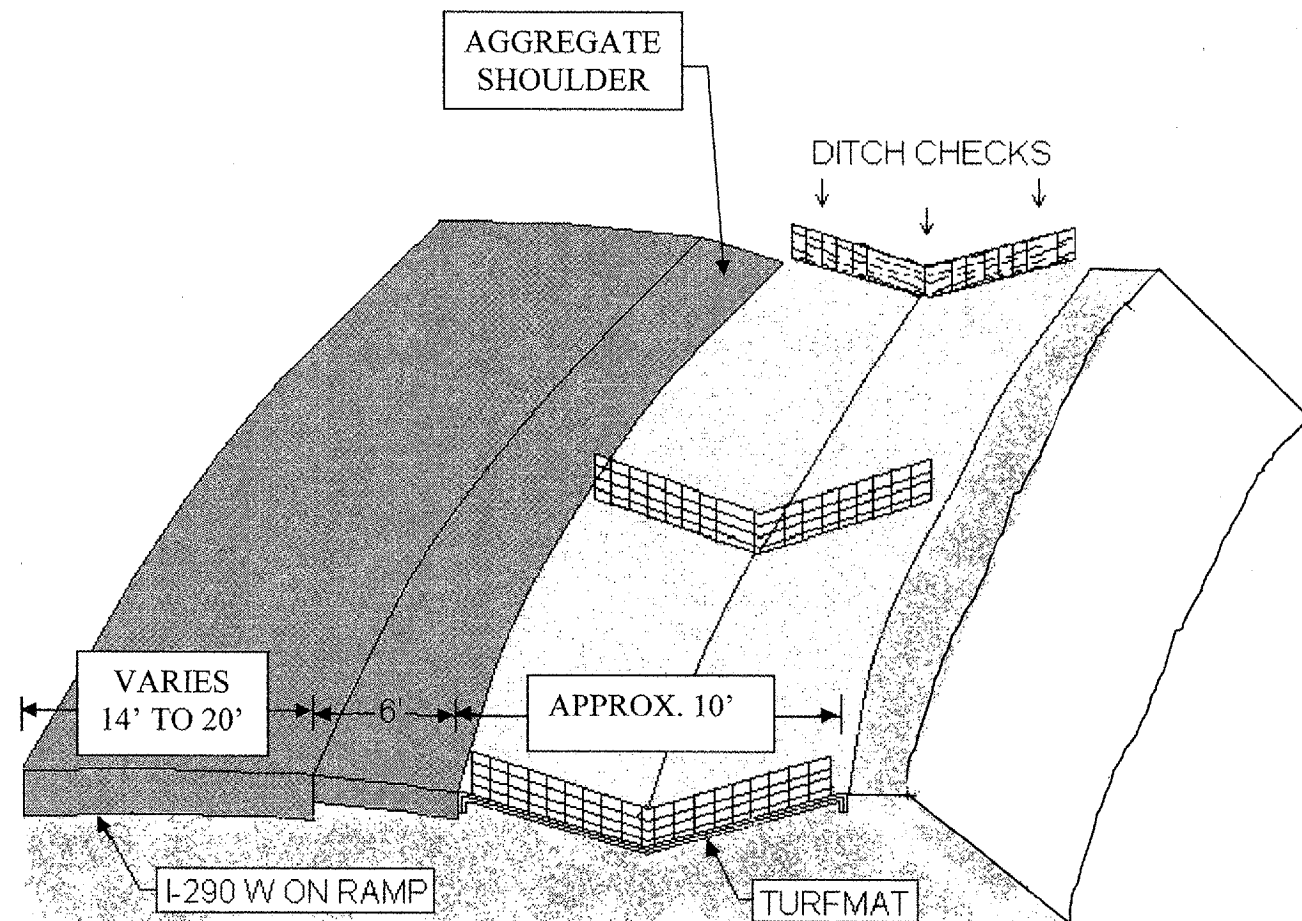

PARTIAL PLAN VIEW
(PROPOSED)

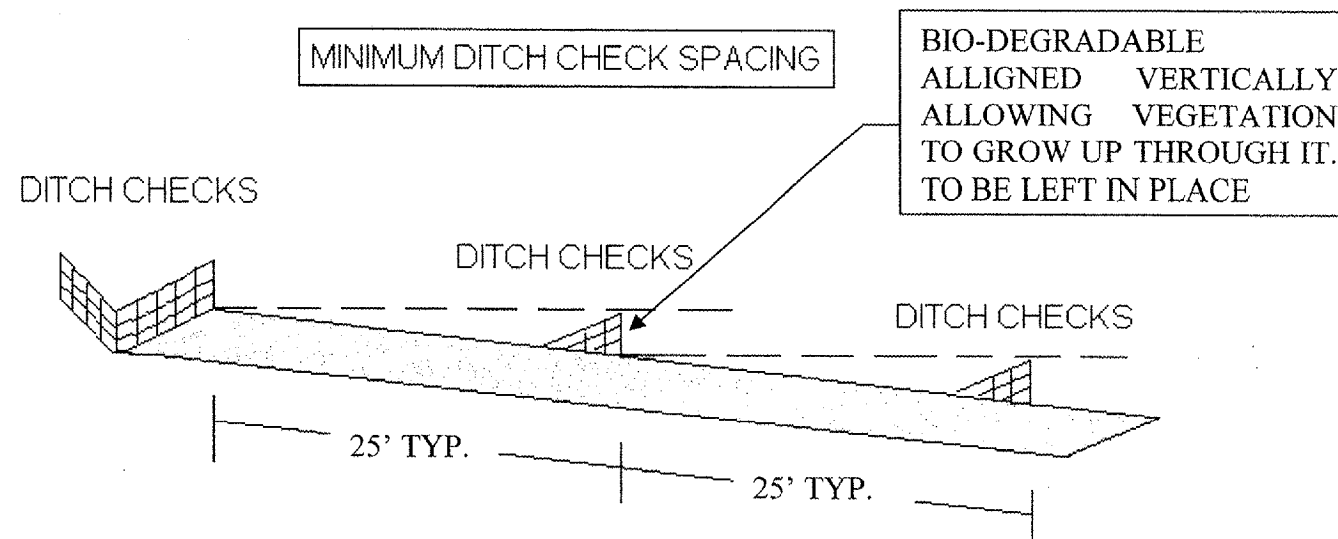

ELEVATION VIEW

ILLINOIS DEPARTMENT OF
TRANSPORTATION

LOCATION 1
I-290W ON RAMP FROM US 12/20/45 N
DITCH CHECK DETAIL
AREA B

ROUTE	SECTION	COUNTY	TOTAL SHEETS	SHEET NUMBER
I-290 & IL 62	2007-0061	COOK	23	9

CHANNEL INSTALLATION

1. PREPARE SOIL BEFORE INSTALLING ROLLED EROSION CONTROL PRODUCTS (RECP's), INCLUDING ANY NECESSARY APPLICATION OF LIME, FERTILIZER, AND SEED.
2. BEGIN AT THE TOP OF THE CHANNEL BY ANCHORING THE RECP's IN A 6" DEEP X 6" WIDE TRENCH WITH APPROXIMATELY 12" OF RECP's EXTENDED BEYOND THE UP-SLOPE PORTION OF THE TRENCH. ANCHOR THE RECP's WITH A ROW OF STAPLES/STAKES APPROXIMATELY 12" APART IN THE BOTTOM OF THE TRENCH. BACKFILL AND COMPACT THE TRENCH AFTER STAPLING. APPLY SEED TO COMPACTED SOIL AND FOLD REMAINING 12" PORTION OF THE RECP's BACK OVER SEED AND COMPACTED SOIL. SECURE RECP's OVER COMPACTED SOIL WITH A ROW OF STAPLES/STAKES SPACED APPROXIMATELY 12".
3. ROLL CENTER RECP's IN DIRECTION OF WATER FLOW IN THE BOTTOM OF CHANNEL. RECP's WILL UNROLL WITH APPROPRIATE SIDE AGAINST THE SOIL SURFACE. ALL RECP's MUST BE SECURELY FASTENED TO SOIL SURFACE BY PLACING STAPLES/STAKES IN APPROPRIATE LOCATIONS AS SHOWN IN THE STAPLE PATTERN GUIDE. WHEN USING THE DOT SYSTEM, STAPLES SHOULD BE PLACED THROUGH EACH OF THE COLORED DOTS CORRESPONDING TO THE APPROPRIATE STAPLE PATTERN.
4. PLACE CONSECUTIVE RECP's END OVER END (SHINGLE STYLE) WITH A 4" -6" OVERLAP. USE A DOUBLE ROW OF STAPLES STAGGERED 4" APART AND 4" ON CENTER TO SECURE RECP's.
5. FULL LENGTH EDGE OF RECP's AT THE TOP OF SIDE SLOPES MUST BE ANCHORED WITH A ROW OF STAPLES/STAKES APPROXIMATELY 12" APART IN A 6" DEEP X 6" WIDE TRENCH. BACKFILL AND COMPACT THE TRENCH AFTER STAPLING.
6. ADJACENT RECP's MUST BE OVERLAPPED APPROXIMATELY 2"-5" (DEPENDING ON RECP's TYPE) AND STAPLED.
7. IN HIGH FLOW CHANNEL APPLICATIONS, A STAPLE CHECK SLOT IS RECOMMENDED AT 30 TO 40 FOOT INTERVALS. USE A DOUBLE ROW OF STAPLES STAGGERED 4" APART AND 4" ON CENTER OVER ENTIRE WIDTH OF THE CHANNEL.
8. THE TERMINAL END OF THE RECP's MUST BE ANCHORED WITH A ROW STAPLES/STAKES APPROXIMATELY 12" APART IN A 6" DEEP X 6" WIDE TRENCH. BACKFILL AND COMPACT THE TRENCH AFTER STAPLING.

NOTE: IN LOOSE SOIL CONDITIONS, THE USE OF STAPLE OR STAKE OR STAKE LENGTHS GREATER THAN 6" MAY BE NECESSARY TO PROPERLY ANCHOR THE RECP's.

CHANNEL INSTALLATION

STAPLE PLACEMENTS SHOWN FOR ILLUSTRATIVE PURPOSES ONLY. SEE MANUFACTURER STAPLE PATTERN GUIDES FOR ACTUAL RECOMMENDED PLACEMENTS

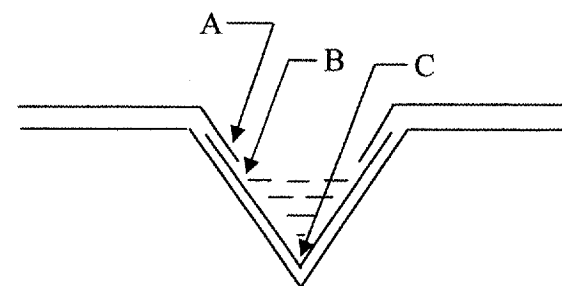
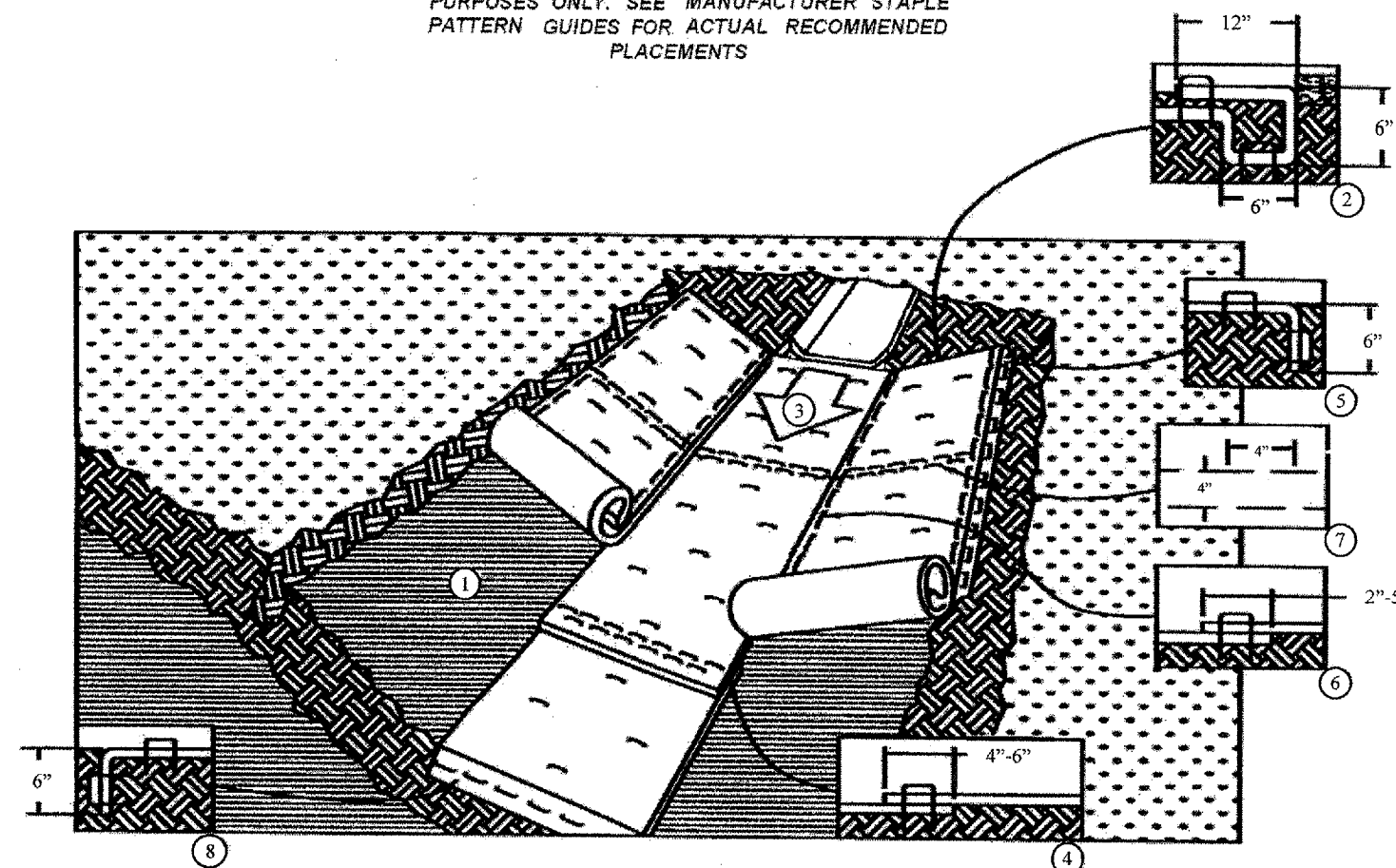

CRITICAL

- A. OVERLAPS AND SEAMS
- B. PROJECTED WATER LINES
- C. CHANNEL BOTTOM/SIDE SLOPE VERTICES

NOTE:

*HORIZONTAL STAPLE SPACING SHOULD BE ALTERED IF NECESSARY TO ALLOW STAPLES TO SECURE THE CRITICAL POINTS ALONG THE CHANNEL SURFACE

**IN LOOSE SOIL CONDITIONS, THE USE OF STAPLE OR STAKE LENGTHS GREATER THAN 6" MAY BE NECESSARY TO PROPERLY ANCHOR THE RECP's.

ILLINOIS DEPARTMENT OF
TRANSPORTATION

LOCATION 1
I-290 @ US 12/20/45
TURFMAT CHANNEL INSTALLATION

ROUTE	SECTION	COUNTY	TOTAL SHEETS	SHEET NUMBER
FAI 290 & FAP 339	2007-006I	COOK	23	10

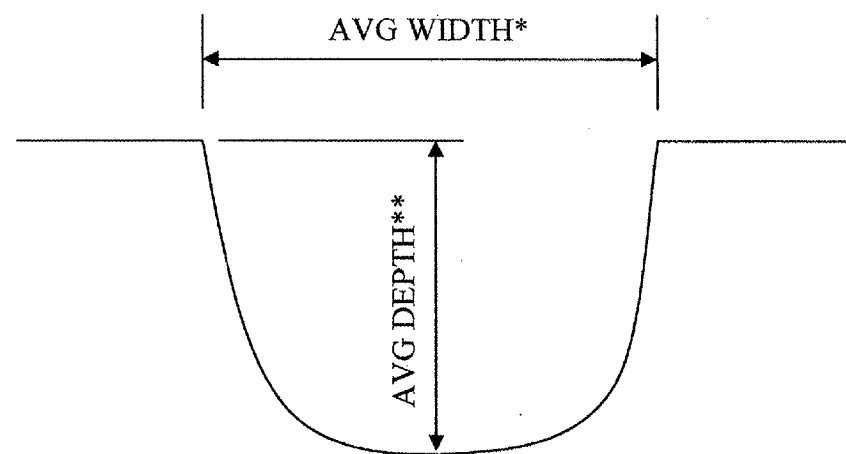

SECTION C₁-C₁, D₁-D₁, E₁-E₁
(EXISTING)

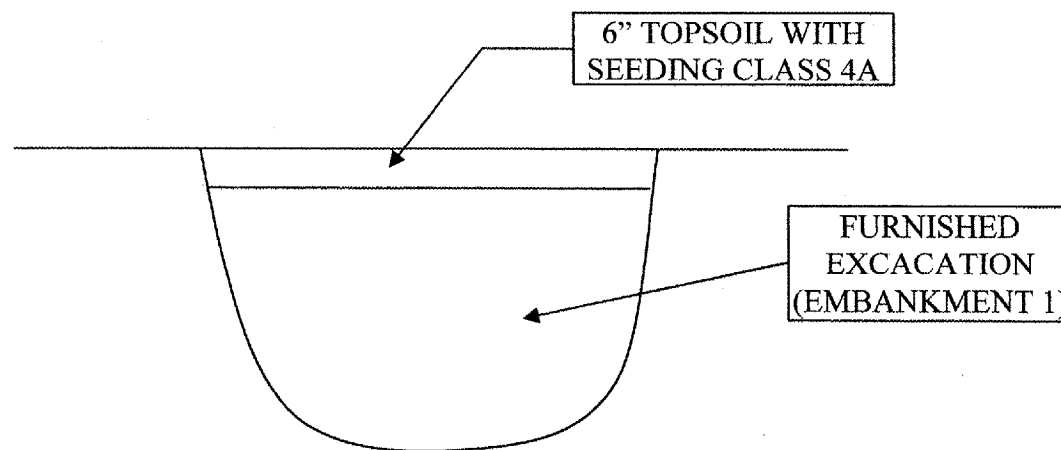

SECTION C₁-C₁, D₁-D₁, E₁-E₁
(PROPOSED)

*AVERAGE WIDTH: C₁-C₁=9', D₁-D₁=7', E₁-E₁=6'
**AVERAGE DEPTH: C₁-C₁=4', D₁-D₁=3', E₁-E₁=2'

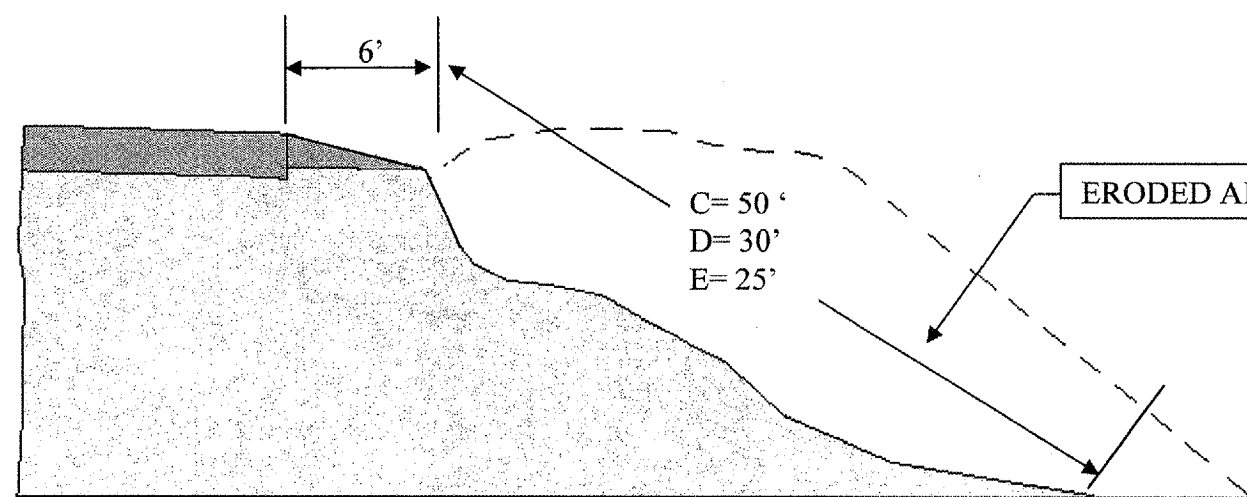

SECTION C₀-C₀, D₀-D₀, E₀-E₀
(EXISTING)

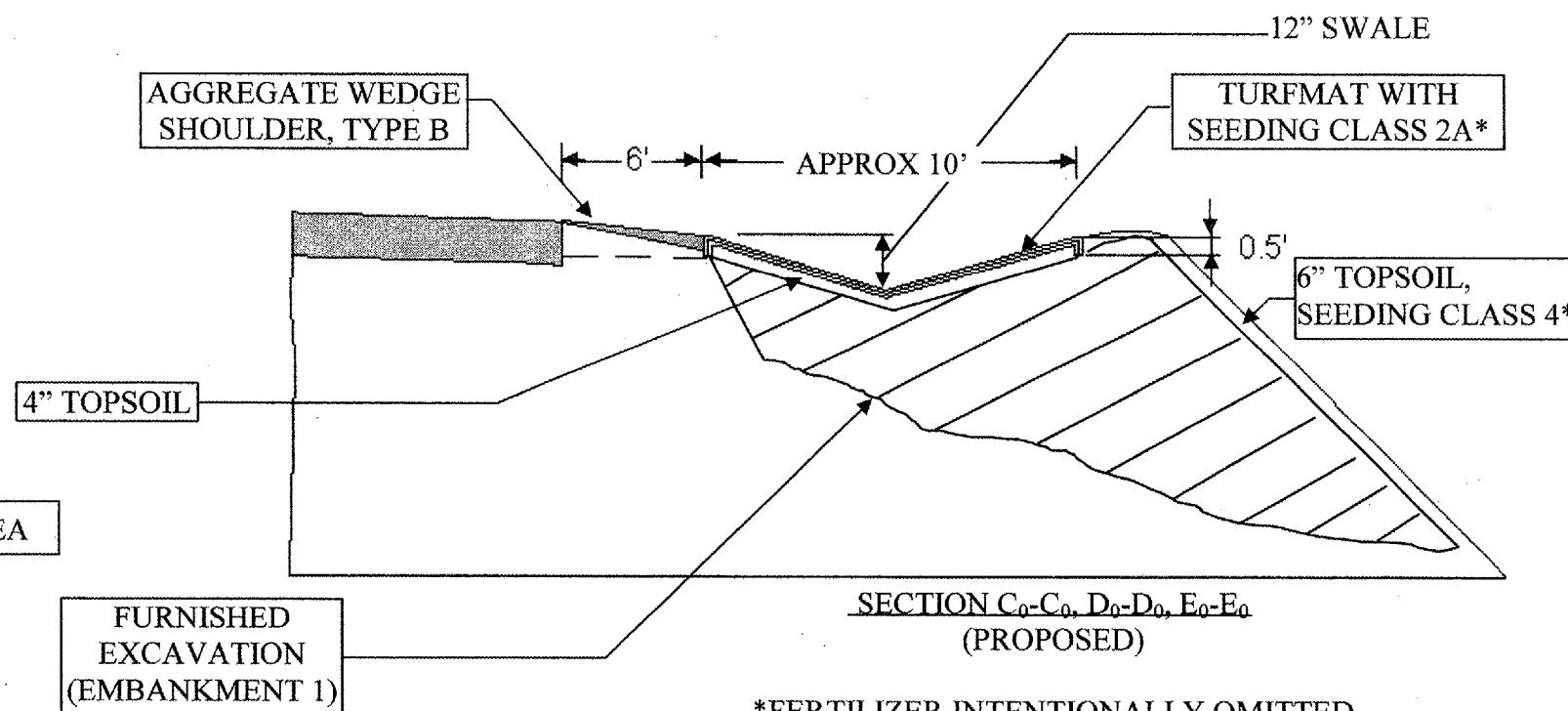

SECTION C₀-C₀, D₀-D₀, E₀-E₀
(PROPOSED)

*FERTILIZER INTENTIONALLY OMITTED

ILLINOIS DEPARTMENT OF
TRANSPORTATION
LOCATION 1
I-290 AT US 12/20/45
SECTIONS C-C, D-D & E-E
AREAS C, D & E

ROUTE	SECTION	COUNTY	TOTAL SHEETS	SHEET NUMBER
FAI 290 & FAP 339	2007-006I	COOK	23	11

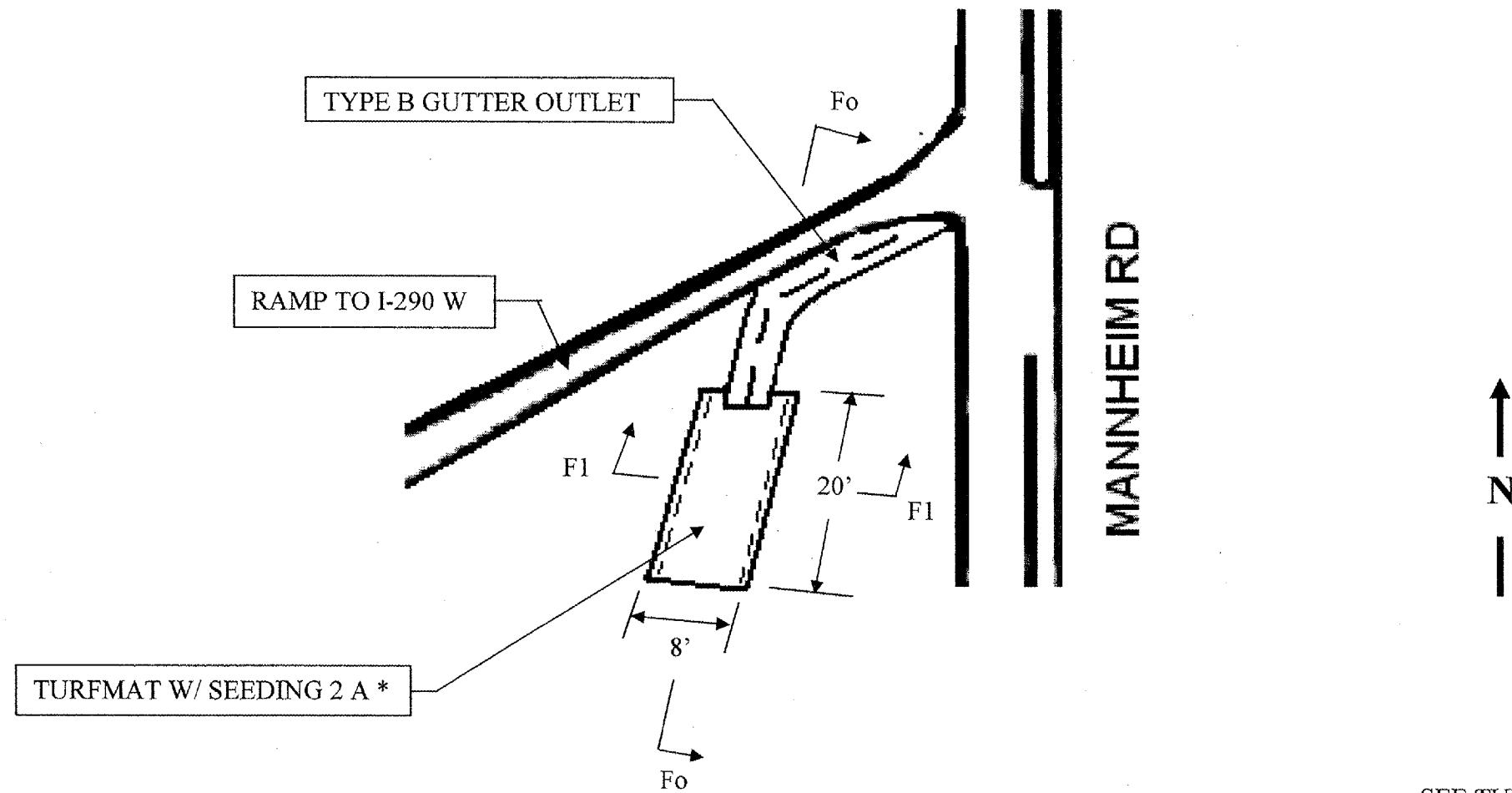

SECTION F
PROPOSED PLAN VIEW

SEE SHEET 9 OF 11 FOR SECTION Fo-Fo
SEE SHEET 10 OF 11 FOR SECTION F1-F1

SEE TURFMAT INSTALLATION ON SHEET 6 OF 11

* FERTILIZER OMITTED INTENTIONALLY

ILLINOIS DEPARTMENT OF TRANSPORTATION

LOCATION 1
I-290 AT US 12/20/45
AREA F

ROUTE	SECTION	COUNTY	TOTAL SHEETS	SHEET NUMBER
FAI 290 & FAP 339	2007-006I	COOK	23	12

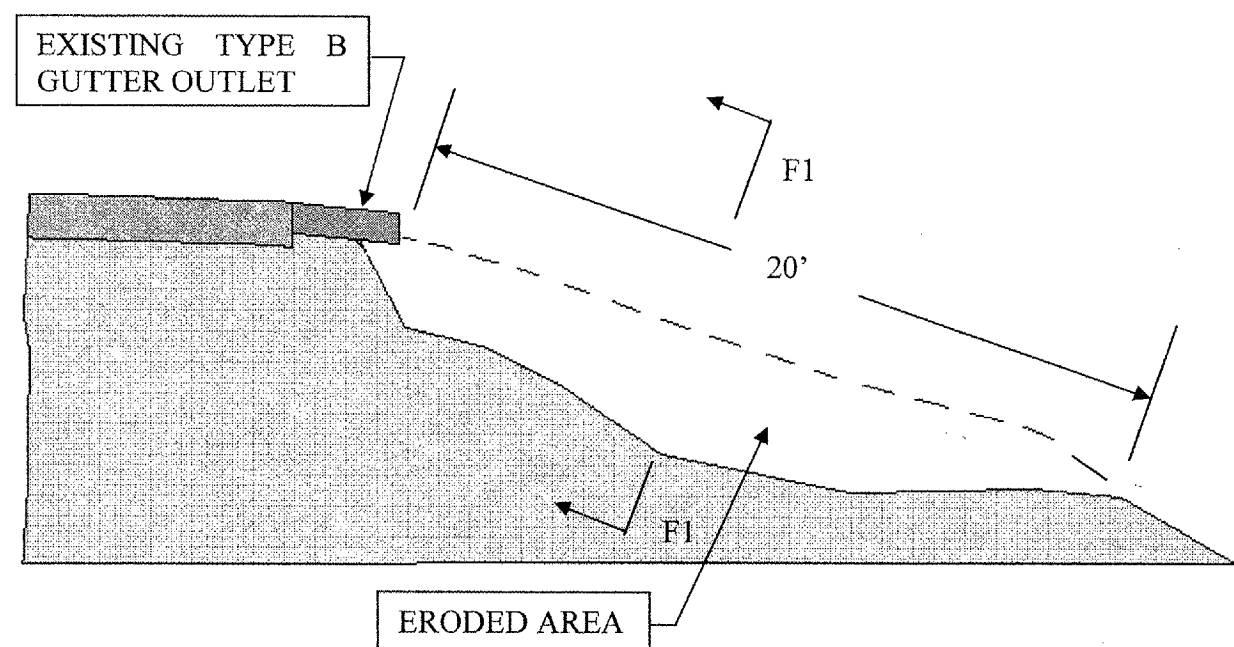

SECTION Fo-Fo
EXISTING

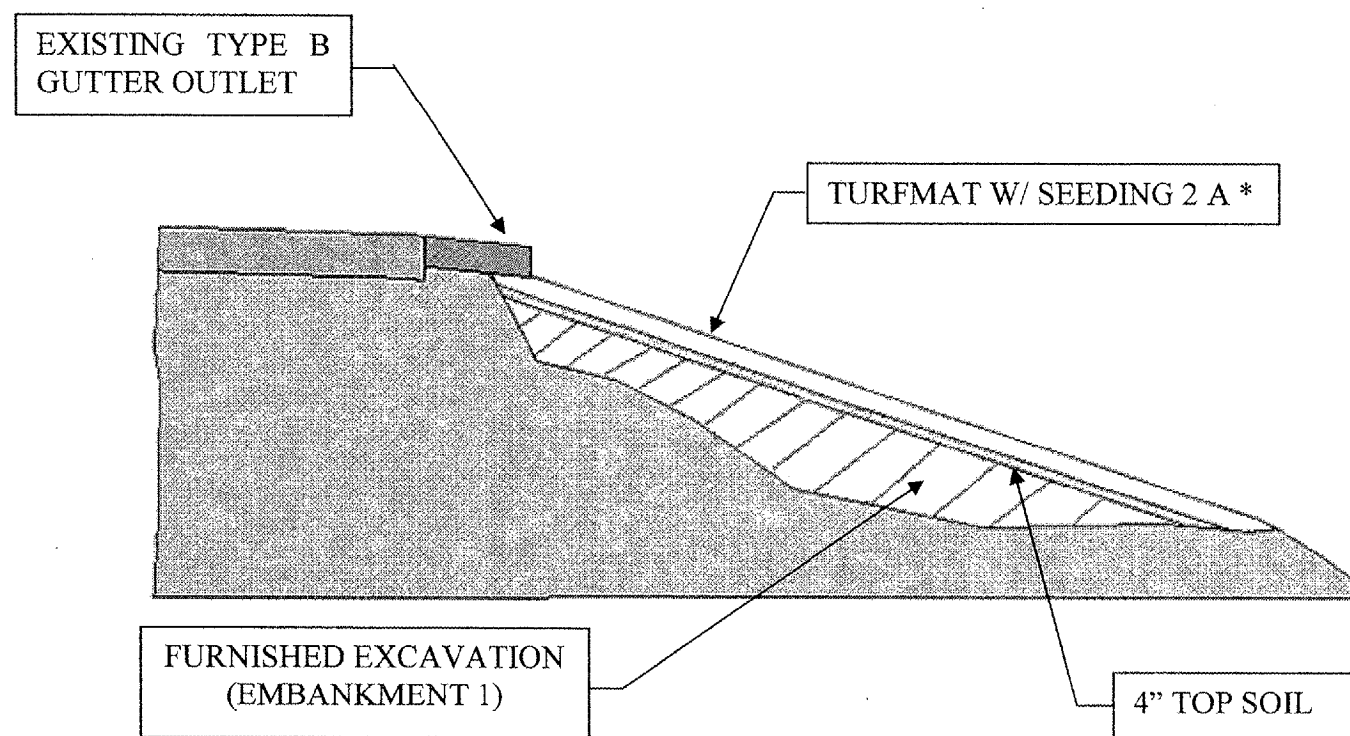

SECTION Fo-Fo
PROPOSED

FOR SECTION F1-F1 SEE SHEET 10 OF 11
SEE TURMAT INSTALLATION ON SHEET 6 OF 11
* FERTILIZER OMITTED INTENTIONALLY

ILLINOIS DEPARTMENT OF TRANSPORTATION
LOCATION 1
I-290 AT US 12/20/45
AREA F

ROUTE	SECTION	COUNTY	TOTAL SHEETS	SHEET NUMBER
FAI 290 & FAP 339	2007-006I	COOK	23	13

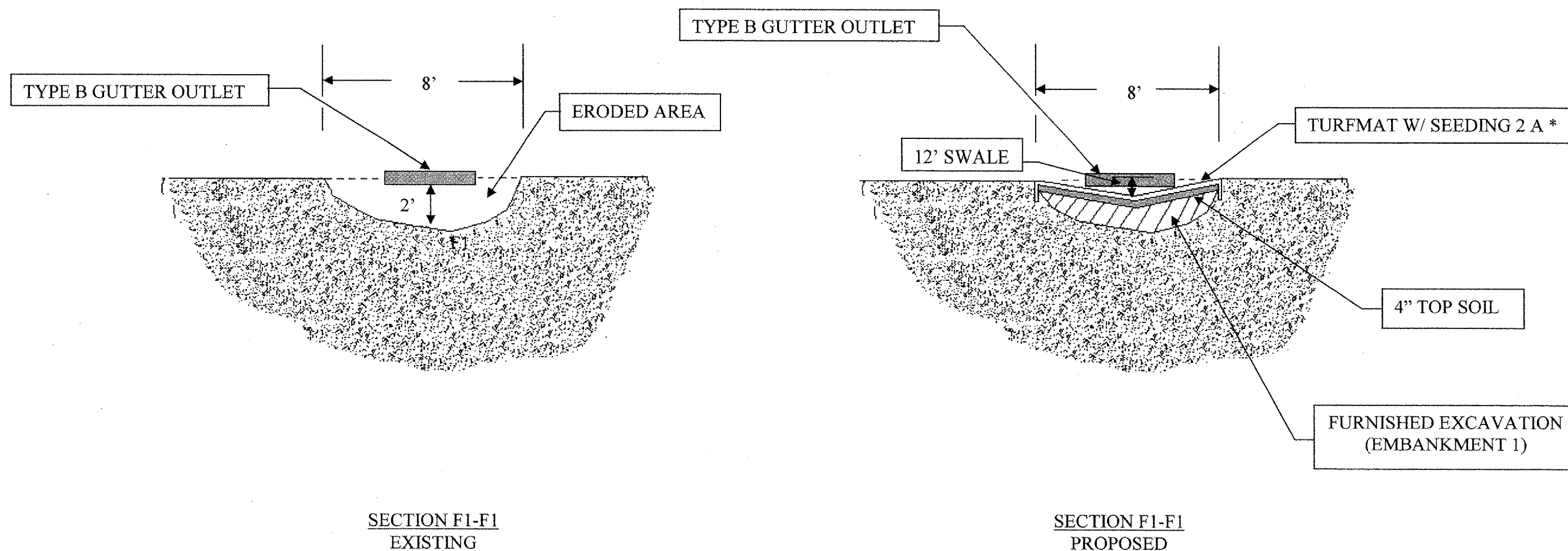

SEE TURMAT INSTALLATION ON SHEET 6 OF 11

* FERTILIZER OMITTED INTENTIONALLY

ILLINOIS DEPARTMENT OF TRANSPORTATION

LOCATION 1
 I-290 AT US 12/20/45
 AREA F
 SECTION F1-F1

ROUTE	SECTION	COUNTY	TOTAL SHEETS	SHEET NUMBER
FAI 290 & FAP 339	2007-006I	COOK	23	14

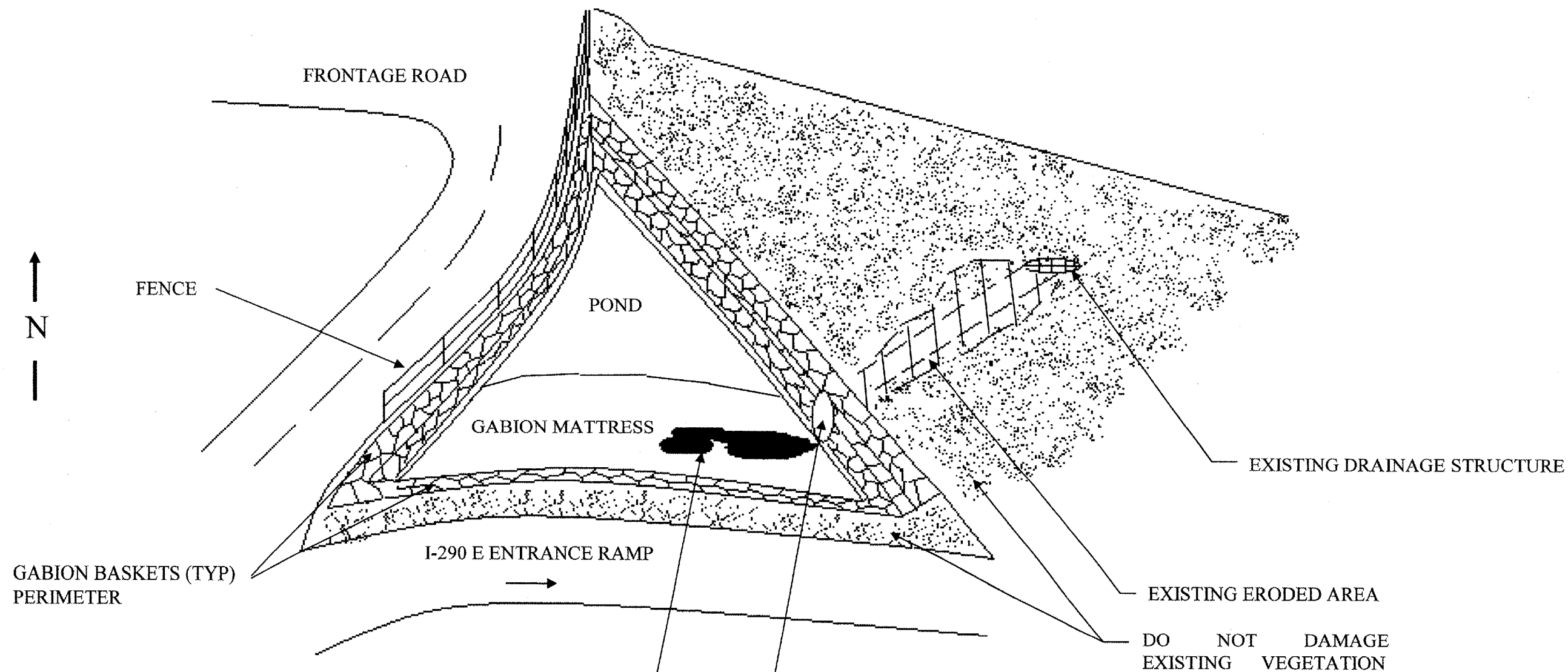

DIRT ERODED FROM TOP TO BE HAND SHOVELED BACK UP IN ERODED AREA. INCLUDED IN COST OF EARTH EXCAVATION (± 1 CU YD)

EXISTING 18" DIA. PCC PIPE PLUGGED W/ CONCRETE AT END. REMOVE CONCRETE PLUG. INCLUDED IN COST OF EARTH EXCAVATION

ILLINOIS DEPARTMENT OF
TRANSPORTATION

LOCATION 1
I-290 AT US 12/20/45
AREA G

ROUTE	SECTION	COUNTY	TOTAL SHEETS	SHEET NUMBER
FAI 290 & FAP 339	2007-006I	COOK	23	15

CONTRACT 60C37

SHEET 1 OF 7

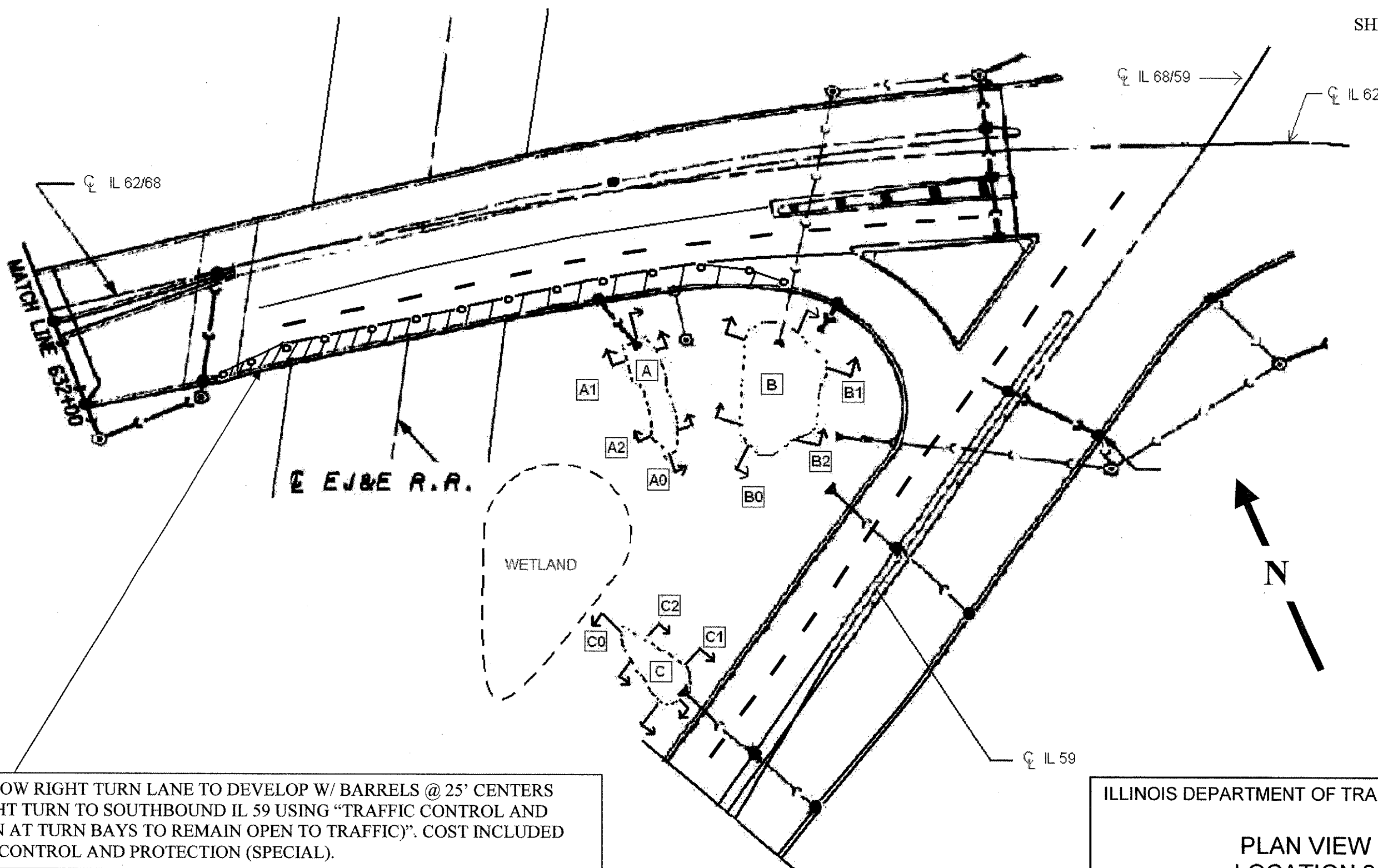

DO NOT ALLOW RIGHT TURN LANE TO DEVELOP W/ BARRELS @ 25' CENTERS
 ALLOW RIGHT TURN TO SOUTHBOUND IL 59 USING "TRAFFIC CONTROL AND
 PROTECTION AT TURN BAYS TO REMAIN OPEN TO TRAFFIC". COST INCLUDED
 W/ TRAFFIC CONTROL AND PROTECTION (SPECIAL).

WHERE [A] , [B] & [C] REPRESENTS IMPROVEMENT AREAS

ILLINOIS DEPARTMENT OF TRANSPORTATION

PLAN VIEW
 LOCATION 2
 IL 62 AT IL 59

ROUTE	SECTION	COUNTY	TOTAL SHEETS	SHEET NUMBER
FAI 290 & FAP 339	2007-006I	COOK	23	16

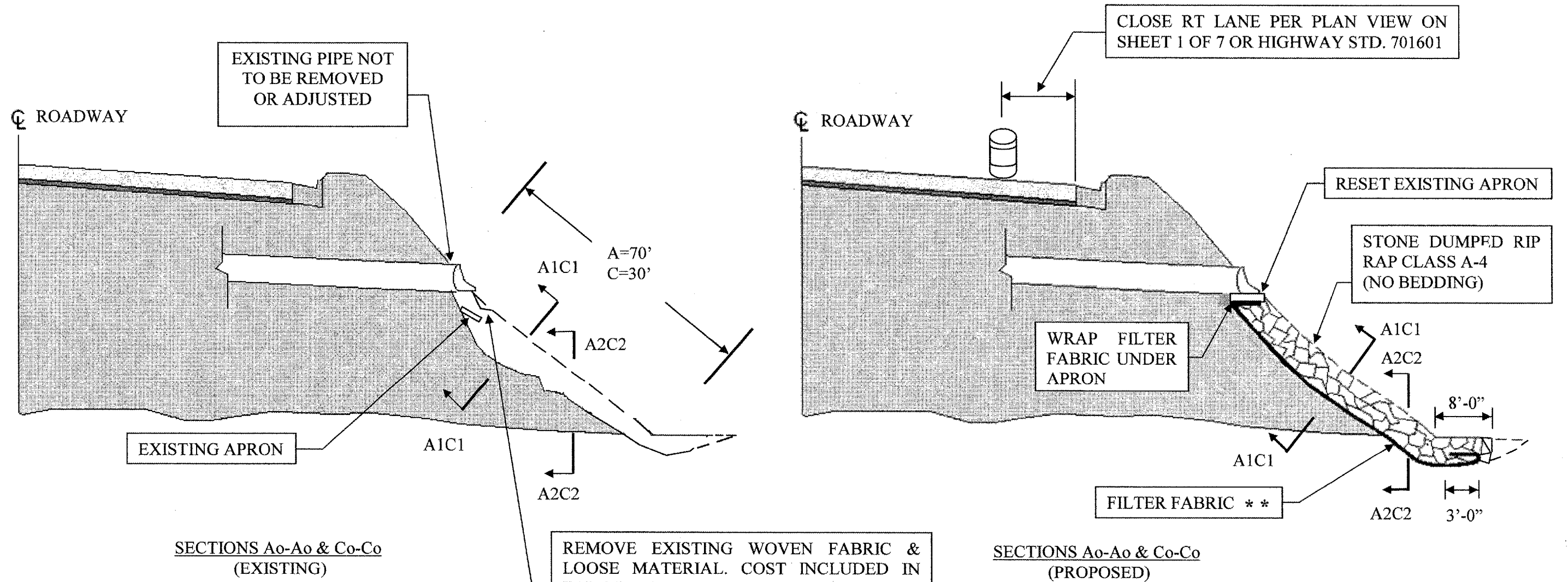

SECTIONS Ao-Ao & Co-Co (EXISTING)

SECTIONS Ao-Ao & Co-Co (PROPOSED)

REMOVE EXISTING WOVEN FABRIC & LOOSE MATERIAL. COST INCLUDED IN EARTH EXCAVATION (\pm 1 CU. YD) REGRADE AS REQUIRED TO HAVE FAIRLY SMOOTH SURFACE TO LAY NEW FILTER FABRIC *

- * COST INCLUDED IN THE COST OF "STONE DUMPED RIP RAP CLASS A4"
- ** RUN FABRIC WITH LONGITUDINAL AXIS UP AND DOWN HILL. ALL LAPS MUST BE PERPENDICULAR TO THE FLOW LINE WITH THE HIGHER PIECE OVERLAPPING THE LOWER PIECE BY 12" MINIMUM.

ILLINOIS DEPARTMENT OF TRANSPORTATION
 LOCATION 2
 IL 62 AT IL 59
 AREAS A & C
 SECTIONS Ao-Ao & Co-Co

ROUTE	SECTION	COUNTY	TOTAL SHEETS	SHEET NUMBER
FAI 290 & FAP 339	2007-006I	COOK	23	17

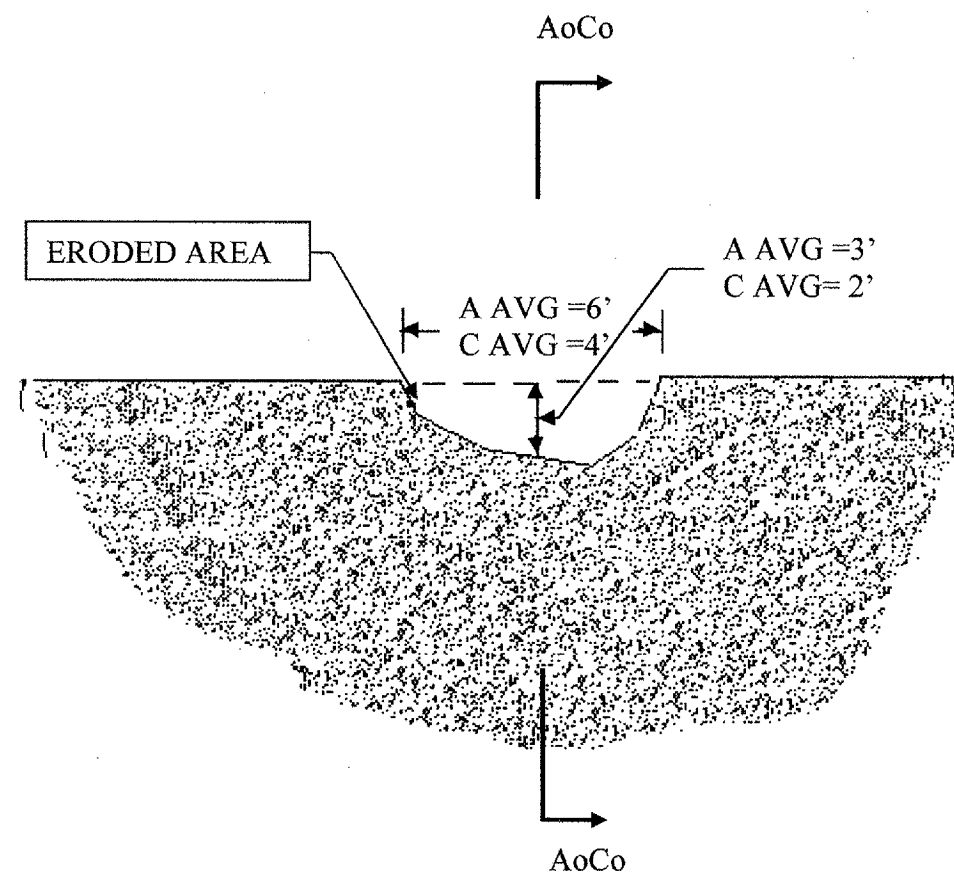

SECTIONS A1-A1 & C1-C1
(EXISTING)

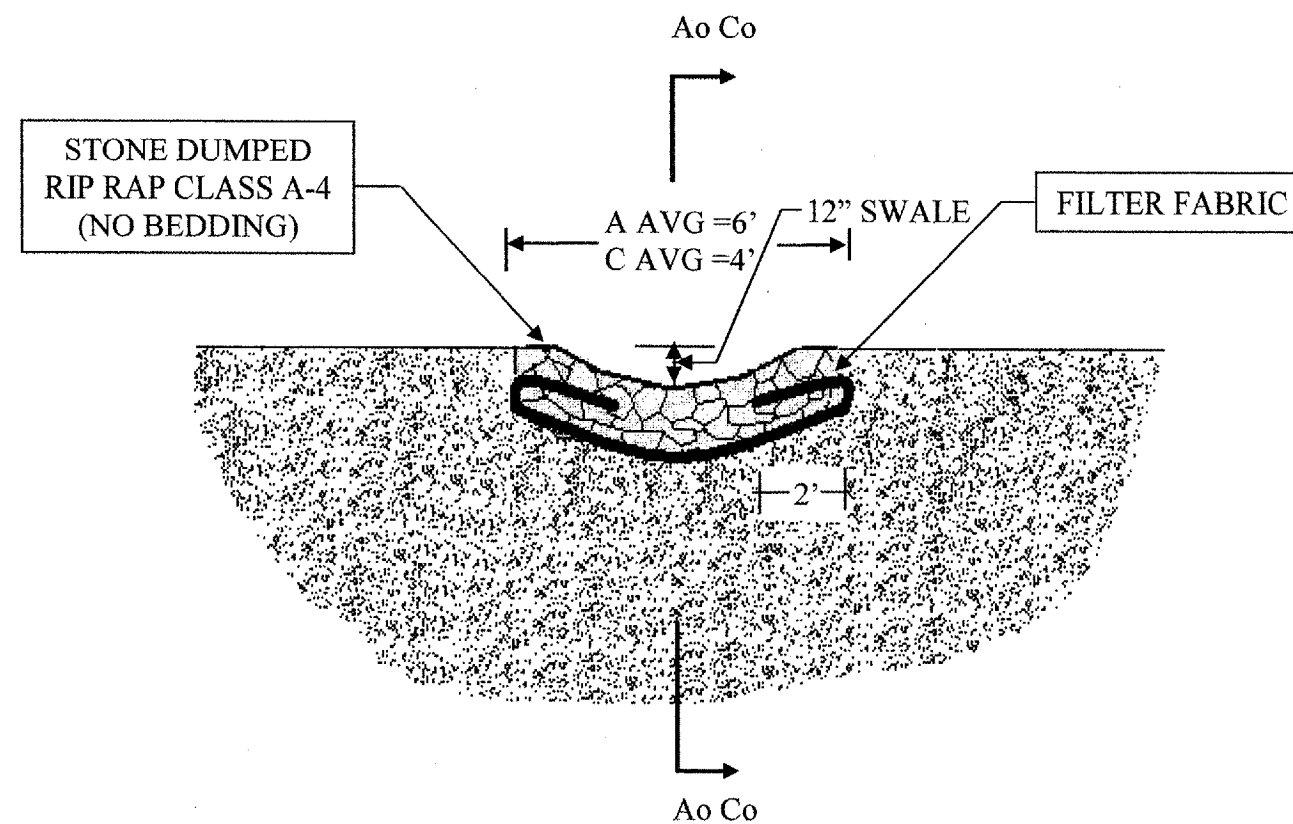

SECTIONS A1-A1 & C1-C1
(PROPOSED)

ILLINOIS DEPARTMENT OF
TRANSPORTATION

LOCATION 2
IL 62 AT IL 59
AREAS A & C
SECTION A1-A1 & C1-C1

ROUTE	SECTION	COUNTY	TOTAL SHEETS	SHEET NUMBER
FAI 290 & FAP 339	2007-006I	COOK	23	18

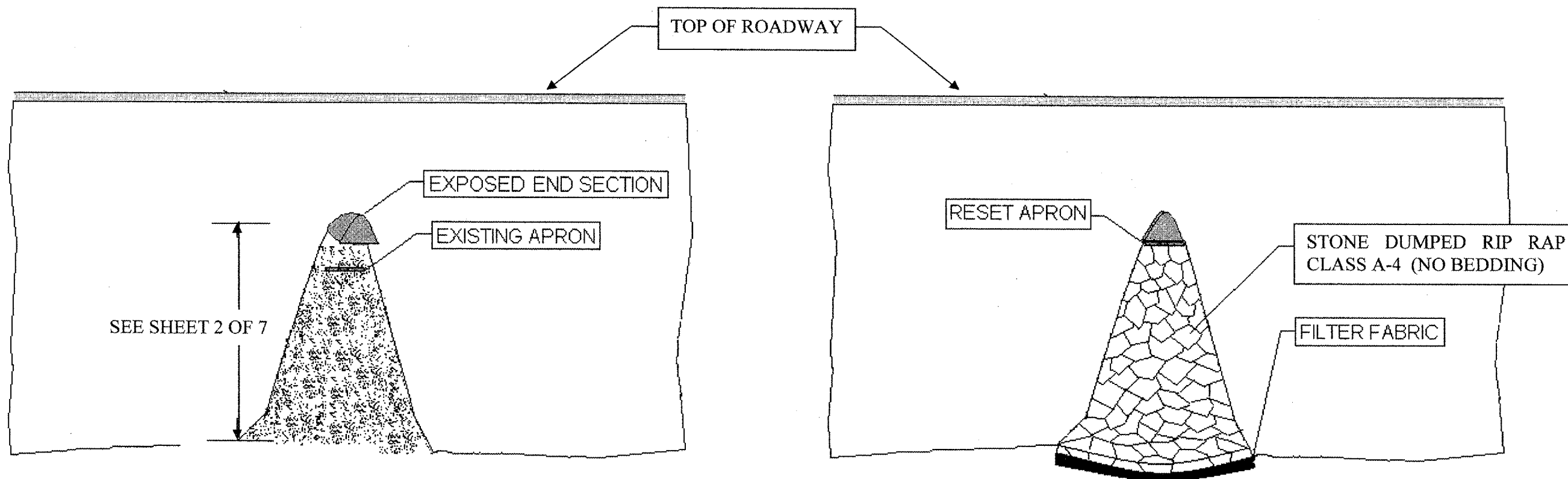

VIEWS A2-A2 & C2-C2
(EXISTING)

VIEWS A2-A2 & C2-C2
(PROPOSED)

ILLINOIS DEPARTMENT OF
TRANSPORTATION

LOCATION 2
IL 62 AT IL 59
AREAS A & C
VIEWS A2-A2 & C2-C2

ROUTE	SECTION	COUNTY	TOTAL SHEETS	SHEET NUMBER
FAI 290 & FAP 339	2007-0061	COOK	23	19

CLOSE RT LANE PER PLAN VIEW ON SHEET 1 OF 7

☉ IL RT 62/68

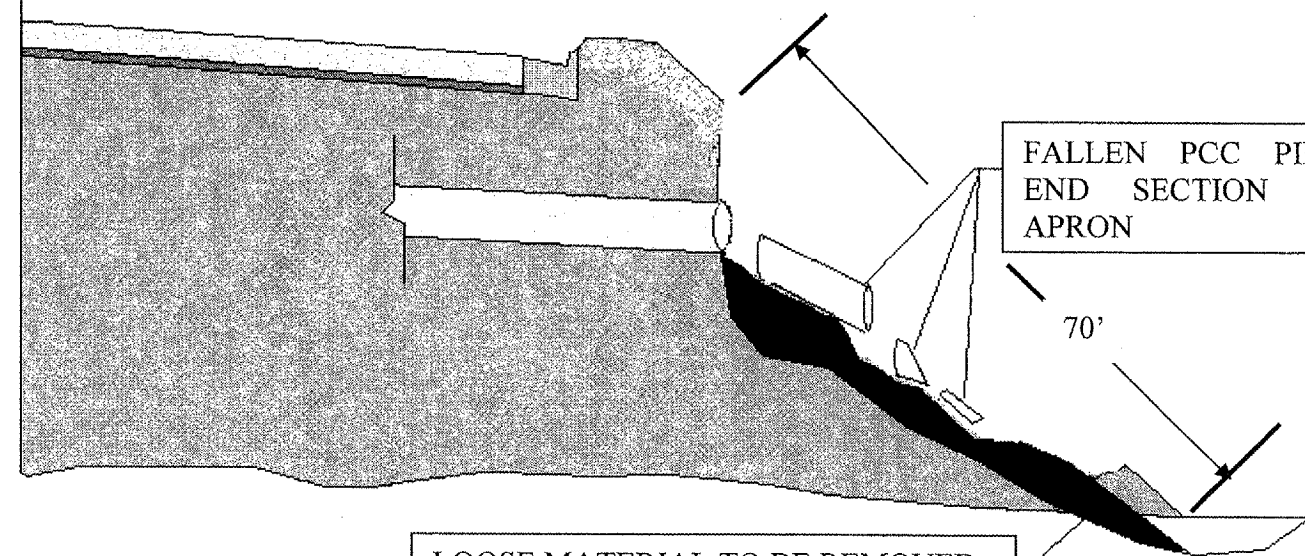

FALLEN PCC PIPE, END SECTION AND APRON

70'

LOOSE MATERIAL TO BE REMOVED
COST INCLUDED IN EARTH
EXCAVATION (± 5 CU YRDS)

SECTION Bo-Bo
(EXISTING)

☉ IL RT 62/68

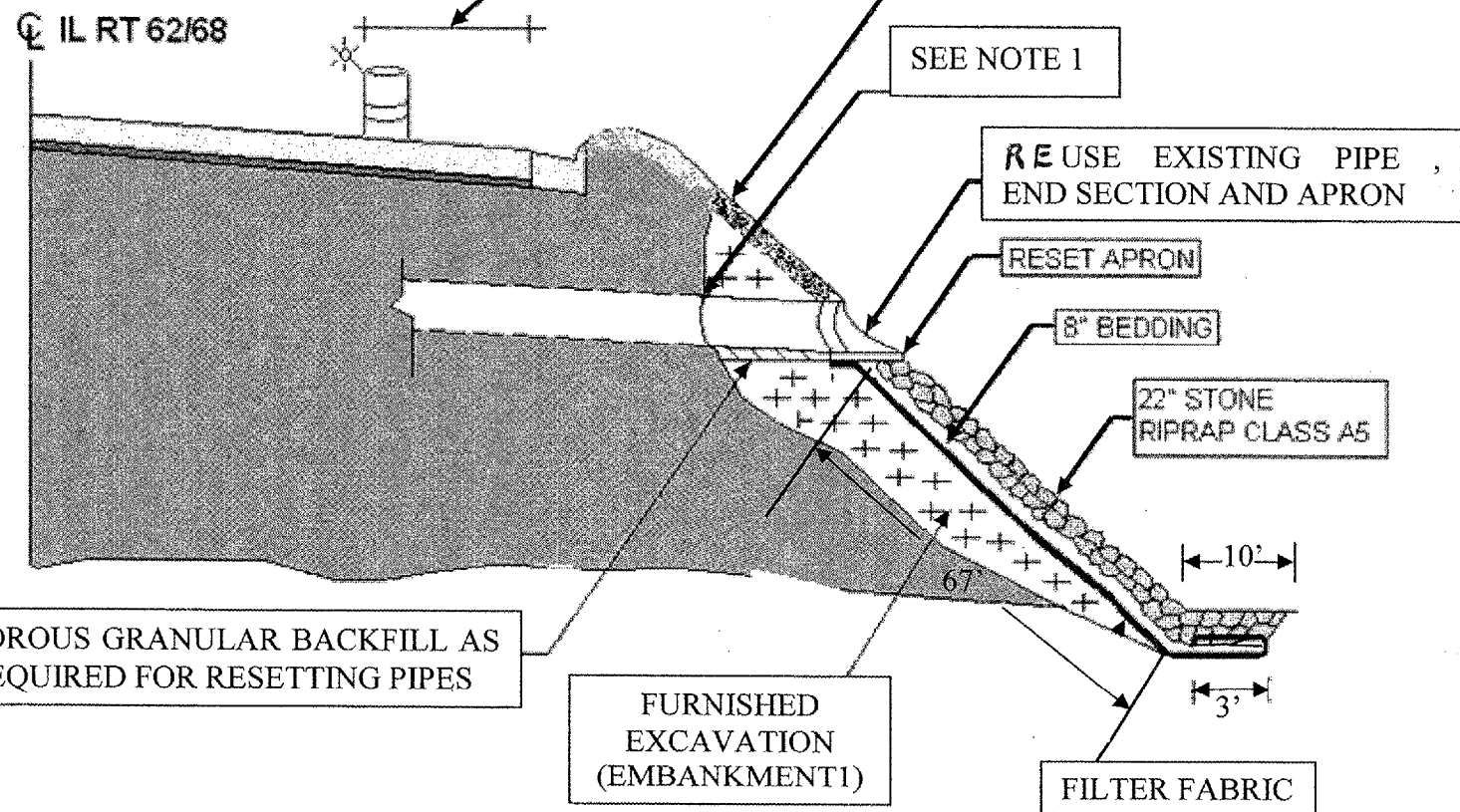

4" TOPSOIL W/ 2A SEEDING *

SEE NOTE 1

RE USE EXISTING PIPE, END SECTION AND APRON

RESET APRON

8" BEDDING

22" STONE RIPRAP CLASS A5

10'

3'

FILTER FABRIC

POROUS GRANULAR BACKFILL AS
REQUIRED FOR RESETTING PIPES

FURNISHED
EXCAVATION
(EMBANKMENT1)

NOTE 1: WRAP PIPE JOINTS WITH 2'
STRIPS FILTER FABRIC (SECURED IN
PLACE)

* INCLUDES EROSION CONTROL BLANKET
FERTILIZER INTENTIONALLY OMITTED

SECTION Bo-Bo
(PROPOSED)

ILLINOIS DEPARTMENT OF
TRANSPORTATION

LOCATION 2
IL 62 AT IL 59
AREA B
SECTION Bo-Bo

Rev.

ROUTE	SECTION	COUNTY	TOTAL SHEETS	SHEET NUMBER
FAI 290 & FAP 339	2007-006I	COOK	23	20

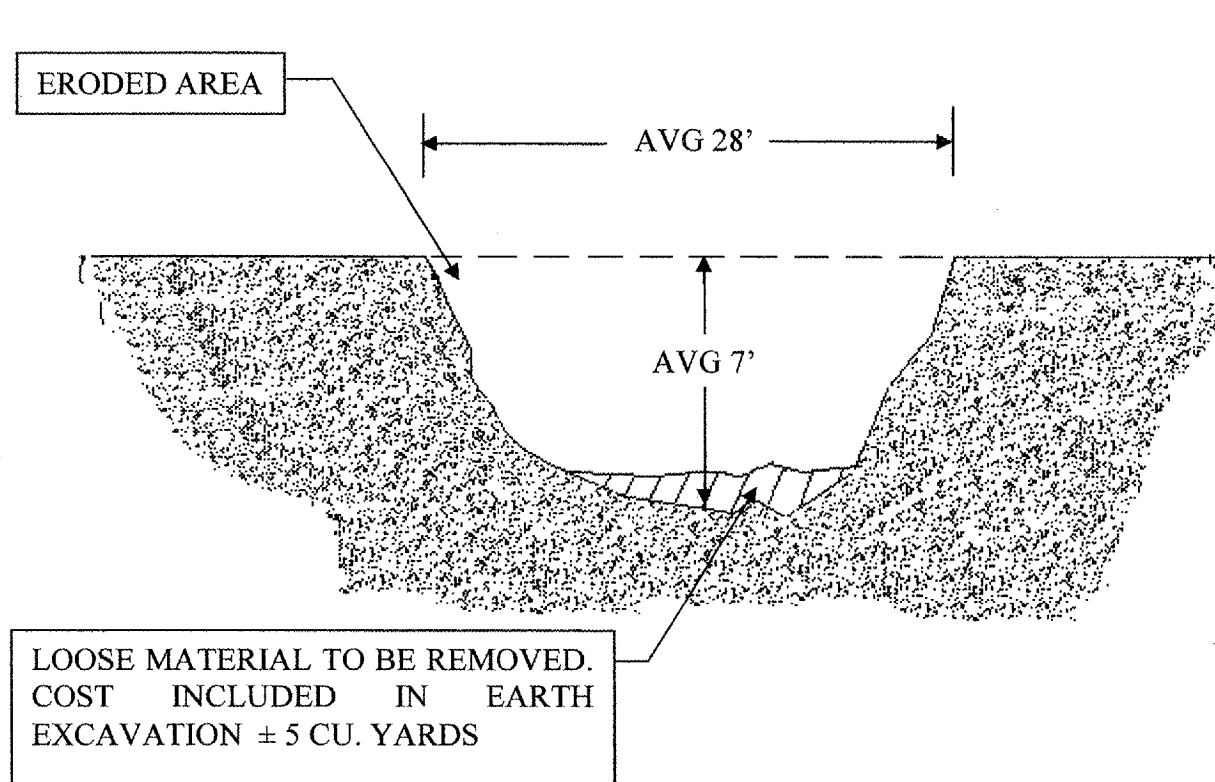

SECTION B2-B2
(EXISTING)

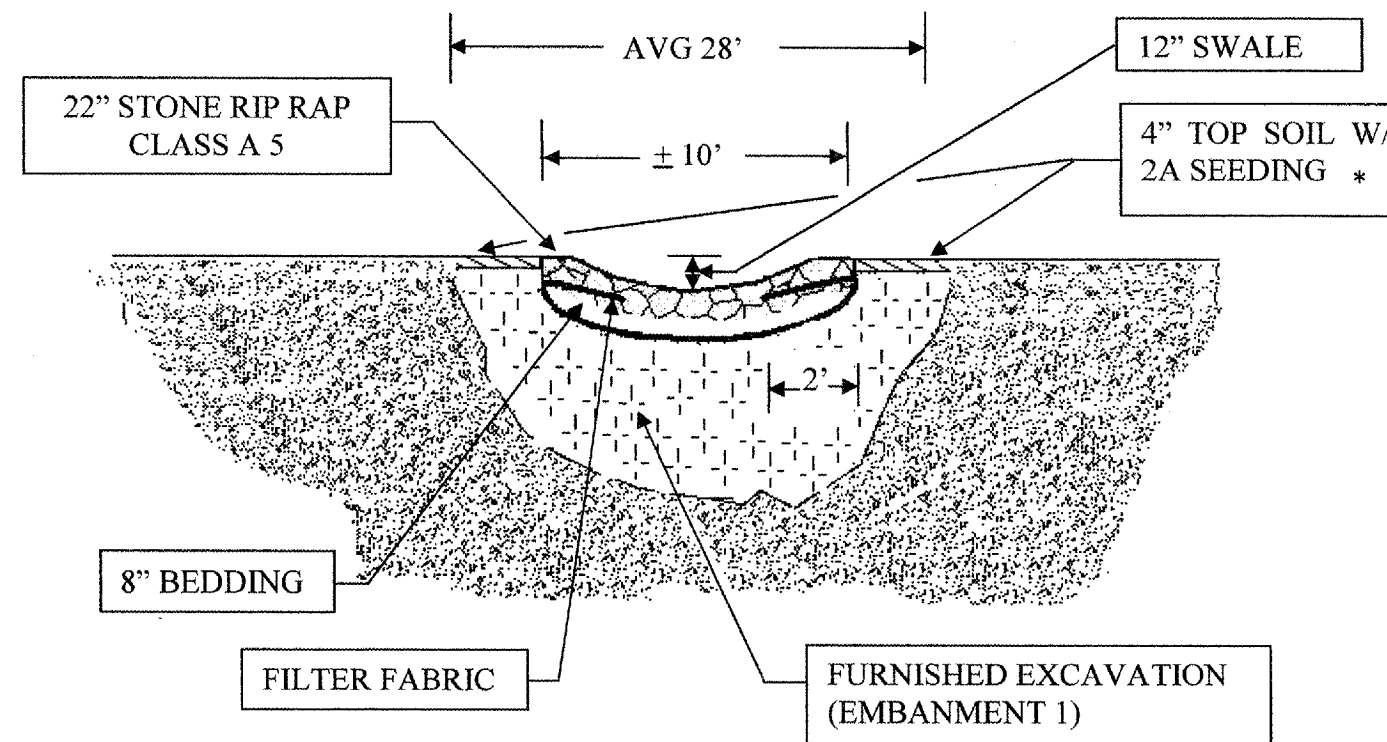

SECTION B2-B2
(PROPOSED)

ILLINOIS DEPARTMENT OF
TRANSPORTATION

LOCATION 2
IL 62 AT IL 59
AREA B
SECTION B2-B2

ROUTE	SECTION	COUNTY	TOTAL SHEETS	SHEET NUMBER
FAI 290 & FAP 339	2007-006I	COOK	23	21

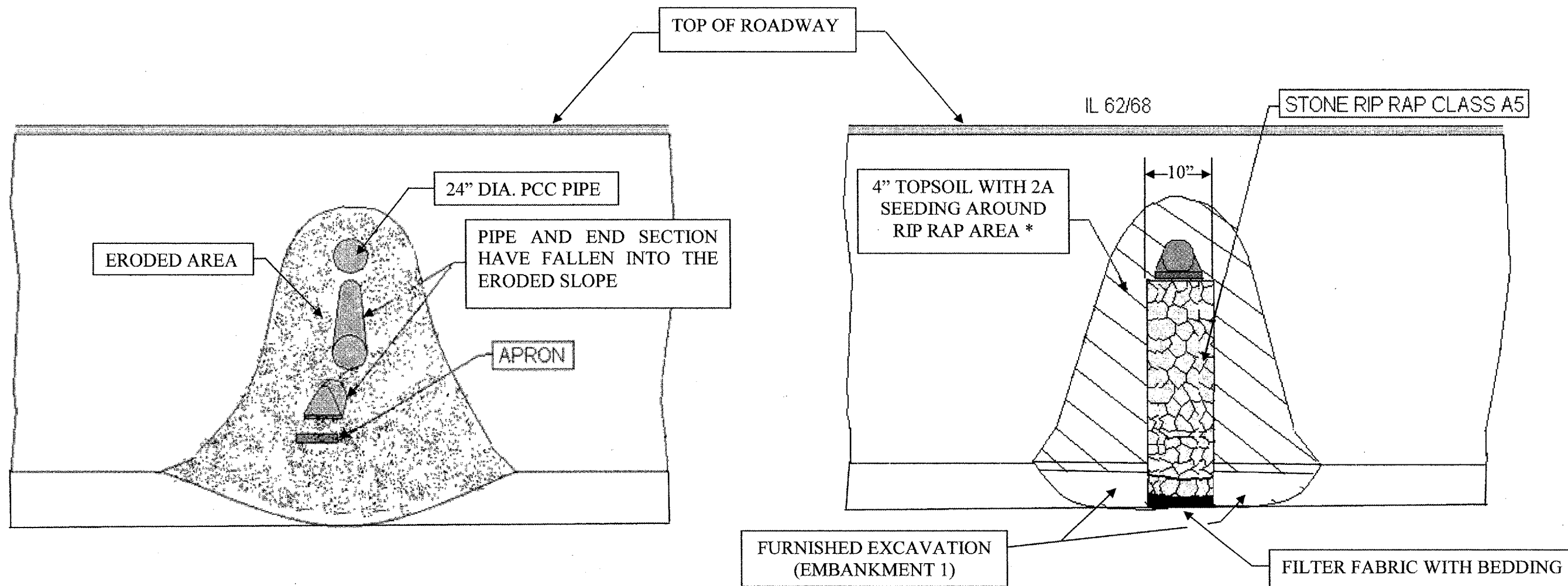

VIEW B2-B2
(EXISTING)

VIEW B2-B2
(PROPOSED)

* INCLUDES EROSION CONTROL BLANKET
FERTILIZER INTENTIONALLY OMITTED

ILLINOIS DEPARTMENT OF
TRANSPORTATION

LOCATION 2
IL 62 AT IL 59
AREA B
VIEW B2-B2



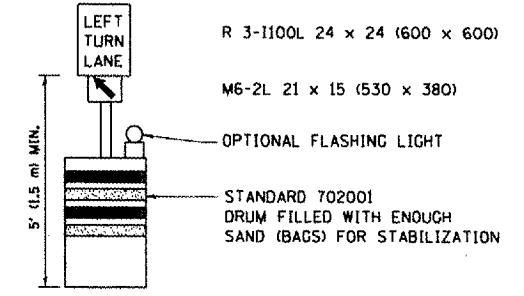
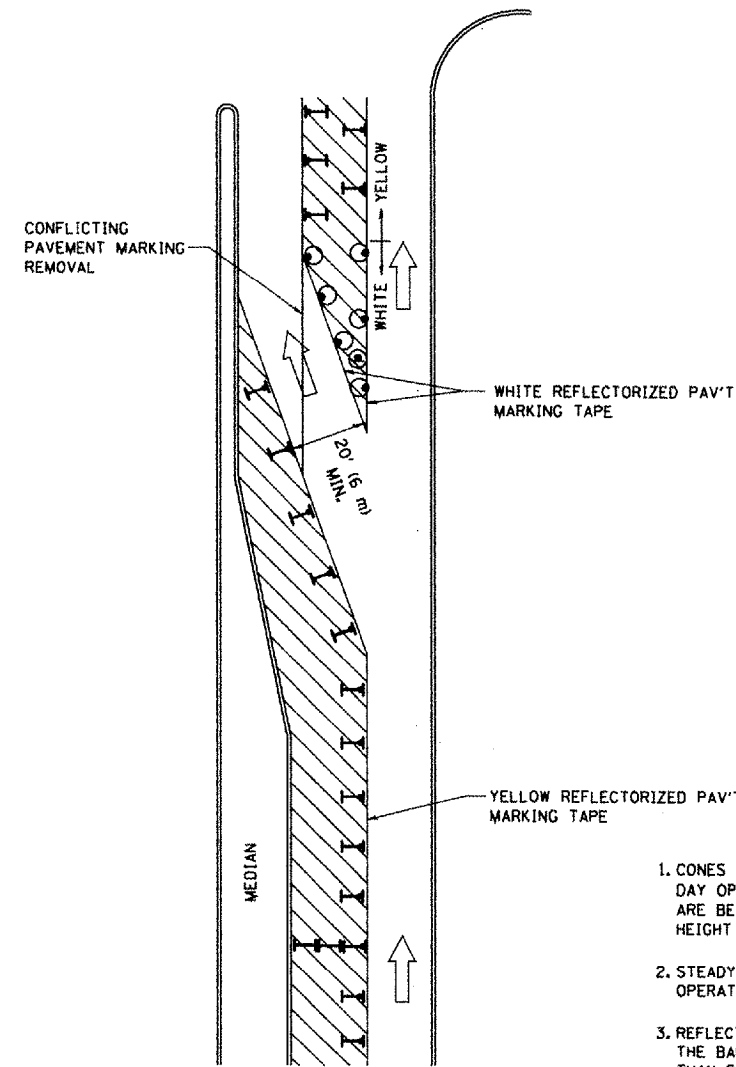

CONTRACT NO.				
F.A. RTE.	SECTION	COUNTY	TOTAL SHEETS	SHEET NO.
2-294 2-333	2007-0061	COOK	23	22
STA.		TO STA.		
FED. ROAD DIST. NO.	ILLINOIS	FED. AID PROJECT		

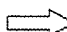

GENERAL NOTES

1. CONES MAY BE SUBSTITUTED FOR BARRICADES OR DRUMS AT HALF THE SPACING DURING DAY OPERATIONS. CONES SHALL BE A MINIMUM OF 28 (710) IN HEIGHT. WHEN CONES ARE BEING USED, THE "LEFT TURN LANE" SIGN MAY BE SKID MOUNTED AT A MINIMUM HEIGHT OF 5' (1.5 m).
2. STEADY BURNING LIGHTS WILL NOT BE REQUIRED ON BARRICADES OR DRUMS FOR DAY OPERATIONS. ALL LIGHTS SHALL BE MONODIRECTIONAL.
3. REFLECTORIZED TEMPORARY PAVEMENT MARKING TAPE SHALL BE PLACED THROUGHOUT THE BARRICADED AREA OF EACH TURN BAY WHERE THE CLOSURE TIME IS GREATER THAN FOURTEEN DAYS.
4. THIS APPLICATION ALSO APPLIES WHEN WORK IS BEING PERFORMED IN THE RIGHT LANE(S) AND THE RIGHT TURN BAY IS TO REMAIN OPEN. UNDER THIS CONDITION, "RIGHT TURN LANE" R3-100 24 x 24 (600 x 600) AND M6-2R 21 x 15 (530 x 380) SHALL BE USED.
5. THESE CONTROLS SHALL SUPPLEMENT MAINLINE TRAFFIC CONTROL FOR LANE CLOSURES.
6. LONGITUDINAL DIMENSIONS MAY BE ADJUSTED TO FIT FIELD CONDITIONS.
7. FORM BT 725 IS REQUIRED.
8. TRAFFIC CONTROL AND PROTECTION AT TURN BAYS (TO REMAIN OPEN TO TRAFFIC) SHALL BE INCLUDED IN THE COST SPECIFIED TRAFFIC CONTROL STANDARDS OR ITEMS.

LEGEND

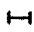
-  WORK AREA
-  LANE OPEN TO TRAFFIC
-  TYPE I OR II BARRICADE WITH STEADY BURN LIGHT
-  DRUM WITH STEADY BURN LIGHT
-  DRUM WITH SIGN (WITH OPTIONAL FLASHING LIGHT) SEE DETAIL
-  TYPE I OR II CHECK BARRICADE WITH FLASHING LIGHT

All dimensions are in inches (millimeters) unless otherwise shown.

REVISIONS	
NAME	DATE
T. RAMMACHER	09/08/94
A. HOUSEH	11/07/95
A. HOUSEH	10/12/96
T. RAMMACHER	01/06/00

ILLINOIS DEPARTMENT OF TRANSPORTATION
**TRAFFIC CONTROL AND PROTECTION
 AT TURN BAYS
 (TO REMAIN OPEN TO TRAFFIC)**

SCALE: NONE

DRAWN BY
 CHECKED BY LHA
 TC-14

PLOT DATE: 3/16/2007
 FILE NAME: R311001.dwg
 PLOT SCALE: 1/8" = 1'-0"
 USER NAME: baurndt

PARTIAL RAMP CLOSURE DETAILS

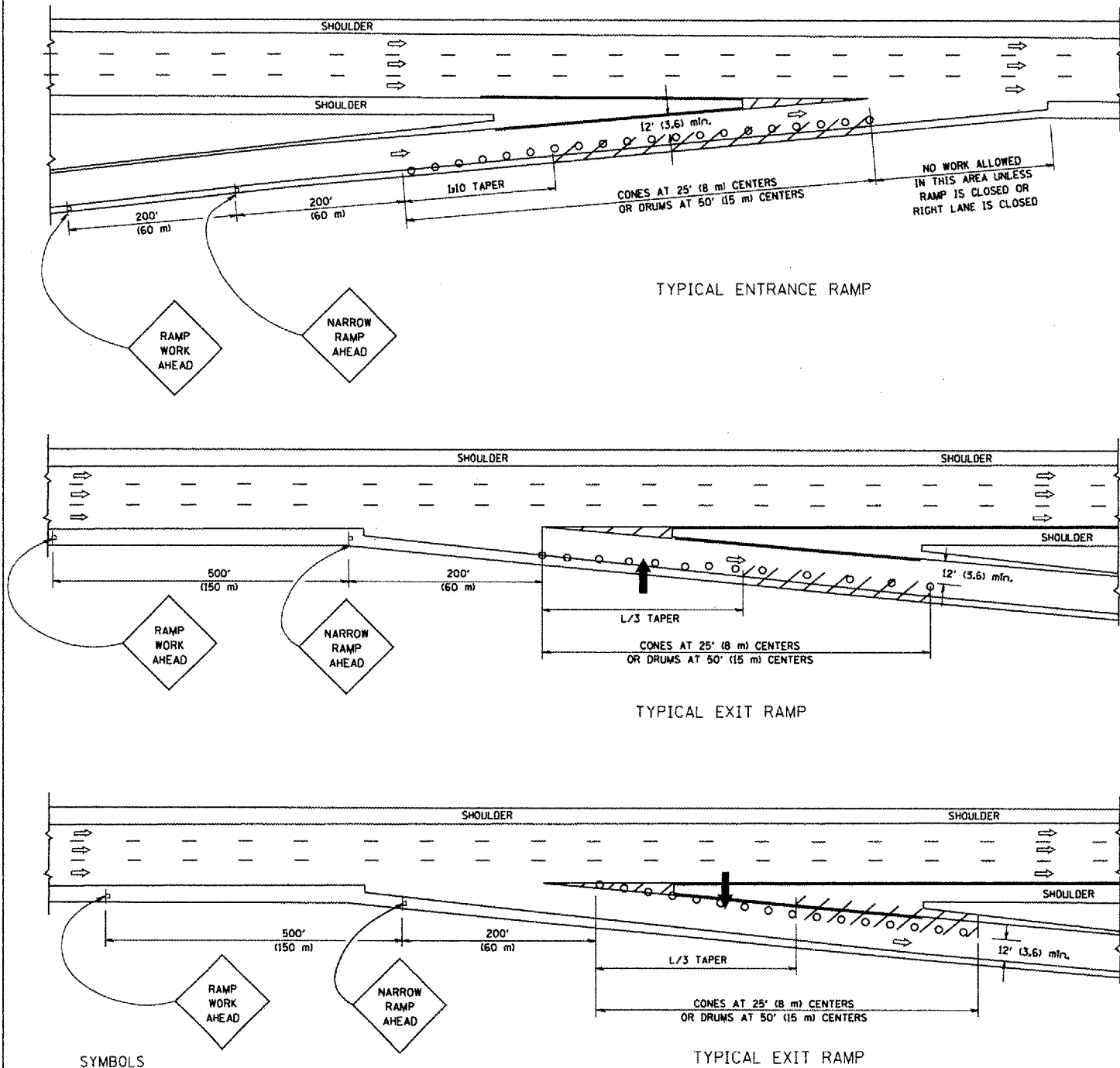

SYMBOLS

- ARROWBOARD
- WORK AREA
- SIGN ON PORTABLE OR PERMANENT SUPPORT
- FLAGGER WITH CONTROL SIGN
- TYPE II BARRICADE, DRUM OR VERTICAL BARRICADE WITH STEADY BURN MONO-DIRECTIONAL LIGHT
- CONE, DRUM OR BARRICADE

GENERAL NOTES

1. THE "L" DISTANCE EQUALS:

SPEED LIMIT	FORMULAS
45 mph (80 km/h) OR GREATER	METRIC: $L=0.65(W)(S)$ ENGLISH: $L=(W)(S)$

W = WIDTH OF OFFSET IN FEET (METERS)
S = NORMAL POSTED SPEED MPH (KM/H)
2. PLASTIC DRUMS WITH HIGH PERFORMANCE REFLECTIVE SHEETING AND STEADY BURNING LIGHTS ARE REQUIRED FOR ALL NIGHTTIME CLOSURES.
3. ALL SIGNS SHALL BE POST MOUNTED IF THE CLOSURE TIME EXCEEDS FOUR DAYS.
4. FLASHING LIGHTS SHALL BE USED DURING THE HOURS OF DARKNESS AND SHALL BE INSTALLED ABOVE THE FIRST TWO SETS OF SIGNS.

SHOULDER CLOSURE DETAILS

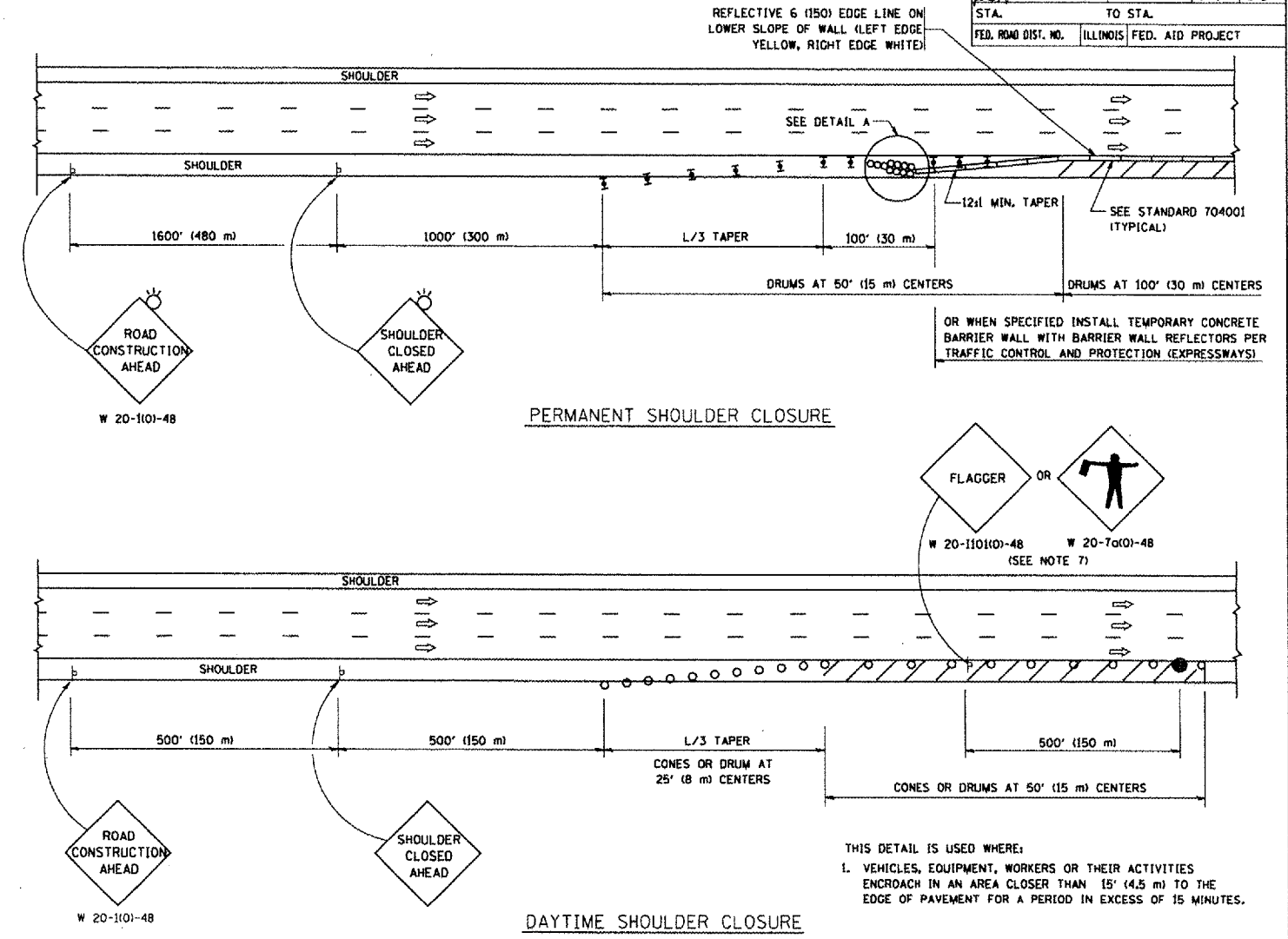

DAYTIME SHOULDER CLOSURE

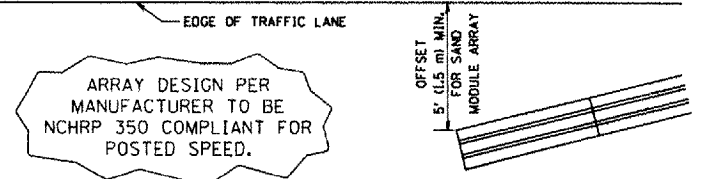

DETAIL "A"
IMPACT ATTENUATOR, TEMPORARY
(SEE NOTE 5)

5. THE IMPACT ATTENUATOR, TEMPORARY IS NOT REQUIRED WHEN THE TEMPORARY CONCRETE BARRIER WALL IS PROTECTED BY OR IS TIED INTO THE EXISTING GUARDRAIL. IF OFFSET IS LESS THAN 5 FEET USE "TRAFFIC BARRIER TERMINAL, TYPE III, TEMPORARY" DEVICE TO MEET NCHRP350 FOR POSTED SPEED.
6. AUTHORIZATION FROM THE DISTRICT'S BUREAU OF TRAFFIC IS REQUIRED FOR ALL FREEWAY CLOSURES.
7. THE FLAGGER AND FLAGGER SIGN ARE REQUIRED AT THE ABOVE WORK SITES WHEN:
 - a. FOUR OR MORE WORK VEHICLES ENTER THE TRAFFIC LANES IN A ONE HOUR PERIOD.
 - b. THE WORK ACTIVITY REQUIRES FREQUENT ENCROACHMENT INTO THE LANE OPEN TO TRAFFIC.
 THE FLAGGER SHALL BE STATIONED APPROXIMATELY 100' (30 m) TO 200' (60 m) IN ADVANCE OF THE WORKERS.

ALL DIMENSIONS ARE IN INCHES (MILLIMETERS) UNLESS OTHERWISE SHOWN.

REVISIONS	
NAME	DATE
DWS	11/96
JAF	12/02
NCHRP 350	04/03
JAF	2/06
SPB	1/07

ILLINOIS DEPARTMENT OF TRANSPORTATION
**TRAFFIC CONTROL DETAILS
 FOR FREEWAY
 SHOULDER CLOSURES
 PARTIAL RAMP CLOSURES**
 DESIGNED BY: DWS
 DRAWN BY:
 CHECKED BY:
 TC-17