

F.A.I. RTE.	SECTION	COUNTY	TOTAL SHEETS	SHEET NO.
55	99-1 AC-RS-3	WILL	14	5
STA.		TO STA.		
FED. ROAD DIST. NO.		ILLINOIS FED. AID PROJECT		
CONTRACT NO.: 60C58				

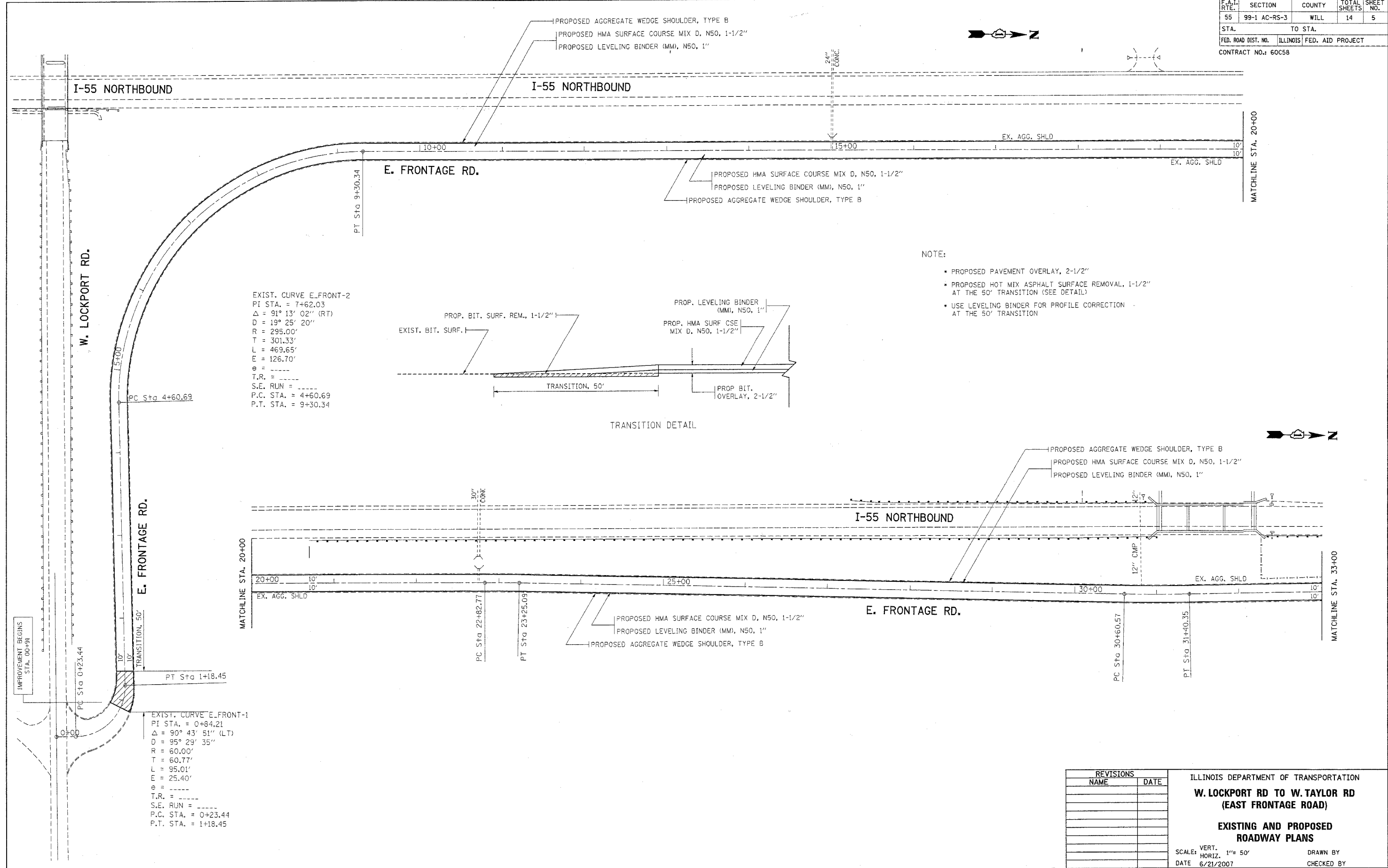

EXIST. CURVE E\_FRONT-2  
 PI STA. = 7+62.03  
 $\Delta = 91^\circ 13' 02''$  (RT)  
 $D = 19^\circ 25' 20''$   
 $R = 295.00'$   
 $T = 301.33'$   
 $L = 469.65'$   
 $E = 126.70'$   
 $\theta = \dots$   
 $T.R. = \dots$   
 $S.E. RUN = \dots$   
 $P.C. STA. = 4+60.69$   
 $P.T. STA. = 9+30.34$

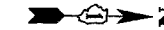
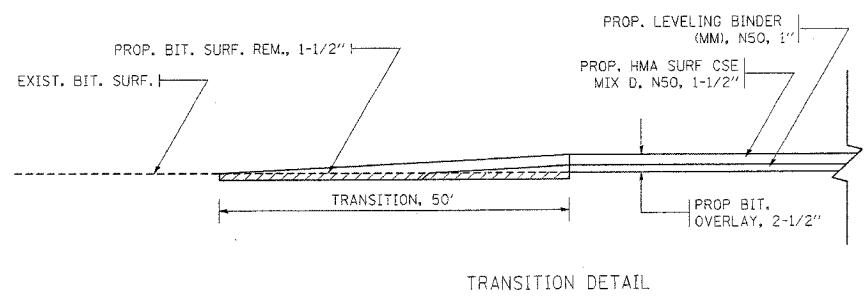

- NOTE:
- PROPOSED PAVEMENT OVERLAY, 2-1/2"
  - PROPOSED HOT MIX ASPHALT SURFACE REMOVAL, 1-1/2" AT THE 50' TRANSITION (SEE DETAIL)
  - USE LEVELING BINDER FOR PROFILE CORRECTION AT THE 50' TRANSITION

EXIST. CURVE E\_FRONT-1  
 PI STA. = 0+84.21  
 $\Delta = 90^\circ 43' 51''$  (LT)  
 $D = 95^\circ 29' 35''$   
 $R = 60.00'$   
 $T = 60.77'$   
 $L = 95.01'$   
 $E = 25.40'$   
 $\theta = \dots$   
 $T.R. = \dots$   
 $S.E. RUN = \dots$   
 $P.C. STA. = 0+23.44$   
 $P.T. STA. = 1+18.45$

REVISIONS	
NAME	DATE

ILLINOIS DEPARTMENT OF TRANSPORTATION  
**W. LOCKPORT RD TO W. TAYLOR RD**  
**(EAST FRONTAGE ROAD)**  
**EXISTING AND PROPOSED**  
**ROADWAY PLANS**  
 SCALE: VERT. 1" = 50'  
 HORIZ. 1" = 50'  
 DATE 6/21/2007  
 DRAWN BY  
 CHECKED BY

PLOT DATE = 6/21/2007  
 FILE NAME = c:\p\proj\04\24187\sh\_rdw.dgn  
 PLOT SCALE = 50.0000 / IN.  
 USER NAME = galsburg