

6060

F.A.I. RTE.	SECTION	COUNTY	TOTAL SHEETS	SHEET NO.
55	99-2 AC-1 RS	WILL	14	1

**STATE OF ILLINOIS**  
**DEPARTMENT OF TRANSPORTATION**  
**DIVISION OF HIGHWAYS**

**PROPOSED**  
**HIGHWAY PLANS**

**FAI 55: I-55 (WEST FRONTAGE ROAD)**  
**LORENZO ROAD TO MURPHY ROAD**  
**SECTION: 99-2 AC-1 RS**  
**RESURFACING (MAINTENANCE)**  
**WILL COUNTY**  
**C-91-246-07**

FOR INDEX OF SHEETS, SEE SHEET NO. 2

IMPROVEMENT IS LOCATED IN  
 UNINCORPORATED WILL COUNTY

TRAFFIC DATA

ADT = NO AVAILABLE DATA  
 POSTED SPEED LIMIT = 35 MPH

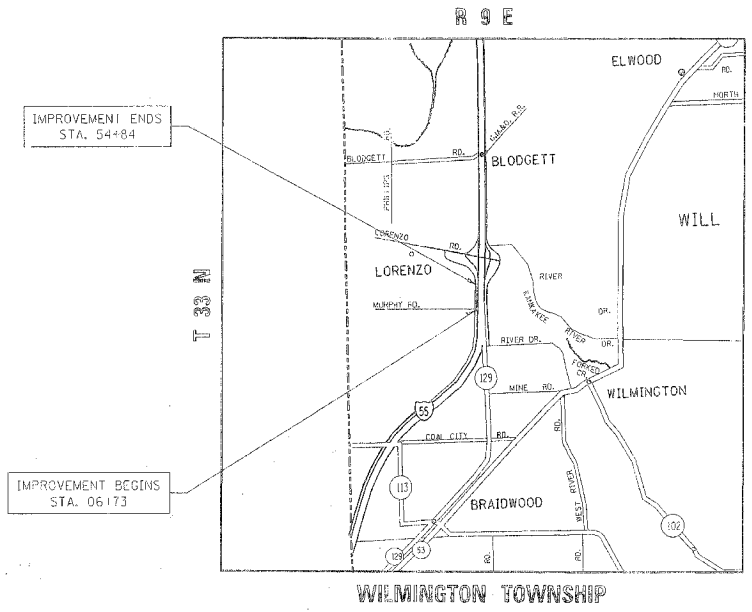
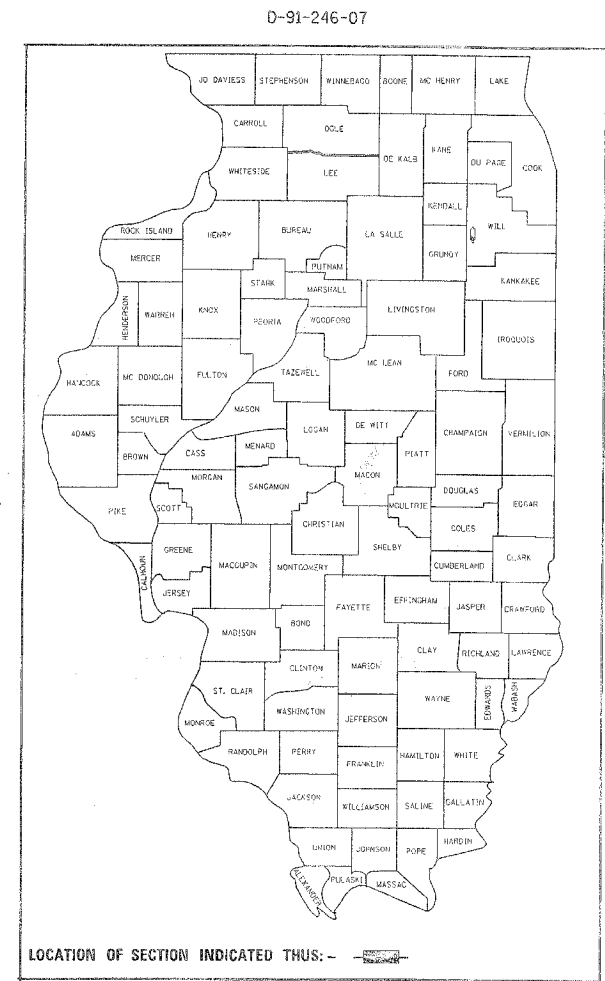

GROSS & NET LENGTH OF IMPROVEMENT = 4811 FEET = 0.91 MILE

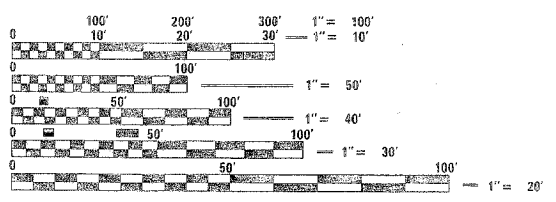

FULL SIZE PLANS HAVE BEEN PREPARED USING STANDARD ENGINEERING SCALES. REDUCED SIZED PLANS WILL NOT CONFORM TO STANDARD SCALES. IN MAKING MEASUREMENTS ON REDUCED PLANS, THE ABOVE SCALES MAY BE USED.

J.U.L.I.E.  
 JOINT UTILITY LOCATION INFORMATION FOR EXCAVATION  
 1-800-892-0123

CONTRACT NO. 60C60

DISTRICT ONE - DESIGN AND PLAN PREPARATION ENGINEER - KEN ENGJ. P. CHANG (847) 705-4432

STATE OF ILLINOIS  
 DEPARTMENT OF TRANSPORTATION  
 DIVISION OF HIGHWAYS

SUBMITTED June 13, 2007

Brian S. [Signature]  
 DEPUTY DIRECTOR OF HIGHWAYS, REGION ENGINEER

June 29, 2007  
Eric E. [Signature]  
 ENGINEER OF DESIGN AND ENVIRONMENT

June 29, 2007  
Milton R. [Signature]  
 DIRECTOR OF HIGHWAYS, CHIEF ENGINEER

**PRINTED BY THE AUTHORITY  
 OF THE STATE OF ILLINOIS**