

F.A.I. RTE.	SECTION	COUNTY	TOTAL SHEETS	SHEET NO.
94	2003-071 RS	COOK	91	37
STA. 432+00		TO STA. 447+00		
FED. ROAD DIST. NO. 7 ILLINOIS		FED. AID PROJECT		

- ① PR CB, T-C, (2' DIA.) W/ T24 F&G
STA. 443+82.31
RIM EL = 615.82
INV EL = 612.49*
- ② EX CB, T-A, (4' DIA.) W/ T24 F&G
STA. 443+92.31
RIM EL = 615.79
INV EL = 612.29*
- ③ EX CB, T-A, (4' DIA.) W/ T24 F&G
STA. 444+01.43
RIM EL = 615.94
INV EL = 612.39*
- ④ EX CB, T-A, (4' DIA.) W/ T24 F&G
STA. 443+75.93
RIM EL = 615.89
INV EL = 612.39
- ⑤ EX CB, T-A, (4' DIA.) W/ T24 F&G
STA. 443+84.90
RIM EL = 615.85
INV EL = 612.35*
- ⑥ PR CB, T-C, (2' DIA.) W/ T24 F&G
STA. 443+94.90
RIM EL = 616.00
INV EL = 612.55*
- ⑦ PR CB, T-C, (2' DIA.) W/ T24 F&G
STA. 445+50.00
RIM EL = 617.35*
INV EL = 613.24*
- ⑧ EX CB, T-A, (4' DIA.) W/ T24 F&G
STA. 445+60.00
RIM EL = 617.44*
INV EL = 613.04*
- ⑨ PR CB, T-C, (2' DIA.) W/ T24 F&G
STA. 445+70.00
RIM EL = 617.53*
INV EL = 613.24*
- ⑩ PR CB, T-C, (2' DIA.) W/ T24 F&G
STA. 445+50.00
RIM EL = 617.35*
INV EL = 613.24*
- ⑪ EX CB, T-A, (4' DIA.) W/ T24 F&G
STA. 445+60.00
RIM EL = 617.44*
INV EL = 613.04*
- ⑫ PR CB, T-C, (2' DIA.) W/ T24 F&G
STA. 445+70.00
RIM EL = 617.53*
INV EL = 613.24*

NOTES:

- * DENOTES ELEVATIONS TAKEN FROM EXISTING PLANS, OR CALCULATED BASED ON EXISTING PLANS ELEVATIONS AND MUST BE FIELD VERIFIED.
- EXISTING PLAN ELEVATIONS COME FROM OLD DATUM NAVD 29, WHICH IS 0.3' HIGHER THEN THE CURRENT DATUM NAVD 88.
- BENCHMARK: SET IRON ROD AT STA 442+51.50; 7.32' RT; EL=617.24'

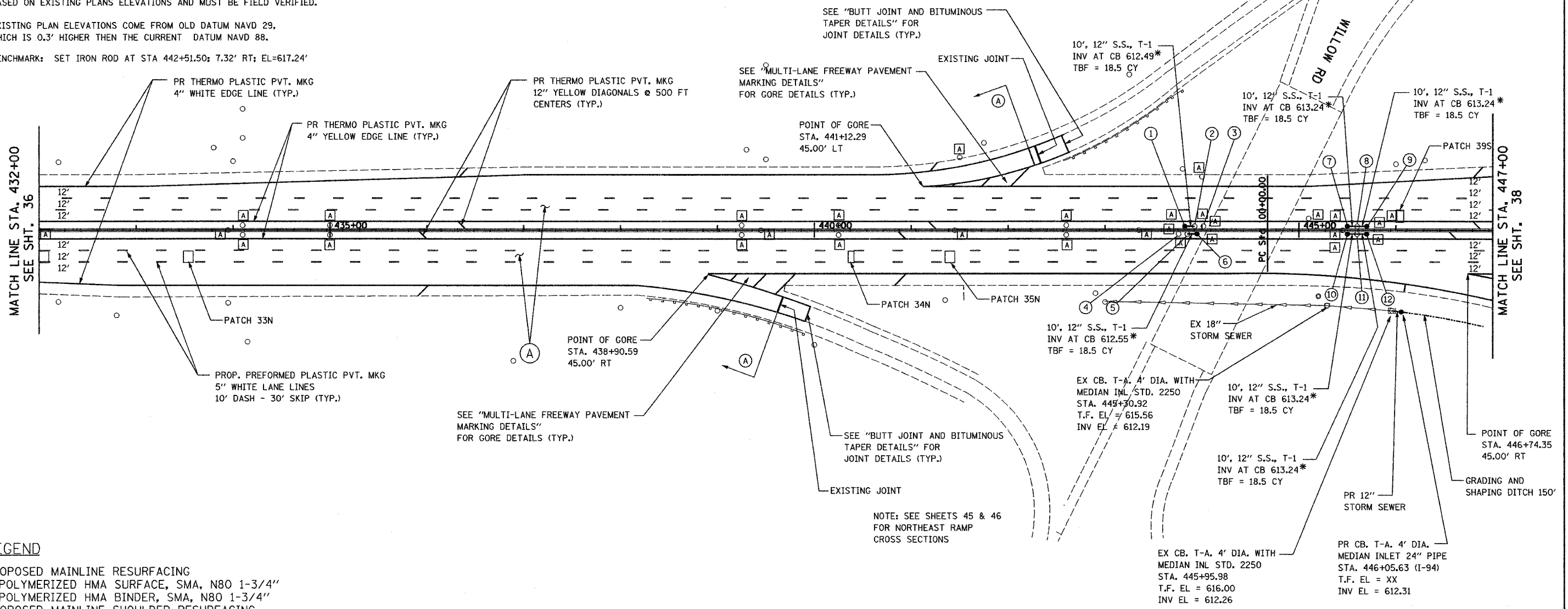

LEGEND

- (A) PROPOSED MAINLINE RESURFACING
 - POLYMERIZED HMA SURFACE, SMA, N80 1-3/4"
 - POLYMERIZED HMA BINDER, SMA, N80 1-3/4"
- PROPOSED MAINLINE SHOULDER RESURFACING
 - HMA SURFACE, MIX D, N70 (IL 9.5 mm) 1-3/4"
 - HMA BINDER, IL-19, N70, VARIES 2-1/4" TO 2-3/4"
- (B) PROPOSED RAMP AND RAMP SHOULDER RESURFACING
 - HMA SURFACE, MIX D, N70 (IL 9.5mm) 1-3/4"
 - HMA BINDER, IL-19, N70, VARIES 2-1/4" TO 2-3/4"
- (A) FRAMES AND GRATES TO BE ADJUSTED

PLOT DATE = 05/04/2007
 FILE NAME = 0511E1
 PLOT SCALE = #SCALE#
 USER NAME = default

NOTE:
SEE "MULTI-LANE FREEWAY PAVEMENT MARKING DETAILS" FOR PLACEMENT & TYPE OF RAISED REFLECTIVE PAVEMENT MARKERS

REVISIONS	
NAME	DATE

ILLINOIS DEPARTMENT OF TRANSPORTATION
 PROPOSED ROADWAY PLANS
 F.A.I. 94 (I-94)
 STA 432+00 TO STA 447+00

SCALE: 1"=50'
 DATE: MAY 2007

DRAWN BY: _____
 CHECKED BY: _____