

F.A.P. RTE.	SECTION	COUNTY	TOTAL SHEETS	SHEET NO.
*	**	KANKAKEE	48	8
STA. TO STA.				
FED. ROAD DIST. NO. - ILLINOIS FED. AID PROJECT				

- FAP 840 (IL 50) & FAP 330 (IL 17)
- (139 Z, 11) TS-1 & (1) TS-2

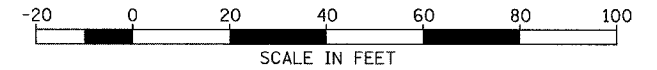

**CONSTRUCTION NOTES:**

- REMOVE AND REPLACE CONTROLLER. MODIFY EXISTING CABINET. INSTALL UNINTERRUPTIBLE POWER SUPPLY.
- EXISTING DETECTOR LOOP LEAD-IN CABLE TO REMAIN IN PLACE.
- REMOVE AND REPLACE TRAFFIC SIGNAL POSTS ON EXISTING FOUNDATIONS IN NORTHWEST AND NORTHEAST CORNERS.
- REMOVE TRAFFIC SIGNAL POSTS AND FOUNDATIONS IN SOUTHWEST AND SOUTHEAST CORNERS. INSTALL NEW POSTS AND FOUNDATIONS WHERE INDICATED.
- REMOVE AND REPLACE ALL SIGNAL HEADS WITH LED HEADS. REPLACE FOUR (4) 4-SECTION HEADS WITH 5-SECTION HEADS.
- REMOVE AND REPLACE EIGHT (8) PEDESTRIAN HEADS WITH LED SYMBOL HEADS.
- REMOVE AND REPLACE PEDESTRIAN PUSH-BUTTONS.
- REMOVE AND REPLACE SERVICE ON EXISTING POLE.
- BACKFILL EXCAVATION IN ROADWAY WITH CONTROLLED LOW-STRENGTH MATERIAL.
- REMOVAL OF THE FOLLOWING ITEMS SHALL BE PAID FOR AS REMOVE EXISTING TRAFFIC SIGNAL EQUIPMENT:
  - 1 EACH - CONTROLLER
  - 6 EACH - INDUCTIVE LOOP DETECTOR
  - 4 EACH - SIGNAL HEAD, 1-FACE, 3-SECTION, BRACKET MOUNTED
  - 2 EACH - SIGNAL HEAD, 1-FACE, 3-SECTION, MAST ARM MOUNTED
  - 2 EACH - SIGNAL HEAD, 1-FACE, 4-SECTION, BRACKET MOUNTED
  - 2 EACH - SIGNAL HEAD, 1-FACE, 4-SECTION, MAST ARM MOUNTED
  - 4 EACH - TRAFFIC SIGNAL POST
  - 8 EACH - PEDESTRIAN SIGNAL HEAD, 1-FACE, BRACKET MOUNTED
  - 8 EACH - PEDESTRIAN PUSH-BUTTON
  - 1 EACH - ELECTRICAL SERVICE

**SCHEDULE OF QUANTITIES**

ITEM NO.	DESCRIPTION	UNIT	TOTAL QUANTITY	④	⑤
42400100	PORTLAND CEMENT CONCRETE SIDEWALK, 4 INCH	SQ FT	393	393	--
42400800	DETECTABLE WARNINGS	SQ FT	33	33	--
44000600	SIDEWALK REMOVAL	SQ FT	274	274	--
44100100	PAVEMENT REPLACEMENT	SQ YD	23	23	--
59300100	CONTROLLED LOW-STRENGTH MATERIAL	CU YD	2	2	--
80500200	SERVICE INSTALLATION, TYPE B	EACH	1	1	--
81012600	CONDUIT IN TRENCH, 2" DIA., PVC	FOOT	182	182	--
81013000	CONDUIT IN TRENCH, 4" DIA., PVC	FOOT	16	16	--
81021330	CONDUIT PUSHED, 2" DIA., PVC	FOOT	18	18	--
81021350	CONDUIT PUSHED, 3" DIA., PVC	FOOT	169	169	--
81021370	CONDUIT PUSHED, 4" DIA., PVC	FOOT	50	50	--
81400720	DOUBLE HANDHOLE, PORTLAND CEMENT CONCRETE	EACH	1	1	--
81900200	TRENCH AND BACKFILL FOR ELECTRICAL WORK	FOOT	190	190	--
85700505	FULL-ACTUATED CONTROLLER IN EXISTING CABINET, SPECIAL	EACH	1	1	--
86200300	UNINTERRUPTIBLE POWER SUPPLY, EXTENDED	EACH	1	1	--
86400100	TRANSCIEVER-FIBER OPTIC	EACH	1	1	--
87301215	ELECTRIC CABLE IN CONDUIT, SIGNAL NO. 14 2C	FOOT	923	923	--
87301225	ELECTRIC CABLE IN CONDUIT, SIGNAL NO. 14 3C	FOOT	995	995	--
87301245	ELECTRIC CABLE IN CONDUIT, SIGNAL NO. 14 5C	FOOT	801	801	--
87301255	ELECTRIC CABLE IN CONDUIT, SIGNAL NO. 14 7C	FOOT	564	564	--
87301805	ELECTRIC CABLE IN CONDUIT, SERVICE, NO. 6 2C	FOOT	222	222	--
87502500	TRAFFIC SIGNAL POST, GALVANIZED STEEL 16 FT.	EACH	4	4	--
87800100	CONCRETE FOUNDATION, TYPE A	FOOT	6	6	--
87900200	DRILL EXISTING HANDHOLE	EACH	8	8	--
88040070	SIGNAL HEAD, POLYCARBONATE, LED, 1-FACE, 3-SECTION, BRACKET MOUNTED	EACH	4	4	--
88040090	SIGNAL HEAD, POLYCARBONATE, LED, 1-FACE, 3-SECTION, MAST ARM MOUNTED	EACH	2	2	--
88040150	SIGNAL HEAD, POLYCARBONATE, LED, 1-FACE, 5-SECTION, BRACKET MOUNTED	EACH	2	2	--
88040160	SIGNAL HEAD, POLYCARBONATE, LED, 1-FACE, 5-SECTION, MAST ARM MOUNTED	EACH	2	2	--
88102710	PEDESTRIAN SIGNAL HEAD, LED, 1-FACE, BRACKET MOUNTED	EACH	8	8	--
88200410	TRAFFIC SIGNAL BACKPLATE, LOUVERED, FORMED PLASTIC	EACH	10	10	--
88500100	INDUCTIVE LOOP DETECTOR	EACH	6	6	--
88800100	PEDESTRIAN PUSH-BUTTON	EACH	8	8	--
89502210	MODIFY EXISTING CONTROLLER CABINET	EACH	1	1	--
89502300	REMOVE ELECTRIC CABLE FROM CONDUIT	FOOT	1760	1760	--
89502375	REMOVE EXISTING TRAFFIC SIGNAL EQUIPMENT	EACH	1	1	--
89502385	REMOVE EXISTING CONCRETE FOUNDATION	EACH	2	2	--
X8730027	ELECTRIC CABLE IN CONDUIT, GROUNDING, NO. 6 1C	FOOT	554.5	554.5	--
X8860100	LOOP DETECTOR TESTING	EACH	1	1	--
XX002179	ELECTRIC CABLE IN CONDUIT, COMMUNICATION, NO. 20 3/C	FOOT	417	417	--
*3001707	LIGHT DETECTOR, INSTALLATION ONLY	EACH	4	--	4
*3001826	CONFIRMATION BEACON, INSTALLATION ONLY	EACH	4	--	4
*3001708	LIGHT DETECTOR AMPLIFIER, INSTALLATION ONLY	EACH	4	--	4

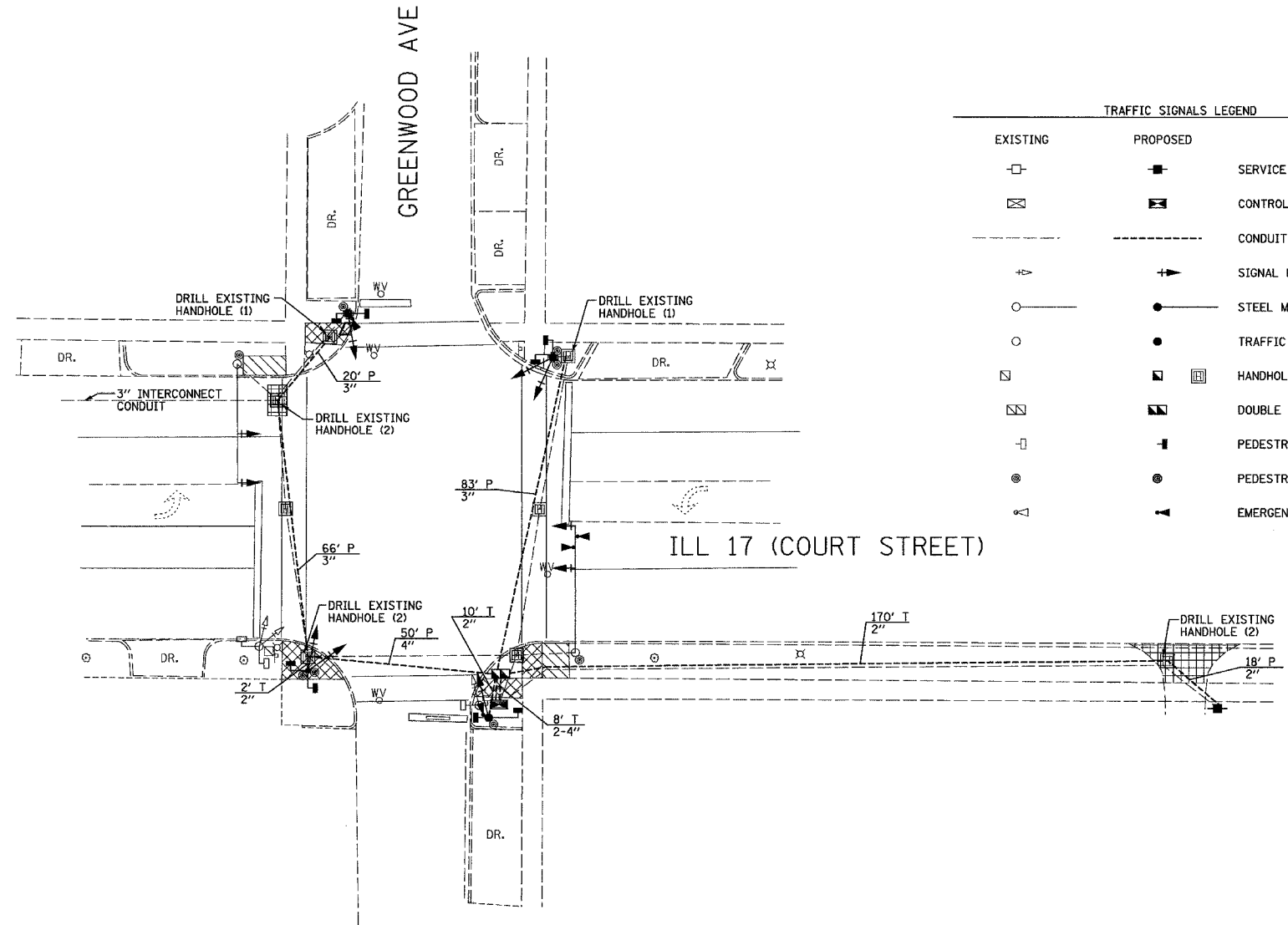

**LEGEND**

- ① 80% FEDERAL, 20% STATE
- ② 80% FEDERAL, 15% STATE, 5% CITY
- ③ 80% FEDERAL, 13.3% STATE, 6.7% CITY
- ④ 80% FEDERAL, 10% STATE, 10% CITY
- ⑤ 100% CITY

**LEGEND**

	SIDEWALK REMOVAL AND REPLACEMENT
	SIDEWALK
	PAVEMENT REPLACEMENT

**TRAFFIC SIGNALS LEGEND**

EXISTING	PROPOSED	
		SERVICE INSTALLATION
		CONTROLLER CABINET
		CONDUIT
		SIGNAL HEAD WITH BACKPLATE
		STEEL MAST ARM
		TRAFFIC SIGNAL POST
		HANDHOLE
		DOUBLE HANDHOLE
		PEDESTRIAN SIGNAL HEAD
		PEDESTRIAN PUSH BUTTON
		EMERGENCY VEHICLE LIGHT DETECTOR

**REVISIONS**

NAME	DATE
ARR	4/07

ILLINOIS DEPARTMENT OF TRANSPORTATION  
**TRAFFIC SIGNAL PLAN**  
 FAP 330 (IL 17)-COURT STREET  
 AND GREENWOOD AVENUE  
 SECTION (139 Z, 11) TS-1 & (1) TS-2  
 KANKAKEE COUNTY

SCALE: VERT. 1" = 20'  
 HORIZ. 1" = 20'  
 DATE 6/05

DRAWN BY ARR  
 CHECKED BY JLS