

PLAN & PROFILE OF A.R. CULVERT @ STA. 796+57.5

CONTRACT NO. 70585

F.A.P. RTE.	SECTION	COUNTY	TOTAL SHEETS	SHEET NO.
840	121BR	VERMILION	19	6
STA.		TO STA.		
FED. ROAD DIST. NO.		ILLINOIS FED. AID PROJECT		

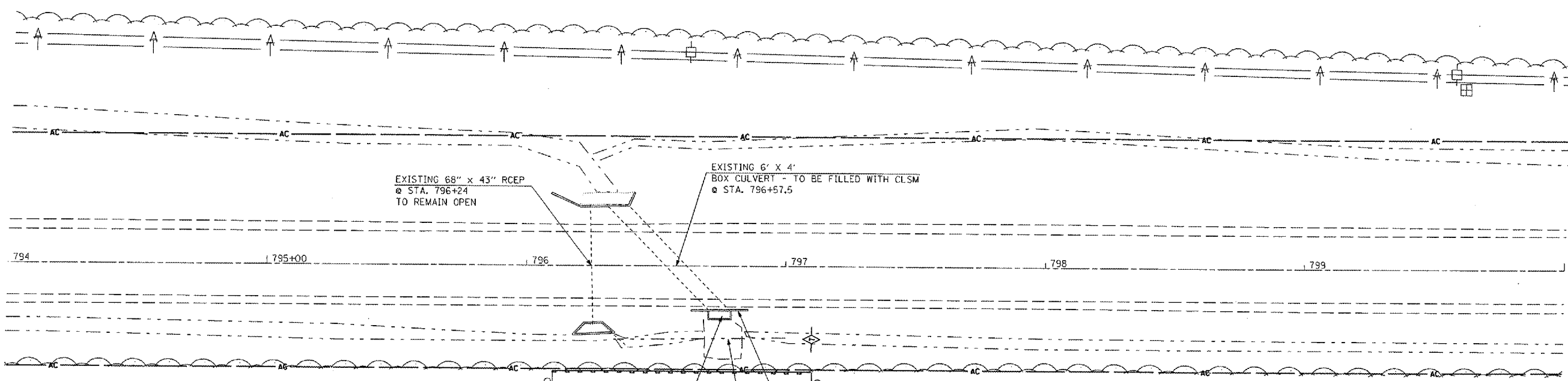

ALL AREAS DISTURBED DURING BOX CULVERT CONSTRUCTION SHALL BE REPAIRED AND SEEDED ACCORDING TO SECTION 250 OF THE STANDARD SPECIFICATIONS. THIS WORK SHALL BE INCLUDED IN THE CONTRACT UNIT PRICE FOR GRADING & SHAPING DITCHES.

SEE SHEET 7 OF 18 FOR CLSM DETAIL

DROP STRUCTURE TO BE FILLED WITH CLSM

EXISTING HEADWALL TO BE REMOVED ABOVE DROP STRUCTURE

GRADING AND SHAPING DITCHES

PERIMETER EROSION BARRIER
TEMPORARY DITCH CHECK

SHEET 1 OF 2

T 22 N, R 14 W, SEC. 35 / 36

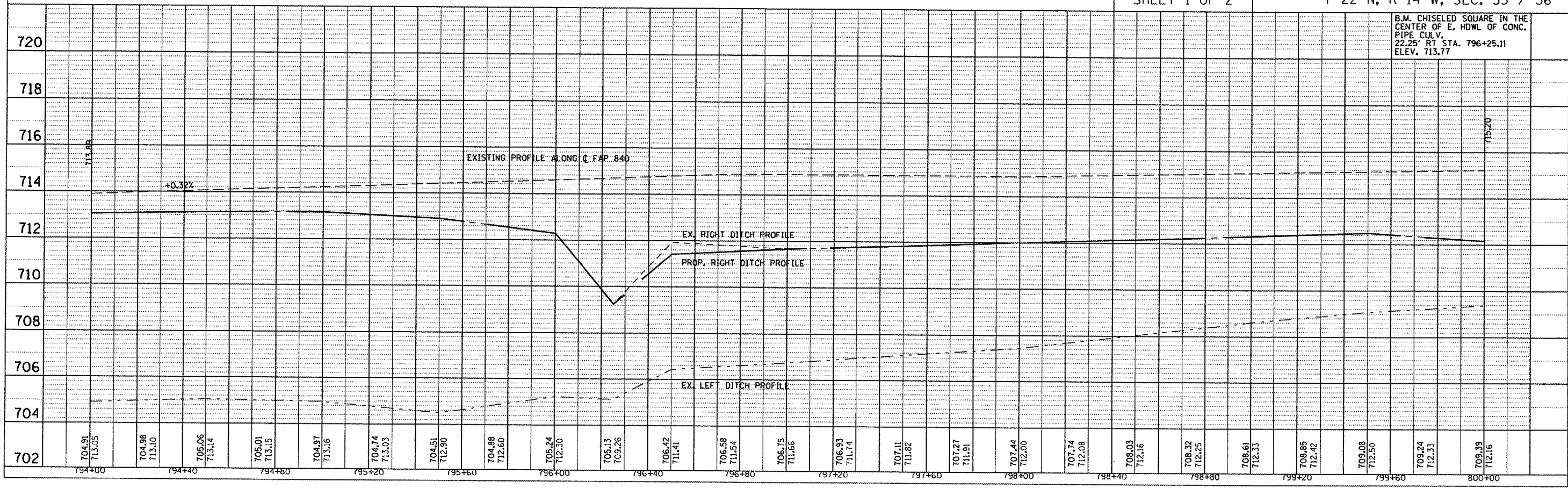

B.M. CHISELED SQUARE IN THE CENTER OF E. HDWL OF CONC. PIPE CULV. 22.25' RT STA. 796+25.11 ELEV. 713.77

PLAN

DATE	
BY	
REVISION	
NO. 1	
NO. 2	
NO. 3	
NO. 4	
NO. 5	
NO. 6	
NO. 7	
NO. 8	
NO. 9	
NO. 10	

PROFILE

DATE	
BY	
REVISION	
NO. 1	
NO. 2	
NO. 3	
NO. 4	
NO. 5	
NO. 6	
NO. 7	
NO. 8	
NO. 9	
NO. 10	

PLOT DATE: 6/16/2007
 FILE NAME: s:\projects\818206\818206.dwg
 PLOT SCALE: 42.853' / IN.
 USER NAME: collierb