

F.A.P. RTE.	SECTION	COUNTY	TOTAL SHEETS	SHEET NO.
322	.	CHRISTIAN	7	7
STA.		TO STA.		
FED. ROAD DIST. NO.		ILLINOIS FED. AID PROJECT		
• D6 BUILDING DEMOLITION 2008				

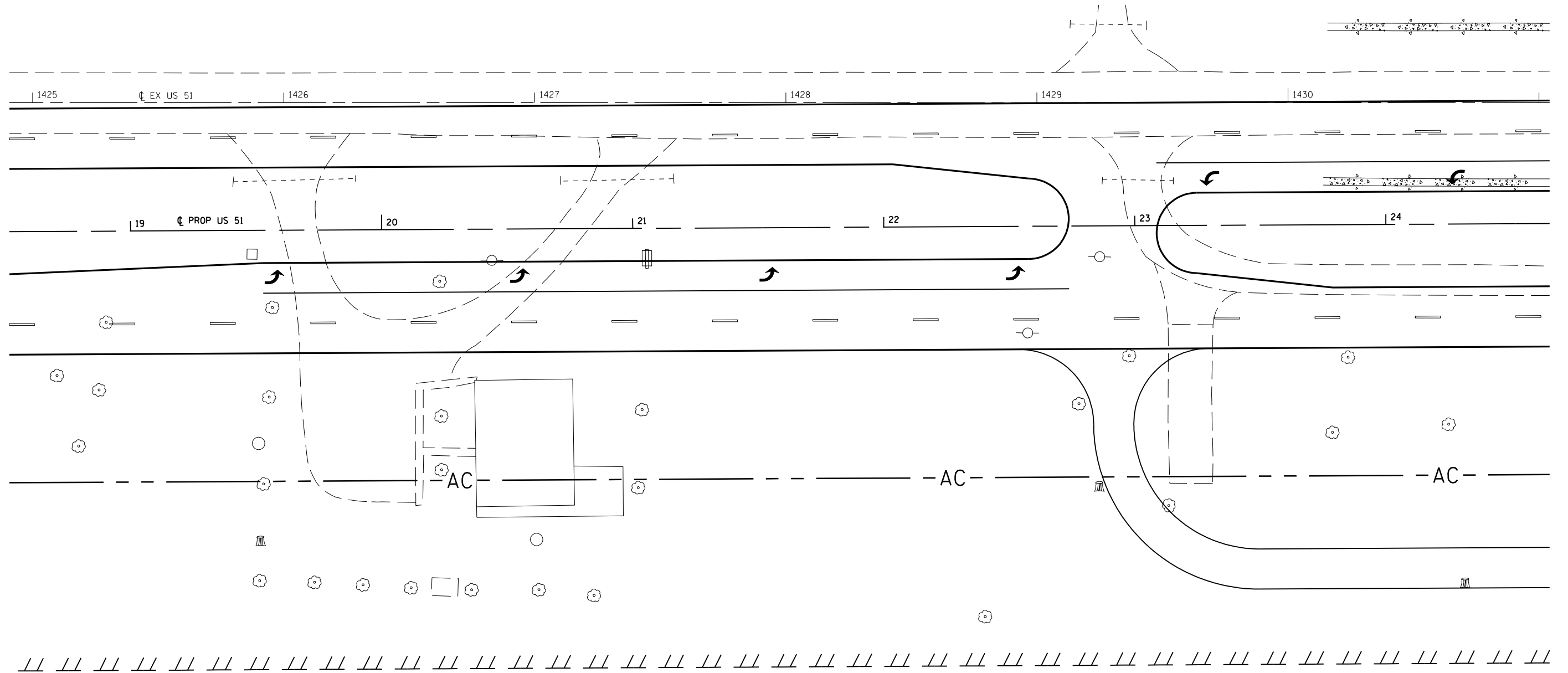

FOR INFORMATION ONLY

REVISIONS	
NAME	DATE

ILLINOIS DEPARTMENT OF TRANSPORTATION  
 FUTURE FOUR LANE PLAN SHEET  
 FAP 322 (US 51)  
 D-6 BUILDING DEMOLITION 2008  
 CHRISTIAN COUNTY  
 SCALE: VERT. \_\_\_\_\_  
 HORIZ. \_\_\_\_\_  
 DATE \_\_\_\_\_ DRAWN BY \_\_\_\_\_  
 CHECKED BY \_\_\_\_\_

PLOT DATE = 5/17/2007  
 FILE NAME = c:\p\projects\653307\shplan\41enne.dgn  
 PLOT SCALE = 42,352% / IN.  
 USER NAME = laughlin-1