

FOR INDEX OF SHEETS AND HIGHWAY
STANDARDS, SEE SHEET 2.

STATE OF ILLINOIS
DEPARTMENT OF TRANSPORTATION
DIVISION OF HIGHWAYS

PLANS FOR PROPOSED
CONTRACT MAINTENANCE

FAP ROUTE 325 (IL 16), FAU ROUTE 7935 (IL 29), FAP 322 (US 51)
SECTION D-6 PANA CNTR MAINT RES 2008
CHRISTIAN COUNTY
C96-112-07 / D96-112-07

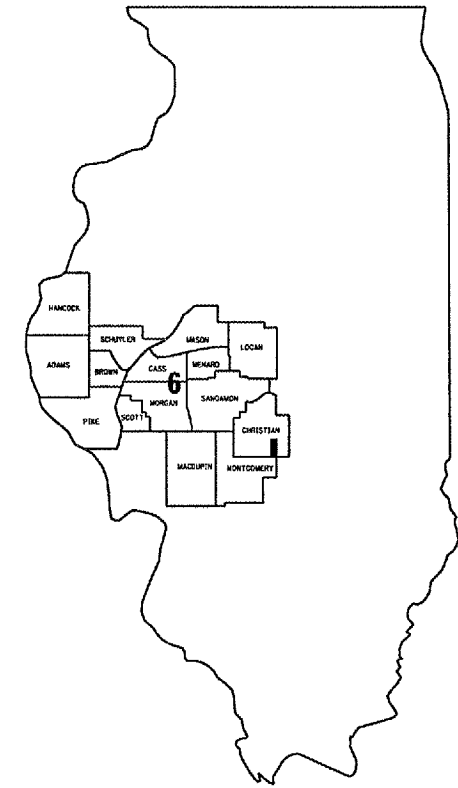

LOCATION OF SECTION INDICATED THUS: ■

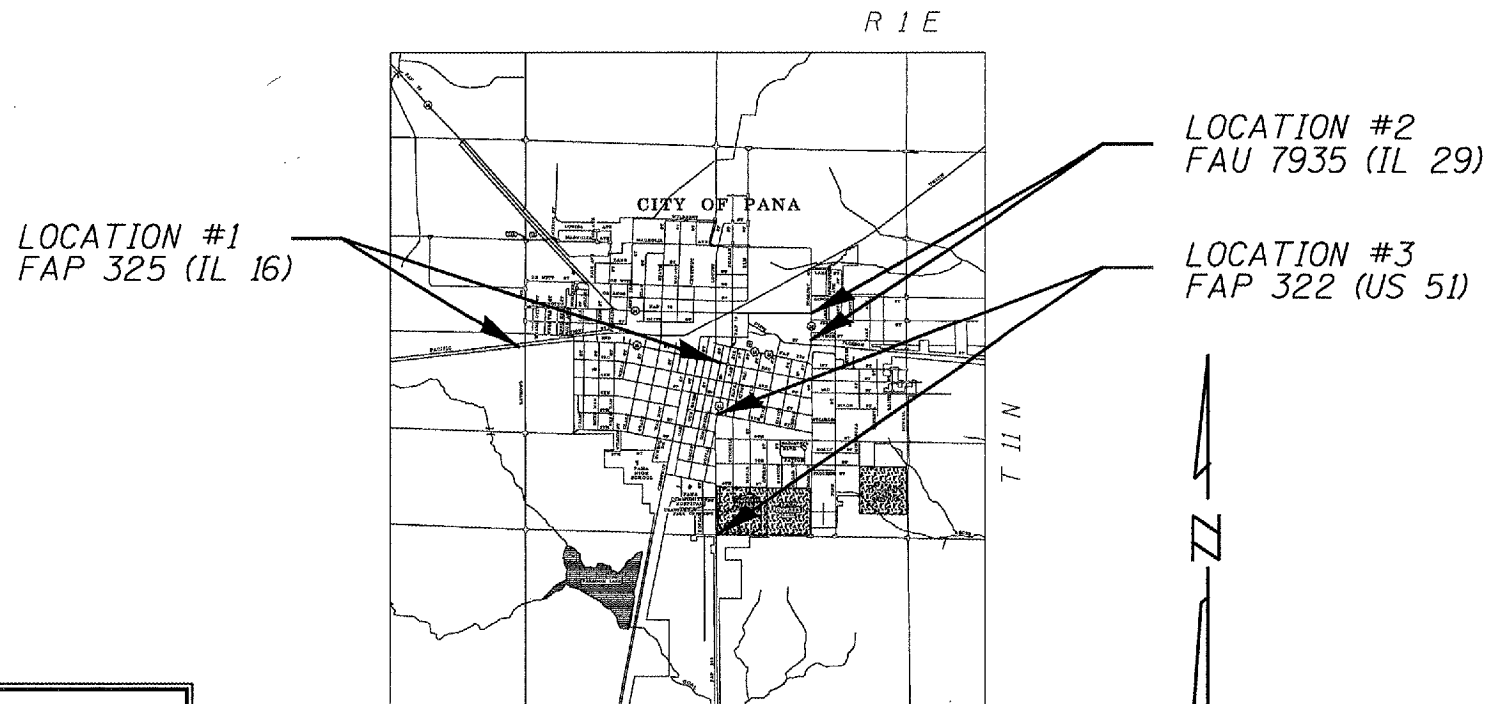

J. U. L. I. E.
JOINT UTILITY LOCATION INFORMATION FOR EXCAVATION
1-800-892-0123

PLANS & CONTRACT TECHNICIAN: TIMOTHY SHARP
PHONE: (217) 782-7743

NET LTH OF LOC #1 5,550.00 FT = 1.051 MILES
NET LTH OF LOC #2 708.00 FT = 0.134 MILE
NET LTH OF LOC #3 3,195.41 FT = 0.605 MILE

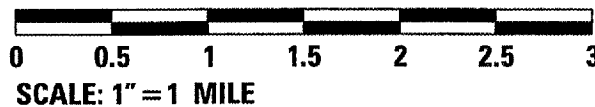

STATE OF ILLINOIS
DEPARTMENT OF TRANSPORTATION
DIVISION OF HIGHWAYS

SUBMITTED May 29 2007
Oliver Reed
DEPUTY DIRECTOR OF HIGHWAYS, REGION FOUR ENGINEER

June 29 2007
Eric E. Harms
INTERIM ENGINEER OF DESIGN AND ENVIRONMENT

June 29 2007
Milton R. Sees, P.E.
DIRECTOR, DIVISION OF HIGHWAYS

CONTRACT NO. 72B35