

F.A.P. RTE.	SECTION	COUNTY	TOTAL SHEETS	SHEET NO.
332	101B-1	WABASH	34	7

STA.	TO STA.
FED. ROAD DIST. NO.	ILLINOIS FED. AID PROJECT

ALIGNMENT TIES:

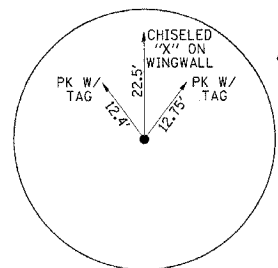

FAP 332 (IL 1)
ALIGNMENT TIE
P.O.T. STA 130+31.19

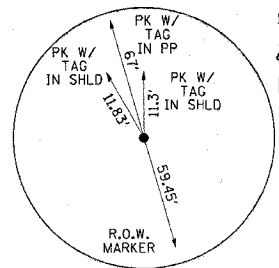

FAP 332 (IL 1)
ALIGNMENT TIE
P.C. STA 136+58.55

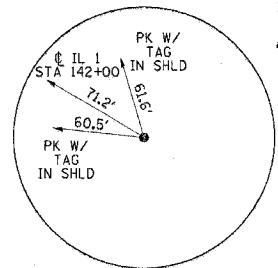

FAP 332 (IL 1)
ALIGNMENT TIE
P.I. (BOLT FOUND)

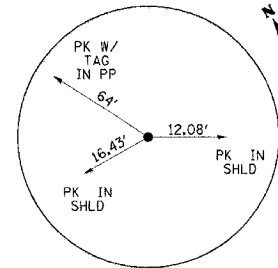

FAP 332 (IL 1)
ALIGNMENT TIE
P.T. STA 147+24.37

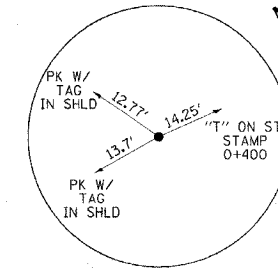

FAP 332 (IL 1)
ALIGNMENT TIE
P.O.T. STA 162+32.80

BENCHMARKS:

FAP 332 (IL 1)

BM 516 - RR SPIKE IN POWER POLE EAST SIDE. STA ± 153+59.
ELEVATION - 395.978

BM 517 - CHISELED SQUARE ON SW WINGWALL OF BRIDGE
SN 093-0005. ELEVATION - 390.496

BM 518 - RR SPIKE IN 30" DIAMETER TREE ON SOUTH SIDE OF
IL 1. STA ± 139+98, 43' RT. ELEVATION - 403.720

REVISIONS	
NAME	DATE

ILLINOIS DEPARTMENT OF TRANSPORTATION

ALIGNMENT TIES & BENCHMARKS

SCALE: VERT. N/A
HORIZ. N/A
DATE 06/20/07

DRAWN BY KMO
CHECKED BY SSM

Plot Date: 6/20/07
 Plotted By: KKM
 Pen Table: 1001.tbl
 Filename: I:\06055\Cad\Downscope\Borbase-Construction Plan\06_Control.dgn