

F.A.P. RTE.	SECTION	COUNTY	TOTAL SHEETS	SHEET NO.
332	101B-1	WABASH	34	13
STA.		TO STA.		
FED. ROAD DIST. NO.		ILLINOIS	FED. AID PROJECT	

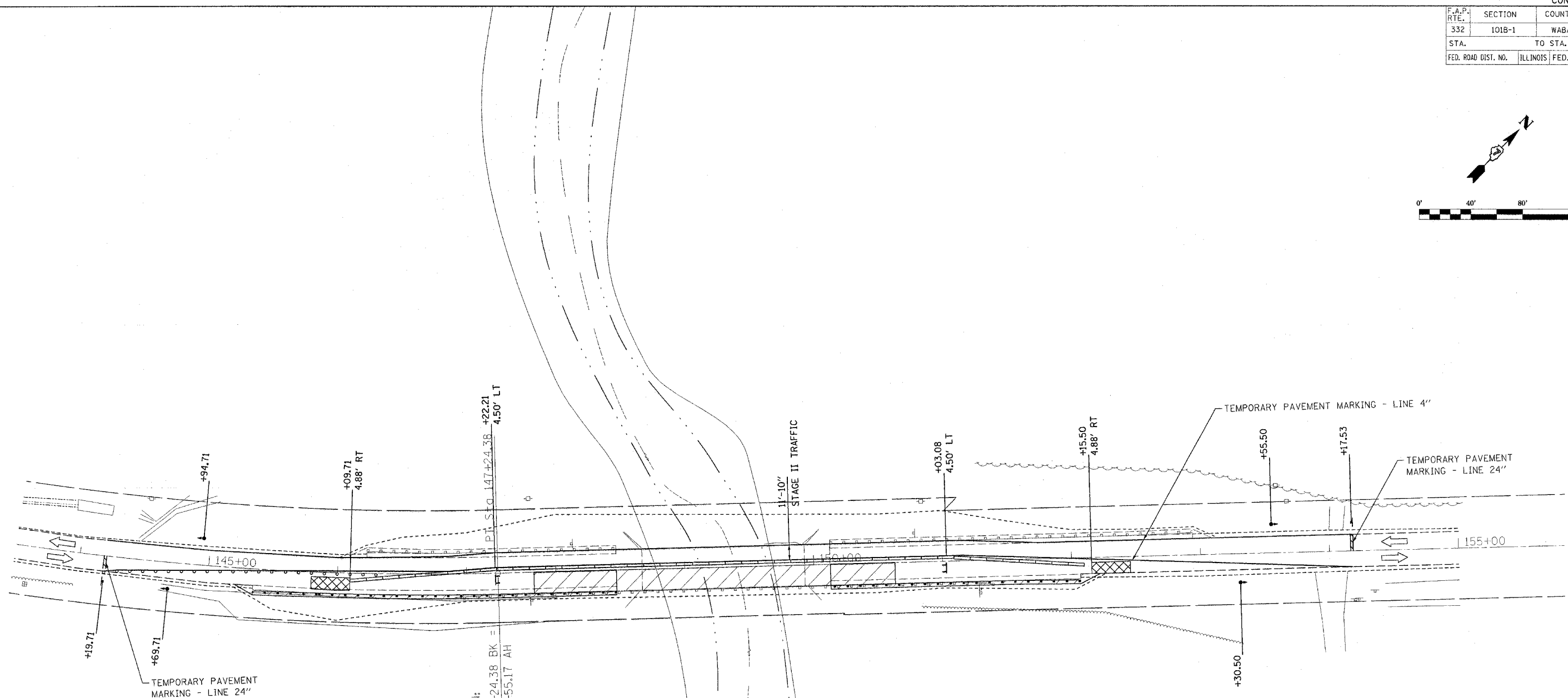
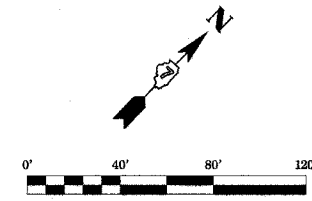

EQUATION:
 STG 147+24.38 BK =
 STG 147+55.17 AH

STAGE II SEQUENCE OF CONSTRUCTION
 RELOCATE BARRIER WALL AND IMPACT ATTENUATORS AND PUT IN PLACE OTHER TRAFFIC CONTROL MEASURES FOR STAGE II AS REQUIRED BY 701321
 ONCE TRAFFIC IS DIRECTED TO STAGE II TRAFFIC LANES, COMPLETE STAGE II STRUCTURAL, WIDENING, GUARDRAIL, SHOULDER WORK & RESURFACING

- LEGEND**
- WORK AREA
 - SIGN (SEE STD 701321)
 - DRUM WITH STEADY BURNING LIGHT
 - TRAFFIC SIGNAL
 - TEMPORARY CONCRETE BARRIER
 - IMPACT ATTENUATOR, TEMPORARY
 - DIRECTION OF TRAFFIC
 - TYPE III BARRICADE
 - PERIMETER EROSION BARRIER

COOMBE-BLOXDORF P.C.
 Engineers / Land Surveyors
 Springfield, Illinois
 Design Firm License No. 184-002708

REVISIONS	
NAME	DATE

ILLINOIS DEPARTMENT OF TRANSPORTATION
 STAGE II TRAFFIC CONTROL PLAN
 FAP ROUTE 332 (IL ROUTE 1)
 OVER BONPAS CREEK
 SECTION 101B-1
 WABASH COUNTY

SCALE: 1"=40'
 DATE _____ DRAWN BY _____
 CHECKED BY _____

Plot Date: 6/21/2007
 Plot Date: 6/21/2007
 File Name: R:\HW\6055\Cad\Downscope\Bonpas-Construction\Plan\B.stage-ii-print.dgn
 Plot Scale: 1/4"=40' / 1/8"=20'
 User Name: R:\HW\6055\Downscope\Bonpas-Construction\Plan\B.stage-ii-print.dgn