

F.A.I. RTE.	SECTION	COUNTY	TOTAL SHEETS	SHEET NO.
64	255	ST. CLAIR	34	8
STA. 272+00		TO STA. 1058+00		
FED. ROAD DIST. NO. ILLINOIS FED. AID PROJECT				
* FAI_64/FAI_255				
** DIST_8_ITS_2008-1_2C				

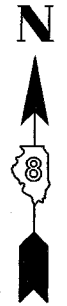

MATCHLINE STA. 272+00

MATCHLINE STA. 1058+00

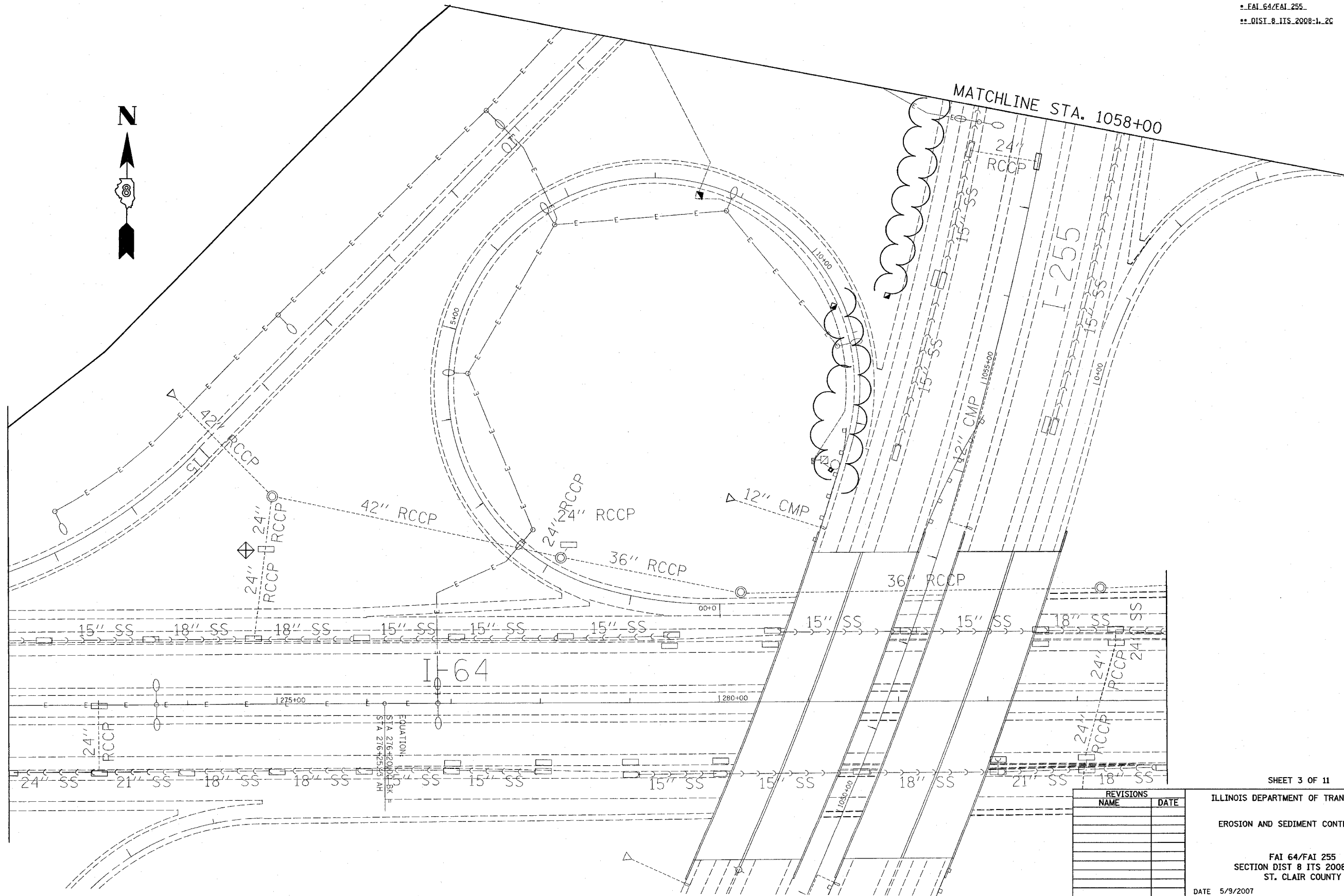

SHEET 3 OF 11

ILLINOIS DEPARTMENT OF TRANSPORTATION  
EROSION AND SEDIMENT CONTROL PLAN

FAI 64/FAI 255  
SECTION DIST 8 ITS 2008-1, 2C  
ST. CLAIR COUNTY

DATE 5/9/2007

REVISIONS	
NAME	DATE

PLOT DATE = 5/9/2007  
 FILE NAME = c:\projects\76a82\station\1\epin0507a.dgn  
 PLOT SCALE = 1"=40' 0.00"  
 REFERENCE = NREF