

F.A.I. RTE.	SECTION	COUNTY	TOTAL SHEETS	SHEET NO.
#	**	ST. CLAIR	34	9
STA. 1058+00		TO STA. 1072+00		
FED. ROAD DIST. NO. _		ILLINOIS FED. AID PROJECT		

* FAI 64/FAI 255
 ** DIST 8 ITS 2008-1-2C

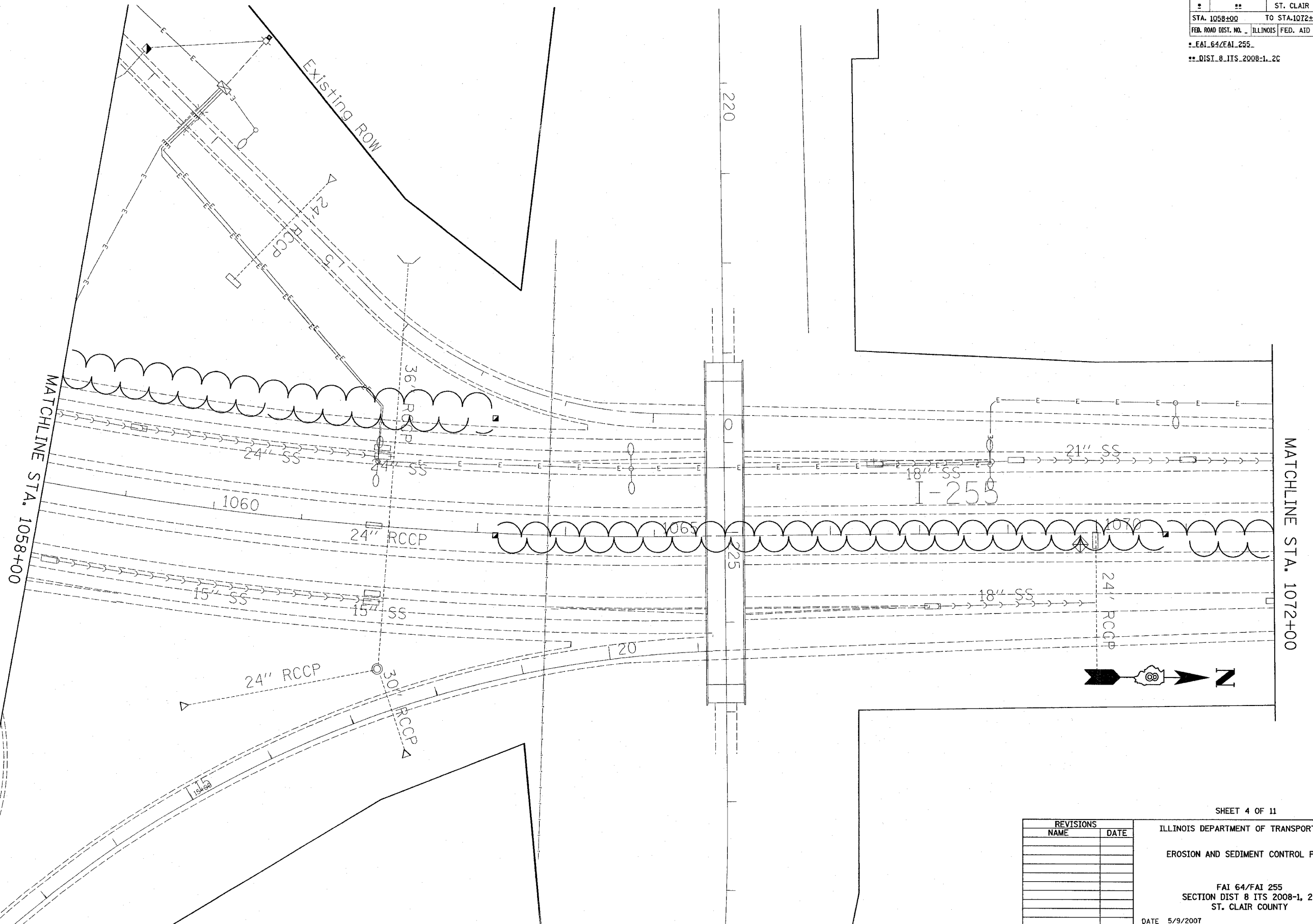

PLOT DATE = 5/9/2007
 FILE NAME = c:\p\projects\76a82\eroc\eroc.dwg
 PLOT SCALE = 5/8"=1'-0"
 REFERENCE = NONE

REVISIONS	
NAME	DATE

ILLINOIS DEPARTMENT OF TRANSPORTATION
 EROSION AND SEDIMENT CONTROL PLAN
 FAI 64/FAI 255
 SECTION DIST 8 ITS 2008-1, 2C
 ST. CLAIR COUNTY
 DATE 5/9/2007