

P.A.A. NO.	SECTION	COUNTY	TOTAL SHEETS	SHEET NO.
789	IRS-1	MADISON	26	13
STA. 257+00 TO STA. 262+00				
EXISTING CONDITIONS:				

PLAN	DATE	BY
DESIGNED		
PLOTTED		
NO. OF WAYS CIRCLED		
PAID FILE NAME		

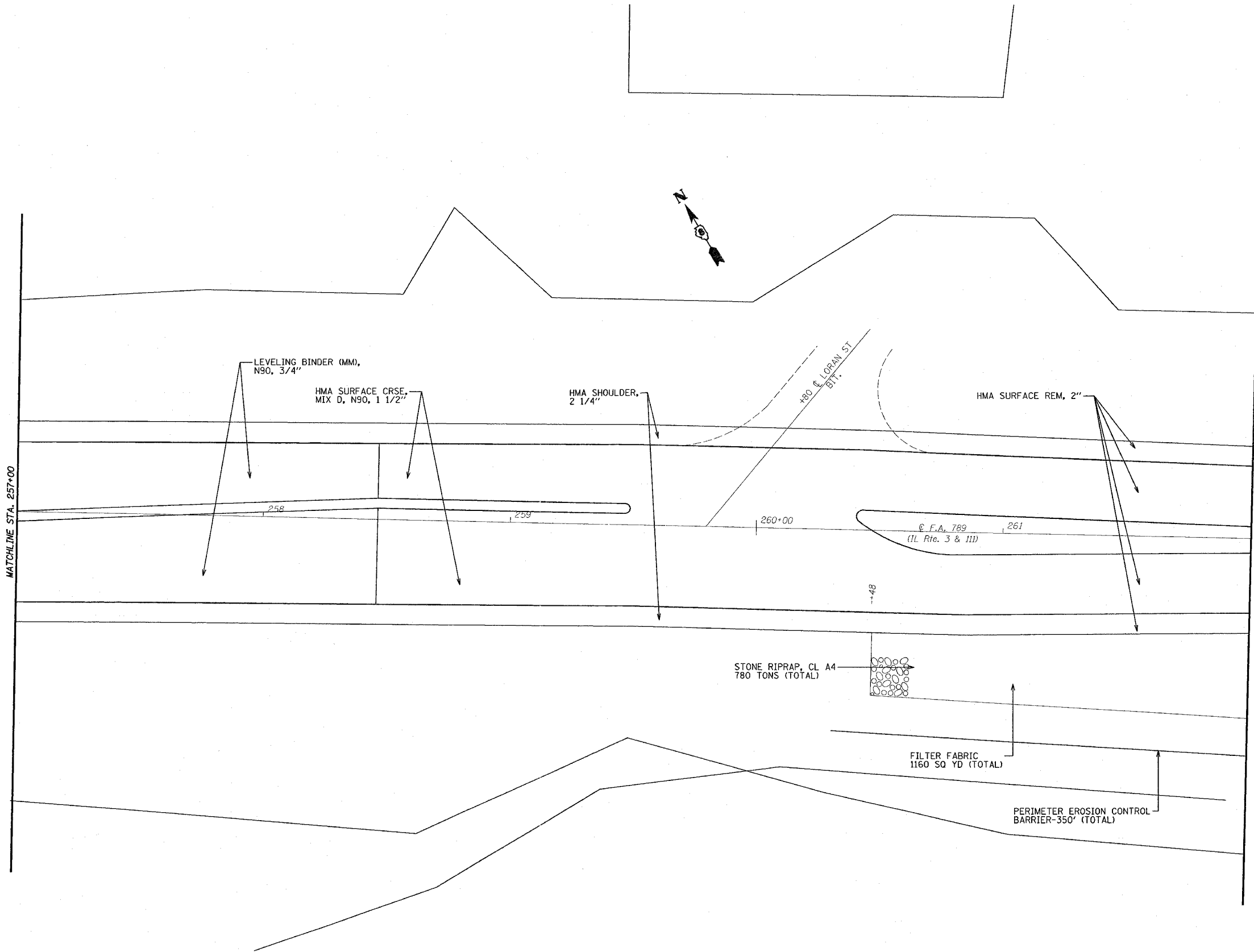

ILLINOIS DEPARTMENT OF TRANSPORTATION

**PLAN SHEETS
LOCATION #3**

F.A. 789 (IL RTE. 3 & 111)
SECTION IRS-1
MADISON COUNTY

PLOT DATE: 4/5/2007

4/5/2007
4/5/2007
c:\p07\res\789\789\plan\plan3.dwg
REF
REF