

F. A. L. NO.	SECTION	COUNTY	TOTAL SHEETS	SHEET NO.
	06-00082-00-BR	COOK	009	007
STA.	TO STA.			
FED. ROAD DIST. NO.	KLANS	FED. AID PROJECT		

CONTRACT NO. 83948

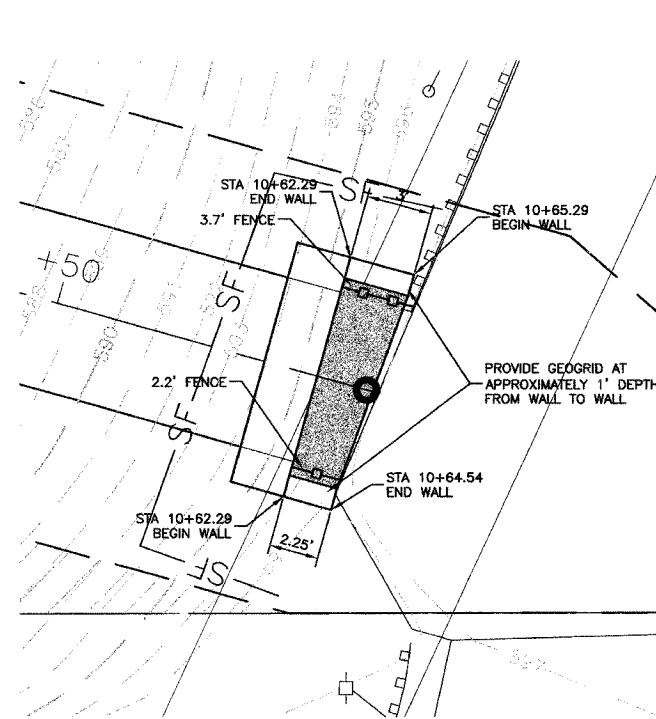

NOTE: STATIONING IS ALONG FRONT FACE OF WALL  
 T/W = TOP OF WALL ELEVATION  
 T/P = TOP OF LEVELING PAD ELEVATION

EAST ABUTMENT MODULAR BLOCK RETAINING WALL PLAN

**BENCH MARK:**

BENCH MARK #156  
 SQUARE CUT ON NORTH WEST WINGWALL OF  
 162ND ST. BRIDGE OVER CAL-UNION DITCH  
 ELEVATION=597.35 (NGVD 29(FEMA))

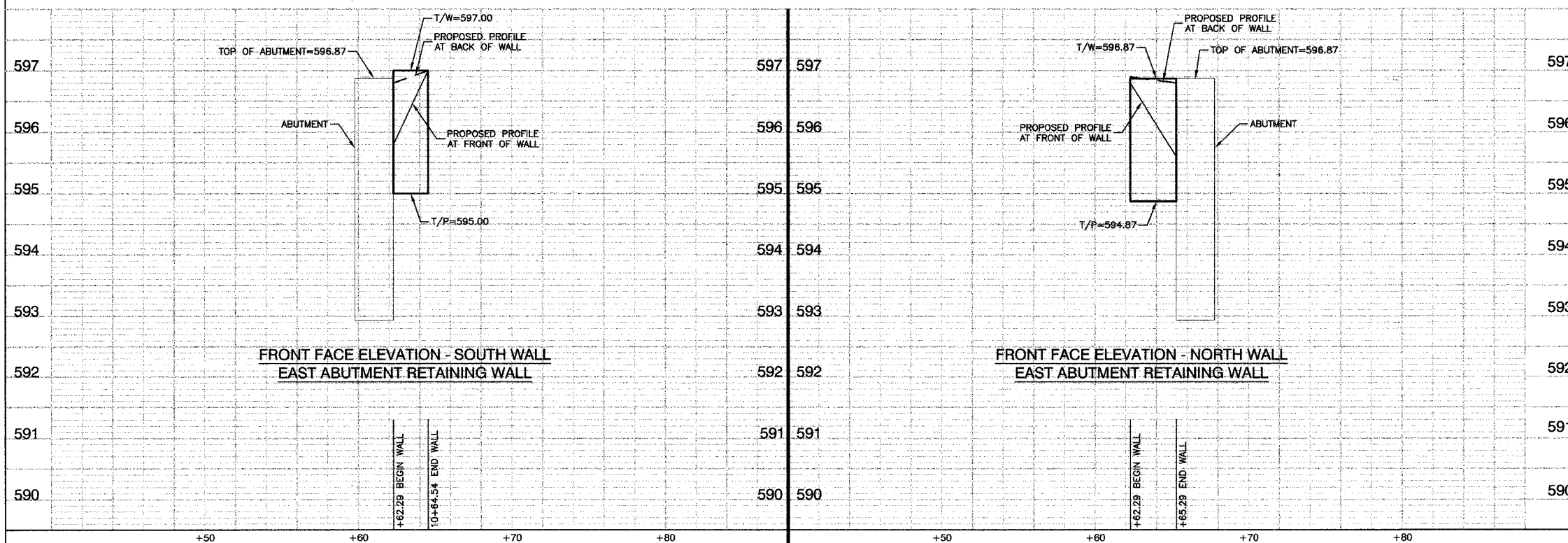

REVISIONS	
NAME	DATE

ILLINOIS DEPARTMENT OF TRANSPORTATION

**PEDESTRIAN BRIDGE  
 MODULAR BLOCK RETAINING WALL  
 PLAN AND ELEVATIONS**

SCALE: VERT. 1"=1'  
 HORIZ. 1"=4'

DATE 5-16-07

DRAWN BY EC  
 CHECKED BY PKB

ROBINSON ENGINEERING, LTD.  
 17000 55TH FERRY AVENUE, SOUTH HOLLAND, ILLINOIS 60470  
 (708) 321-8700 FAX (708) 321-2825  
 ILLINOIS DESIGN FIRM REGISTRATION NO. 154801108

04389-PLAN 02 - PKB