

RTE.	SECTION	COUNTY	TOTAL SHEETS	SHEET NO.
CH 10	05-00075-05-RS	SANGAMON	72	29
STA. 195+75 TO STA. 294+56				

CONTRACT NO. 93439

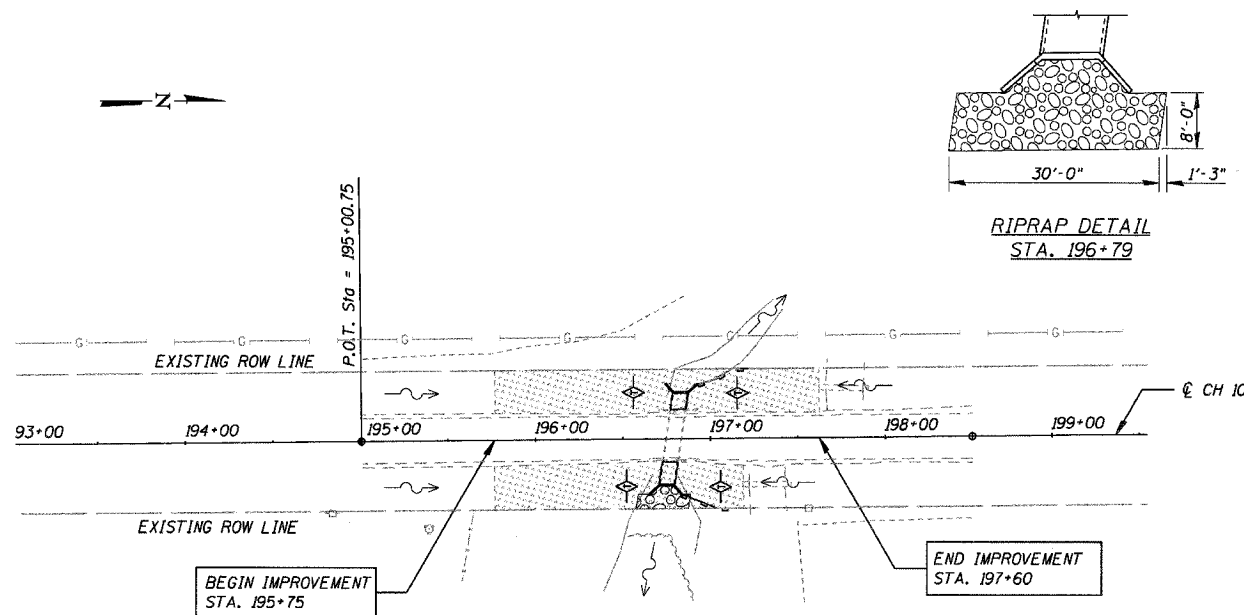

LOCATION 12

QUANTITIES STA. 195+75 TO STA. 197+60
 SEEDING CLASS 2 (SPECIAL) 0.2 ACRE
 RIPRAP (SPECIAL) A4 28 TONS
 TEMPORARY EROSION CONTROL SEEDINGS 20 POUNDS
 TEMPORARY DITCH CHECKS 4 EACH
 PERIMETER EROSION BARRIER 80 FEET

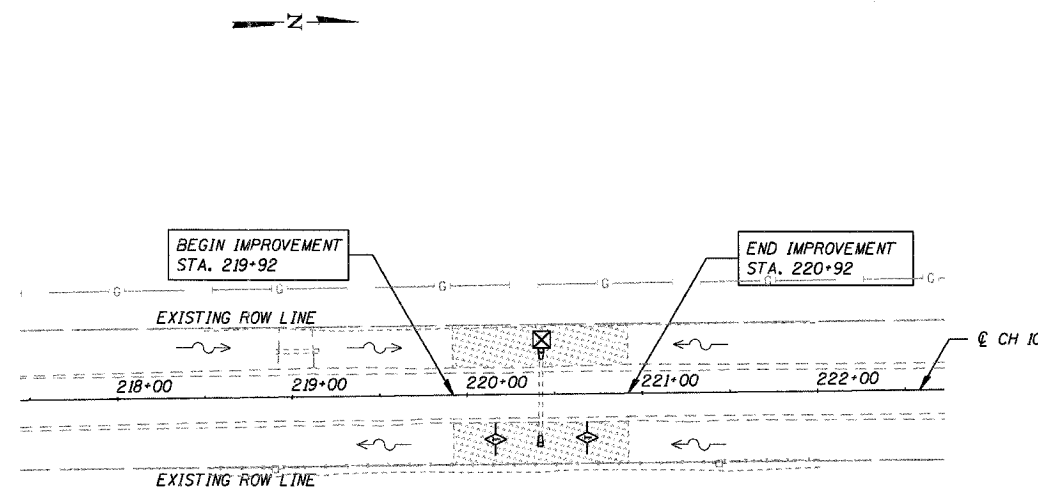

LOCATION 13

QUANTITIES STA. 219+92 TO STA. 220+92
 SEEDING CLASS 2 (SPECIAL) 0.1 ACRE
 TEMPORARY EROSION CONTROL SEEDINGS 10 POUNDS
 TEMPORARY DITCH CHECKS 1 EACH
 INLET AND PIPE PROTECTION 1 EACH

LEGEND	
	INDICATES LIMITS OF CLASS 2 SEEDING (SPECIAL)
	INDICATES LIMITS OF RIPRAP (SPECIAL)
	TEMPORARY DITCH CHECK
	INLET AND PIPE PROTECTION
	PERIMETER EROSION BARRIER

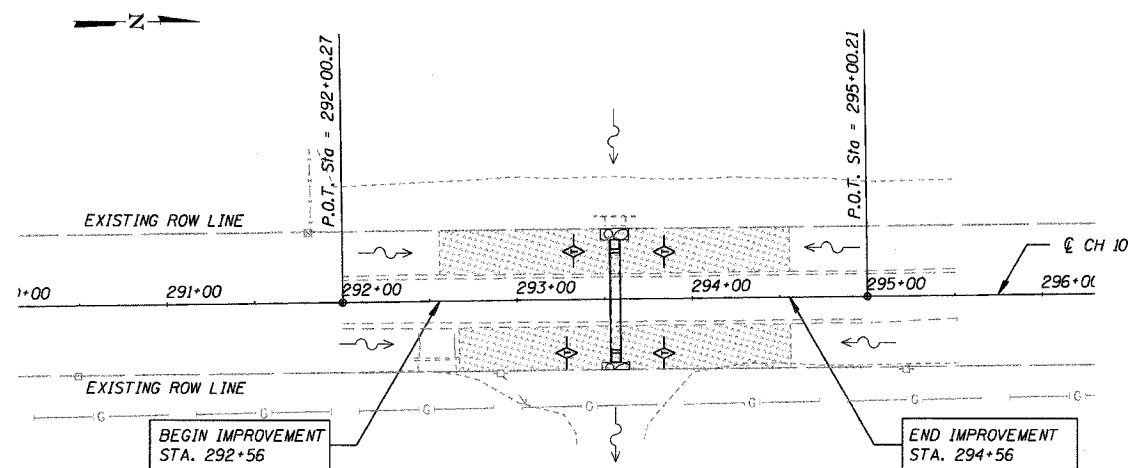

LOCATION 14

QUANTITIES STA. 292+56 TO STA. 294+56
 SEEDING CLASS 2 (SPECIAL) 0.2 ACRE
 RIPRAP (SPECIAL) A3 15 TON
 TEMPORARY EROSION CONTROL SEEDINGS 20 POUNDS
 TEMPORARY DITCH CHECKS 4 EACH

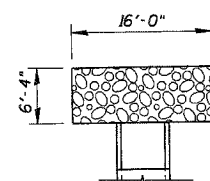

RIPRAP DETAIL
STA. 293+56

EROSION CONTROL PLAN

CH 10
 SECTION 05-00075-05-RS
 SANGAMON COUNTY
 STA. 195+75 TO 294+56

CUMMINS ENGINEERING CORPORATION
 JOB #: 2171
 FILE: 2171EROSION
 DATE: 4/25/07