

CONTROLLER PHASING

PROPOSED											
PHASE Ø	1	2	3	4	5	6	7	8	O.L. A	O.L. B	O.L. C
MOVEMENT	NB LT	SB	EB LT	WB	SB LT	NB	WB LT	EB			
CONCURRENT MOVEMENT PERMITTED	5 or 6	5 or 6	7 or 8	7 or 8	1 or 2	1 or 2	3 or 4	3 or 4	9 + 11	2 + 3	1 + 8

RAILROAD TRACK CLEARANCE PHASES: 4 AND 7
 PERMISSIVE PHASES DURING PRE-EMPTION: 1, 2, 3, 6 AND O.L.A, O.L.B
 WITH "NO RIGHT TURN" SIGN ACTIVATED

EXISTING									
PHASE Ø	1	2	3	4	5	6	7	8	O.L. A
MOVEMENT	NB LT	SB	EB LT	WB	SB LT	NB	WB LT	EB	
CONCURRENT MOVEMENT PERMITTED	5 or 6	5 or 6	7 or 8	7 or 8	1 or 2	1 or 2	3 or 4	3 or 4	9 + 11

RAILROAD TRACK CLEARANCE PHASES: 9 AND 11 TERMINATE OVERLAP A
 HOLD PHASES DURING PRE-EMPTION: 1, 2, 3 AND 6
 WITH "NO RIGHT TURN" SIGN ACTIVATED
 PHASE REVERSAL: PHASES 3 & 4

TRAFFIC SIGNAL FACES

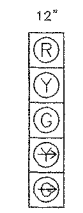

PROPOSED

FAP ROUTE	SECTION	COUNTY	TOTAL SHEETS	SHEET NO.
X	X	MADISON		
JOB NO.		ILLINOIS		

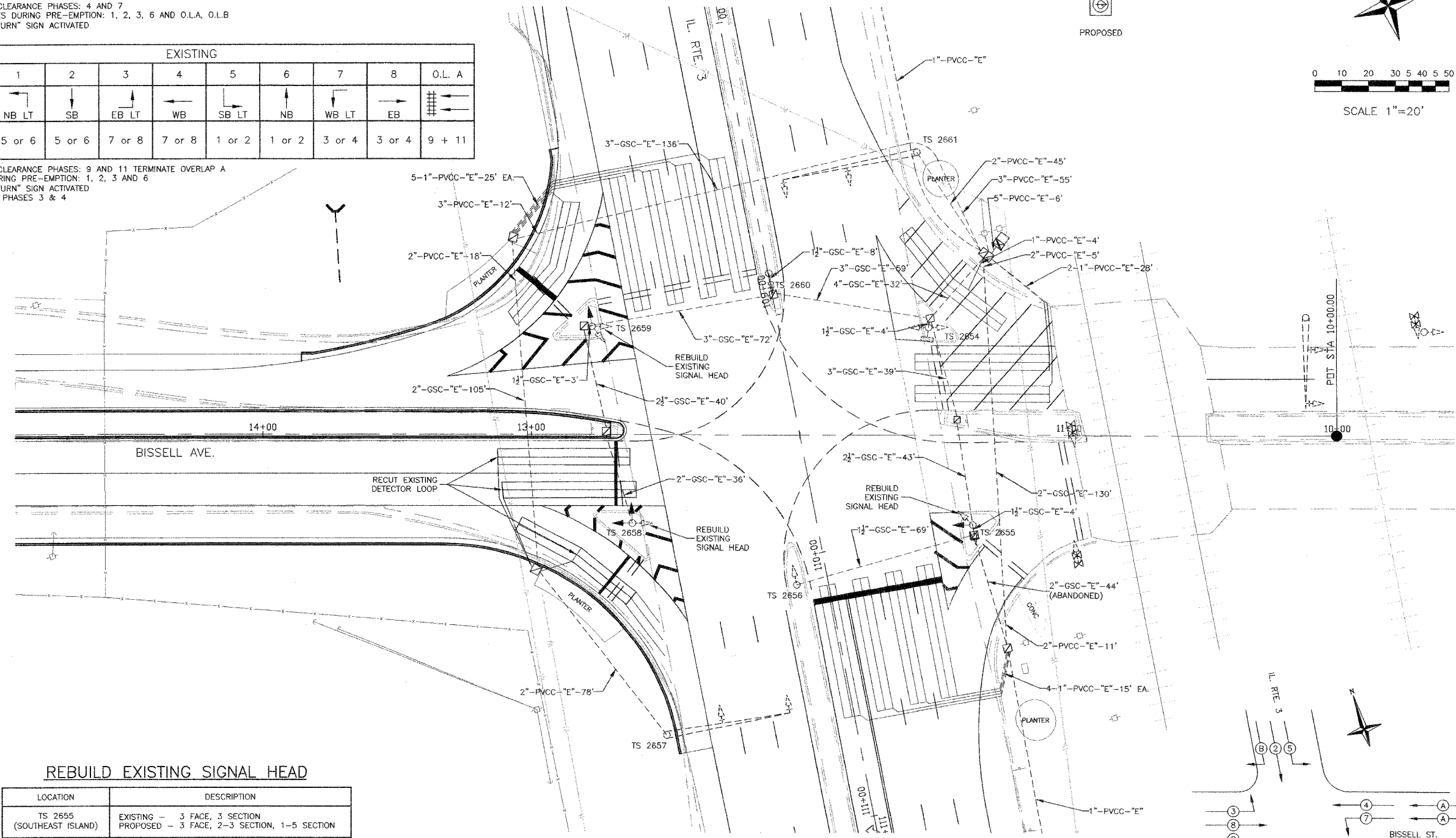
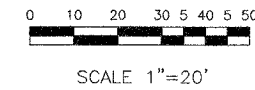

REBUILD EXISTING SIGNAL HEAD

LOCATION	DESCRIPTION
TS 2655 (SOUTHEAST ISLAND)	EXISTING - 3 FACE, 3 SECTION PROPOSED - 3 FACE, 2-3 SECTION, 1-5 SECTION
TS 2658 (SOUTHWEST ISLAND)	EXISTING - 2 FACE, 1-3 SECTION, 1-5 SECTION PROPOSED - 3 FACE, 5 SECTION
TS 2659 (NORTHWEST ISLAND)	EXISTING - 3 FACE, 3 SECTION PROPOSED - 3 FACE, 2-3 SECTION, 1-5 SECTION

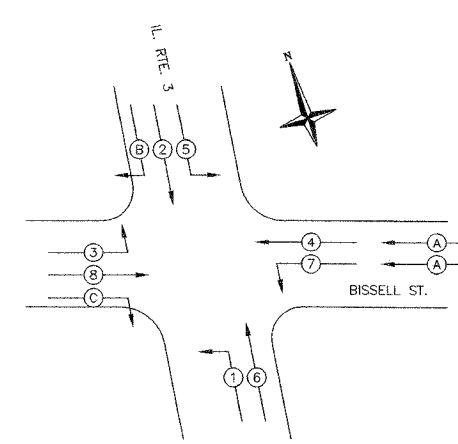

PHASE DESIGNATION DIAGRAM

SHEET NO.

69

Job No. 046-06
 Date: 11/15/06
 Scale: 1" = 20'
 Drawn by: A.J.T.
 Design by: K.W.
 Approved by: C.M.B.
 File Name: TS046-06

REVISIONS

CBB Crawford, Bunte, Brammeier
 Traffic and Transportation Engineers
 St. Louis, Missouri/Glen Carbon, Illinois
 314-878-6644 618-656-2612
 Fax: 314-878-5876 E-Mail: cbb@cbbtraffic.com

TRAFFIC SIGNAL PLAN

IL. RTE. 3 & BISSELL AVE.
GRANITE CITY, ILLINOIS