

F.A.U. RTE.	SECTION	COUNTY	TOTAL SHEETS	SHEET NO.
9104	05-00001-00-WR	MADISON	102	77
FED. ROAD DIST. NO.	ILLINOIS	FED. AID PROJECT		

CONTRACT NO. 87314

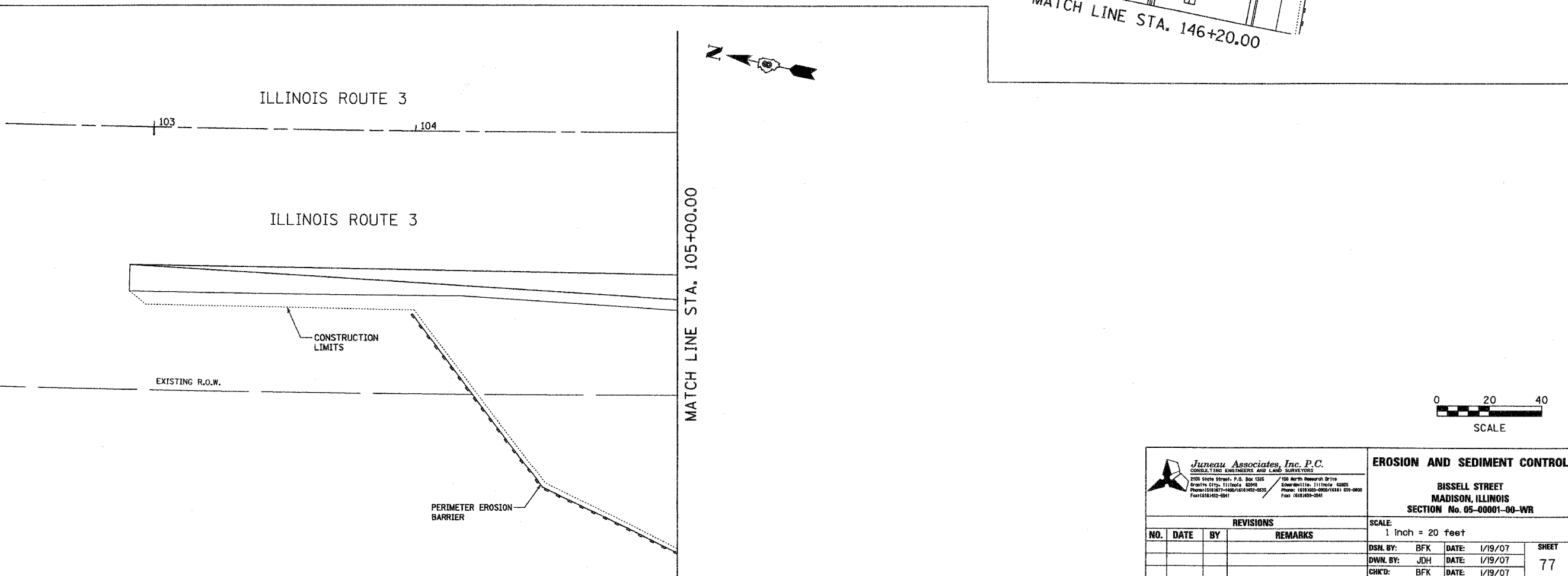
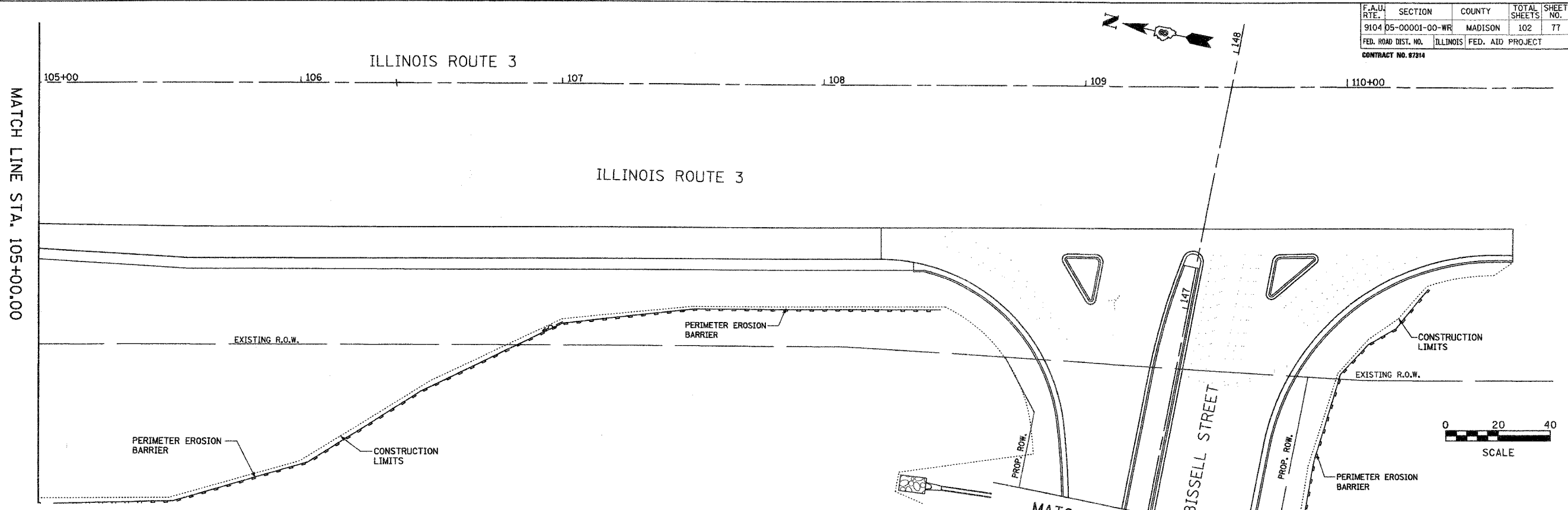

FINAL SURVEY	DATE
SURVEYED	
PLOTTED	
NOTE BOOK	
TEMP. PLATE	
AREAS CHECKED	
NO.	

ORIGINAL SURVEY	DATE
SURVEYED	
PLOTTED	
NOTE BOOK	
TEMP. PLATE	
AREAS CHECKED	
NO.	

**Juneau Associates, Inc. P.C.**  
 CONSULTING ENGINEERS AND LAND SURVEYORS  
 2100 North Street, P.O. Box 1225  
 South Peoria, Illinois 62590  
 Phone: (318) 363-4000 / (318) 363-4005  
 Fax: (318) 363-0541

**EROSION AND SEDIMENT CONTROL**  
 BISSELL STREET  
 MADISON, ILLINOIS  
 SECTION No. 05-00001-00-WR

REVISIONS			
NO.	DATE	BY	REMARKS

SCALE: 1 inch = 20 feet	
DSN. BY: BFK	DATE: 1/19/07
DWN. BY: JDH	DATE: 1/19/07
CHK'D: BFK	DATE: 1/19/07
JOB NO. E061300	DGN. NAME: ERO4

SHEET  
77

OF 102 SHTS