

ROUTE	SECTION	COUNTY	TOTAL SHEETS	SHEET NUMBER
CH13	04-00069-00-RS	GALLATIN	25	6
POUNDS HOLLOW ROAD		FAS ROUTE 934		
CONTRACT NO. 99264				

NE 1/4 NE 1/4  
SEC 36 T10S R8E  
UNITED STATES OF AMERICA

STA 103+30  
EXISTING 18" DIA. CMPC 52'  
PIPE CULVERT REMOVAL 52 FOOT  
P CUL 2 RCCP 18 - 58 FOOT  
PRC FLAR END SEC 18 - 1 LT & 1 RT  
FL 26' LT ELEV 637.1  
FL 32' RT ELEV 634.8

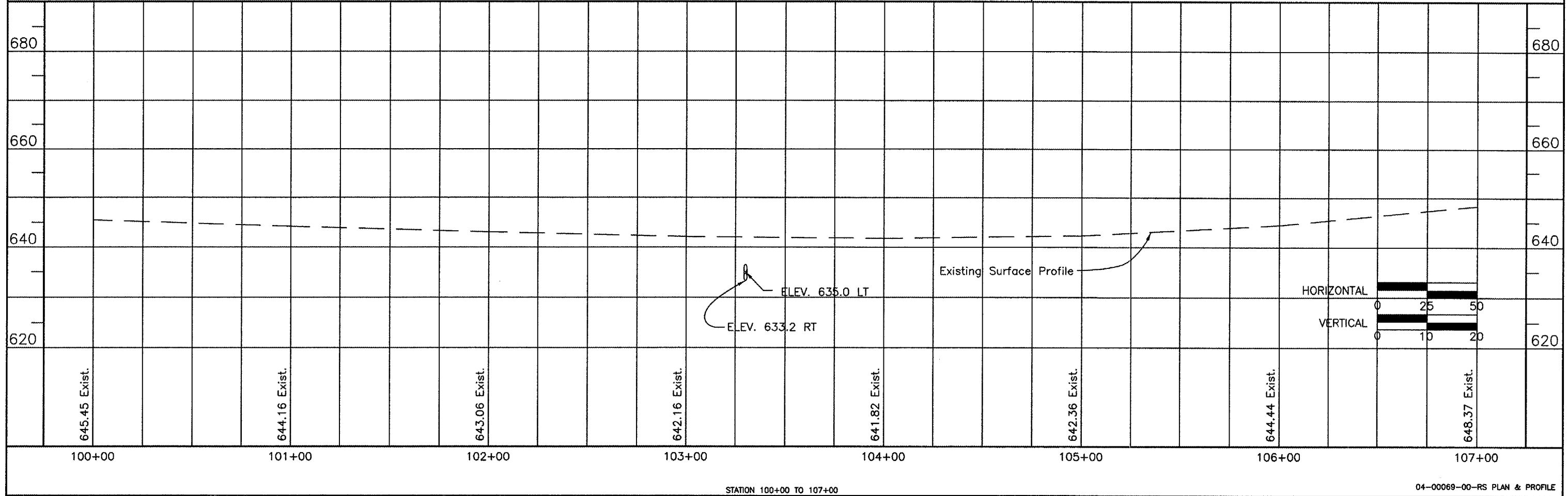
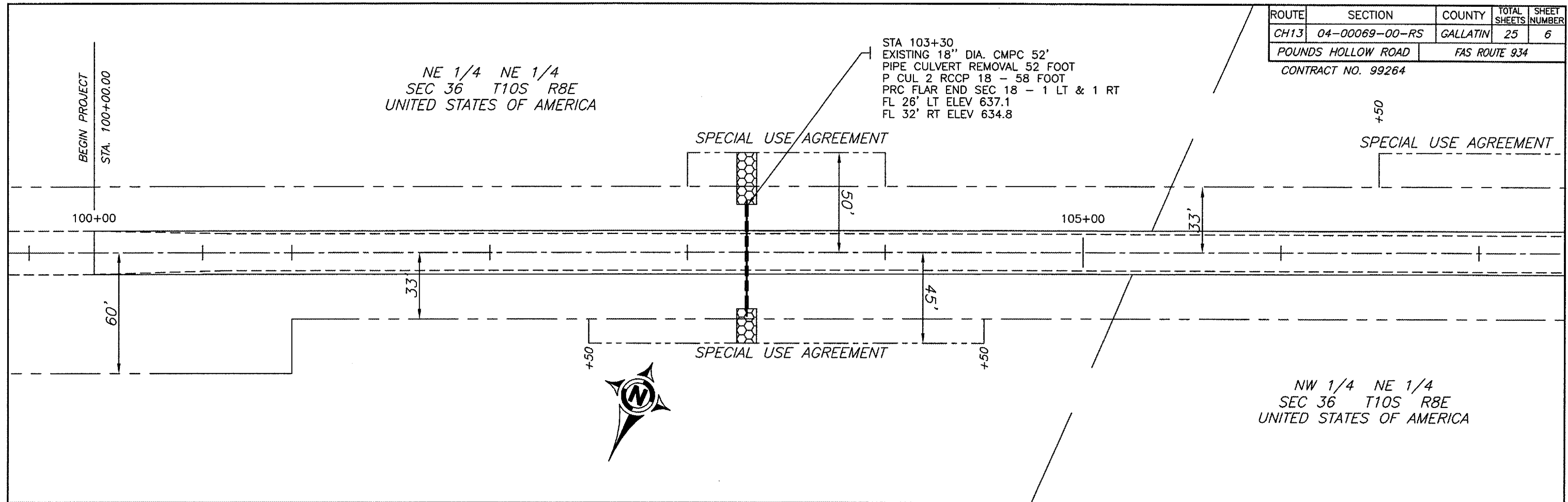

645.45 Exist.      644.16 Exist.      643.06 Exist.      642.16 Exist.      641.82 Exist.      642.36 Exist.      644.44 Exist.      648.37 Exist.

100+00      101+00      102+00      103+00      104+00      105+00      106+00      107+00

STATION 100+00 TO 107+00

04-00069-00-RS PLAN & PROFILE