

03 Apr 2006 - 6:53pm E:\Gallatin County\04-00069-00-RS\ac\cross sections.dwg

PROPOSED SPECIAL USE PERMIT 50' RT

| ROUTE | SECTION        | COUNTY   | TOTAL SHEETS | SHEET NUMBER |
|-------|----------------|----------|--------------|--------------|
| CH 13 | 05-00069-00-RS | GALLATIN | 25           | 24           |

POUNDS HOLLOW ROAD (FAS ROUTE 934)

CONTRACT NO. 99264

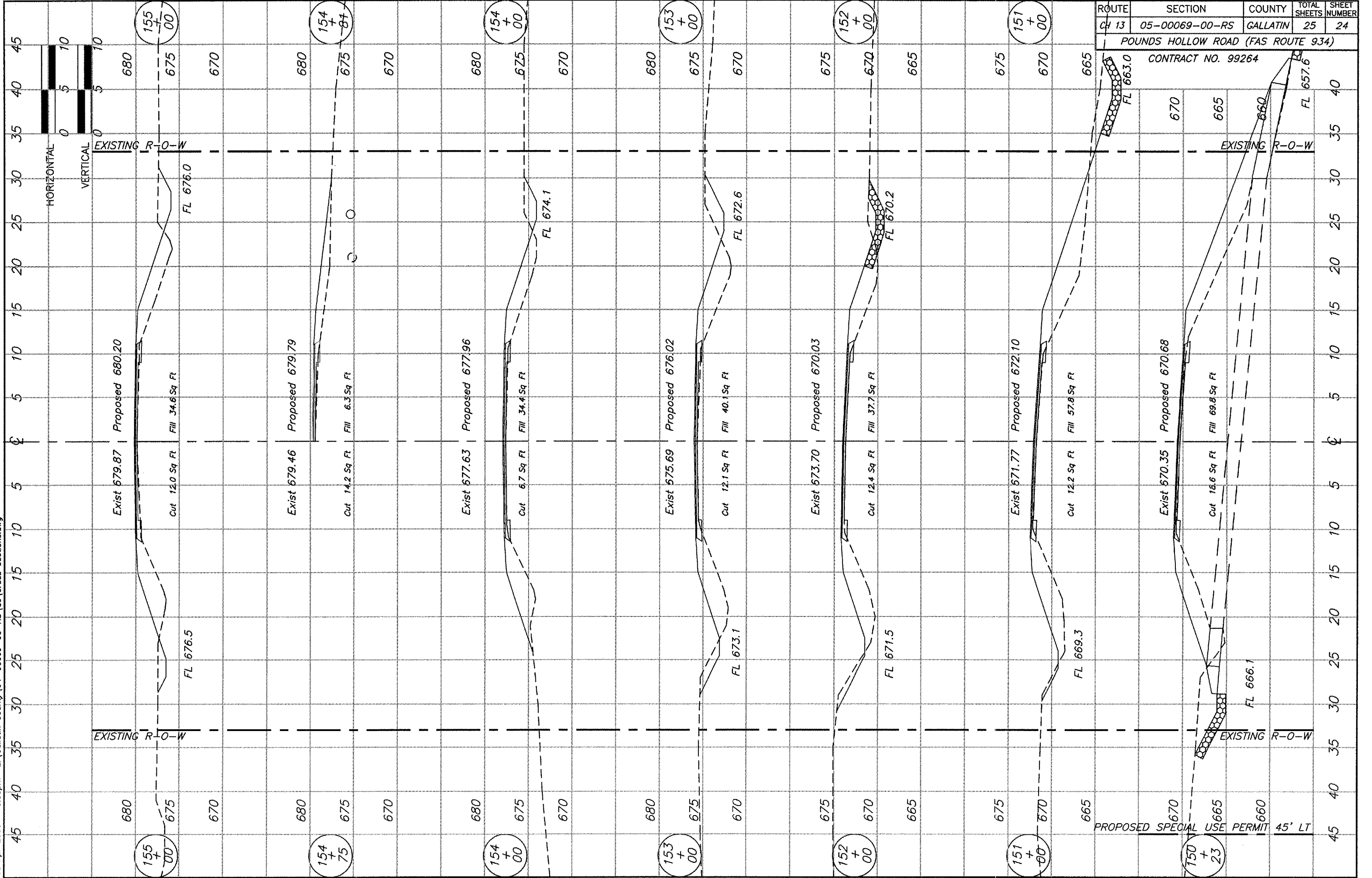

PROPOSED SPECIAL USE PERMIT 45' LT