

CITY OF WEST FRANKFORT

PLANS FOR DOWNTOWN STREETScape

ROUTE	SECTION	COUNTY	TOTAL SHEETS	SHEET NO.
	06-00054-00-SW	FRANKLIN	9	1
WEST FRANKFORT		MAIN STREET		

CONTRACT NO. 99302
PROJECT NO. TE-00D9(93)

ILLINOIS TRANSPORTATION ENHANCEMENT PROGRAM

PROJECT NO. TE-00D9(93)

SECTION 06-00054-00-SW

JOB NO. C-99-500-07

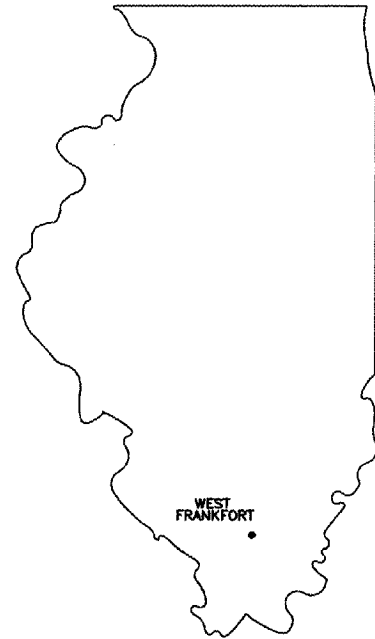

PROPOSED IMPROVEMENTS

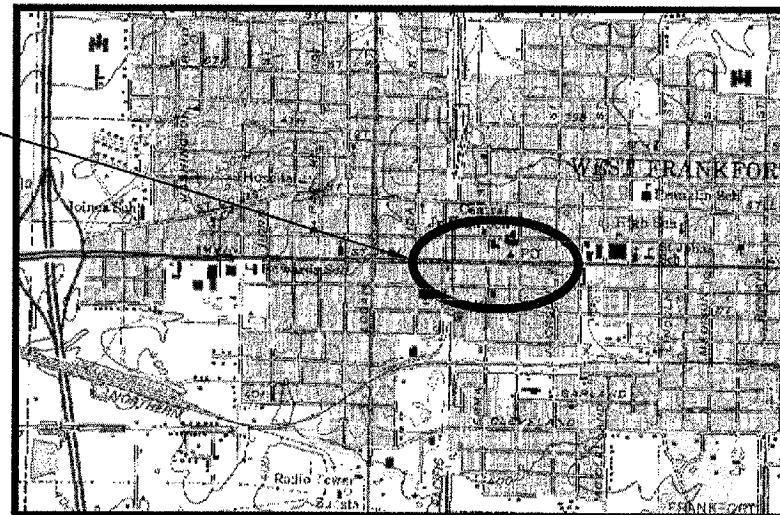

LOCATION MAP APPROXIMATE SCALE: 1" = 0.5 MI.
LENGTH OF IMPROVEMENT = 900 FEET (0.17 MILES)

INDEX OF SHEETS

- 1 COVER SHEET
- 2 SUMMARY OF QUANTITIES AND MATERIAL SCHEDULES
- 3 TYPICAL DETAILS
- 4-7 PLAN VIEW
- 8-9 ELECTRICAL DETAILS

HIGHWAY STANDARDS

- 000001-04 STANDARD SYMBOLS, ABBREVIATIONS & PATTERNS
- 701006-02 OFF RD OP, 2L, 2W, 15' TO EOP
- 701301-02 LANE CLOS., 2L, 2W, SHORT TIME OPERATIONS
- 702501-03 URBAN LANE CLOS., 2L, 2W
- 701801-03 LANE CLOS., CROSSWALK CLOS.
- 702001-06 TRAFFIC CONTROL DEVICES

UTILITIES

ALL EXISTING UTILITIES AND LOCATIONS TO BE CONFIRMED BY J.U.L.I.E. 800-892-0123

Jim W. Brown
JIM W. BROWN, PRESIDENT
ILLINOIS PROFESSIONAL DESIGN FIRM
LAND SURVEY & PROF. ENG. CORP.
NUMBER 184-002518
EXPIRES APRIL 30, 2009
DATE: MAY 31 2007

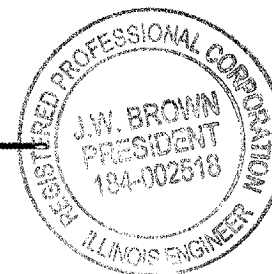

BROWN AND ROBERTS, INC.
CONSULTING ENGINEERS AND LAND SURVEYORS

1 WEST RIDGE ROAD HARRISBURG, IL 62946 (618) 252-8111

CITY OF WEST FRANKFORT

APPROVED 5/31/2007

Marion Presley
MAYOR, CITY OF WEST FRANKFORT

PASSED JUNE 1, 2007

Dani W. Hill
DISTRICT 9 ENGINEER OF LOCAL ROADS & STREETS

RELEASING FOR BID
BASED ON LIMITED
REVIEW

Mary C. Lamie
JUNE 5, 2007

MARY C. LAMIE, P.E.
DEPUTY DIRECTOR OF HIGHWAYS
REGION FIVE ENGINEER

B.R.I. JOB NO. 05-136

ROUTE	SECTION	COUNTY	TOTAL SHEETS	SHEET NO.
	06-00054-00-SW	FRANKLIN	9	3
WEST FRANKFORT		MAIN STREET		

CONTRACT NO. 99302
PROJECT NO. TE-00D9(93)

BROWN AND ROBERTS, INC.
CONSULTING ENGINEERS & LAND SURVEYORS
1 WEST RIDGE ROAD HARRISBURG, IL. 62946 (618) 252-8111

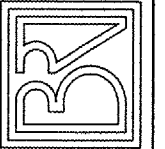

CITY OF WEST FRANKFORT
STREETSCAPE IMPROVEMENTS
TYPICAL DETAILS

Drawn By:	Checked By:
ECB	MWR
Revisions	
Item	Date By
Scale:	Field Bk:
AS SHOWN	
Job Number:	Date:
05-136	03/2007
Sheet	

3
of 9

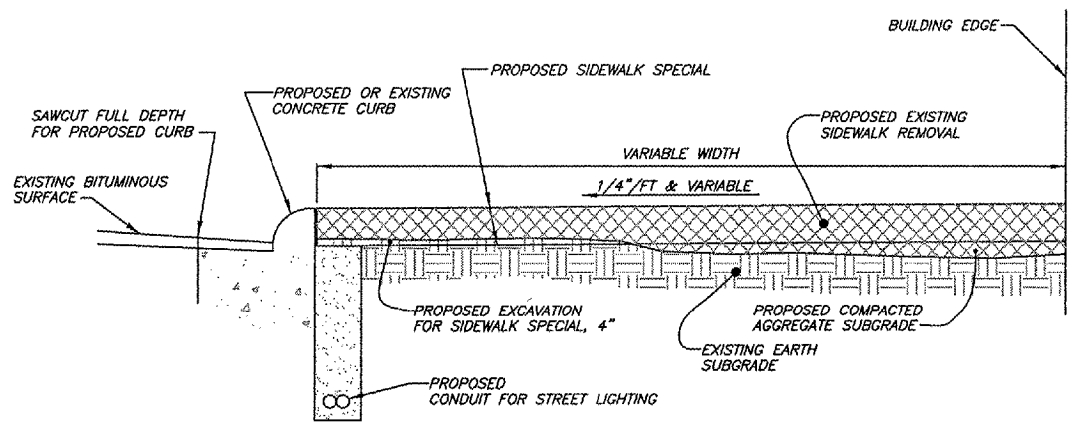

TYPICAL SECTION
NO SCALE

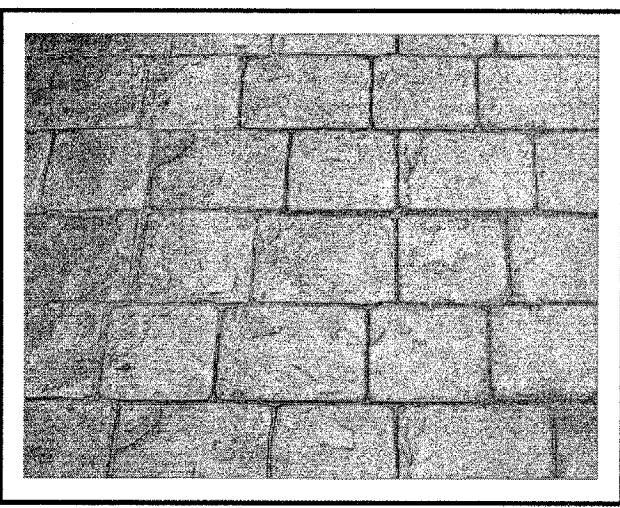

TYPICAL PATTERN
PROPOSED SIDEWALK SPECIAL
NO SCALE

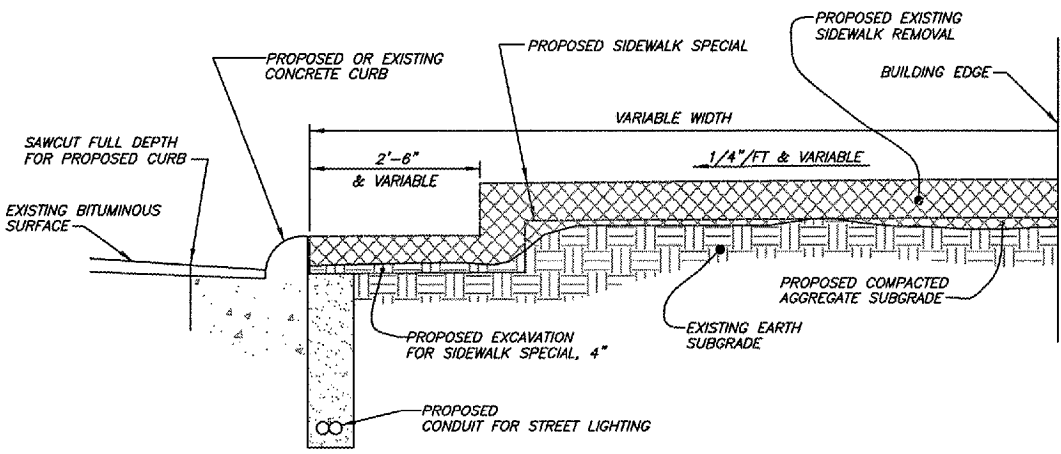

TYPICAL SECTION
STATION 3+78 RT TO 4+27 RT
STATION 4+91 LT TO 7+14 LT
STATION 4+96 RT TO 6+41 LT
STATION 6+71 RT TO 8+32 RT
NO SCALE

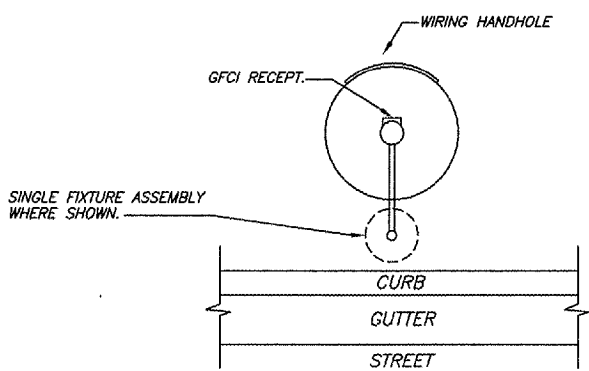

FIXTURE AND ACCESSORY ORIENTATION
NO SCALE

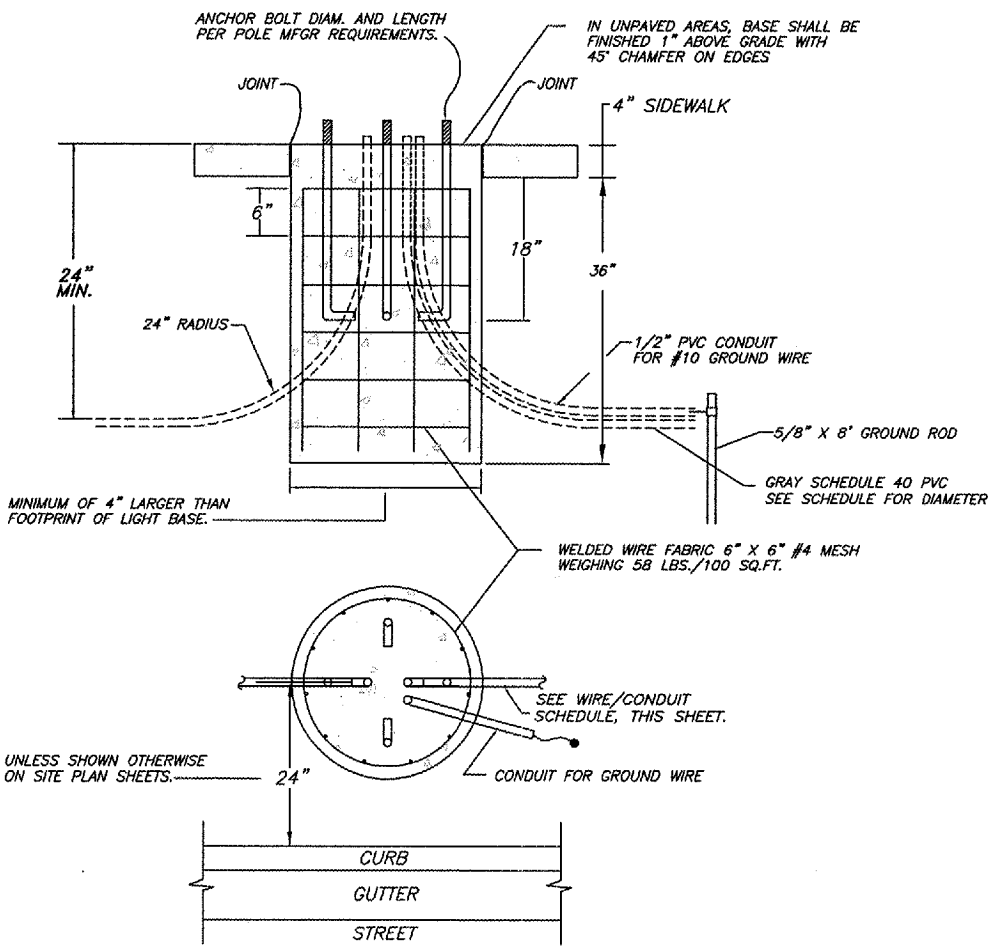









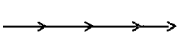
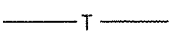
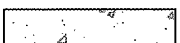

LIGHT POLE FOUNDATION
NO SCALE

31 May 2007 - 8:34am X:\2005\05136\loc\plans\quantity and detail sheets.dwg: Layout Tab 'Model'

ROUTE	SECTION	COUNTY	TOTAL SHEETS	SHEET NO.
WEST FRANKFORT	06-00054-00-SW	FRANKLIN	9	4
WEST FRANKFORT		MAIN STREET		

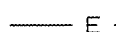
CONTRACT NO. 99302
PROJECT NO. TE-00D9(93)

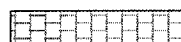
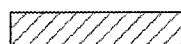
LEGEND

-  EXISTING STREET LIGHT
-  EXISTING TREE TO BE REMOVED
-  EXISTING OVERHEAD ELECTRIC
-  EXISTING OVERHEAD TELEPHONE
-  EXISTING CONCRETE TO REMAIN
-  EXISTING GRASS AREA
-  EXISTING TRASH RECEPTACLE
-  EXISTING FIRE HYDRANT
-  PROPOSED UNDERGROUND ELECTRICAL IN CONDUIT
-  PROPOSED PERIOD STREET LAMP
-  PROPOSED SIDEWALK SPECIAL
-  PROPOSED PC SIDEWALK 4"
-  PROPOSED ELECTRICAL PULL BOX
-  PROPOSED DETECTABLE WARNING

- ① STREET AND ALLEY CROSSINGS SHALL BE BORED FOR CONDUIT PLACEMENT. REMAINDER OF INSTALLATION BELOW PAVED SURFACE SHALL BE BORED OR TRENCHED.
- ③ SEE WIRE AND CONDUIT SCHEDULE, SHEET 8.

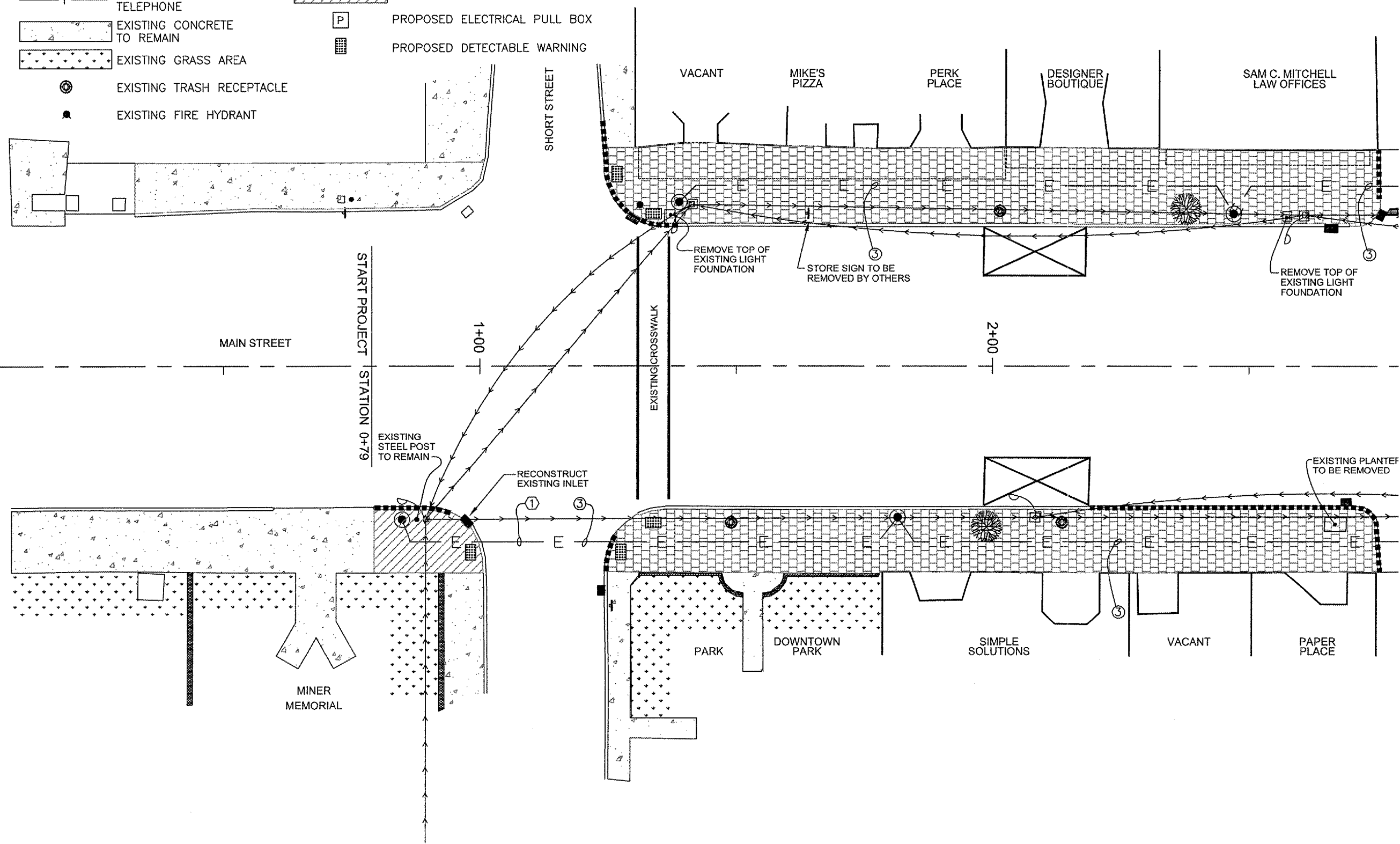

BROWN AND ROBERTS, INC.
CONSULTING ENGINEERS & LAND SURVEYORS
1 WEST RIDGE ROAD HARRISBURG, IL 62946 (618) 252-8111

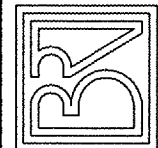

CITY OF WEST FRANKFORT
STREETSCAPE IMPROVEMENTS
PLAN VIEW

Drawn By: ECB
Checked By: MWR

Revisions		
Item	Date	By

Scale: AS SHOWN
Field Bk:

Job Number: 05-136
Date: 03/2007

Sheet

4

of 9

- ① STREET AND ALLEY CROSSINGS SHALL BE BORED FOR CONDUIT PLACEMENT. REMAINDER OF INSTALLATION BELOW PAVED SURFACE SHALL BE BORED OR TRENCHED.
- ② PRECAST POLYMER CONCRETE SUBGRADE PULL BOX, 12"X12"X12" DEEP WITH OPEN BOTTOM AND ANSI TIER 15 DESIGN AND TEST LOADS - QUAZITE #PC1212BA12 WITH COVER #PC1212HA00. COVER LOGO SHALL READ "ELECTRIC". FINAL ELEVATION SHALL BE FLUSH WITH SURROUNDING SIDEWALK. BOX SHALL BE FOR PULLING PURPOSES ONLY. NO SPLICES ALLOWED WITHIN BOX.
- ③ INSTALL SERVICE RISER UP POLE TO HEIGHT REQUIRED BY AMEREN AND TERMINATE WITH A WEATHERHEAD.
- ④ SEE SERVICE DETAIL, SHEET 8.
- ①②③ SEE WIRE AND CONDUIT SCHEDULE, SHEET 8.

ROUTE	SECTION	COUNTY	TOTAL SHEETS	SHEET NO.
	06-00054-00-SW	FRANKLIN	9	5
WEST FRANKFORT		MAIN STREET		

CONTRACT NO. 99302
PROJECT NO. TE-00D9(93)

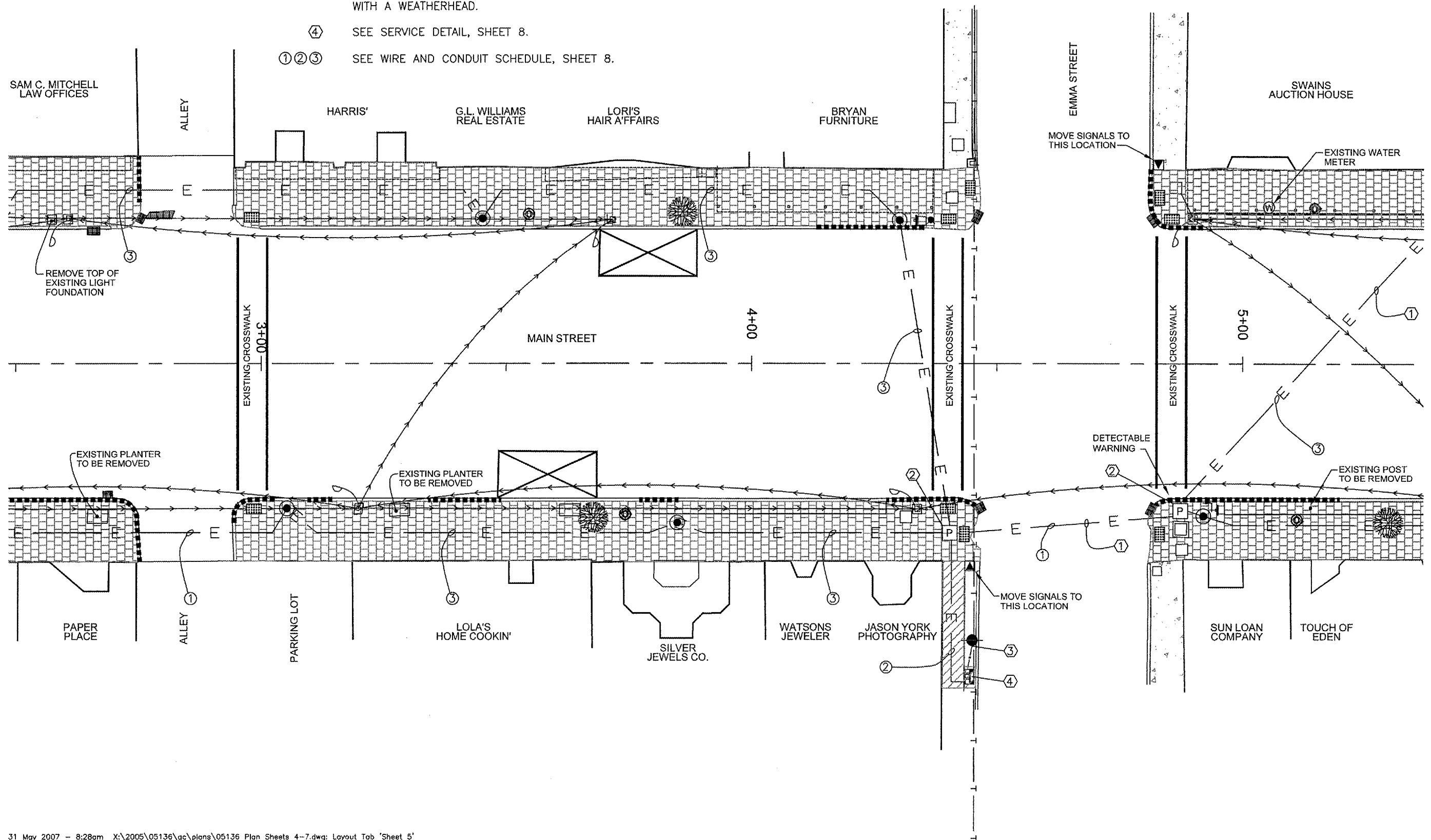

BROWN AND ROBERTS, INC.
CONSULTING ENGINEERS & LAND SURVEYORS
1 WEST RIDGE ROAD HARRISBURG, IL 62946 (618) 252-8111

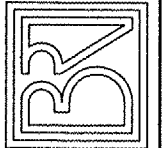

CITY OF WEST FRANKFORT
STREETSCAPE IMPROVEMENTS
TYPICAL DETAILS

Drawn By: ECB
Checked By: MWR

Revisions		
Item	Date	By

Scale: AS SHOWN
Field Bk:

Job Number: 05-136
Date: 03/2007

Sheet

5

of 9

ROUTE	SECTION	COUNTY	TOTAL SHEETS	SHEET NO.
	06-00054-00-SW	FRANKLIN	9	6
WEST FRANKFORT		MAIN STREET		

CONTRACT NO. 99302
PROJECT NO. TE-00D9(93)

BROWN AND ROBERTS, INC.
CONSULTING ENGINEERS & LAND SURVEYORS
1 WEST RIDGE ROAD HARRISBURG, IL. 62946 (618) 252-8111

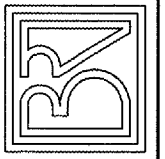

CITY OF WEST FRANKFORT
STREETSCAPE IMPROVEMENTS
TYPICAL DETAILS

- ① STREET AND ALLEY CROSSINGS SHALL BE BORED FOR CONDUIT PLACEMENT. REMAINDER OF INSTALLATION BELOW PAVED SURFACE SHALL BE BORED OR TRENCHED.
- ③ SEE WIRE AND CONDUIT SCHEDULE, SHEET 8.

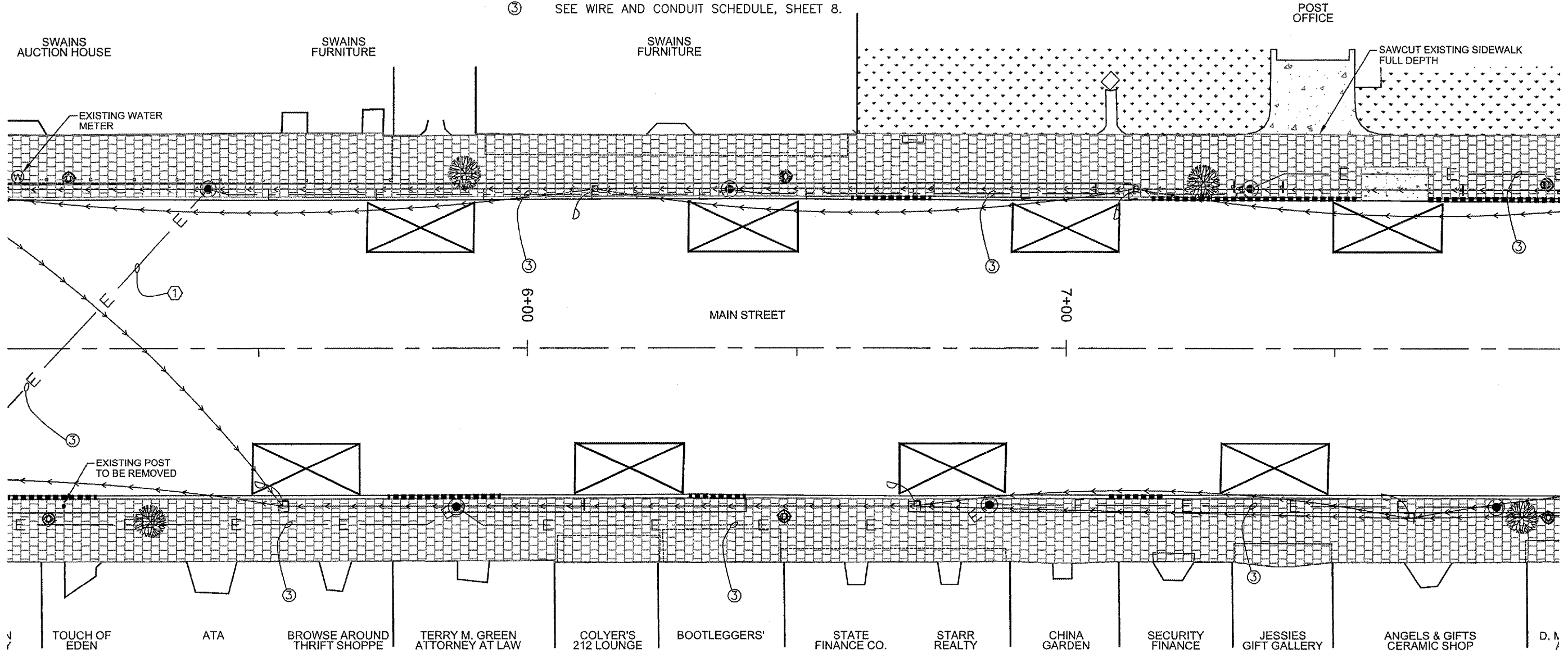

Drawn By: ECB
Checked By: MWR

Revisions		
Item	Date	By

Scale: AS SHOWN
Field Bk:
Job Number: 05-136
Date: 03/2007

Sheet
6
of 9

ROUTE	SECTION	COUNTY	TOTAL SHEETS	SHEET NO.
	06-00054-00-SW	FRANKLIN	9	7
WEST FRANKFORT		MAIN STREET		

CONTRACT NO. 99302
PROJECT NO. TE-00D9(93)

- ① STREET AND ALLEY CROSSINGS SHALL BE BORED FOR CONDUIT PLACEMENT. REMAINDER OF INSTALLATION BELOW PAVED SURFACE SHALL BE BORED OR TRENCHED.
- ③ SEE WIRE AND CONDUIT SCHEDULE, SHEET 8.

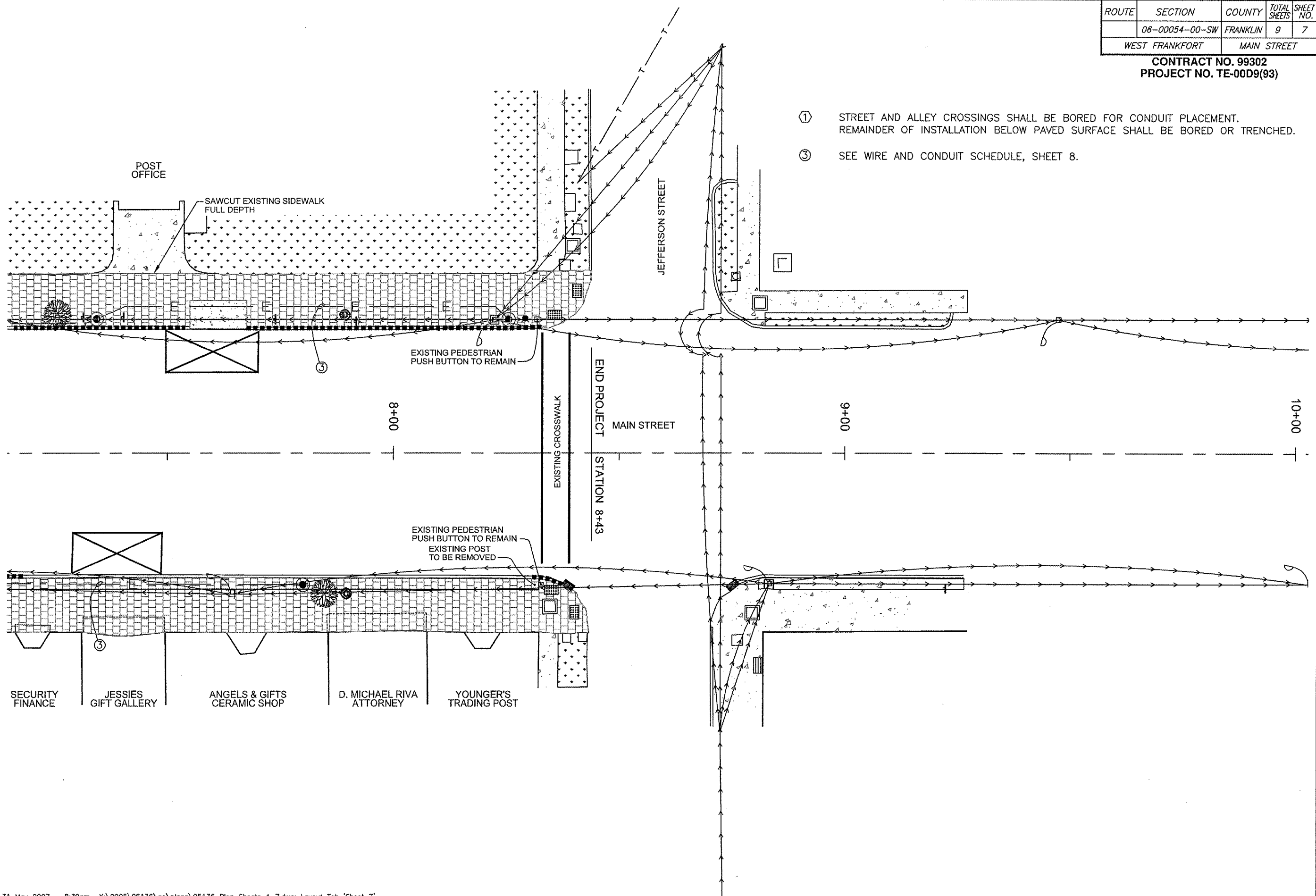

BROWN AND ROBERTS, INC.
CONSULTING ENGINEERS & LAND SURVEYORS
1 WEST RIDGE ROAD HARRISBURG, IL 62946 (618) 252-8111

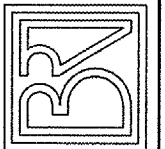

CITY OF WEST FRANKFORT
STREETSCAPE IMPROVEMENTS
TYPICAL DETAILS

Drawn By: ECB
Checked By: MWR

Revisions		
Item	Date	By

Scale: AS SHOWN
Field Bk:

Job Number: 05-136
Date: 03/2007

Sheet
7
of 9

ROUTE	SECTION	COUNTY	TOTAL SHEETS	SHEET NO.
	06-00054-00-SW	FRANKLIN	9	8
WEST FRANKFORT		MAIN STREET		

CONTRACT NO. 99302
PROJECT NO. TE-00D9(93)

BROWN AND ROBERTS, INC.
CONSULTING ENGINEERS & LAND SURVEYORS
1 WEST RIDGE ROAD HARRISBURG, IL 62946 (618) 252-8111

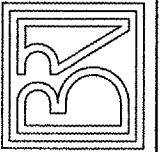

CITY OF WEST FRANKFORT
STREETSCAPE IMPROVEMENTS
TYPICAL DETAILS

Drawn By:	Checked By:
ECB	MWR
Revisions	
Item	Date By
Scale:	Field Bk:
AS SHOWN	
Job Number:	Date:
05-136	03/2007
Sheet	

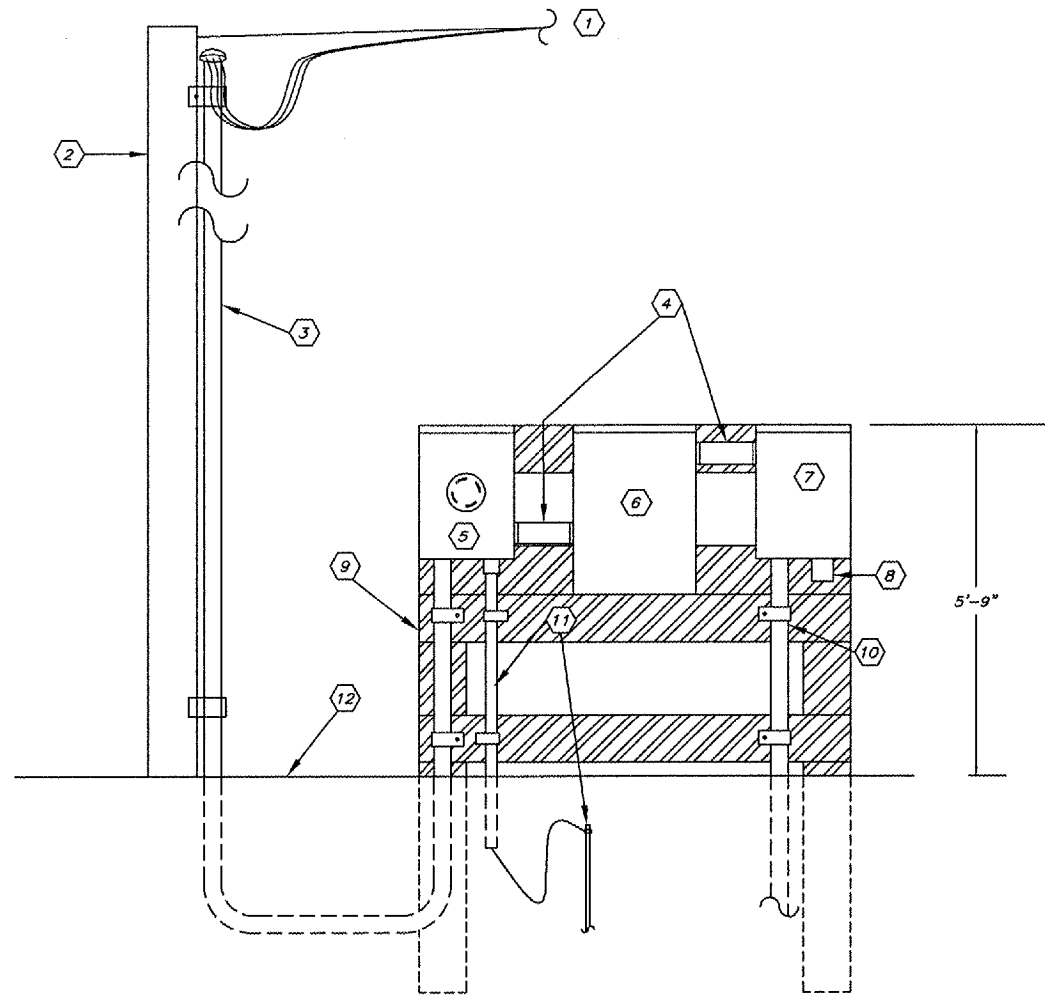

SERVICE AND CONTROL EQUIPMENT
NO SCALE

DETAIL NOTES

- ① OVERHEAD 100 AMP, 120/240 VOLT SERVICE DROP BY AMEREN CIPS.
- ② EXISTING UTILITY POLE
- ③ STUB SERVICE RISER UP POLE TO HEIGHT REQUIRED BY AMEREN AND TERMINATE WITH A WEATHERHEAD.
- ④ SEE 1-LINE DIAGRAMS, THIS SHEET.
- ⑤ 100 AMP, 120/240 VOLT, SINGLE PHASE METER BASE BY CONTRACTOR TO AMEREN STANDARDS.
- ⑥ MAIN DISTRIBUTION PANEL (MDP) - 100 AMP, 120/240 VOLT, SINGLE PHASE, 3-WIRE S/N, 20 CIRCUIT, NEMA 3R LOAD CENTER -- SQUARE D #QO120M100RB, OR EQUAL. PROVIDE TYPE QO BRANCH BREAKERS PER SYSTEM 1-LINE DIAGRAM, THIS SHEET.
- ⑦ CONTACTOR PANEL SHALL CONSIST OF TWO SIZE 1, 4-POLE, OPEN LIGHTING CONTACTORS WITH 120 VOLT COIL - SQUARE D, CLASS 8903, #L040V02, OR EQUAL. ENCLOSURE SHALL BE NEMA 4X, 12" x 14" x 6" MINIMUM SIZE, WITH MOUNTING PANEL, AND SHALL BE LOCKABLE.
- ⑧ 1800 WATT, 120 VOLT, SPST, PHOTOCONTROL - PARAGON #LB201, OR EQUAL. MOUNT IN BOTTOM OF PANEL TO FACE DOWN.
- ⑨ TREATED WOOD MOUNTING FRAME SHALL CONSIST OF TWO 6"x6"x9' POSTS, AND SUFFICIENT NUMBER OF 2X6 CROSS-MEMBERS TO PROVIDE TOP AND BOTTOM SUPPORT FOR ALL ENCLOSURES PLUS CONDUIT FASTENING AS SHOWN. LOCATE FRAME WITHIN FOUR FEET OF EXISTING UTILITY POLE. SETBACK FROM CURB LINE SHALL BE DIRECTED BY THE ENGINEER.
- ⑩ 1" PVC FOR BRANCH WIRING. SEE SYSTEM 1-LINE DIAGRAM, THIS SHEET. SEE SHEET 5 FOR CONTINUATION.
- ⑪ 1 - #6 STRANDED COPPER GROUNDING ELECTRODE CONDUCTOR IN 1/2" SCHEDULE 80 PVC FROM NEUTRAL BUS TO 5/8" X 8" GROUND ROD DRIVEN 1' TO THE TOP BELOW GRADE.
- ⑫ SAW CUT, REMOVE AND REPLACE EXISTING CONCRETE AS REQUIRED FOR UNDERGROUND SERVICE AND BRANCH WIRING.

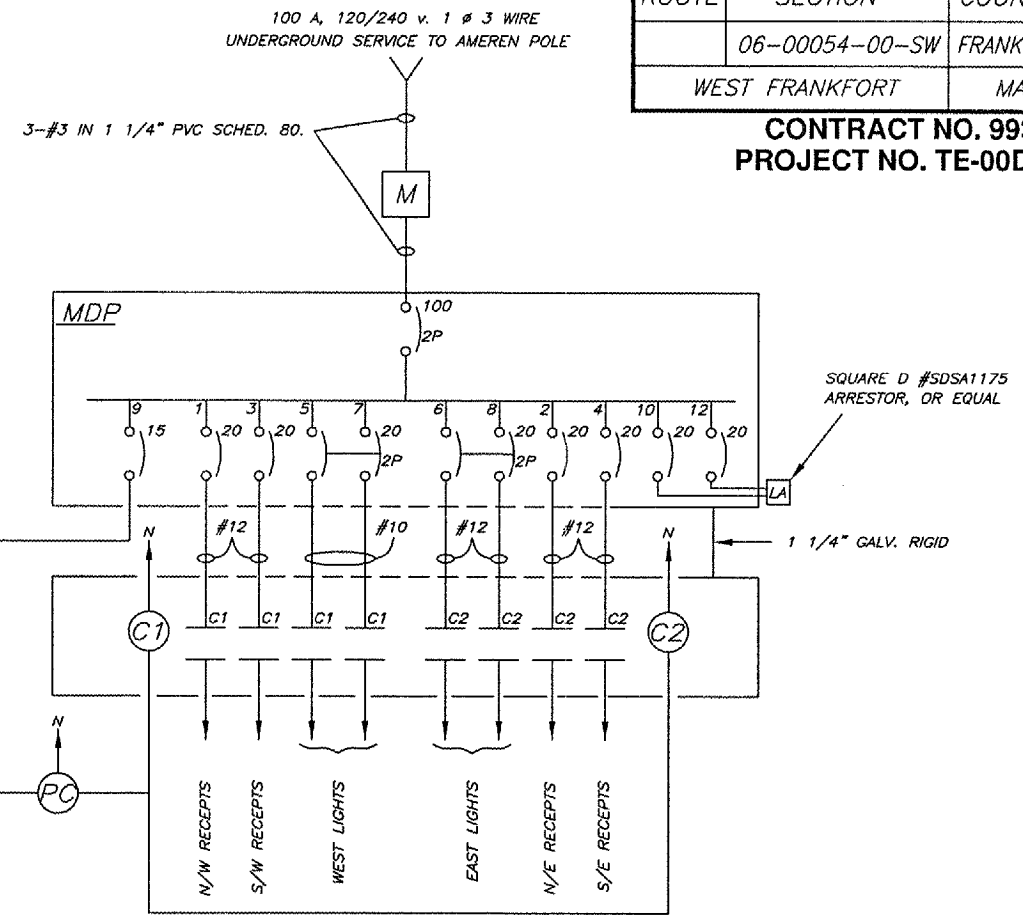

SYSTEM 1 - LINE DIAGRAM

WIRE/CONDUIT SCHEDULE

MARK	PHASE COND.	PHASE COND. QUAN.	EQUIP. GRND.*	CONDUIT SIZE
①	#10	5	#10	3/4"
②	#10	10	#10	1"
③	#10	4	#10	3/4"

* BOND THIS EGC TO THE INDIVIDUAL GROUND ROD AT EACH LIGHT FOUNDATION, SEE DETAIL, THIS SHEET.

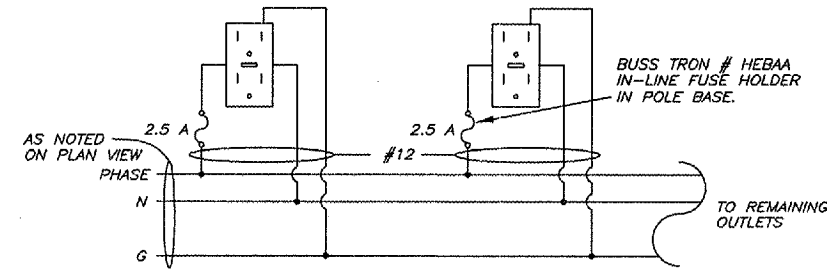

DUPLEX GFI RECEPT PHASE DISTRIBUTION

31 May 2007 - 8:36am X:\2005\05136\plans\quantity and detail sheets.dwg: Layout Tab 'Model'

ROUTE	SECTION	COUNTY	TOTAL SHEETS	SHEET NO.
06-00054-00-SW	WEST FRANKFORT	FRANKLIN	9	9
WEST FRANKFORT		MAIN STREET		

CONTRACT NO. 99302
PROJECT NO. TE-00D9(93)

BROWN AND ROBERTS, INC.
CONSULTING ENGINEERS & LAND SURVEYORS
1 WEST RIDGE ROAD HARRISBURG, IL 62946 (618) 252-8111

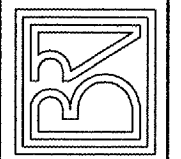

CITY OF WEST FRANKFORT
STREETScape IMPROVEMENTS
IDOT SIGNAL DETAILS

Drawn By:	Checked By:
ECB	MWR
Revisions	
Item	Date By
Scale:	Field Bk:
AS SHOWN	
Job Number:	Date:
05-136	03/2007
Sheet	

TRAFFIC SIGNAL LEGEND

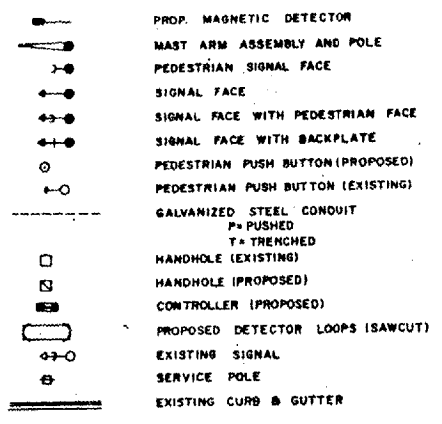

PROPOSED OPERATION TABLE													
NORMAL SEQUENCE - BOTH CONTROLLERS								FIRE LANE SEQUENCE - EMMA ST. ONLY					
PHASE	A				B				NORM A		NORM B		
MOVEMENT	[Diagram]				[Diagram]				SEE A MOVEMENT		SEE B MOVEMENT		
INTERVAL	1	2	3	4	5	6	7	8	FLASH	CALL	CALL	DWELL	CLEAN
MAIN STREET	G	G	Y	R	R	R	R	R	R	G	Y	R	R
CROSS STREET	R	R	R	R	G	G	Y	R	R	R	R	G	Y
INT. TIME	20	10	3.0	0.25	7	13	3.0	0.75	-	3.0	-	3.0	3.0

- NOTES:** WALK, DON'T WALK, & DWELL
- PHASE A SHALL OPERATE SEMI-ACTUATED AND DWELL IN INTERVAL 1.
 - INTERVAL 5, UPON VEHICLE ACTIVATION WITH NO PEDESTRIAN CALL, SHALL TIME AS FOLLOWS: INITIAL = 8 SECONDS, UNIT EXTENSION = 2 SECONDS, AND MAX TIME = 25 SECONDS.
- NOTES: FIRE LANE**
- DURING FL SEQUENCE BOTH CONTROLLERS SHALL RECEIVE "PHASE A" HOLD SIGNALS.
 - ALL TIME SETTINGS SHALL BE DIGITAL, ADJUSTABLE.
 - THE INTERCONNECTION WITH THE FIRE STATION IS IN PLACE.

- NON-METALLIC END BELLS SHALL BE USED ON ALL CONDUITS ENTERING HANDHOLES.
 - NO LOOPS (IN HANDHOLES OR POLE BASES) OR SLACK IN SHIELDED CABLES WILL BE PERMITTED FROM VEHICLE DETECTORS TO THE CONTROLLER.
 - LOOP DETECTOR WIRE SHALL BE NO. 12 AWG. MINIMUM, OF NUMBER OF TURNS AS RECOMMENDED BY THE MANUFACTURER OF THE SIGNAL EQUIPMENT.
 - LOOPS SHALL BE WOUND CLOCKWISE, AND THE BEGINNING LEAD MARKED FOR IDENTIFICATION.
 - EXACT LOCATIONS OF FOUNDATIONS AND DETECTOR LOOPS SHALL BE MARKED BY THE ENGINEER PRIOR TO EXCAVATING OR SAW CUTTING.
 - ALL TRAFFIC SIGNAL FOUNDATION CENTERS SHALL BE A MINIMUM OF 3 FEET FROM THE CURB FACE. LOCATION IN FIELD APPROVED BY THE ENGINEER.
- ALL CONDUITS STUBBED INTO FOUNDATIONS SHALL BE EQUIPPED WITH INSULATED-THROAT BONDING BUSHINGS AND GROUNDED ACCORDINGLY.
 - ANY SIDEWALK, CURB AND GUTTER, DRIVEWAY, OR STREET SURFACE WHICH REQUIRES REMOVAL FOR THE INSTALLATION OF ANY TRAFFIC SIGNAL EQUIPMENT, HANDHOLES, OR CONDUITS, SHALL BE SAWCUT OR REMOVED TO AN EXISTING JOINT, AND REPLACED OR REPAIRED TO THE SATISFACTION OF THE ENGINEER. THIS WORK SHALL BE CONSIDERED AS INCIDENTAL TO THE PARTICULAR EQUIPMENT OR MATERIAL BEING INSTALLED, UNLESS OTHERWISE SPECIFIED, AND NO ADDITIONAL COMPENSATION ALLOWED.
 - THE CONTRACTOR SHALL COORDINATE THE CONSTRUCTION OF THESE FACILITIES WITH THE FOLLOWING PUBLIC AND PRIVATE UTILITY COMPANIES:
GENERAL TELEPHONE COMPANY, MARION, ILLINOIS
CENTRAL ILLINOIS PUBLIC SERVICE COMPANY, MARION, ILLINOIS
CITY OF WEST FRANKFORT, STREET DEPARTMENT, WEST FRANKFORT, ILLINOIS
CITY OF WEST FRANKFORT, WATER & SEWER DEPARTMENT, WEST FRANKFORT, ILLINOIS
 - ALL INSTALLATION COST CHARGED BY THE UTILITY COMPANIES SHALL BE BORNE BY THE CONTRACTOR.

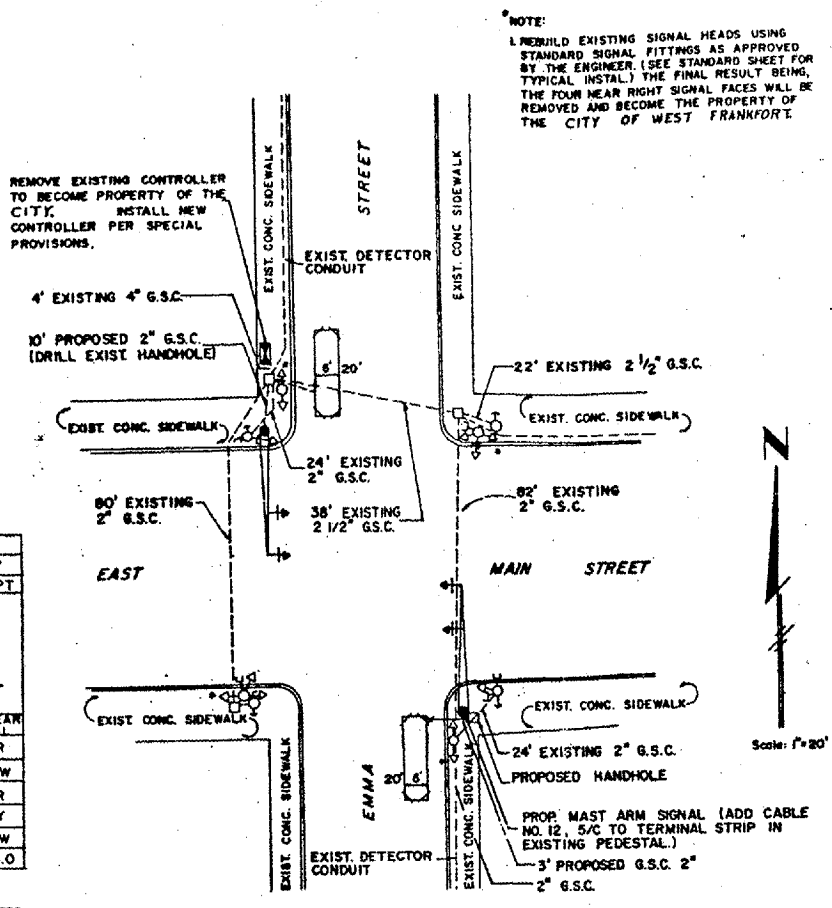

DETAIL OF INTERSECTION
MAIN & EMMA INTERSECTION

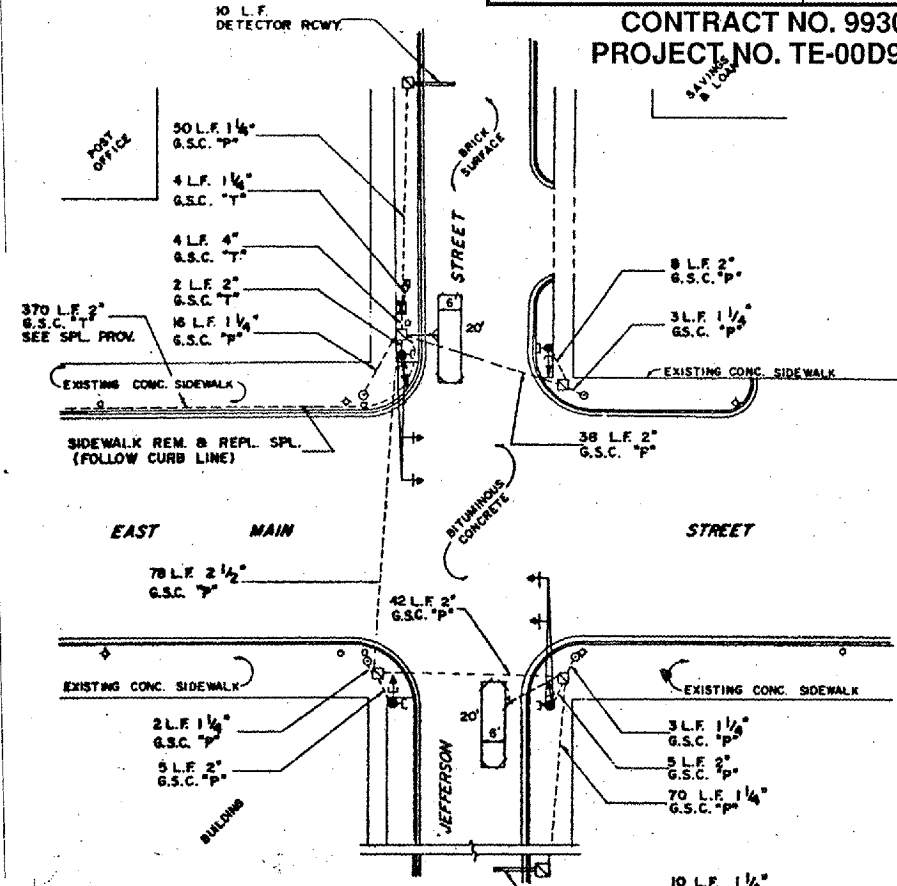
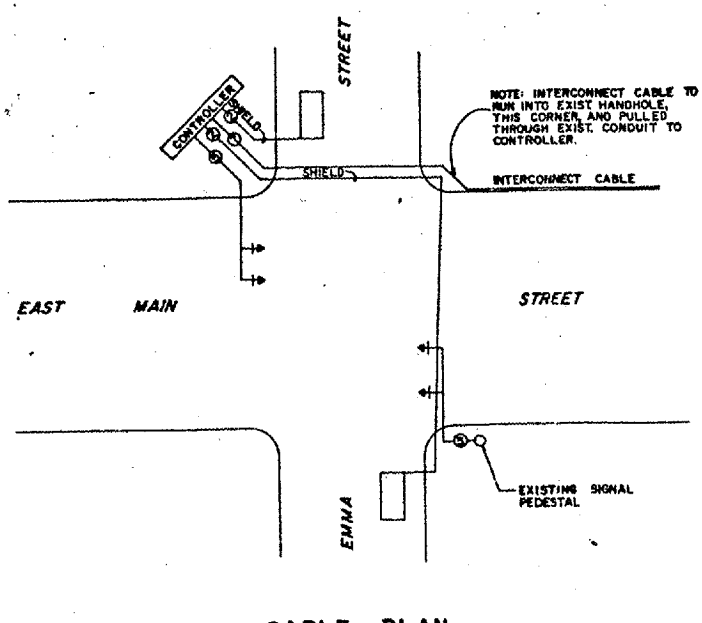

DETAIL OF INTERSECTION
MAIN & JEFFERSON INTERSECTION

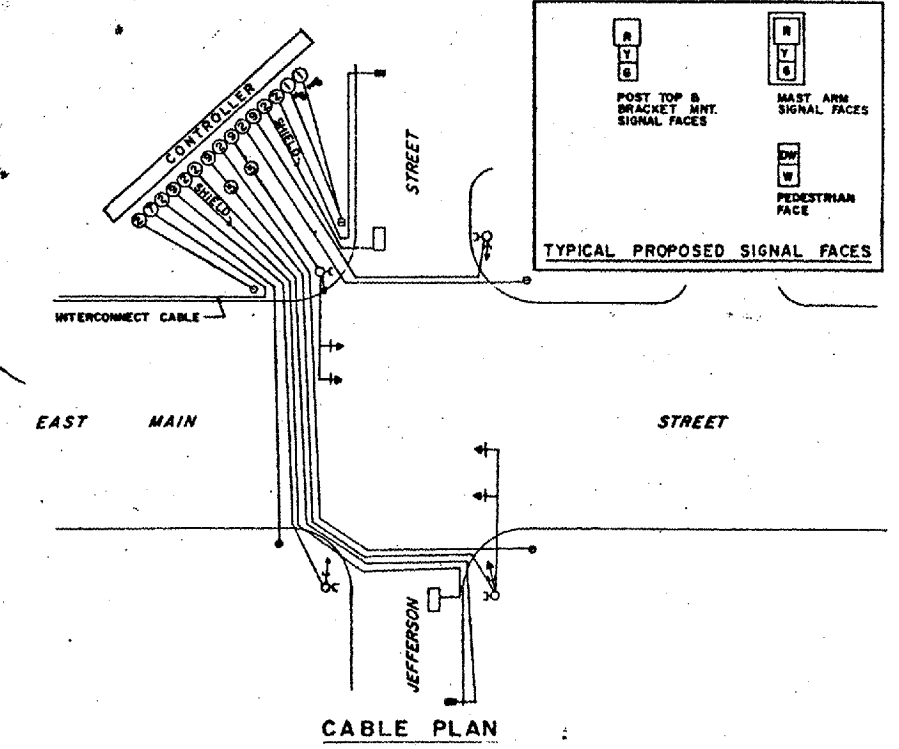

31 May 2007 - 8:35am X:\2005\05136\plans\quantity and detail sheets.dwg: Layout Tab Model