

# CONSTRUCTION PLANS FOR MID-AMERICAN AIR CENTER LAWRENCEVILLE-VINCENNES AIRPORT LAWRENCEVILLE, LAWRENCE COUNTY, ILLINOIS INSTALL PERIMETER FENCING

### SCOPE OF WORK

THIS PROJECT CONSISTS OF CONSTRUCTING A CLASS E FENCE (6') ALONG THE NORTH AIRPORT PROPERTY LINE.

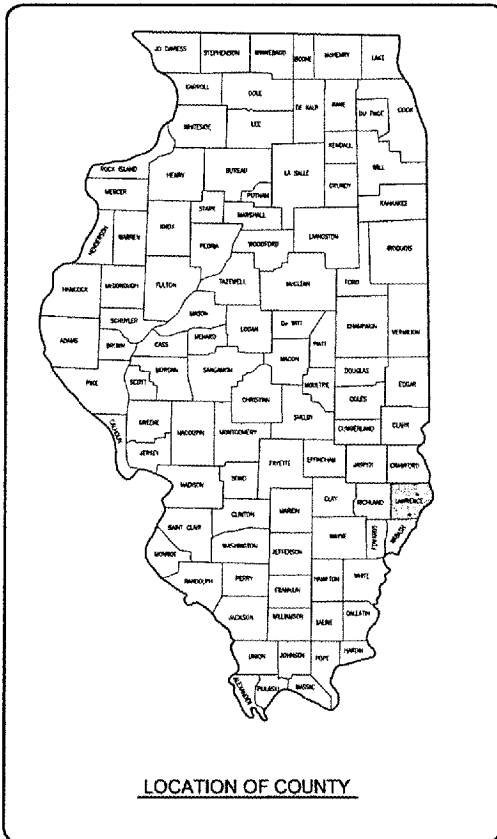

LOCATION OF COUNTY

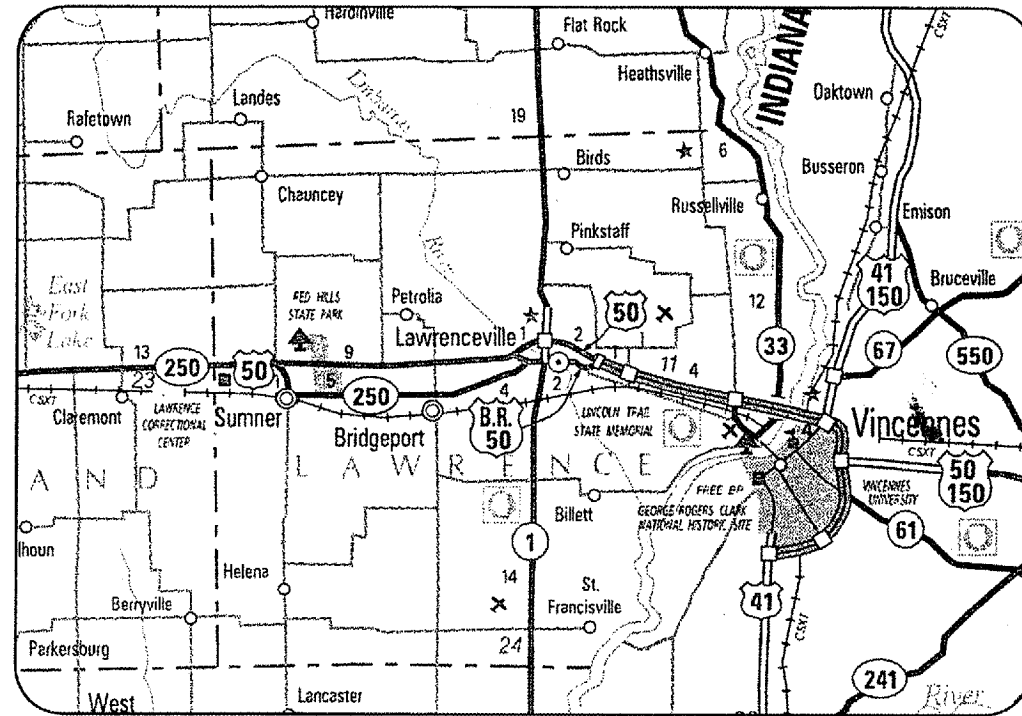

## LOCATION

ILL. PROJ.: LWV-3672  
A.I.P. PROJ.: 3-17-0061-B14  
LATITUDE: 38° 45' 35"  
LONGITUDE: 87° 36' 27"  
ELEVATION: 429.0' M.S.L.  
DATE: MAY 11, 2007

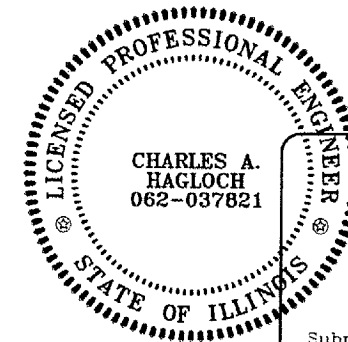

REVISED 06/28/07



Submitted by: *Charles A. Hagloch* ENG'R  
Date Submitted: JUNE 29, 2007  
Lic. Exp. Date: NOVEMBER 30, 2007

### BI-STATE AUTHORITY

Approved: *David H. Watson* CHAIRMAN  
Date: *6-12-07*  
Approved: *John Bozbe* SECRETARY  
Date: *6-12-07*

DATE	REVISION	BY

MID-AMERICAN AIR CENTER  
LAWRENCEVILLE-VINCENNES AIRPORT  
LAWRENCEVILLE, ILLINOIS

ILL. PROJ.: LWV-3672 A.I.P. PROJ.: 3-17-0061-B14

FILE NAME	SCALE	DATE	LAYOUT	DRAWN	REVIEWED
R-001CVR.DWG	NOT TO SCALE	04/25/07	CAH	BAK	CAH

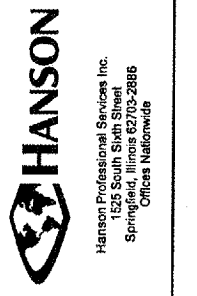

INSTALL PERIMETER FENCING  
COVER SHEET

JUN 29, 2007 7:34 AM CAH  
I:\AIRPORTS\LAWRENCEVILLE\B12-07FENC\AIRPORT\SHEETS\R-001CVR.DWG - COVER

LW022

DATE	REVISION	BY

**SUMMARY OF QUANTITIES**

ITEM NO.	DESCRIPTION	UNIT	TOTAL QUANTITIES	AS BUILT QUANTITIES
AR161900	REMOVE CLASS C FENCE	L.F.	733	
AR162506	CLASS E FENCE 6'	L.F.	10,559	
AR162640	CLASS E GATE-40'	EACH	1	
AR800524	CLASS E MANUAL SLIDE GATE	EACH	1	

**INDEX TO SHEETS**

SHEET NO.	DESCRIPTION
1	COVER SHEET
2	SUMMARY OF QUANTITIES AND INDEX TO SHEETS
3	PROPOSED SAFETY PLAN
4	EXISTING FENCE REMOVAL PLAN
5	PROPOSED FENCING PLAN
6	PROPOSED MANUAL SLIDE GATE DETAIL

MID-AMERICAN AIR CENTER  
 LAWRENCEVILLE-VINCENNES AIRPORT  
 LAWRENCEVILLE, ILLINOIS

ILL. PROJ.: LWV-3672      A.I.P. PROJ.: 3-17-0061-B14

IEL Project No. 81207FNC01_0800 Filename R-002FLP.DWG Scale NOT TO SCALE Date 04/25/07	
LAYOUT	CAH 04/25/07
DRAWN	BAK 04/25/07
REVIEWED	CAH 05/10/07



**INSTALL PERIMETER FENCING**  
**SUMMARY OF QUANTITIES AND INDEX TO SHEETS**

**SCOPE OF WORK**

THIS PROJECT CONSISTS OF CONSTRUCTING A CLASS E FENCE (6') ALONG THE NORTH AIRPORT PROPERTY LINE.

**AIRPORT SECURITY NOTE**

AIRPORT SECURITY WILL BE MAINTAINED AT ALL TIMES. THE CONTRACTOR WILL CLOSE AND LOCK THE EXISTING GATE IN THE HAUL ROUTE AT THE END OF EACH WORKING DAY.

**UTILITY NOTE**

THE CONTRACTOR SHALL CONTACT ALL UTILITY COMPANIES AND AGENCIES WHICH HAVE LINES OR CONDUITS IN THE PROPOSED WORK AREA. ALL LINES AND CONDUITS SHALL BE LOCATED AND IDENTIFIED FOR DEPTH BEFORE ANY EXCAVATION BEGINS. THE CONTRACTOR WILL CALL J.U.L.I.E. (1-800-892-0123) TO ACCOMPLISH THE ABOVE. IT IS THE CONTRACTOR'S RESPONSIBILITY TO IDENTIFY ALL UNDERGROUND NON-JULIE UTILITIES LOCATED WITHIN THE PROPOSED CONSTRUCTION LIMITS. THESE UNDERGROUND IMPROVEMENTS WILL BE LOCATED AT THE CONTRACTOR'S OWN EXPENSE PRIOR TO THE START OF CONSTRUCTION ACTIVITIES.

**HEIGHT OF CONSTRUCTION EQUIPMENT**

THE MAXIMUM ANTICIPATED HEIGHT OF THE CONSTRUCTION EQUIPMENT WILL BE 15 FEET. THE TALLEST EQUIPMENT IS EXPECTED TO BE A CONCRETE TRUCK.

**EQUIPMENT PARKING AND STORAGE AREA**

THE LOCATION OF THE EQUIPMENT PARKING AND STORAGE AREA IS AS SHOWN ON THIS SHEET. THE CONTRACTOR WILL BE REQUIRED TO MAINTAIN THE PROPOSED EQUIPMENT PARKING AND STORAGE AREA THROUGHOUT THE COURSE OF THE PROJECT. ANY PROPERTY DAMAGE OUTSIDE OF THESE DESIGNATED AREAS WILL BE REPAIRED BY THE CONTRACTOR AND AT THE CONTRACTOR'S OWN EXPENSE. AT THE CONCLUSION OF THE PROJECT THE CONTRACTOR WILL RESTORE THE EQUIPMENT PARKING AND STORAGE AREA TO THEIR ORIGINAL STATE. RESTORATION OF THE EQUIPMENT PARKING AND STORAGE AREAS WILL BE CONSIDERED INCIDENTAL TO THE PROJECT AND NO ADDITIONAL COMPENSATION WILL BE ALLOWED.

**CONTRACTOR RESPONSIBILITIES**

THE CONTRACTOR'S EMPLOYEES WILL PARK THEIR VEHICLES IN THE EXISTING AUTO PARKING LOT. ONLY CONTRACTOR VEHICLES WILL BE ALLOWED OUTSIDE THIS AREA.

THE CONTRACTOR AND HIS EMPLOYEES WILL BE RESTRICTED TO THE WORK AREA AND ALL OTHER AREAS OF THE AIRPORT ARE "OFF LIMITS" TO THEM.

THE WORK AREA WILL BE DEFINED AS FOLLOWS: THE DEFINED WORK AREA WILL BE 10' ON THE AIRPORT SIDE OF THE PROPOSED FENCE ALIGNMENT OR EXISTING FENCE REMOVAL. THE CONTRACTOR MUST KEEP HIS EQUIPMENT WITHIN THESE WORK AREA LIMITS.

**SEEDING NOTE**

ALL AREAS DISTURBED DURING CONSTRUCTION SHALL BE LIMED, SEEDED, AND MULCHED IN ACCORDANCE TO THE SPECIFICATIONS AND SPECIAL PROVISIONS.

**J.U.L.I.E. INFORMATION**

COUNTY \_\_\_\_\_ LAWRENCE  
CITY \_\_\_\_\_ LAWRENCEVILLE  
TOWNSHIP \_\_\_\_\_ ALLISON  
SECTION NO. \_\_\_\_\_ 23 & 26  
ADDRESS \_\_\_\_\_ LAWRENCEVILLE-VINCENNES AIRPORT  
RR# 4, BOX 195  
LAWRENCEVILLE, ILLINOIS 62439

THE LOCATION, SIZE AND TYPE OF MATERIAL OF EXISTING UNDERGROUND UTILITIES INDICATED ON THE PLANS IS NOT REPRESENTED AS BEING ACCURATE, SUFFICIENT OR COMPLETE. IT SHALL BE THE CONTRACTOR'S RESPONSIBILITY TO DETERMINE THE ACTUAL LOCATION OF ALL SUCH FACILITIES, INCLUDING SERVICE CONNECTIONS TO UNDERGROUND UTILITIES. PRIOR TO CONSTRUCTION, THE CONTRACTOR SHALL NOTIFY THE UTILITY COMPANIES OF HIS OPERATIONAL PLANS AND SHALL OBTAIN FROM THE RESPECTIVE UTILITY COMPANIES DETAILED INFORMATION AND ASSISTANCE RELATIVE TO THE LOCATION OF THEIR FACILITIES AND THE WORKING SCHEDULE OF THE COMPANIES FOR REMOVAL OR ADJUSTMENT WHERE REQUIRED. IN THE EVENT AN UNEXPECTED UTILITY INTERFERENCE IS ENCOUNTERED DURING CONSTRUCTION, THE CONTRACTOR SHALL IMMEDIATELY NOTIFY THE UTILITY COMPANY OF JURISDICTION. THE ENGINEER SHALL ALSO BE IMMEDIATELY NOTIFIED. ANY SUCH MAINS AND SERVICES SHALL BE RESTORED TO SERVICE AT ONCE AND PAID FOR BY THE CONTRACTOR AT NO ADDITIONAL COST TO THE CONTRACT.

CALL J.U.L.I.E. FOR UTILITY INFORMATION AT 1-800-892-0123.

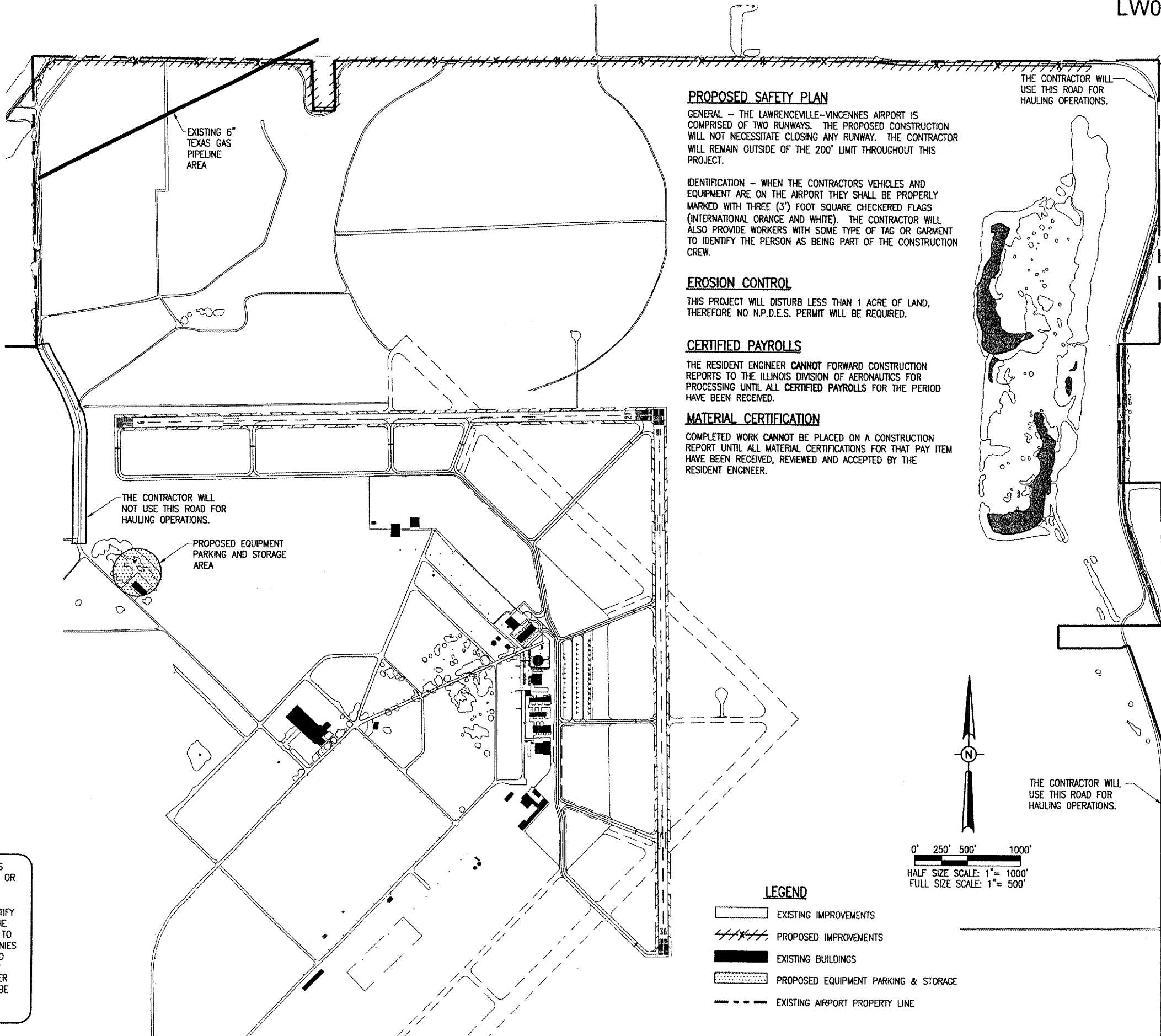

**PROPOSED SAFETY PLAN**

GENERAL - THE LAWRENCEVILLE-VINCENNES AIRPORT IS COMPRISED OF TWO RUNWAYS. THE PROPOSED CONSTRUCTION WILL NOT NECESSITATE CLOSING ANY RUNWAY. THE CONTRACTOR WILL REMAIN OUTSIDE OF THE 200' LIMIT THROUGHOUT THIS PROJECT.

IDENTIFICATION - WHEN THE CONTRACTORS VEHICLES AND EQUIPMENT ARE ON THE AIRPORT THEY SHALL BE PROPERLY MARKED WITH THREE (3') FOOT SQUARE CHECKERED FLAGS (INTERNATIONAL ORANGE AND WHITE). THE CONTRACTOR WILL ALSO PROVIDE WORKERS WITH SOME TYPE OF TAG OR GARMENT TO IDENTIFY THE PERSON AS BEING PART OF THE CONSTRUCTION CREW.

**EROSION CONTROL**

THIS PROJECT WILL DISTURB LESS THAN 1 ACRE OF LAND, THEREFORE NO N.P.D.E.S. PERMIT WILL BE REQUIRED.

**CERTIFIED PAYROLLS**

THE RESIDENT ENGINEER CANNOT FORWARD CONSTRUCTION REPORTS TO THE ILLINOIS DIVISION OF AERONAUTICS FOR PROCESSING UNTIL ALL CERTIFIED PAYROLLS FOR THE PERIOD HAVE BEEN RECEIVED.

**MATERIAL CERTIFICATION**

COMPLETED WORK CANNOT BE PLACED ON A CONSTRUCTION REPORT UNTIL ALL MATERIAL CERTIFICATIONS FOR THAT PAY ITEM HAVE BEEN RECEIVED, REVIEWED AND ACCEPTED BY THE RESIDENT ENGINEER.

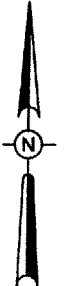
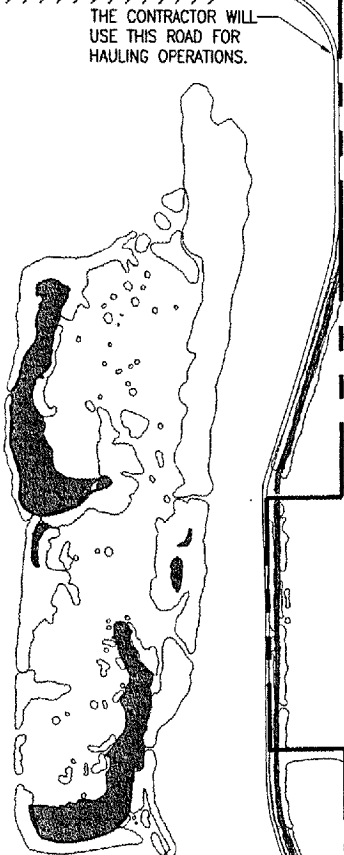

0' 250' 500' 1000'  
HALF SIZE SCALE: 1" = 1000'  
FULL SIZE SCALE: 1" = 500'

**LEGEND**

- EXISTING IMPROVEMENTS
- PROPOSED IMPROVEMENTS
- EXISTING BUILDINGS
- PROPOSED EQUIPMENT PARKING & STORAGE
- EXISTING AIRPORT PROPERTY LINE

DATE	REVISION	BY
07/05/07	REVISED AS PER I.D.A. REVIEW	CAH

MID-AMERICAN AIR CENTER  
LAWRENCEVILLE-VINCENNES AIRPORT  
LAWRENCEVILLE, ILLINOIS  
I.L. PROJ.: LW-3672 A.I.P. PROJ.: 3-17-0061-814

REVISED	DATE
CAH	04/25/07
BAK	04/25/07
CAH	05/10/07

8/207FENC0800  
R-00335FY.DWG  
Scale 1" = 500'  
Date 04/25/07

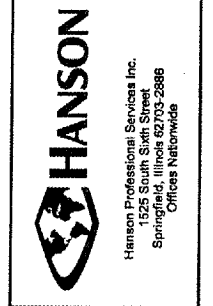

INSTALL PERIMETER FENCING  
PROPOSED SAFETY PLAN

JUL 05, 2007 11:27 AM BAK  
I:\AIRPORTS\LAWRENCEVILLE\B12-07FENC\AIRPORT\SHEETS\R-00335FY.DWG - SAFETY

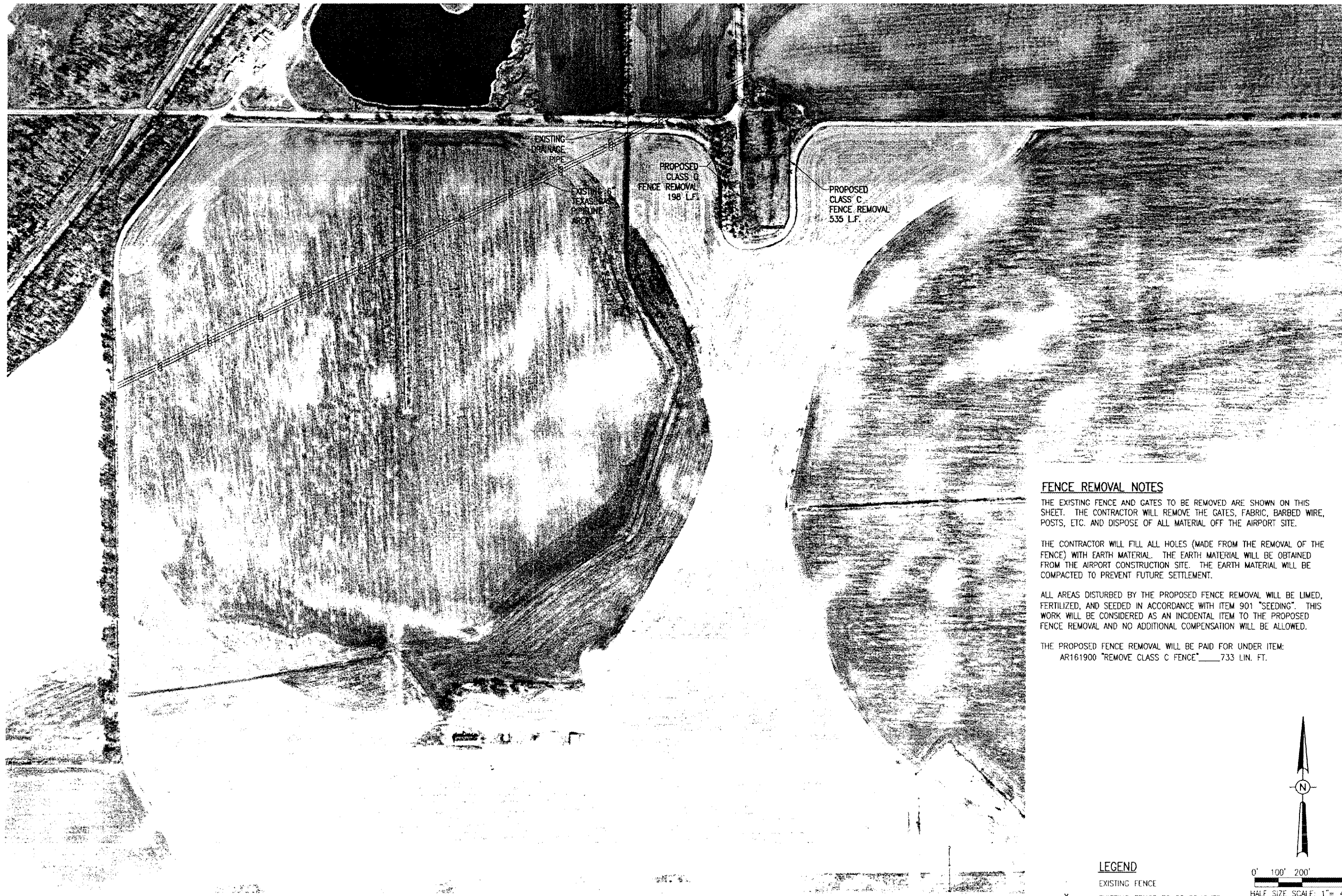

PROPOSED CLASS C FENCE REMOVAL 198 L.F.

PROPOSED CLASS C FENCE REMOVAL 535 L.F.

**FENCE REMOVAL NOTES**

THE EXISTING FENCE AND GATES TO BE REMOVED ARE SHOWN ON THIS SHEET. THE CONTRACTOR WILL REMOVE THE GATES, FABRIC, BARBED WIRE, POSTS, ETC. AND DISPOSE OF ALL MATERIAL OFF THE AIRPORT SITE.

THE CONTRACTOR WILL FILL ALL HOLES (MADE FROM THE REMOVAL OF THE FENCE) WITH EARTH MATERIAL. THE EARTH MATERIAL WILL BE OBTAINED FROM THE AIRPORT CONSTRUCTION SITE. THE EARTH MATERIAL WILL BE COMPACTED TO PREVENT FUTURE SETTLEMENT.

ALL AREAS DISTURBED BY THE PROPOSED FENCE REMOVAL WILL BE LIMED, FERTILIZED, AND SEEDING IN ACCORDANCE WITH ITEM 901 "SEEDING". THIS WORK WILL BE CONSIDERED AS AN INCIDENTAL ITEM TO THE PROPOSED FENCE REMOVAL AND NO ADDITIONAL COMPENSATION WILL BE ALLOWED.

THE PROPOSED FENCE REMOVAL WILL BE PAID FOR UNDER ITEM:  
AR161900 "REMOVE CLASS C FENCE" \_\_\_\_\_ 733 LIN. FT.

**LEGEND**

- X — EXISTING FENCE
- X — EXISTING FENCE TO BE REMOVED

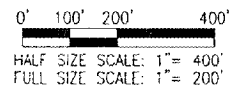
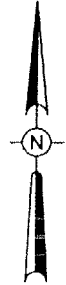

DATE	REVISION	BY

MID-AMERICAN AIR CENTER  
LAWRENCEVILLE-VINCENNES AIRPORT  
LAWRENCEVILLE, ILLINOIS

IL PROJ.: LW-3672 A.I.P. PROJ.: 3-17-0061-B14

USL Serial No. 81207ENC0.0800	04/26/07
Project: R-171FEN.DWG	MDR 04/26/07
Scale: 1" = 200'	MDR 04/26/07
Date: 04/26/07	CAH 05/10/07
LAYOUT	MDR 04/26/07
DRAWN	MDR 04/26/07
REVIEWED	CAH 05/10/07

**HANSON**  
Hanson Professional Services Inc.  
1525 South Sixth Street  
Springfield, Illinois 62703-2866  
Offices Nationwide

INSTALL PERIMETER FENCING  
EXISTING FENCE REMOVAL PLAN

11/12/07 1:44 PM BY CAH  
 PROJECT: LAWRENCEVILLE-VINCENNES AIRPORT SHEETS R-171FEN.DWG - Layout 1





**FENCE COORDINATES**

POINT NO.	NORTHING	EASTING
1	769217.5103	1187325.6148
2	769247.5067	1187326.0770
3	769244.1172	1187546.0509
4	769243.5009	1187586.0461
5	769210.2744	1189742.3667
6	768801.6803	1189774.4026
7	768802.1183	1189945.4403
8	768846.8783	1189965.7996
9	769243.5454	1189969.5817
10	769250.8657	1192423.1916
11	769250.9850	1192463.1913
12	769258.4079	1194951.0877
13	769228.6104	1195325.1737
14	769230.7930	1197113.5438
15	769290.1762	1197733.8348
16	769290.2939	1197743.8341
17	769280.2944	1197743.9409

**CLASS E FENCE NOTES**

THE PROPOSED CLASS "E" FENCE SHALL BE INSTALLED AT THE LOCATIONS SHOWN ON THIS SHEET AND IN ACCORDANCE WITH THE SPECIAL PROVISIONS.

THE PROPOSED CLASS "E" FENCE WILL BE PAID FOR UNDER ITEM:  
AR162506 "CLASS E FENCE 6" \_\_\_\_\_ 10,559 LIN. FT.

THE PROPOSED CLASS "E" SLIDE GATE AND SWING GATE WILL BE INSTALLED AT THE LOCATIONS SHOWN ON THIS SHEET AND IN ACCORDANCE WITH THE SPECIAL PROVISIONS.

THE PROPOSED CLASS "E" SLIDE GATE WILL BE PAID FOR UNDER ITEM:  
AR800524 "CLASS E MANUAL SLIDE GATE" \_\_\_\_\_ 1 EACH.

THE PROPOSED CLASS "E" SWING GATE WILL BE PAID FOR UNDER ITEM:  
AR162640 "CLASS E GATE-40" \_\_\_\_\_ 1 EACH

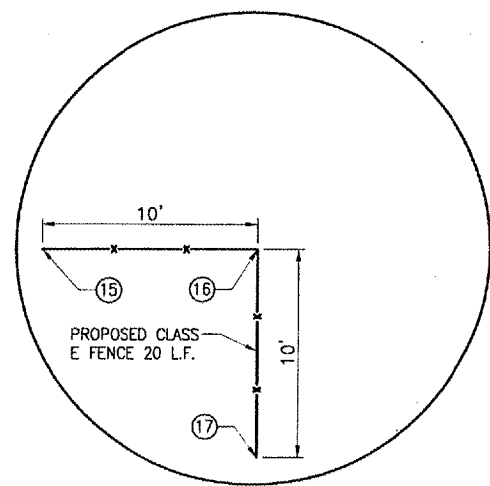

**DETAIL "A"**  
"NOT TO SCALE"

**LEGEND**  
 ---X--- EXISTING FENCE  
 ---X--- PROPOSED CLASS E FENCE

0' 250' 500' 1000'  
 HALF SIZE SCALE: 1" = 1000'  
 FULL SIZE SCALE: 1" = 500'

DATE	REVISION	BY

MID-AMERICAN AIR CENTER  
 LAWRENCEVILLE-VINCENNES AIRPORT  
 LAWRENCEVILLE, ILLINOIS

IL PROJ.: LW-3672 A.I.P. PROJ.: 3-17-0061-814

REV. Project No. 8120ZENC0800	DATE 04/26/07
Electronic R-172EEN.DWG	MDR 04/26/07
Scale 1" = 500'	MDR 04/26/07
Date 04/26/07	CAH 05/10/07
LAYOUT	
DRAWN	
REVIEWED	



INSTALL PERIMETER FENCING  
 PROPOSED FENCING PLAN

