

NOTES:

1. CONTRACTOR TO NOTIFY FAA (RUDY BRODSKY, 618.256.1800) PRIOR TO BEGINNING ANY EXCAVATION ACTIVITIES.
2. HAUL ROUTE LOCATION SHOWN IS APPROXIMATE ONLY. CONTRACTOR TO DETERMINE EXACT LOCATION AND COMPOSITION OF HAUL ROUTE. CONTRACTOR TO RESTORE ALL AREAS DISTURBED BY CONSTRUCTION OF HAUL ROUTE WITH COST BEING INCIDENTAL TO PAY ITEM AR150540 "HAUL ROUTE". HAUL ROUTE TO BE LEFT IN PLACE AT THE END OF CONSTRUCTION.
3. CONTRACTOR TO COMPLY WITH ANY/ALL REGULATIONS REQUIRED TO COMPLY WITH US ARMY CORPS OF ENGINEER NATIONWIDE PERMIT NUMBER 13, BANK STABILIZATION. SPECIFICALLY, CONTRACTOR TO MEET REQUIREMENT THAT ALL HEAVY EQUIPMENT WORKING IN WETLANDS MUST BE PLACED ON MATS, OR OTHER MEASURES MUST BE TAKEN TO MINIMIZE SOIL DISTURBANCE.
4. AT THE LOCATION SHOWN ON THE CONSTRUCTION SAFETY PLAN, A SECTION OF 12' WILDLIFE FENCE (APPROXIMATELY 250' LONG) WAS RECENTLY DAMAGED BY FLOOD DEBRIS. BEND POSTS STRAIGHT, DRIVE A NEW 2.875"Ø TERMINAL POST ADJACENT TO FORMERLY BENT POST AND FASTEN NEW POST TO OLD POST WITH BANDS. WORK TO BE PAID FOR UNDER ITEM AR801855, STABILIZE WILDLIFE POST. ACCESS TO FENCE LOCATIONS IS WITHIN THE SILVER CREEK FLOODPLAIN AND MAY REQUIRE LOW GROUND PRESSURE EQUIPMENT.

TAXIWAY KILO ALIGNMENT INFO		
STA	NORTHING	EASTING
100+00	2,392,302.08	688,503.48
110+00	2,392,992.41	687,779.99

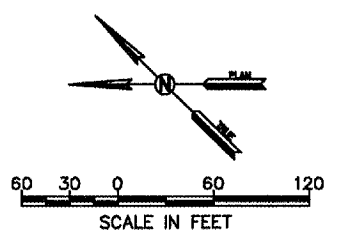
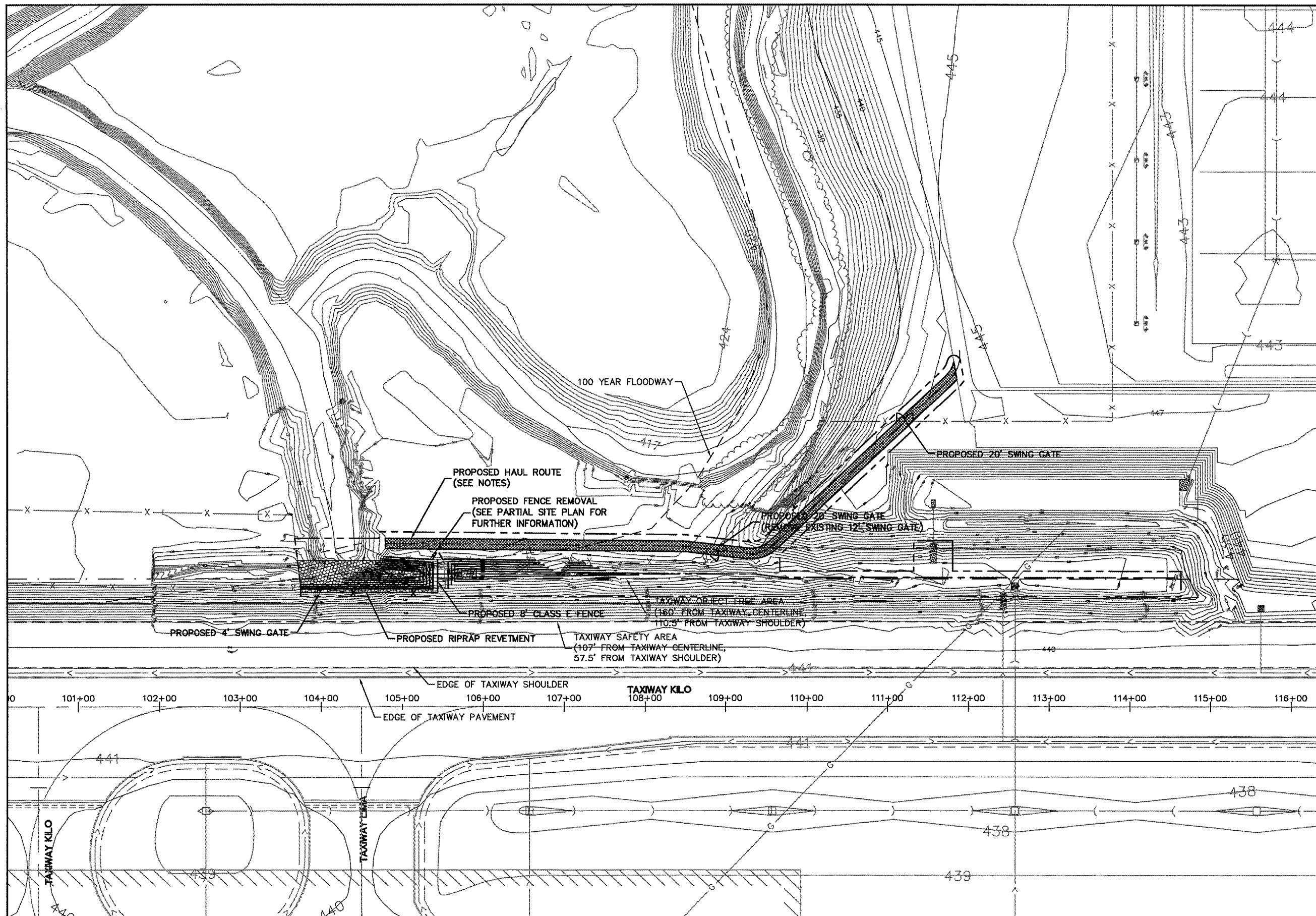

REV.	DATE	BY	APPR.	DESCRIPTION	PLOT FILE	REV.	DATE	BY	APPR.	DESCRIPTION	PLOT FILE

DESIGNED BY: DJT
 DRAWN BY: DJT
 CHECKED BY: TNG
 DATE: 06/08/07

MidAmerica
ST. LOUIS AIRPORT

EarthTech
A Tyco International Ltd. Company

TWY K EROSION STABILIZATION

9768 Airport Blvd, Box 3
 Mascoutah, IL 62258
 PH 618-624-2628
 FAX 618-566-5324



SITE PLAN

DWG. FILE NAME
95073-C-06

SHEET NO.
6