

PLAN	SURVEYED	BY	DATE
	PLOTTED		
	CHECKED		
	AT		
	NO.		
	FILE NAME		

PROFILE	SURVEYED	BY	DATE
	PLOTTED		
	CHECKED		
	AT		
	NO.		
	STRUCTURE		
	NOTATION		

NOTE:
 1 - BENCHMARK #1 - ELEVATION = 99.71'
 2 - BENCHMARK #2 - CUT " " IN TOP OF HEADWALL, EAST END OF HEADWALL, WEST OF BRIDGE & SOUTH OF GOLF ROAD. ELEVATION = 96.54'

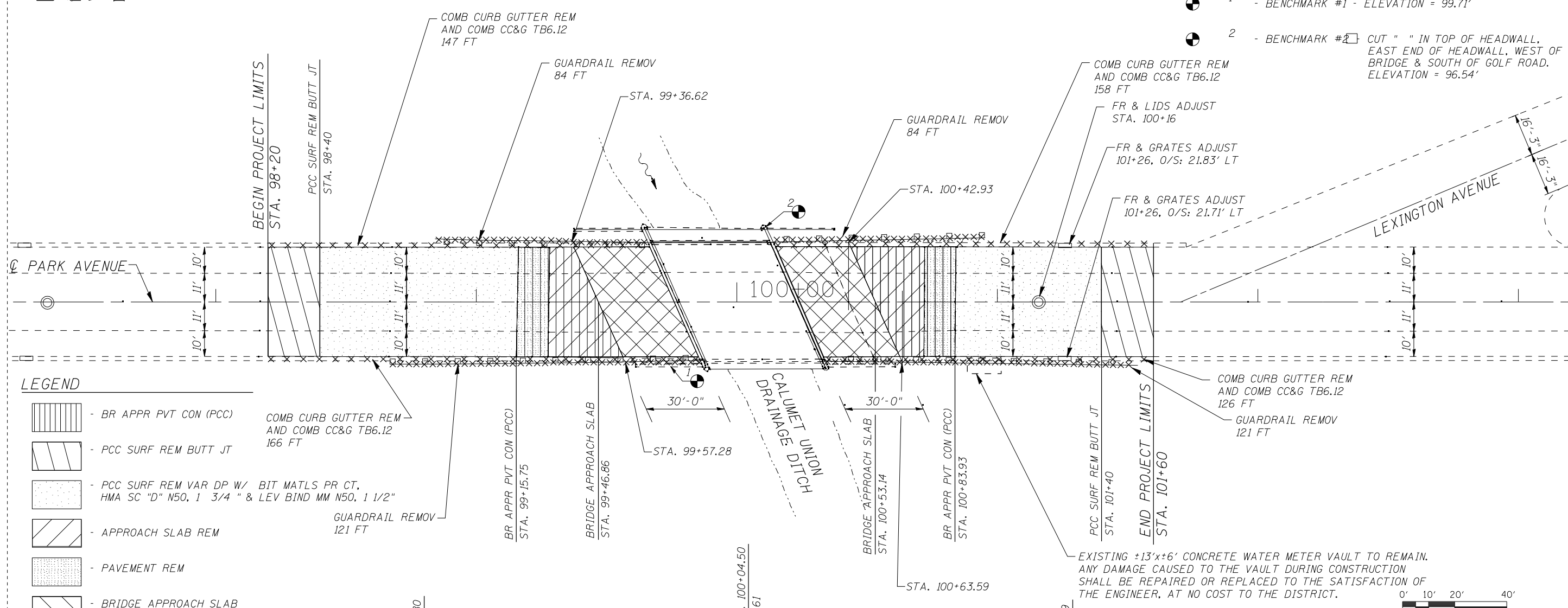

LEGEND

- BR APPR PVT CON (PCC) COMB CURB GUTTER REM AND COMB CC&G TB6.12 166 FT
- PCC SURF REM BUTT JT
- PCC SURF REM VAR DP W/ BIT MATLS PR CT, HMA SC "D" N50, 1 3/4" & LEV BIND MM N50, 1 1/2"
- GUARDRAIL REMOV 121 FT
- APPROACH SLAB REM
- PAVEMENT REM
- BRIDGE APPROACH SLAB (PAID AS CONCRETE SUPERSTRUCTURE)

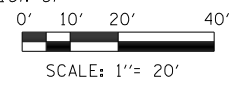
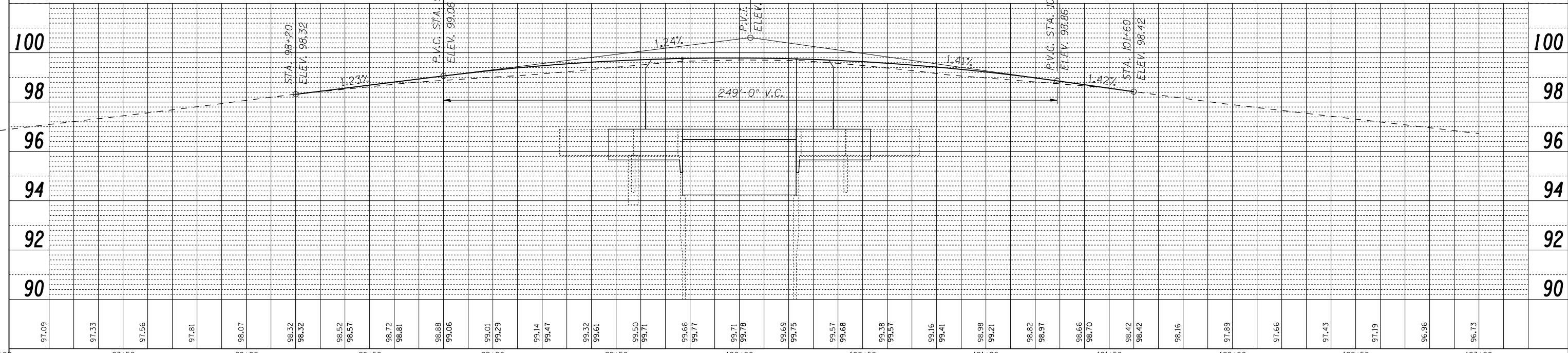

96.85

97+00	97+50	98+00	98+50	99+00	99+50	100+00	100+50	101+00	101+50	102+00	102+50	103+00																																		
97.09	97.33	97.56	97.81	98.07	98.32	98.52	98.57	98.72	98.81	98.88	99.06	99.01	99.29	99.14	99.47	99.32	99.61	99.50	99.71	99.66	99.77	99.71	99.78	99.69	99.75	99.57	99.68	99.38	99.57	99.16	99.41	98.98	99.21	98.82	98.97	98.66	98.70	98.42	98.42	98.16	97.89	97.66	97.43	97.19	96.96	96.73

LONCO, INC.
 CONSULTING ENGINEERS
 1560 WALL ST, SUITE 222
 NAPERVILLE, ILLINOIS 60563 PH: (630) 577-9100

DESIGNED -	REVISED -
DRAWN -	REVISED -
CHECKED -	REVISED -
DATE - 03/29/2012	REVISED -

STATE OF ILLINOIS
DEPARTMENT OF TRANSPORTATION

PLAN AND PROFILE
PARK AVENUE OVER CALUMET UNION DRAINAGE DITCH

SCALE: 1" = 20' SHEET NO. 1 OF 1 SHEETS STA. 98+20 TO STA. 101+60

F.A.P. RTE.	SECTION	COUNTY	TOTAL SHEETS	SHEET NO.
3597	0710 B	COOK	30	7
D-91-292-09		CONTRACT NO. 60F95		
FED. ROAD DIST. NO.		ILLINOIS FED. AID PROJECT		