

LIGHTING STAGING (SEQUENCE OF CONSTRUCTION) NOTES:

STAGE 1 (SEE DWGS. MOT-1, MOT-2, AND MOT-5)

A. ALL EXISTING LIGHTING UNITS AND LIGHTING CONTROLLER FOR KAUTZ ROAD SHALL REMAIN IN SERVICE AND SHALL BE OPERATIONAL DURING NIGHT TIME HOURS.

STAGE 2 (SEE DWGS. MOT-1, MOT-3, AND MOT-6 THRU MOT-10)

A. ALL EXISTING LIGHTING UNITS AND LIGHTING CONTROLLER FOR KAUTZ ROAD SHALL REMAIN IN SERVICE AND SHALL BE OPERATIONAL DURING NIGHT TIME HOURS.

B. FURNISH AND INSTALL TEMPORARY LIGHTING CONTROLLER "T1" AND ASSOCIATED SERVICE. COORDINATE THE WORK WITH COMED.

C. FURNISH AND INSTALL TEMPORARY LIGHTING UNITS ON THE EAST SIDE OF EXISTING KAUTZ ROAD AND NORTH OF THE PRAIRIE LANDING GOLF COURSE ENTRANCE (LONGEST DRIVE). DO NOT ENERGIZE TEMPORARY LIGHTING UNITS UNTIL THE EXISTING LIGHTING UNITS ARE DE-ENERGIZED IN SUB-STAGE 3A.

STAGE 3 (SEE DWGS. MOT-1, MOT-4, AND MOT-11 THRU MOT-15)

SUB-STAGE 3A (WEST SIDE & SOUTHEAST CORNER OF KAUTZ ROAD & LONGEST DRIVE):

A. COORDINATE WITH COMED TO DISCONNECT SERVICE TO THE EXISTING WOOD LIGHT POLE AT IL RTE 38 AND KAUTZ ROAD. REMOVE THE LIGHT POLE AND ASSOCIATED AERIAL CABLES.

B. ENERGIZE ALL TEMPORARY LIGHTING UNITS INSTALLED IN STAGE 2 FOR KAUTZ ROAD.

C. PERFORM BALLAST REPLACEMENT ON EXISTING LIGHTING UNITS LOCATED BETWEEN AVERILL ROAD AND THE CONSTRUCTION ZONE ALONG THE WEST SIDE OF KAUTZ ROAD. CONNECT EXISTING LIGHTING UNITS TO THE TEMPORARY LIGHTING CONTROLLER "T1".

D. COORDINATE WITH COMED TO DISCONNECT SERVICE TO THE EXISTING LIGHTING CONTROLLER. REMOVE THE INDICATED EXISTING STREET LIGHTING UNITS FROM FOUNDATIONS AND SALVAGE. REMOVE EXISTING LIGHTING CONTROLLER, CONTROLLER FOUNDATION, AND LIGHTING UNIT FOUNDATIONS AFFECTED BY THE CONSTRUCTION.

E. FURNISH AND INSTALL NEW LIGHTING UNITS FOR THE PROPOSED KAUTZ ROAD ALIGNMENT. INSTALL, BUT DO NOT CONNECT, PERMANENT UNIT DUCT FEED TO EXISTING LIGHTING UNITS NORTH OF THE CONSTRUCTION ZONE.

F. REMOVE AND RE-INSTALL THREE EXISTING PRIVATE LIGHTING UNITS LOCATED ON THE SOUTH SIDE OF LONGEST DRIVE. COORDINATE THE WORK WITH PRAIRIE LANDING GOLF COURSE.

SUB-STAGE 3B (NORTHEAST CORNER OF KAUTZ ROAD & LONGEST DRIVE):

A. FURNISH, INSTALL, AND ENERGIZE NEW LIGHTING CONTROLLER "G" AND THE ASSOCIATED SERVICE. COORDINATE THE WORK WITH COMED.

B. COMPLETE AND ENERGIZE ALL PERMANENT UNIT DUCT FEEDS FROM LIGHTING CONTROLLER "G" TO NEW AND EXISTING LIGHTING UNITS.

C. DISCONNECT EXISTING KAUTZ ROAD LIGHTING UNITS FROM TEMPORARY LIGHTING CIRCUIT. CONNECT AND ENERGIZE PERMANENT UNIT DUCT FEED TO EXISTING LIGHTING UNITS NORTH OF THE CONSTRUCTION ZONE. APPLY NEW LIGHTING UNIT IDENTIFICATION LABELS TO IDENTIFY NEW POLE ASSIGNMENT.

D. DISCONNECT AND REMOVE TEMPORARY LIGHTING UNITS AND TEMPORARY LIGHTING CONTROLLER "T1" AND ASSOCIATED SERVICE. COORDINATE THE WORK WITH COMED.

E. REMOVE AND RE-INSTALL THREE EXISTING PRIVATE LIGHTING UNITS LOCATED ON THE NORTH SIDE OF LONGEST DRIVE. COORDINATE THE WORK WITH PRAIRIE LANDING GOLF COURSE.

NOTES:

- SEE DRAWING RL-1 FOR ELECTRICAL SYMBOL LIST, ABBREVIATIONS, AND GENERAL NOTES.
- EXISTING WOOD LIGHT POLE AND ASSOCIATED AERIAL CABLE SHALL BE REMOVED. COORDINATE REMOVAL WORK WITH COMED. SEE SUB-STAGE 3A, NOTE A.
- EXISTING LIGHTING UNIT SHALL BE REMOVED FROM FOUNDATION AND SALVAGED. FOUNDATION SHALL BE REMOVED IN ACCORDANCE WITH THE STANDARD SPECIFICATIONS.

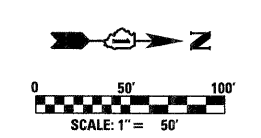
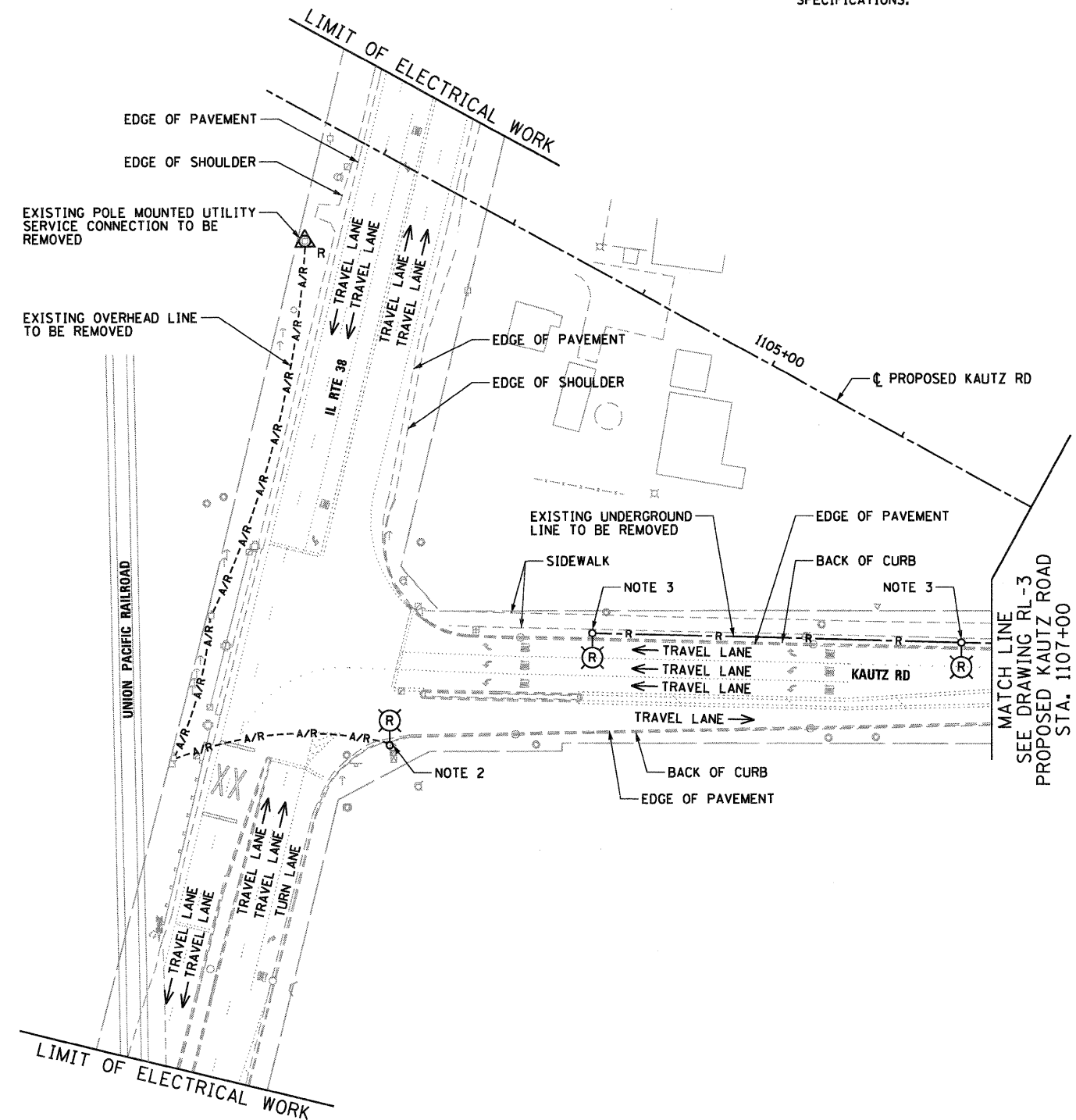

McDonough Associates Inc.
 Engineers / Architects
 130 East Randolph Street Chicago, Illinois 60601

FILE NAME =	USER NAME = amartin
D:\168122-SHT-RL-2.dgn	

DESIGNED - JLW	REVISD -
DRAWN - CJM	REVISD -
CHECKED - KMY	REVISD -
DATE - 12/09/11	REVISD -

DESIGNED - JLW	REVISD -
DRAWN - CJM	REVISD -
CHECKED - KMY	REVISD -
DATE - 12/09/11	REVISD -

DESIGNED - JLW	REVISD -
DRAWN - CJM	REVISD -
CHECKED - KMY	REVISD -
DATE - 12/09/11	REVISD -

STATE OF ILLINOIS
DEPARTMENT OF TRANSPORTATION

ILLINOIS ROUTE 38 AND KAUTZ ROAD
ELECTRICAL REMOVAL PLAN

SCALE: 1" = 50' SHEET NO. 1 OF 2 SHEETS STA. 103+00 TO STA. 115+00/1107+00

F.A.P. RTE.	SECTION	COUNTY	TOTAL SHEETS	SHEET NO.
347	LY (HB & VB)	DUPAGE/KANE	421	157
RL-2		CONTRACT NO. 60122		
FED. ROAD DIST. NO. 1 ILLINOIS FED. AID PROJECT				