

Bench Mark: No. 204 cut "a" on B/C along westerly side of Kautz Rd. opposite 2nd L.P. = Elev. 767.58
 Existing Structure: None

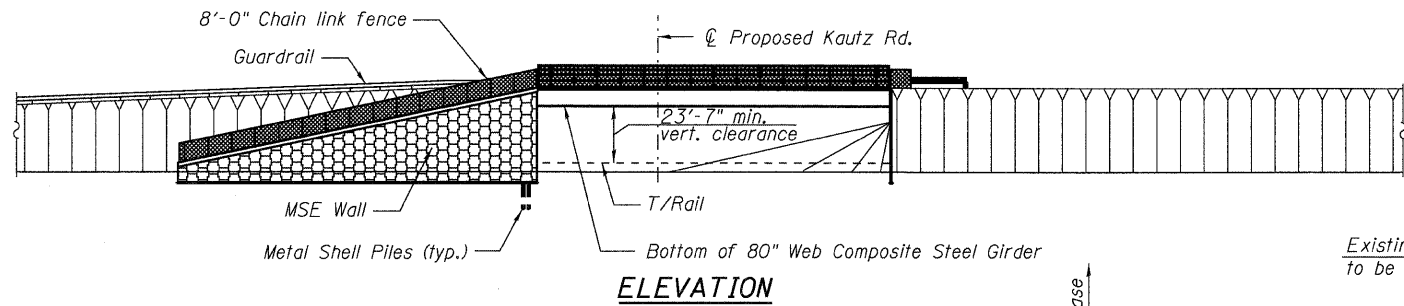

ELEVATION

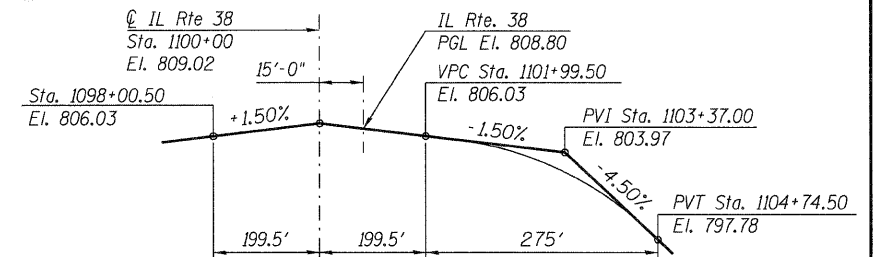

PROFILE GRADE-PROPOSED KAUTZ RD.

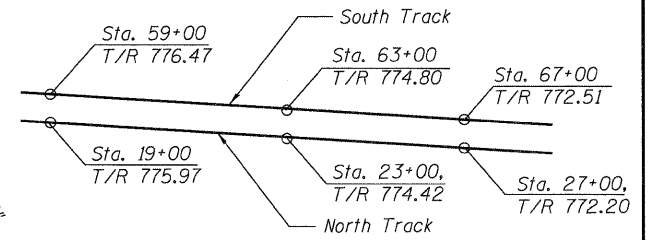

SURVEY TOP OF RAIL ELEVATIONS

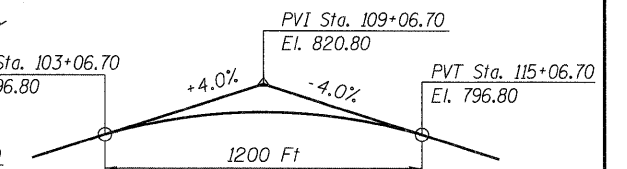

PROFILE GRADE-PROPOSED RTE 38

BRIDGE DESIGN SPECIFICATIONS

AASHTO LRFD Bridge Design Specifications, 2007 (4th Edition) with 2008 and 2009 Interim.

MSE WALL

2002 AASHTO Standard Specifications for Highway Bridges

LOADING HL-93

Allow 50 lbs/sq. ft. for Future Wearing Surface

DESIGN STRESSES

Field Units
 $f'_c = 3,500$ psi
 $f_y = 60,000$ psi (reinforcement)
 $f_y = 50,000$ psi (M270 Grade 50W Structural Steel)
 $f'_c = 4,500$ psi (Precast Units)
 Allowable Soil Pressure = 5.7 ksf (MSE Walls and Geotextile Walls)

SEISMIC DATA

Seismic Performance Zone (SPZ) = 1
 Design Spectral Acceleration at 1.0 sec. (S_M) = 0.159g
 Design Spectral Acceleration at 0.2 sec. ($S_{0.2}$) = 0.088g
 Soil Site class = D

APPROVED
 FOR STRUCTURAL ADEQUACY ONLY

Gerald E. Koynass
 ENGINEER OF BRIDGES AND STRUCTURES

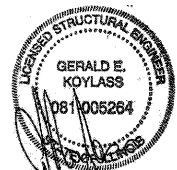

Exp: 11/30/2012

GENERAL PLAN & ELEVATION
ILLINOIS ROUTE 38 OVER U.P.R.R.
F.A.P. RTE. 347 - SECTION LY (HB & VB)
KANE/DuPAGE COUNTY
STATION 109+06.70
STRUCTURE NO. 045-0079

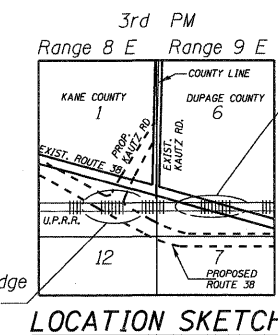

LOCATION SKETCH

- Notes:
 1. For Section B-B see Sheet 2.
 2. For Section A-A see Sheet 4.
 3. Railroad Milepost 33.21 equals NB Track Sta. 22+4.52 at the intersection of Rte. 38 and the U.P.R.R.

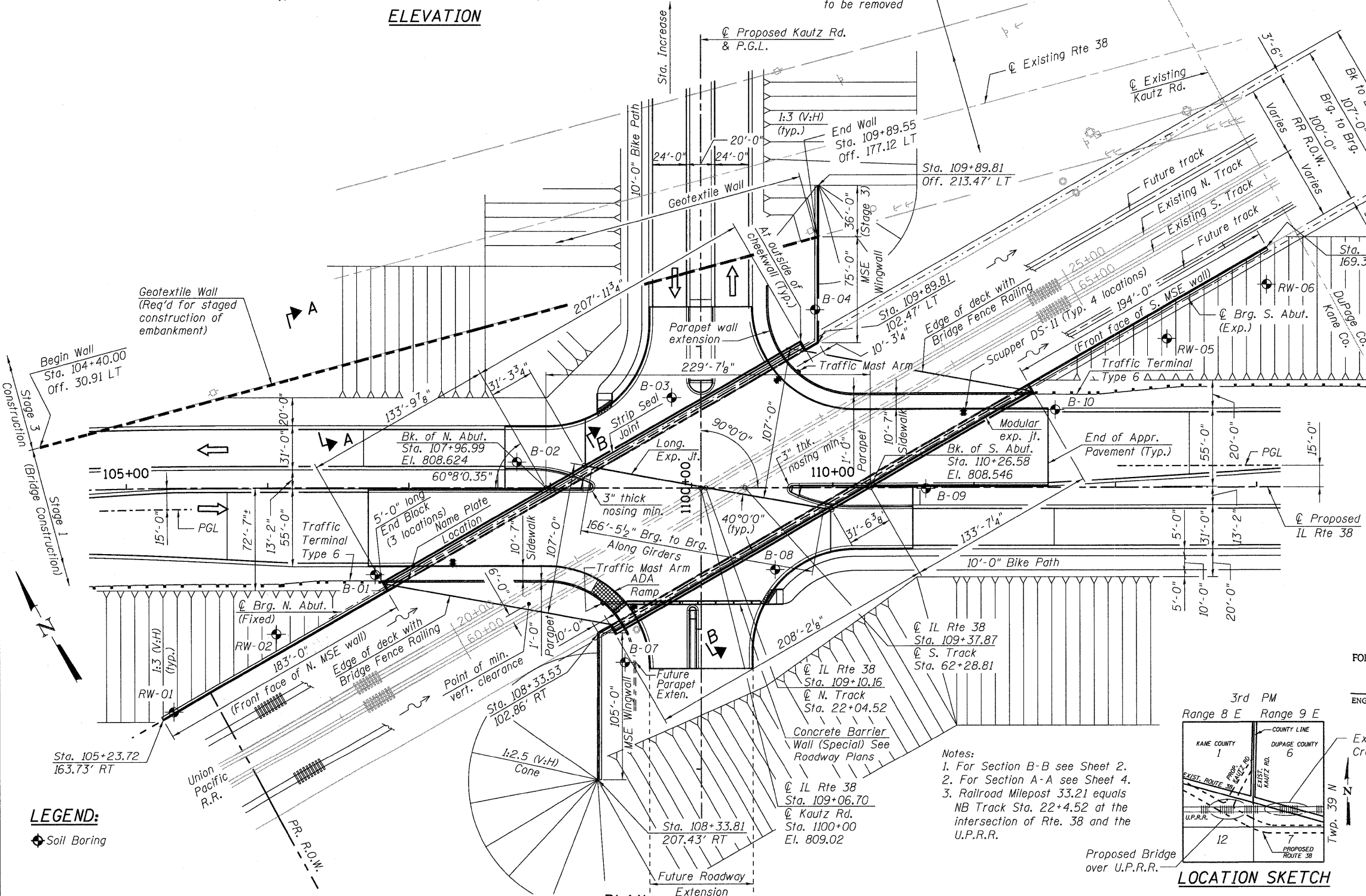

PLAN

LEGEND:

Soil Boring

McDonough Associates Inc.
 Engineers / Architects
 130 East Randolph Street Chicago, Illinois 60601

| | | | |
|---------------------------|----------------------|----------------|-----------|
| FILE NAME = | USER NAME = jehrbert | DESIGNED - KJH | REVISED - |
| 0450079-60122-001-GPE.dgn | | CHECKED - GEK | REVISED - |
| | | DRAWN - RJ | REVISED - |
| | | CHECKED - GEK | REVISED - |

| | |
|-----------------------|--|
| PLOT SCALE = 1:48 | |
| PLOT DATE = 3/28/2012 | |

STATE OF ILLINOIS
DEPARTMENT OF TRANSPORTATION

SHEET NO. 1 OF 67 SHEETS

| F.A.P. RTE. | SECTION | COUNTY | TOTAL SHEETS | SHEET NO. |
|-------------|--------------|-------------|--------------------|-----------|
| 347 | LY (HB & VB) | DUPAGE/KANE | 421 | 167 |
| | | | CONTRACT NO. 60122 | |

ILLINOIS FED. AID PROJECT