

LEGEND:

- PROPOSED INLET
- o PROPOSED MANHOLE
- PROPOSED CATCH BASIN
- ⌋ PROPOSED HEADWALL
- ▭ PROPOSED SLOPED HEADWALL
- ▽ PROPOSED END SECTION
- ~ PROPOSED DITCH
- PROPOSED PIPE UNDERDRAIN
- PROPOSED STORM SEWER
- △ PROPOSED STRUCTURE NO.
- ⊙ PROPOSED STORM SEWER NO.
- ▨ PROPOSED STONE RIPRAP
- ▩ PROPOSED TURF REINFORCEMENT MAT
- PROPOSED SWALE
- ➔ PROPOSED SHEET FLOW
- ⊠ ARTICULATED BLOCK REVETMENT MAT
- EXISTING INLET
- o EXISTING CATCH BASIN
- EXISTING MANHOLE
- ▽ EXISTING END SECTION
- EXISTING STORM SEWER
- EXISTING PIPE UNDERDRAIN / FARM TILE
- EXISTING ABANDONED FARM TILE (SEE GENERAL NOTES)
- ~ EXISTING DITCH
- ⌋ EXISTING HEADWALL
- ▭ EXISTING SLOPED HEADWALL
- ▽ EXISTING SWALE
- ➔ EXISTING SHEET FLOW

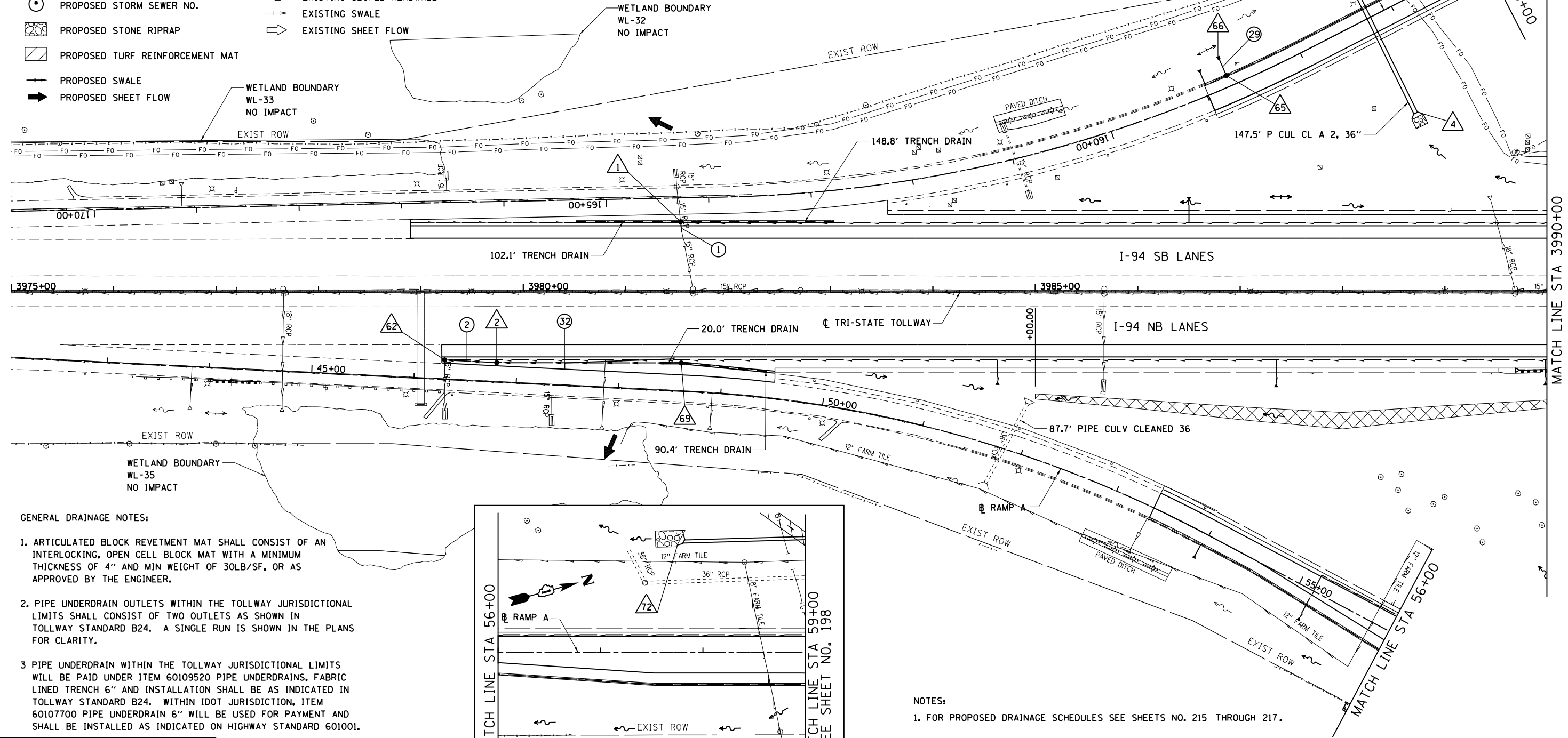

GENERAL DRAINAGE NOTES:

1. ARTICULATED BLOCK REVETMENT MAT SHALL CONSIST OF AN INTERLOCKING, OPEN CELL BLOCK MAT WITH A MINIMUM THICKNESS OF 4" AND MIN WEIGHT OF 30LB/SF, OR AS APPROVED BY THE ENGINEER.
2. PIPE UNDERDRAIN OUTLETS WITHIN THE TOLLWAY JURISDICTIONAL LIMITS SHALL CONSIST OF TWO OUTLETS AS SHOWN IN TOLLWAY STANDARD B24. A SINGLE RUN IS SHOWN IN THE PLANS FOR CLARITY.
3. PIPE UNDERDRAIN WITHIN THE TOLLWAY JURISDICTIONAL LIMITS WILL BE PAID UNDER ITEM 60109520 PIPE UNDERDRAINS, FABRIC LINED TRENCH 6" AND INSTALLATION SHALL BE AS INDICATED IN TOLLWAY STANDARD B24. WITHIN IDOT JURISDICTION, ITEM 60107700 PIPE UNDERDRAIN 6" WILL BE USED FOR PAYMENT AND SHALL BE INSTALLED AS INDICATED ON HIGHWAY STANDARD 601001.

BOWMAN, BARRETT & ASSOCIATES INC.
 CONSULTING ENGINEERS
 Chicago, Illinois
 312.228.0100
 www.bbandainc.com

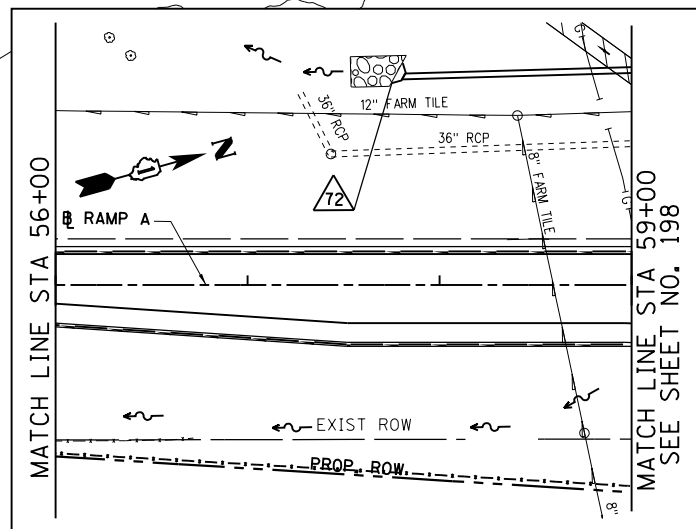

NOTES:

1. FOR PROPOSED DRAINAGE SCHEDULES SEE SHEETS NO. 215 THROUGH 217.

FILE NAME = \$FILES\$

USER NAME = default

DESIGNED - JAM

REVISED -

DRAWN - JAM

REVISIONS -

PLOT SCALE = Hgt=10" Wdt=5"

CHECKED - RGR

REVISIONS -

PLOT DATE = 6/20/2012

DATE - 6/19/2012

REVISIONS -

**STATE OF ILLINOIS
 DEPARTMENT OF TRANSPORTATION**

**PROPOSED DRAINAGE PLAN
 NB I-94 AND SB I-94**

SCALE: 1"=50' SHEET NO. 1 OF 15 SHEETS STA. 3975+00 TO STA. 3990+00

F.A. RTE.	SECTION	COUNTY	TOTAL SHEETS	SHEET NO.
94	49-1-R-1	LAKE	677	186
CONTRACT NO. 60L77				
ILLINOIS FED. AID PROJECT				

S:\1101\95-CADD\60L77_IL_175\60L77_Sheets\160L77-shs-prop.drain01.dgn