

STATE OF ILLINOIS
DEPARTMENT OF TRANSPORTATION
RIGHT OF WAY PLANS
FOR PROPOSED
FEDERAL AID HIGHWAY

ROUTE: INTERSTATE 94
SECTION: AT ILLINOIS ROUTE 173 (FAP 303) AND
PROJECT NO: MILL CREEK ROAD
JOB NO.: R-91-025-09
COUNTY: LAKE
LIMITS: 2008 + 88.34 TO 2048 + 43.97

F.A. RTE.	SECTION	COUNTY	TOTAL SHEETS	SHEET NO.
94	AT ILLINOIS ROUTE 173 AND MILL CREEK ROAD	LAKE	8	1
FED. ROAD DIST. NO. 1	ILLINOIS	CONTRACT NO.		

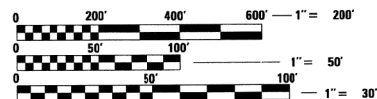
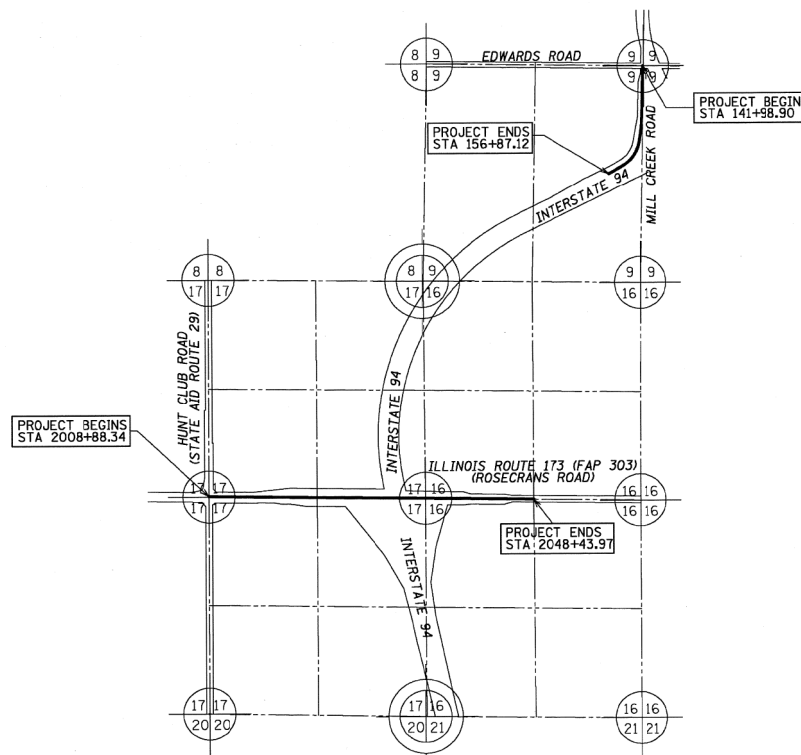

FULL SIZE PLANS HAVE BEEN PREPARED USING STANDARD ENGINEERING SCALES. REDUCED SIZED PLANS WILL NOT CONFORM TO STANDARD SCALES. IN MAKING MEASUREMENTS ON REDUCED PLANS, THE ABOVE SCALES MAY BE USED.

PROJECT LENGTH = 3955.63 LINEAL FEET (0.749 MILES), ILLINOIS ROUTE 173
1488.22 LINEAL FEET (0.282 MILES), MILL CREEK ROAD

RECEIVED
MAY 16 2012 pm
PLATS & LEGALS

STATE OF ILLINOIS
DEPARTMENT OF TRANSPORTATION
DIVISION OF HIGHWAYS

SUBMITTED _____ 20 _____
DISTRICT ENGINEER

EXAMINED _____ 20 _____
DISTRICT RIGHT OF WAY PLANS ENGINEER

PASSED _____ 20 _____
DISTRICT LAND ACQUISITION ENGINEER

REVIEWED _____ 20 _____
CENTRAL BUREAU RIGHT OF WAY PLANS ENGINEER

APPROVED _____ 20 _____
ENGINEER OF LAND ACQUISITION

Mackie Consultants, LLC
9575 W. Higgins Road, Suite 500
Rosemont, IL 60018
(847)696-1400
www.mackieconsult.com

FOR INFORMATION ONLY

FILE NAME = \$FILES\$	USER NAME = default	DESIGNED -	REVISED -	STATE OF ILLINOIS DEPARTMENT OF TRANSPORTATION	IL 173 PLAT OF HIGHWAYS	F.A. RTE.	SECTION	COUNTY	TOTAL SHEETS	SHEET NO.	
		DRAWN -	REVISED -			94	49-1-R-1	LAKE	677	219	
		CHECKED - RGR	REVISED -			CONTRACT NO. 60L77					
		DATE - 6/19/2012	REVISED -			SCALE:	SHEET NO. 1 OF 1 SHEETS	STA.	TO STA.	ILLINOIS FED. AID PROJECT	

S:\1101\95-CADD\60L77-IL-173\60L77-Sheets\0160L77-shr-rep-plan.dgn