

MIN. BAR LAP

- #4 - 2'-7"
- #5 - 3'-3"
- #7 - 5'-2"
- #8 - 6'-9"
- #9 - 8'-7"

BEARING SEAT ELEVATIONS

Beam	Brg. Seat Elevation
1	758.48
2	758.33
3	758.22
4	758.31
5	758.45
6	758.58
7	758.71
8	758.84
9	758.97
10	759.10
11	759.10
12	758.96
13	758.81
14	758.66
15	758.50
16	758.35
17	758.20
18	758.06
19	757.98

TOP PLAN - STAGE II

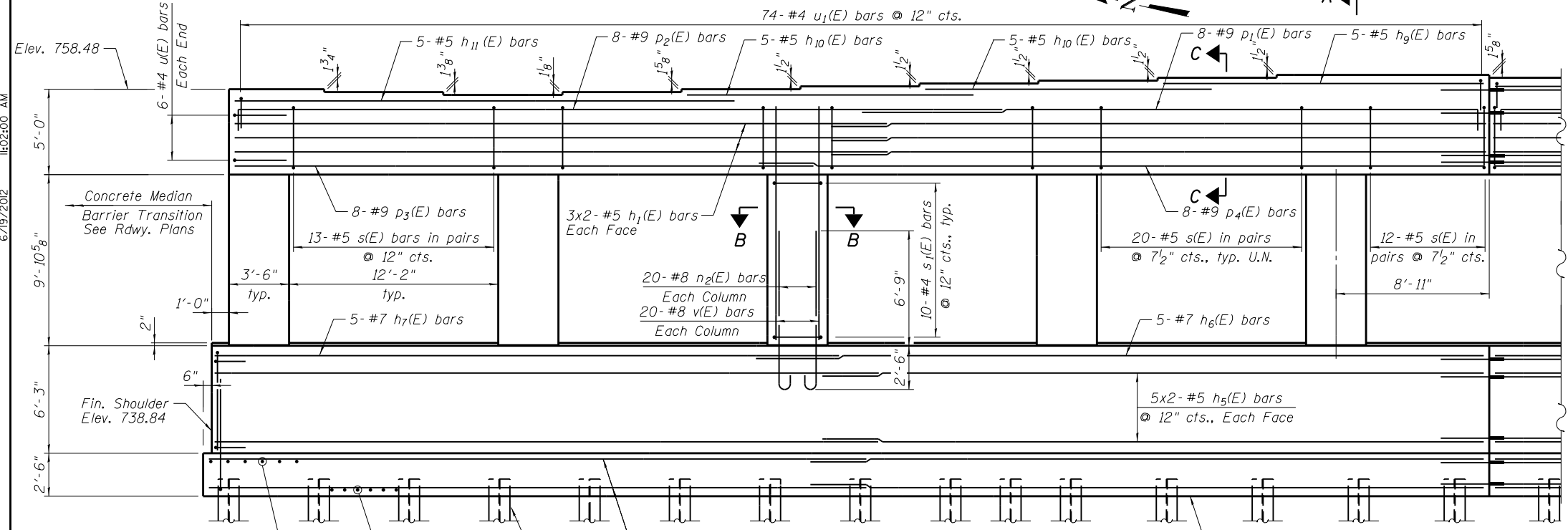

ELEVATION - STAGE II

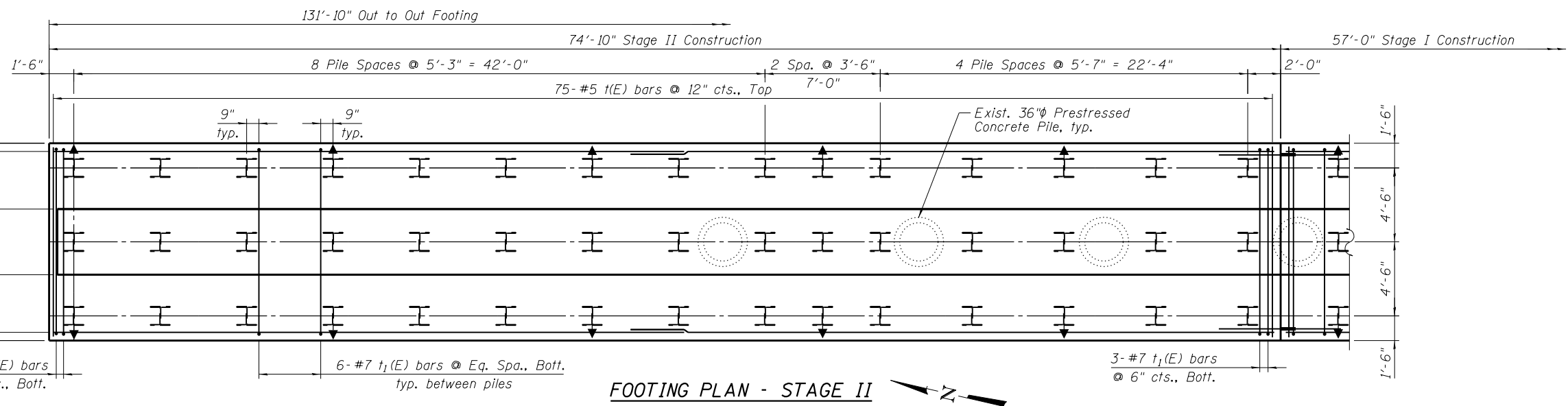

FOOTING PLAN - STAGE II

PILE DATA

Type: Steel-HP14x73
Nominal Required Bearing: 250 Kips
Factored Resistance Available: 140 Kips
Est. Length: 45 ft.
No. Production Piles: 80
No. Test Piles: 1

LEGEND

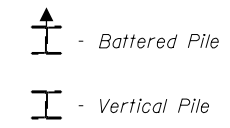

- Notes:
- Pour steps monolithically with cap.
 - See Sheet No. S-32 for Sections A-A, B-B & C-C.
 - See Sheet No. S-32 for Bill of Material and Bar Bending Diagrams.
 - Bars indicated thus 3x2-#5 etc. indicates 3 lines of bars with 2 lengths per line.
 - For details of piles, see Sheet No. S-33.
 - U.N. denotes unless noted.
 - See Sheet S-2 of S-36 for Median Pier Construction Detail.

6/19/2012 11:02:00 AM S:\10\05_CADD\60L77_IL_173\60L77_Sheets\0490535-60L77-031-PDI.dgn

BOWMAN, BARRETT & ASSOCIATES INC.
CONSULTING ENGINEERS
Chicago, Illinois
312.228.0100
www.bbandatinc.com

USER NAME =	DESIGNED - SF	DATE - 6/19/2012
PLOT SCALE =	CHECKED - MRM	REVISED -
PLOT DATE =	DRAWN - MTR	REVISED -
	CHECKED - SF	REVISED -

STATE OF ILLINOIS
DEPARTMENT OF TRANSPORTATION

PIER DETAILS I
STRUCTURE NO. 049-0535 (BRIDGE NO. 441)
SHEET NO. S-31 OF S-36 SHEETS

F.A.I. RTE.	SECTION	COUNTY	TOTAL SHEETS	SHEET NO.
94	49-1-R-1	LAKE	677	469
CONTRACT NO. 60L77				
ILLINOIS FED. AID PROJECT				