

EX CURVE #1  
 PI STA. = 794+98.21  
 $\Delta = 3^\circ 36' 29''$  (RT)  
 $D = 0^\circ 22' 11''$   
 $R = 15,500.00'$   
 $T = 488.19'$   
 $L = 976.05'$   
 $E = 7.69'$   
 $e = N.C.$   
 $T.R. = N/A$   
 $S.E. RUN = N/A$   
 $P.C. STA. = 790+10.03$   
 $P.T. STA. = 799+86.08$

ATKINSON ROAD  
 MATCH LINE STA. 433+00  
 (SEE SHEET NO. 18)

IL ROUTE 137

NOTES

1. STATION/OFFSET CALL-OFFS NOTED WITH (A) ARE DEFINED BY THE ATKINSON ROAD ALIGNMENT.
2. STATION/OFFSET CALL-OFFS NOTED WITH (I) ARE DEFINED BY THE IVANHOE ROAD ALIGNMENT.

EXISTING IL ROUTE 137 CONSTRUCTION CENTERLINE			
DESCRIPTION	STATION	NORTHING	EASTING
B.O.A.	782+36.00	2061827.38	1067976.51
P.C.	790+10.03	2062467.16	1067540.84
P.I.	794+98.21	2062870.67	1067266.06
P.T.	799+86.08	2063290.67	1067017.22
P.O.T.	809+45.72	2064116.29	1066528.07
E.O.A.	826+11.13	2065548.59	1065678.31
IVANHOE ROAD CENTERLINE			
B.O.A.	286+67.12	2063076.78	1066538.67
E.O.A.	310+08.67	2065418.32	1066529.22

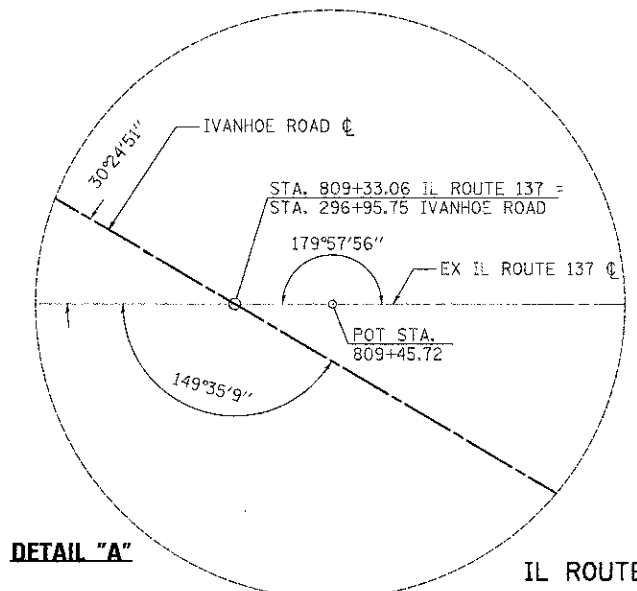
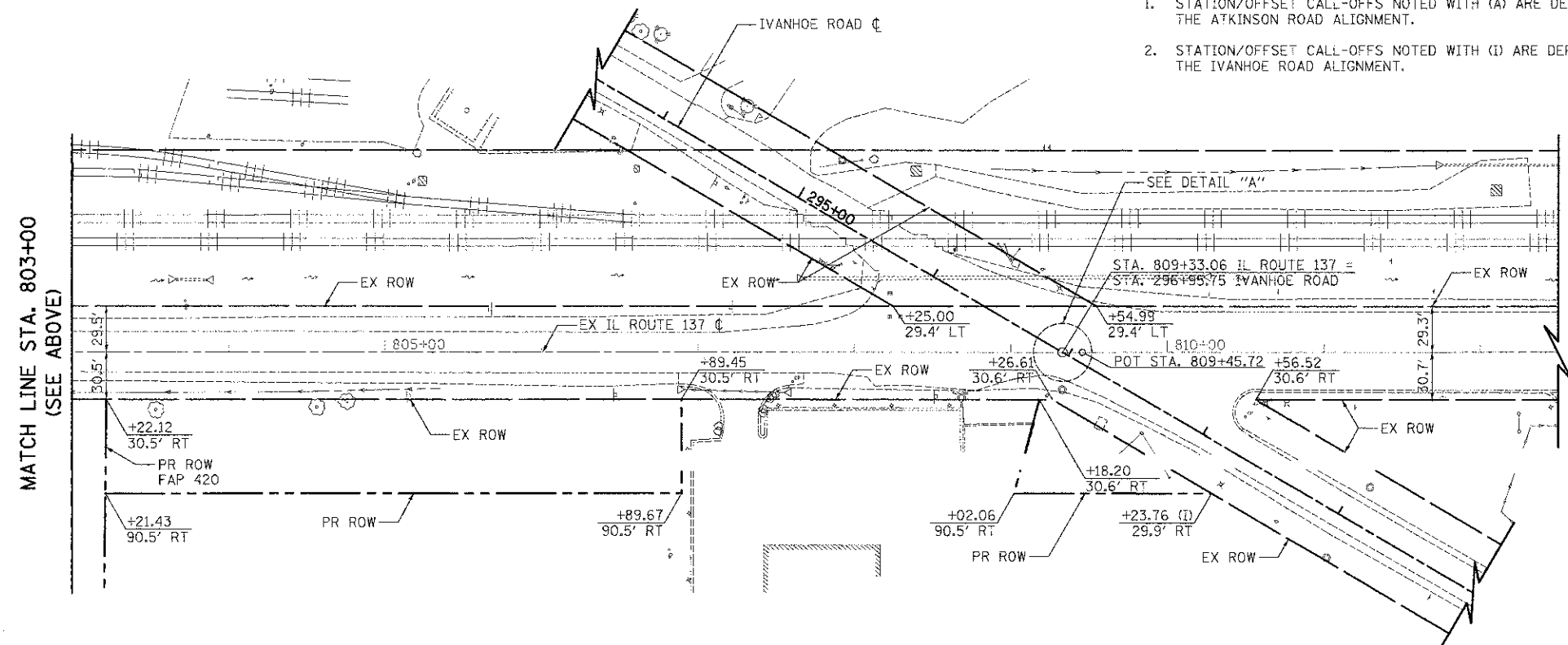

DETAIL "A"

IL ROUTE 137