

SOIL PROFILE DRAWING
 MIDLAND STANDARD ENGINEERING & TESTING, INC.
 ATKINSON ROAD IMPROVEMENTS STAGE 1A
 GRAYSLAKE, ILLINOIS
 MSET PROJECT NO. 88297
 JANUARY 2009

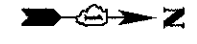

LEGEND

- ✦ BORING NUMBER ✦ CORE NUMBER
- N = Standard Penetration Resistance, blows per foot
- Mc = Moisture Content
- Qp = Unconfined Compressive Strength, tons per square foot (tsf)
- Qu = Unconfined Compressive Strength, tons per square foot (tsf)
- Sample used for Classification
- Wet Level (Water Table)
- * "Firmest Material" refers to roadway construction pavement materials, granular base course materials, granular shoulder materials, and/or roadway and shoulder TBL materials

DATE	
BY	
CHECKED	
NO. OF REV.	
NO.	

DATE	
BY	
CHECKED	
NO. OF REV.	
NO.	

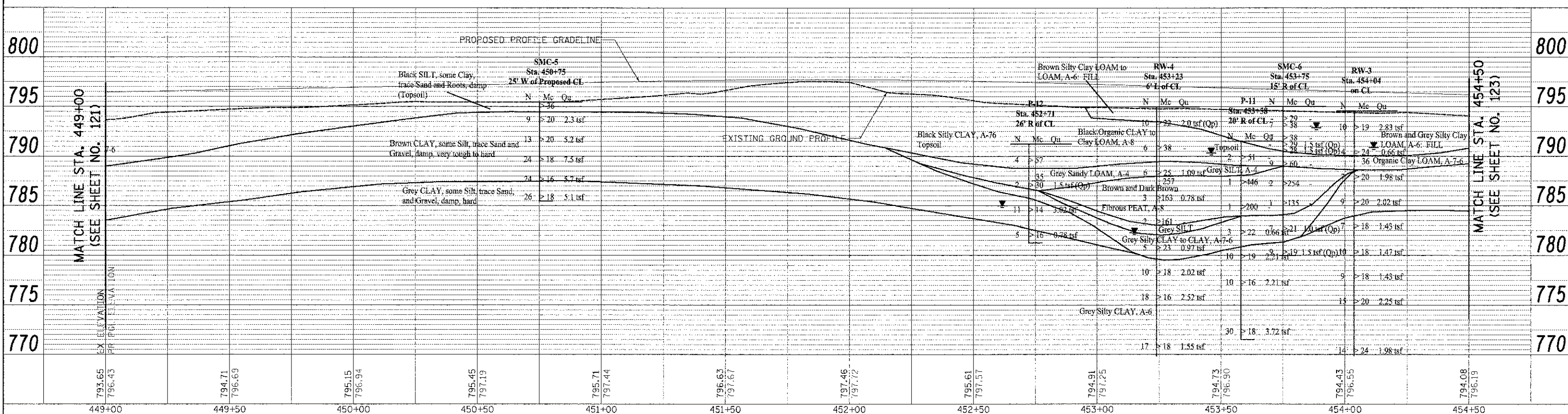
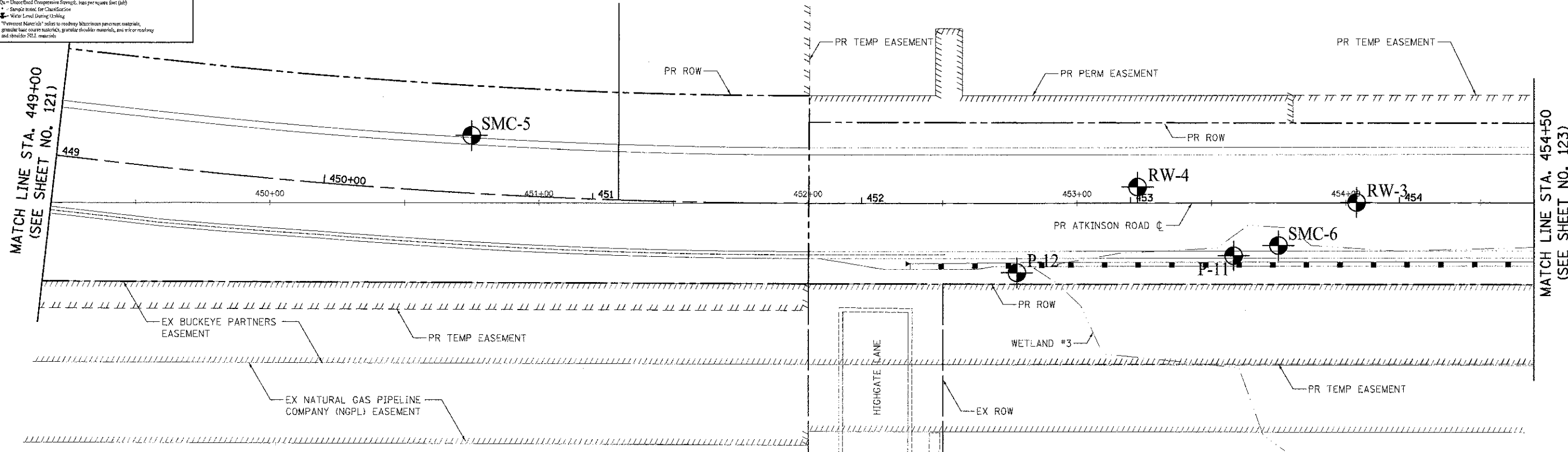

USER NAME = eds	DESIGNED = MSET	REVISED =
FILE NAME = \\2183-shr\soil04.dgn	DRAWN = MSET	REVISED =
PLT SCALE = 20:0000 1/1 in.	CHECKED = MSET	REVISED =
PLT DATE = 2/2/2012	DATE = 02/06/12	REVISED =

STATE OF ILLINOIS
DEPARTMENT OF TRANSPORTATION

ATKINSON ROAD
SOIL BORING LOCATION PLAN & SOIL PROFILE
 SCALE: 1" = 20' SHEET NO. 4 OF 13 SHEETS STA. 449+00 TO STA. 454+50

F.A.U. RTE. 198	SECTION 00-00045-00-PV	COUNTY LAKE	TOTAL SHEETS 195	SHEET NO. 122
CONTRACT NO. 63640				
FED. ROAD DIST. NO. 1 ILLINOIS FED. AID PROJECT				