

PLANNED	DATE
DESIGNED	
DRAWN	
CHECKED	
IN CHARGE	
NO.	

PROFILE	DATE
DESIGNED	
DRAWN	
CHECKED	
IN CHARGE	
NO.	

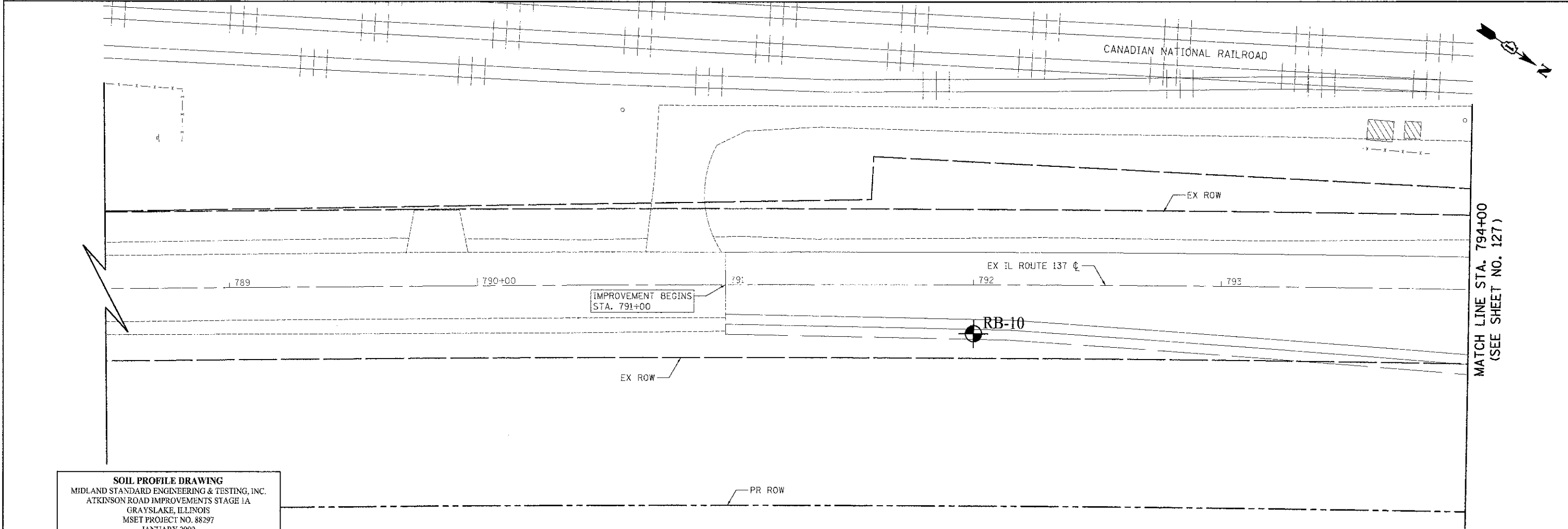

MATCH LINE STA. 794+00  
(SEE SHEET NO. 127)

**SOIL PROFILE DRAWING**  
 MIDLAND STANDARD ENGINEERING & TESTING, INC.  
 ATKINSON ROAD IMPROVEMENTS STAGE 1A  
 GRAYSLAKE, ILLINOIS  
 MSET PROJECT NO. 88297  
 JANUARY 2009

**LEGEND**

BORING NUMBER      CORE NUMBER  
 N - Standard Penetration Resistance, blows per foot  
 Mc - Moisture Content  
 Qp - Unconfined Compressive Strength, tons per square foot (tsf)  
 Qc - Unconfined Compressive Strength, tons per square foot (tsf)  
 \* - Sample tested for Classification  
 Water Level (Diving Bell)  
 \*Placement Material\* refers to road way bituminous pavement materials, granular base course materials, granular shoulder materials, and motor roadway and shoulder PCC material

IL ROUTE 137

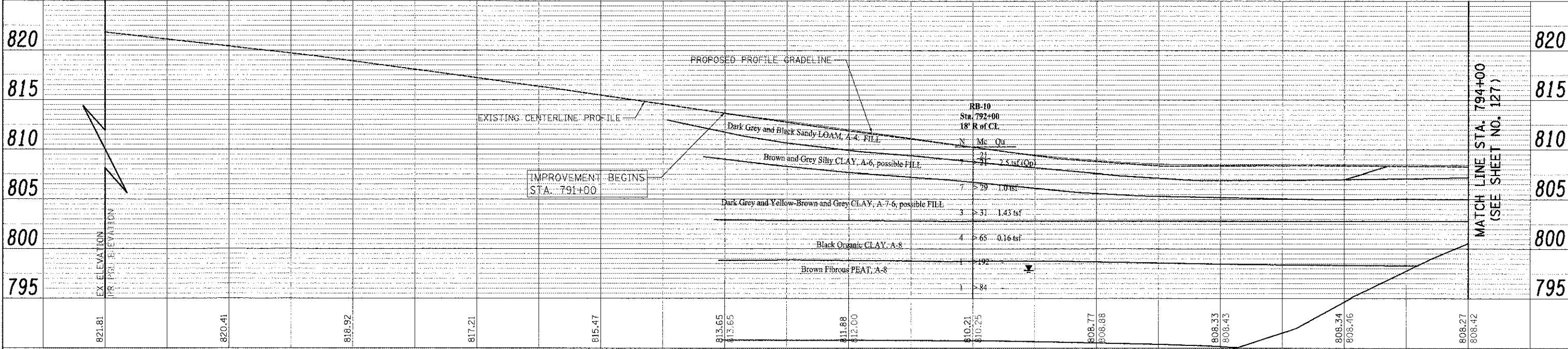

MATCH LINE STA. 794+00  
(SEE SHEET NO. 127)

	USER NAME: c.ude FILE NAME: ...\\2189\shc\soil08.dgn PLOT SCALE: 20.0000" / 1" PLOT DATE: 2/2/2012	DESIGNED - MSET DRAWN - MSET CHECKED - MSET DATE - 02/06/12	REVISED - REVISED - REVISED - REVISED -	<b>STATE OF ILLINOIS</b> <b>DEPARTMENT OF TRANSPORTATION</b>		<b>IL ROUTE 137</b> <b>SOIL BORING LOCATION PLAN &amp; SOIL PROFILE</b>		F.A.U. RITE: 198 SECTION: 00-00045-00-PV COUNTY: LAKE CONTRACT NO. 63640	TOTAL SHEET NO. 126 SHEETS: 195
	SCALE: 1" = 20'    SHEET NO. 1 OF 5 SHEETS    STA. 791+00 TO STA. 794+00				FED. ROAD DIST. NO. 1 ILLINOIS FED. AID PROJECT				