



LEGEND

-  TOPSOIL REMOVAL
-  REMOVAL AND DISPOSAL OF UNSUITABLE MATERIALS
-  POROUS GRANULAR EMBANKMENT, SUBGRADE
-  PAVEMENT REMOVAL

BY: _____ DATE: _____
 FINL SURVEY _____
 SURVEY _____
 NOTE BOOK _____
 AREAS CHECKED _____
 NO. _____

BY: _____ DATE: _____
 ORIGINAL SURVEY _____
 SURVEY _____
 NOTE BOOK _____
 AREAS CHECKED _____
 NO. _____

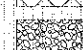
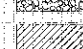
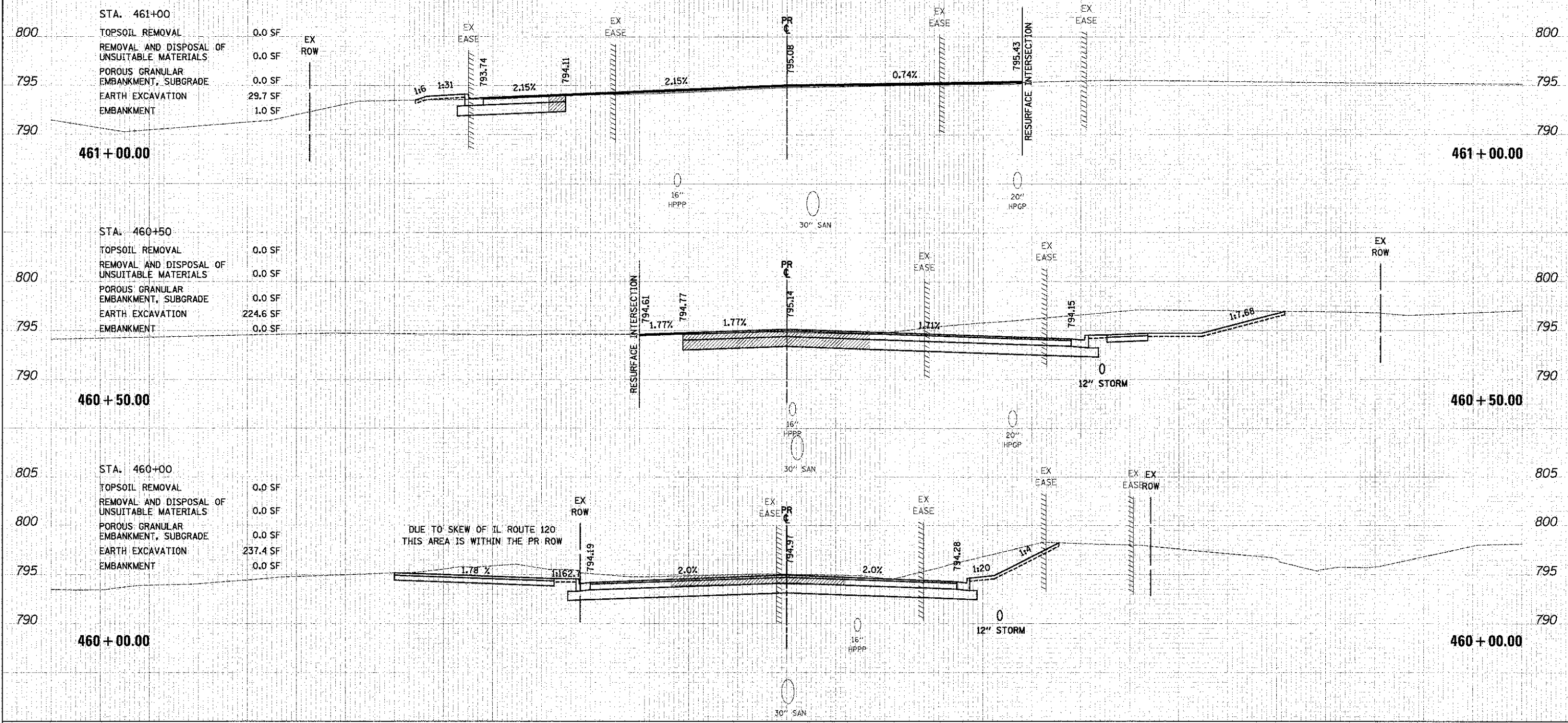

STA. 461+00

TOPSOIL REMOVAL	0.0 SF
REMOVAL AND DISPOSAL OF UNSUITABLE MATERIALS	0.0 SF
POROUS GRANULAR EMBANKMENT, SUBGRADE	0.0 SF
EARTH EXCAVATION	29.7 SF
EMBANKMENT	1.0 SF

STA. 460+50

TOPSOIL REMOVAL	0.0 SF
REMOVAL AND DISPOSAL OF UNSUITABLE MATERIALS	0.0 SF
POROUS GRANULAR EMBANKMENT, SUBGRADE	0.0 SF
EARTH EXCAVATION	224.6 SF
EMBANKMENT	0.0 SF

STA. 460+00

TOPSOIL REMOVAL	0.0 SF
REMOVAL AND DISPOSAL OF UNSUITABLE MATERIALS	0.0 SF
POROUS GRANULAR EMBANKMENT, SUBGRADE	0.0 SF
EARTH EXCAVATION	237.4 SF
EMBANKMENT	0.0 SF

DUE TO SKEW OF IL ROUTE 120
THIS AREA IS WITHIN THE PR ROW



USER NAME = acd	DESIGNED = JSM	REVISED =
FILE NAME = ...2189-sh-t-x-sh-tr-atk.dgn	DRAWN = JSM	REVISED =
PLOT SCALE = 1/8" = 1' / in.	CHECKED = DNM	REVISED =
PLOT DATE = 2/2/2012	DATE = 02/06/12	REVISED =

DESIGNED = JSM	REVISED =
DRAWN = JSM	REVISED =
CHECKED = DNM	REVISED =
DATE = 02/06/12	REVISED =

**STATE OF ILLINOIS
DEPARTMENT OF TRANSPORTATION**

CROSS SECTIONS - ATKINSON ROAD

SCALE: 1"=5'V/10'H | SHEET NO. 21 OF 26 SHEETS | STA. 460+00.00 TO STA. 461+00.00

F.A.U. 198	SECTION 00-00045-00-PV	COUNTY LAKE	TOTAL SHEETS 195	SHEET NO. 160
FED. ROAD DIST. NO. 1 ILLINOIS FED. AID PROJECT			CONTRACT NO. 63640	