

W11-10
48"x48"



WARNING SIGN, SPECIAL
48"x48"

CONSTRUCTION ENTRANCE SIGNING

1. SIGNS TO BE PLACED AT A LOCATION SPECIFIED BY THE ENGINEER TO NOTIFY TRAFFIC OF CONSTRUCTION ENTRANCES AND ACTIVITIES.
2. FLAGMAN REQUIRED WHEN ENTERING HIGHWAY.

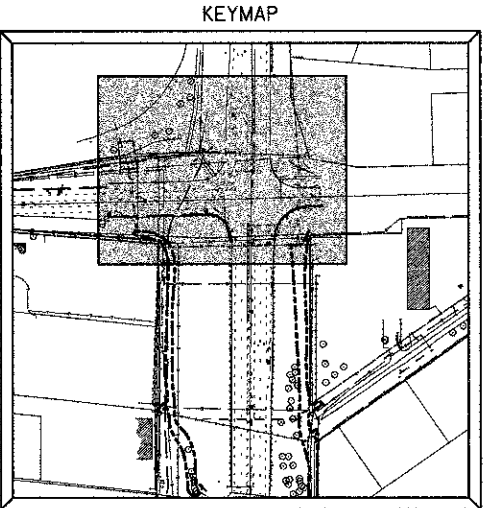

NOTES:

- * EXISTING AGGREGATE BASE COURSE SHALL BE REMOVED. BASE REMOVAL SHALL BE INCLUDED IN THE COST OF SIDEWALK REMOVAL.
- ALL STATION CALL OUTS ARE REFERENCED TO THE ADJACENT ROADWAY ALIGNMENT.

TOPSOIL, FURNISH AND PLACE, 6"
SEEDING, CLASS 1B
EROSION CONTROL BLANKET
(163 SQ YD)

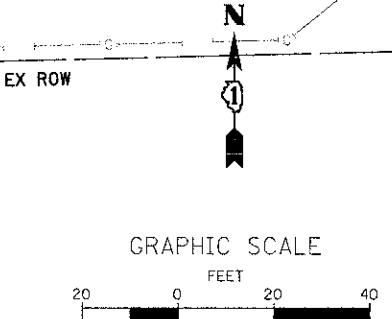
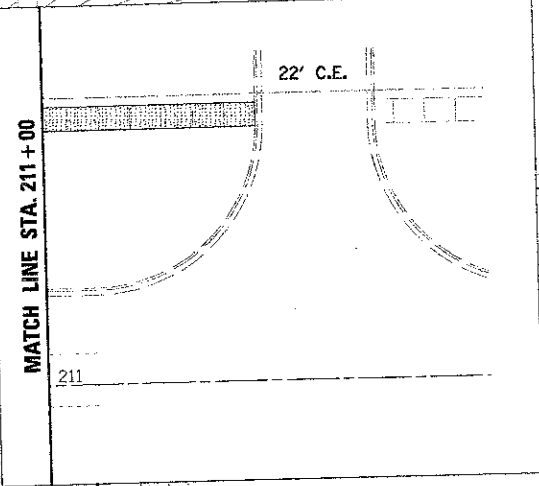

WILLS BURKE KELSEY ASSOCIATES LTD.
116 West Main Street, Suite 201
St. Charles, Illinois 60174
(630) 443-7755

| | | |
|-----------------------|----------------|-----------|
| USER NAME = #USER# | DESIGNED - DPB | REVISED - |
| PLOT SCALE = AS SHOWN | DRAWN - NDP | REVISED - |
| PLOT DATE = 5/11/2012 | CHECKED - DPB | REVISED - |
| | DATE - 5/14/12 | REVISED - |

**STATE OF ILLINOIS
DEPARTMENT OF TRANSPORTATION**

**EXISTING CONDITIONS
& REMOVAL PLAN**
SCALE: AS SHOWN SHEET NO. 11 OF 79 SHEETS STA. TO STA.

| | | | | |
|---|----------------|--------|--------------|-----------|
| F.A.P. RTE. | SECTION | COUNTY | TOTAL SHEETS | SHEET NO. |
| 0336 | 00-00259-00-BT | KANE | 79 | 11 |
| CONTRACT NO. 63667 | | | | |
| FED. ROAD DIST. NO. 1 ILLINOIS FED. AID PROJECT | | | | |

FILE NAME: W:\P\1163667\1163667.dwg