

08-03-12 LETTING ITEM 057  
INDEX OF SHEETS

1. COVER SHEET
2. GENERAL NOTES
3. SUMMARY OF QUANTITIES
4. TRAFFIC CONTROL DETAILS
- 5-11. STRUCTURE PLANS

STANDARDS

- |           |  |
|-----------|--|
| 000001-06 | STANDARD SYMBOLS, ABBREVIATIONS AND PATTERNS                               |
| 001001-02 | AREAS OF REINFORCEMENT BARS  |
| 001006    | DECIMAL OF AN INCH AND OF A FOOT   |
| 701006-03 | OFF-ROAD OPERATIONS 2L, 2W, 15' (4.5 m) TO 24" (600 mm) FROM PAVEMENT EDGE |
| 701901-02 | TRAFFIC CONTROL DEVICES  |

**STATE OF ILLINOIS**  
**DEPARTMENT OF TRANSPORTATION**  
**DIVISION OF HIGHWAYS**

**PROPOSED  
HIGHWAY PLANS**

**T.R. ROUTE 246  
(OLD DAD JOE TRAIL)  
SECTION (ORCB)BP-2  
PROJECT: ACTR-ACNHCB-0246(092)  
BRIDGE PAINTING  
BUREAU COUNTY  
C-93-021-12**

T.R. RTE. 246	SECTION (ORCB)BP-2	COUNTY BUREAU	TOTAL SHEETS 11	SHEET NO. 1
ILLINOIS			CONTRACT NO. 66B72	

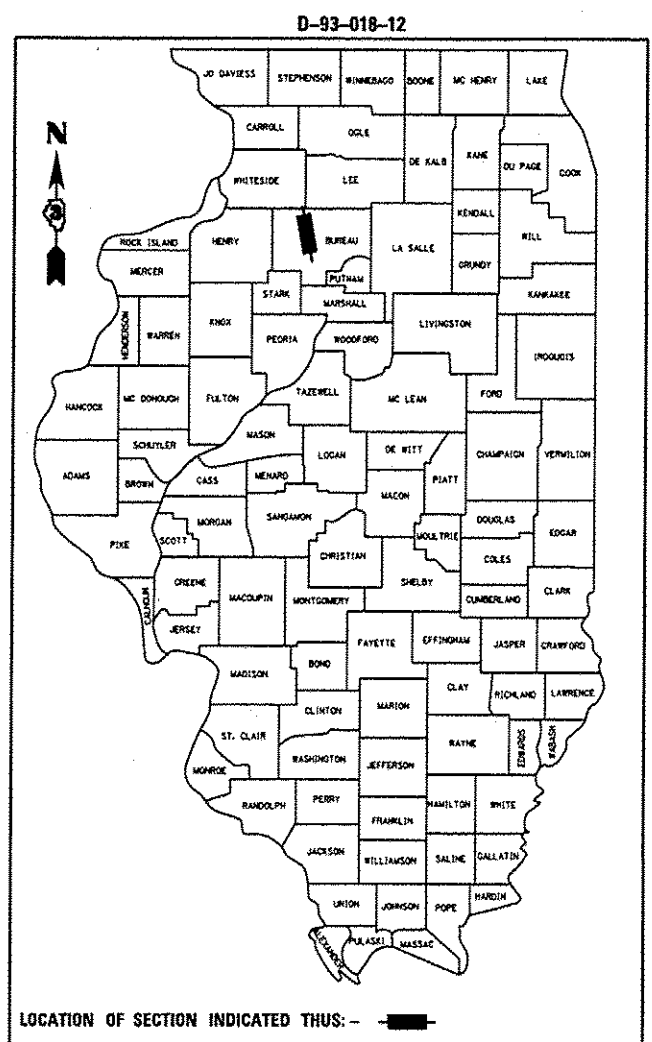

**RURAL  
LOCAL HIGHWAY  
TR 246  
(OLD DAD JOE TRAIL)  
2011**

ADT	200
P.V.	99.00%
S.U.	1.00%
M.U.	0.00%

**PROJECT LOCATION**  
SN 006-0134  
CARRYING TR 246  
(OLD DAD JOE TRAIL)  
OVER BUREAU CREEK  
0.50 MILES WEST OF IL 26

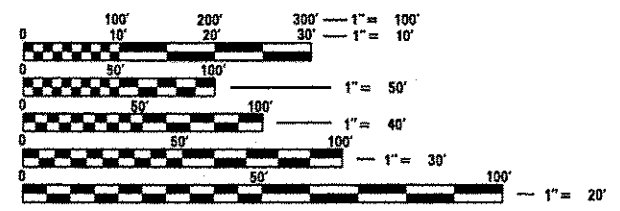

FULL SIZE PLANS HAVE BEEN PREPARED USING STANDARD ENGINEERING SCALES. REDUCED SIZED PLANS WILL NOT CONFORM TO STANDARD SCALES. IN MAKING MEASUREMENTS ON REDUCED PLANS, THE ABOVE SCALES MAY BE USED.

J.U.L.I.E.  
JOINT UTILITY LOCATION INFORMATION FOR EXCAVATION  
1-800-892-0123  
OR 811

DISTRICT 3 NO. (815) 434-6131

PROJECT ENGINEER: JOE KANNEL P.E.  
PROJECT MANAGER: RON WOODSHANK  
TOWNSHIP: DOVER  
CONTRACT NO. 66B72

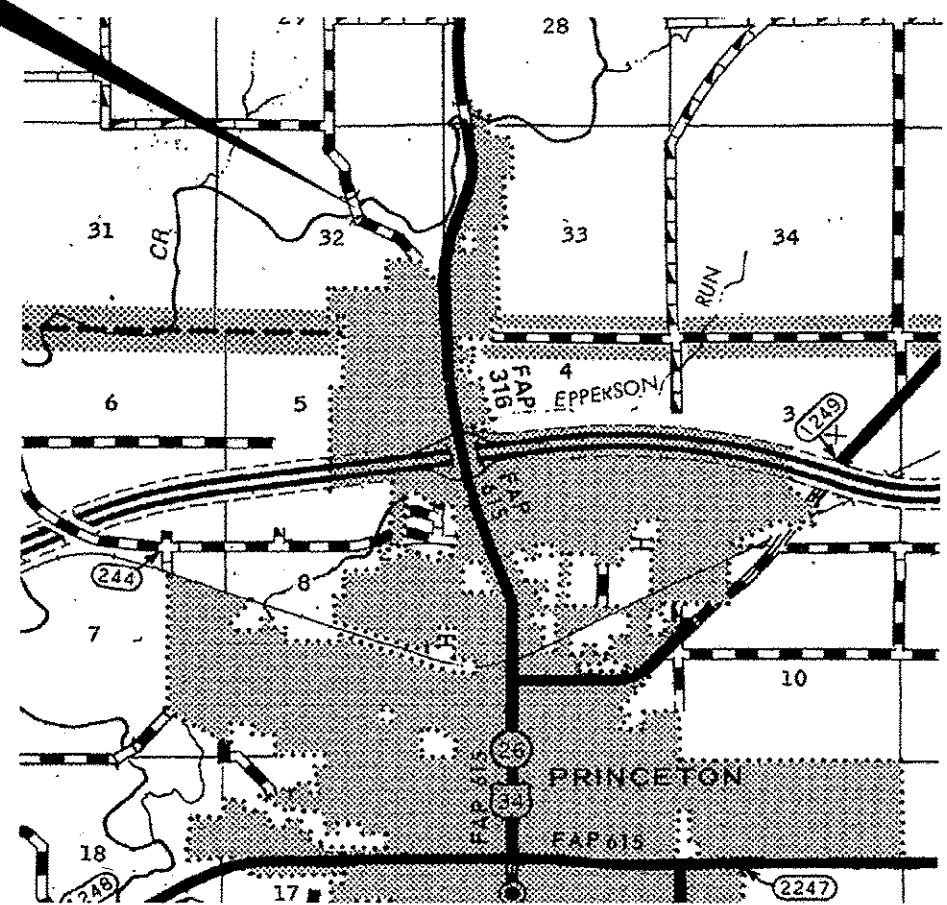

GROSS LENGTH = 156.00 FT. = 0.030 MILE  
NET LENGTH = 156.00 FT. = 0.030 MILE  
NOT TO SCALE

STATE OF ILLINOIS  
DEPARTMENT OF TRANSPORTATION  
DIVISION OF HIGHWAYS

SUBMITTED 6/22/12

*John D. Baranzelli*  
DEPUTY DIRECTOR OF HIGHWAYS, REGION ENGINEER

June 29 2012  
*John D. Baranzelli* P.E.  
acting ENGINEER OF DESIGN AND ENVIRONMENT

June 29 2012  
*William B. Freyer*  
acting DIRECTOR OF HIGHWAYS, CHIEF ENGINEER

**PRINTED BY THE AUTHORITY  
OF THE STATE OF ILLINOIS**

## GENERAL NOTES

FOR STABILIZATION, ALL TYPE III BARRICADES SHALL REQUIRE A MINIMUM OF FOUR SAND BAGS PER BARRICADE.

SEEDING SHALL NOT BE PERMITTED AT ANY TIME WHEN THE GROUND IS FROZEN, WET, OR IN AN UNTILLABLE CONDITION. LOCATIONS TO BE SEEDED WILL BE DETERMINED BY THE ENGINEER.

THE FINISHED EARTHWORK SHALL HAVE A VEGETATION SUSTAINING SOIL COVERING THE TOP FOUR INCHES IN AREAS TO BE SEEDED OR SODDED. THE VEGETATION SUSTAINING SOIL REQUIRED WILL NOT BE PAID FOR SEPARATELY BUT SHALL BE INCLUDED IN THE COST OF THE CONSTRUCTION ITEM REQUIREING THIS WORK.

ABANDONED UNDERGROUND UTILITIES THAT CONFLICT WITH CONSTRUCTION SHALL BE DISPOSED OF OUTSIDE THE LIMITS OF THE RIGHT OF WAY ACCORDING TO ARTICLE 202.03 OF THE STANDARD SPECIFICATIONS AND AS DIRECTED BY THE ENGINEER. THIS WORK WILL NOT BE PAID FOR SEPARATELY, BUT SHALL BE INCLUDED IN THE COST OF EARTH EXCAVATION.

ANY REFERENCE TO A STANDARD IN THESE PLANS SHALL BE INTERPRETED TO MEAN THE EDITION AS INDICATED BY THE SUBNUMBER SHOWN IN THE LIST OF STANDARDS OR THE COPY INCLUDED IN THESE PLANS.

THE CONTRACTOR'S ATTENTION IS DIRECTED TO THE PRESENCE OF DEPARTMENT-OWNED UNDERGROUND ELECTRICAL CABLE WITHIN THE LIMITS OF THE PROPOSED IMPROVEMENT. THE CONTRACTOR SHALL REQUEST THE ILLINOIS DEPARTMENT OF TRANSPORTATION IN OTTAWA (815-434-8417) TO LOCATE THE UNDERGROUND FACILITIES, PROVIDING A MINIMUM OF 72 HOURS NOTICE. THE DEPARTMENT IS NOT A MEMBER OF THE JOINT UTILITY LOCATING INFORMATION FOR EXCAVATORS (JULIE) SYSTEM.

ALL DAMAGE TO DEPARTMENT OWNED UNDERGROUND FACILITIES, CAUSED BY THE CONTRACTOR SHALL BE REPAIRED TO THE SATISFACTION OF THE DEPARTMENT AT THE CONTRACTOR'S EXPENSE. THIS SHALL INCLUDE ALL TEMPORARY REPAIRS REQUIRED TO KEEP THE FACILITY OPERATIONAL WHILE MATERIAL IS BEING OBTAINED TO MAKE PERMANENT REPAIRS. SPlicing OF ELECTRIC CABLE SHALL NOT BE ALLOWED. ELECTRIC CABLE SHALL BE REPLACED FROM POLE TO POLE OR CONTROLLER.

THE CONTRACTOR SHALL CONTACT JULIE AT LEAST 48 HOURS PRIOR TO EXCAVATION TO DETERMINE WHICH UTILITIES ARE IN THE AREA.

## NOTES

### "CLEAN AND PAINT WOODEN STRUCTURE"

#### 1. NORTH AND SOUTH APPROACH SPANS:

CLEAN AND PAINT EXISTING STEEL OR WOODEN GUARDRAIL POSTS, STEEL OR WOODEN RAILS AND STEEL GUARDRAIL POST BRACKETS.

EXISTING "STRUCTURAL STEEL" ON THE APPROACHES SHALL NOT BE PAINTED.

THE CLEANING AND PAINTING OF APPROACH SPAN COMPONENTS SHALL BE AS SPECIFIED IN THE PAINT MANUFACTURER'S RECOMMENDATIONS, AND THE SPECIAL PROVISIONS FOR "CLEANING AND PAINTING WOODEN STRUCTURES" AND "CONTAINMENT AND DISPOSAL OF NON-LEAD PAINT CLEANING RESIDUES".

COLOR OF THE FINAL FINISH COAT FOR APPROACH SPAN COMPONENTS SHALL BE "WHITE".

#### 2. COVERED SPAN

CLEAN AND PAINT ALL "EXISTING" INTERIOR AND EXTERIOR PAINTED PANELS AND TRIM SURFACES.

THE CLEANING AND PAINTING OF "EXISTING" INTERIOR AND EXTERIOR PAINTED PANELS AND TRIM SURFACES SHALL BE AS SPECIFIED IN THE PAINT MANUFACTURER'S RECOMMENDATIONS, THE SPECIAL PROVISIONS FOR "CLEANING AND PAINTING WOODEN STRUCTURES" AND "CONTAINMENT AND DISPOSAL OF NON-LEAD PAINT CLEANING RESIDUES".

COLOR OF THE FINAL FINISH COAT FOR INTERIOR AND EXTERIOR PAINTED PANELS AND TRIM SURFACES SHALL BE "BARN RED".

### "PROTECTIVE COAT"

#### 1. NORTH AND SOUTH APPROACH SPANS:

APPLY A WATERPROOFING/FIRE RETARDANT TREATMENT COAT TO ALL "UNPAINTED" SURFACES OF THE APPROACH SPANS WITH THE FOLLOWING EXCEPTION, THE SURFACE AREA OF THE APPROACH SPANS SHALL "NOT" BE TREATED.

#### 2. COVERED SPAN:

APPLY A WATERPROOFING/FIRE RETARDANT TREATMENT COAT TO ALL "UNPAINTED" WOODEN SURFACES OF THE STRUCTURE'S INTERIOR AND EXTERIOR INCLUDING THE ROOF SHINGLES, INTERIOR OF THE COVERED SPAN AND UNDERSIDE OF THE COVERED SPANS DECK WITH THE FOLLOWING EXCEPTION, THE SURFACE AREA OF THE COVERED SPAN SHALL "NOT" BE TREATED.

## COMMITMENTS

ALL EXISTING SOILS OR EMBANKMENTS DISTURBED OR EXCAVATED DUE TO THE CONTRACTOR'S CONSTRUCTION OPERATIONS SHALL REMAIN ON SITE AND SHALL BE DISPOSED OF WITHIN THE LIMITS OF THE STATE RIGHT OF WAY. THE ENGINEER SHALL DETERMINE LOCATIONS AND METHODS OF DISPOSAL AT TIME OF CONSTRUCTION.

DATE: 6-22-12

PREPARED BY: Don Bonil  
DISTRICT STUDIES & PLANS ENGINEER

EXAMINED BY: Herbert K. Jones, Jr.  
DISTRICT CONSTRUCTION ENGINEER

Wayne L. Phillips  
DISTRICT MATERIALS ENGINEER

Bruce A. Ancker  
DISTRICT OPERATIONS ENGINEER

FILE NAME =	USER NAME = woodshankr1	DESIGNED <u>RON WOODSHANK</u>	REVISED -	STATE OF ILLINOIS DEPARTMENT OF TRANSPORTATION	GENERAL NOTES	T.R. RTE.	SECTION	COUNTY	TOTAL SHEETS	SHEET NO.	
c:\pwwork\pwwork\woodshankr1\d282868	366872-shr-detailed.dgn	DRAWN <u>RON WOODSHANK</u>	REVISED -			246	(ORCBIP-2)	BUREAU	11	2	
	PLOT SCALE = 1/8" = 1'	CHECKED -	REVISED -			CONTRACT NO. 66872					
	PLOT DATE = 6/28/2012	DATE -	REVISED -			SCALE:	SHEET NO. 1 OF 1 SHEETS	STA.	TO STA.		ILLINOIS FED. AID PROJECT

508 13 408

80% FED. / 20% STATE

CONSTR. CODE  
STATE FUNDS

STRUCTURE  
0014  
RURAL

CODE NO.	ITEM	UNIT	TOTAL QUANTITY	
50700105	TREATED TIMBER	F.B.M.	105	105
67100100	MOBILIZATION	L SUM	1	1
X0325689	REMOVAL OF EXISTING TIMBER MEMBERS	L SUM	1	1
X0326549	STONE MASONRY REPAIRS AND REPLACEMENT	L SUM	1	1
X0327291	WOODEN WALL PLANK	SQ FT	186	186
X5030550	PROTECTIVE COAT (SPECIAL)	SQ YD	2331	2331
X5067500	BRIDGE CLEANING AND PAINTING WARRANTY	L SUM	1	1
X7010216	TRAFFIC CONTROL AND PROTECTION, (SPECIAL)	L SUM	1	1
Z0012754	STRUCTURAL REPAIR OF CONCRETE (DEPTH EQUAL TO OR LESS THAN 5 INCHES)	SQ FT	7	7
Z0031300	JACKING AND CRIBBING	L SUM	1	1
Z0075500	TIMBER RETAINING WALL	SQ FT	80	80
Z0075505	TIMBER RETAINING WALL REMOVAL	FOOT	40	40
X0327405	CLEANING AND PAINTING WOODEN STRUCTURE	L SUM	1	1



1

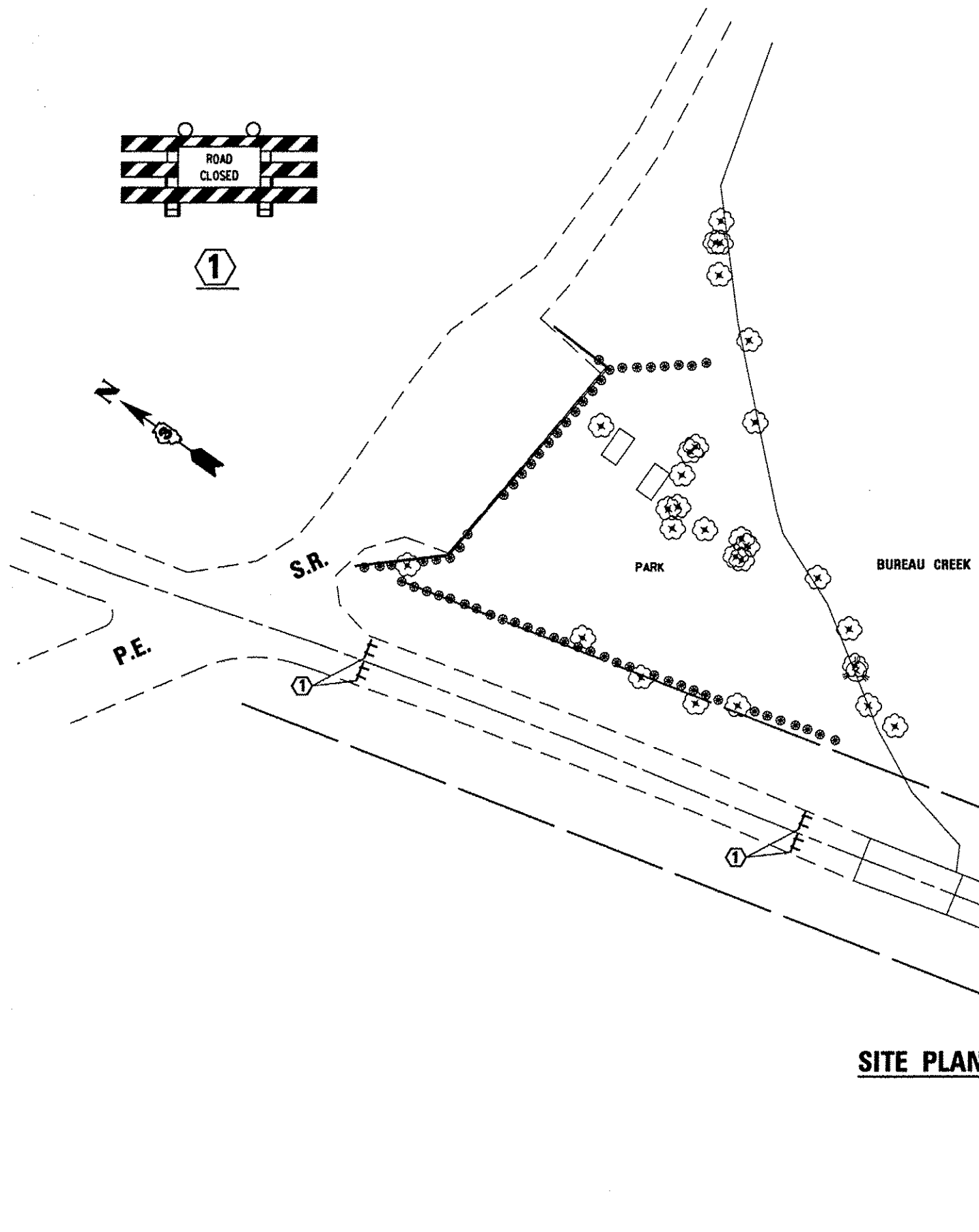
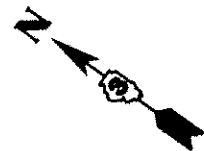

**SITE PLAN**

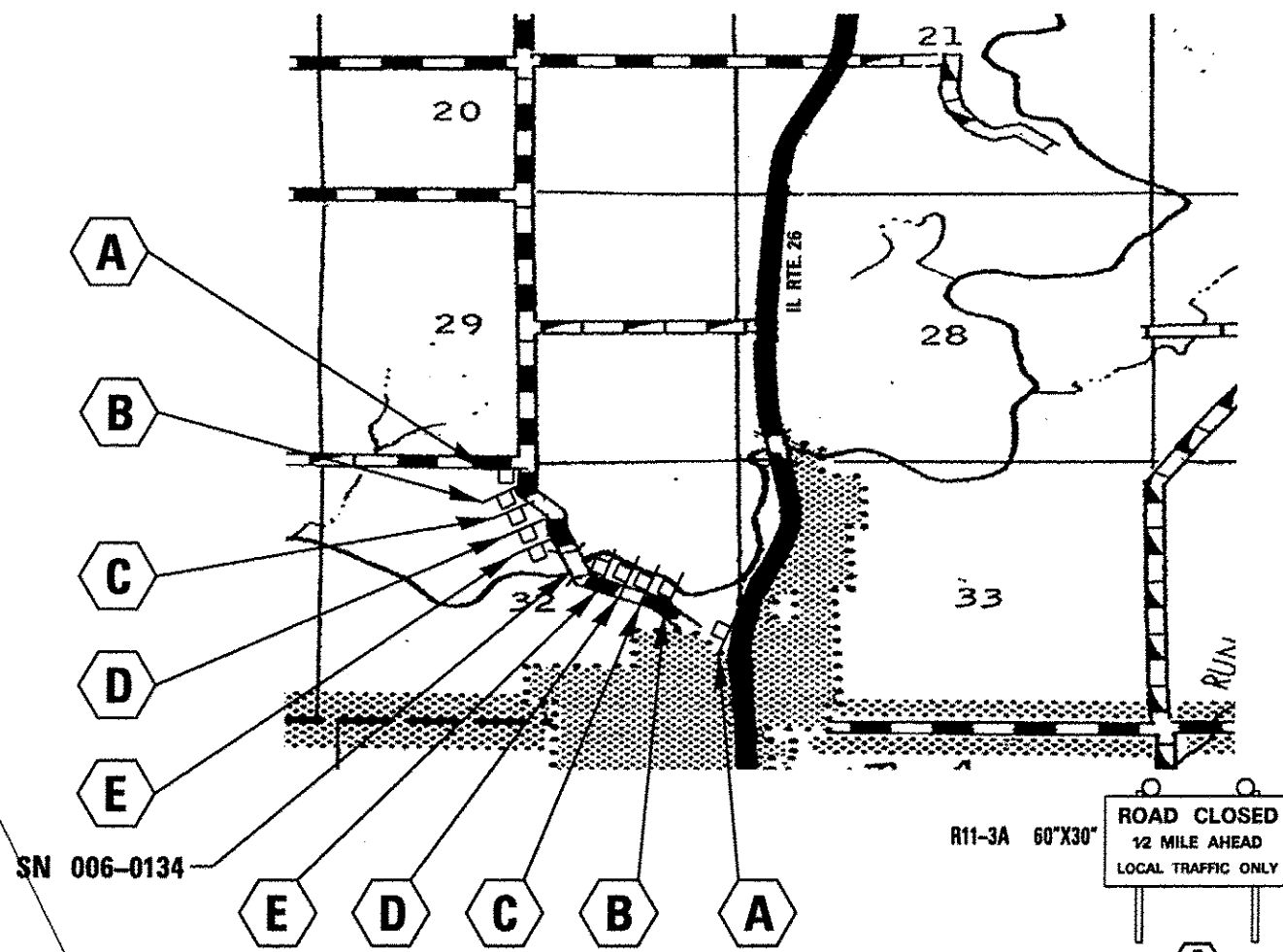

SN 006-0134

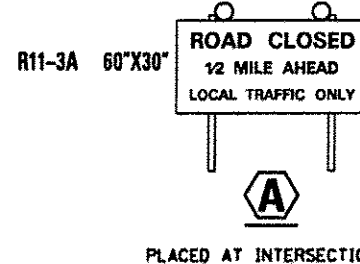

PLACED AT INTERSECTION

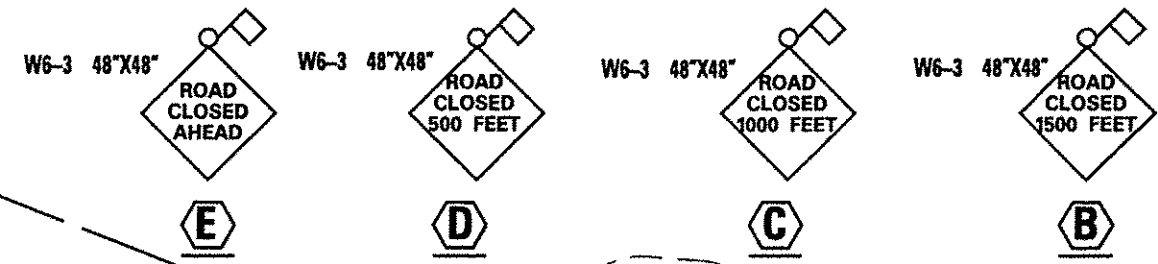

PAVED TURNAROUND

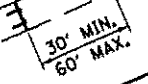

FILE NAME : c:\pwwork\psidot\woodshankr\1\08282068	USER NAME : woodshankr1	DESIGNED <b>RON WOODSHANK</b>	REVISED -
	366872-sht-details.dgn	DRAWN <b>RON WOODSHANK</b>	REVISED -
	PLOT SCALE * 1/8" = 1' / 1/4"	CHECKED -	REVISED -
	PLOT DATE * 6/28/2012	DATE -	REVISED -

**STATE OF ILLINOIS  
DEPARTMENT OF TRANSPORTATION**

**TRAFFIC CONTROL DETAILS**

SCALE: SHEET NO. 1 OF 1 SHEETS STA. TO STA.

T.P. RTE. 246	SECTION 10RCS/1P-2	COUNTY BUREAU	TOTAL SHEETS 11	SHEET NO. 4
CONTRACT NO. 66872			ILLINOIS FED. AID PROJECT	

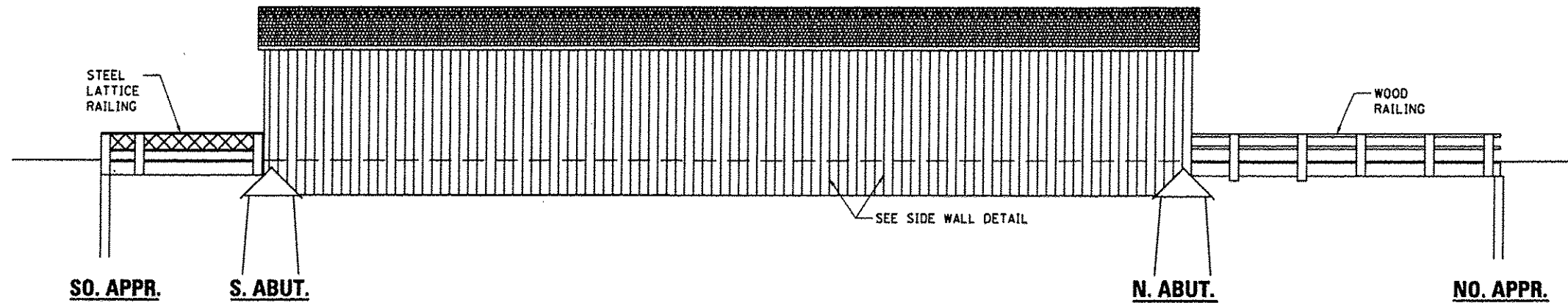

**ELEVATION**

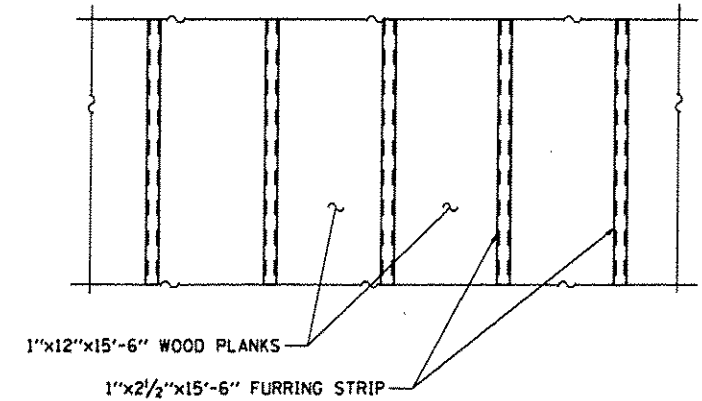

**SIDE WALL DETAIL**

CLEAN AND PAINT ALL EXISTING PAINTED EXTERIOR AND INTERIOR WOOD SIDING PLANKS AND TRIM INCLUDING PIER CAPS

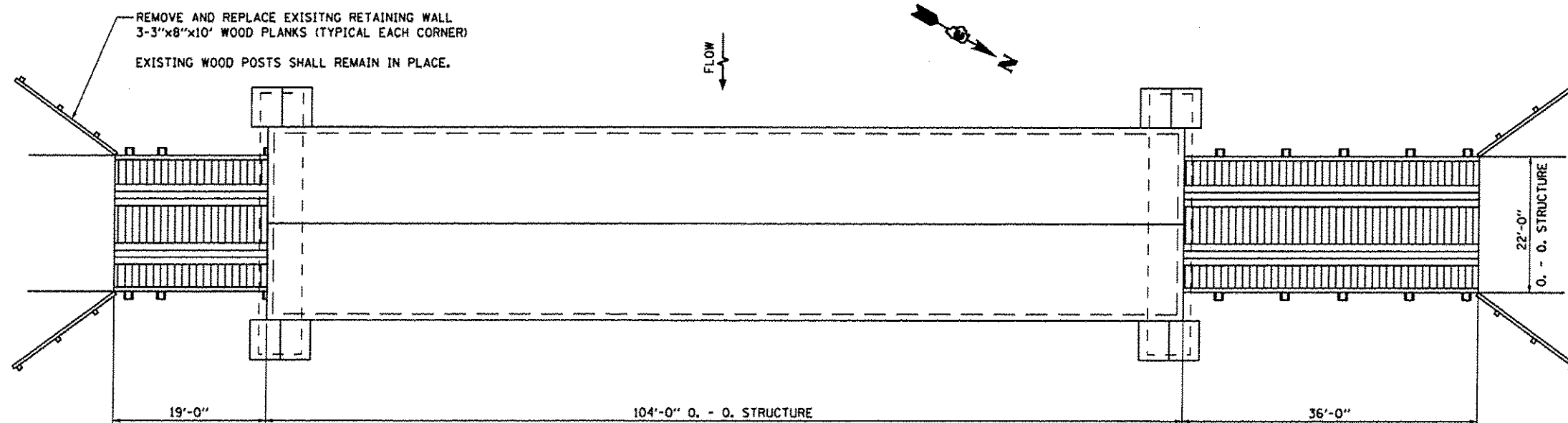

**PLAN**

**DESIGN SPECIFICATIONS**

PAINTED WOOD SURFACE AREA = 694 SQ YDS

**PROTECTIVE COAT AREA**  
 ROOF SHINGLES = 308 SQ YDS  
 INTERIOR = 1329 SQ YDS  
 EXTERIOR = 694 SQ YDS

**TOTAL BILL OF MATERIAL**

ITEM	UNIT	SUPER	SUB	TOTAL
CLEANING AND PAINTING WOOD STRUCTURE	L SUM	1		1
TREATED TIMBER	F.B.M.		105	105
REMOVAL OF EXISTING TIMBER MEMBERS	L SUM	1		1
STONE MASONRY REPAIRS AND REPLACEMENT	L SUM		1	1
WOODEN WALL PLANK	SQ FT	186		186
PROTECTIVE COAT (SPECIAL)	SQ YD	1002	1329	2331
STRUCTURAL REPAIR OF CONCRETE (DEPTH EQUAL TO OR LESS THAN 5")	SQ FT		7	7
JACKING AND CRIBBING	L SUM		1	1
TIMBER RETAINING WALL	SQ FT		80	80
TIMBER RETAINING WALL REMOVAL	FOOT		40	40

FILE NAME :	USER NAME : woodshankr1	DESIGNED <b>RON WOODSHANK</b>	REVISED -
or\p\work\p\sidot\woodshankr1\d9282868\0366872-sht-detail.dgn		DRAWN <b>RON WOODSHANK</b>	REVISED -
PLOT SCALE : 1/8" = 1'		CHECKED -	REVISED -
PLOT DATE : 6/28/2012		DATE -	REVISED -

STATE OF ILLINOIS  
 DEPARTMENT OF TRANSPORTATION

**GENERAL PLAN AND ELEVATION  
 FOR SN 006-0134**

SCALE: SHEET NO. 1 OF 6 SHEETS STA. TO STA.

F.R. RTE.	SECTION	COUNTY	TOTAL SHEETS	SHEET NO.
246	(ORCBHP-2)	BUREAU	11	5
			CONTRACT NO. 66872	
ILLINOIS FED. AID PROJECT				

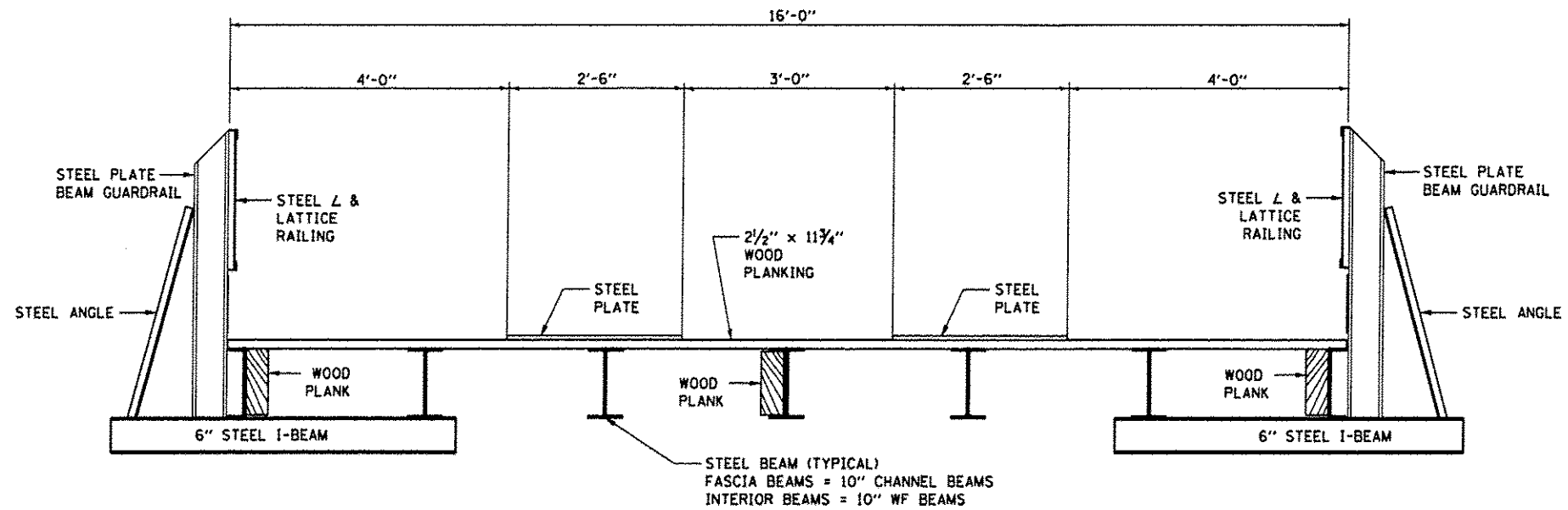

**TYPICAL SECTION**  
**SOUTH APPROACH**

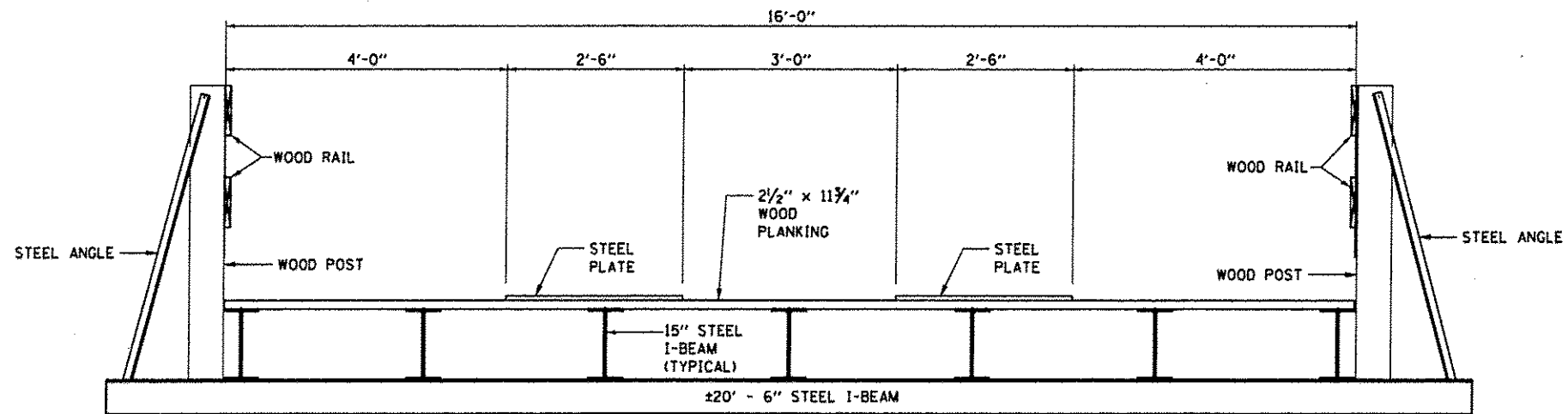

**TYPICAL SECTION**  
**NORTH APPROACH**

FILE NAME *	USER NAME * woodshankr1	DESIGNED <i>RON WOODSHANK</i>	REVISED -	<b>STATE OF ILLINOIS DEPARTMENT OF TRANSPORTATION</b>	<b>TYPICAL SECTIONS FOR S.N. 006-0134</b>	T.P. RTEL	SECTION	COUNTY	TOTAL SHEETS	SHEET NO.
01\pe_work\p1dot\woodshankr1\d8282068\366872-shs-detailed.dgn	DRAWN <i>RON WOODSHANK</i>	REVISED -	246			(ORCB)BP-2	BUREAU	11	6	
PLOT SCALE * 1/8" = 1'-0"	CHECKED -	REVISED -	CONTRACT NO. 66B72							
PLOT DATE * 6/20/2012	DATE -	REVISED -	(ILLINOIS) FED. AID PROJECT							
				SCALE:	SHEET NO. 1 OF 1 SHEETS	STA.	TO STA.			





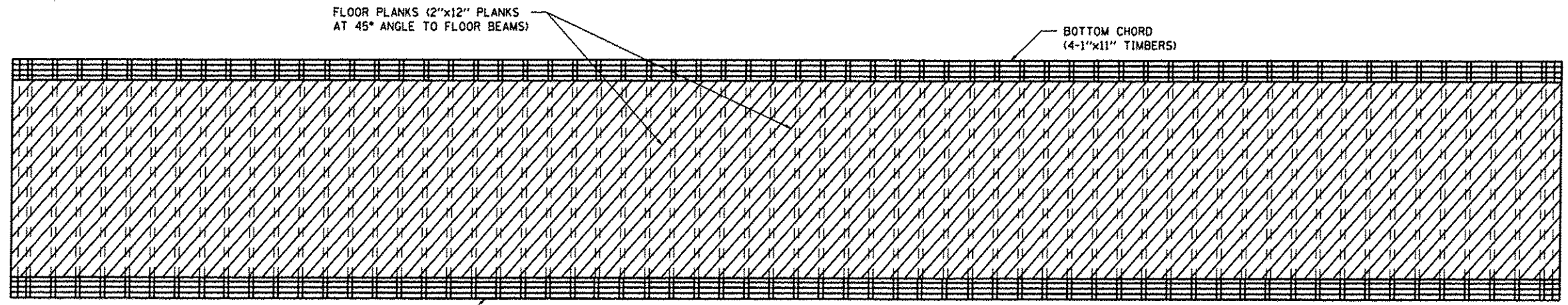

**FLOOR DECK  
FLOORING**  
AS VIEWED FROM TOP

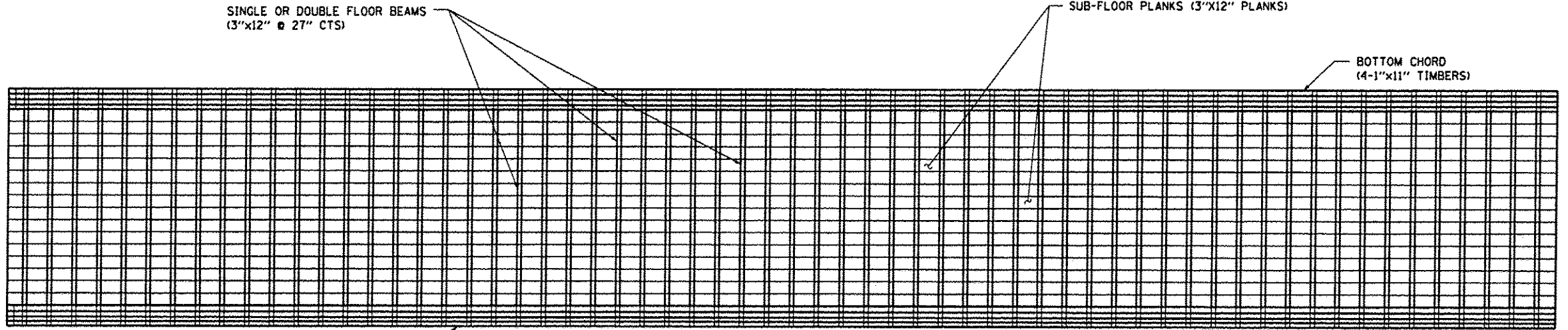

**FLOOR DECK  
SUB-FLOOR**  
AS VIEWED FROM BOTTOM

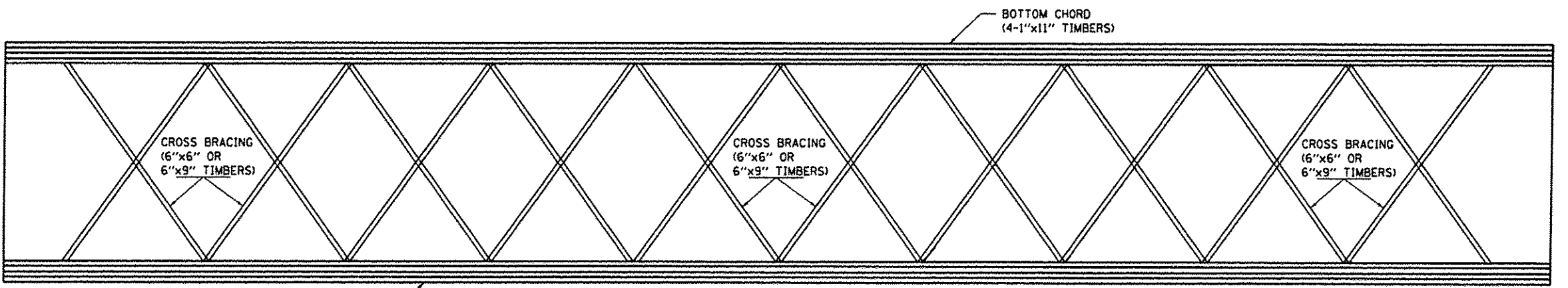

**FLOOR DECK  
CROSS FRAMING**  
AS VIEWED FROM BOTTOM

FILE NAME :	USER NAME : woodshankr1	DESIGNED <i>RON WOODSHANK</i>	REVISED -
o:\p\work\pwidth\woodshankr1\d8282868\0366872-shr\details.dgn		DRAWN <i>RON WOODSHANK</i>	REVISED -
	PLOT SCALE : 1/8" = 1' / in.	CHECKED -	REVISED -
	PLOT DATE : 6/20/2012	DATE -	REVISED -

STATE OF ILLINOIS  
DEPARTMENT OF TRANSPORTATION

**FLOOR DECK DETAILS  
FOR SN 006-0314**

SCALE: SHEET NO. 3 OF 6 SHEETS STA. TO STA.

T.R. RTE. 246	SECTION ORCBP-2	COUNTY BUREAU	TOTAL SHEETS 11	SHEET NO. 8
CONTRACT NO. 66B72				
ILLINOIS FED. AID PROJECT				



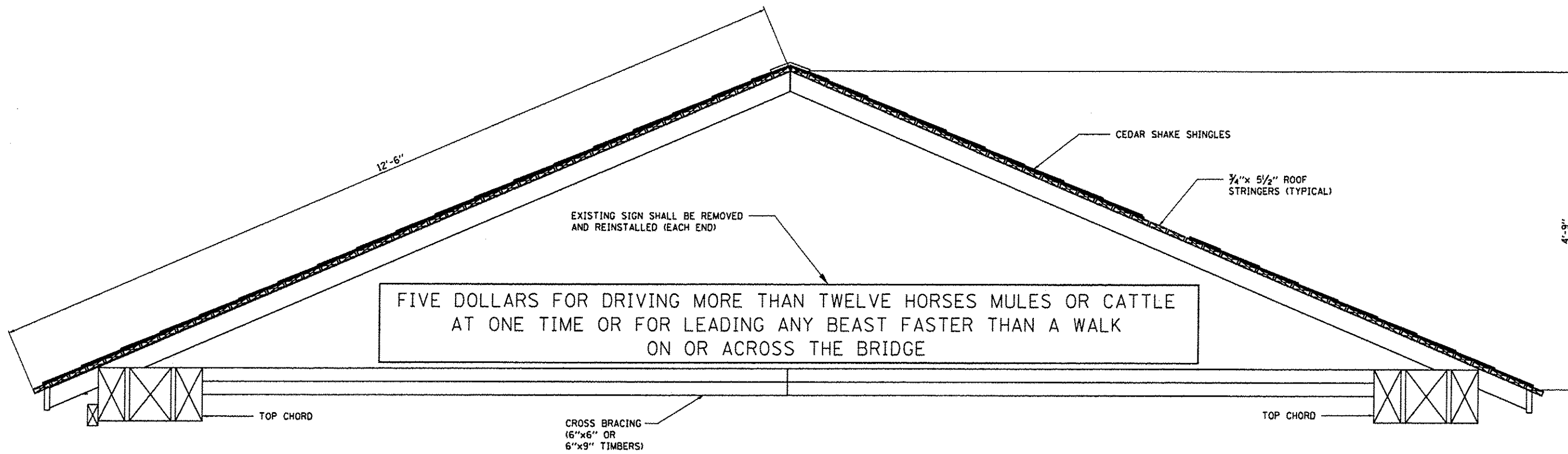

FIVE DOLLARS FOR DRIVING MORE THAN TWELVE HORSES MULES OR CATTLE  
AT ONE TIME OR FOR LEADING ANY BEAST FASTER THAN A WALK  
ON OR ACROSS THE BRIDGE

**ELEVATION**

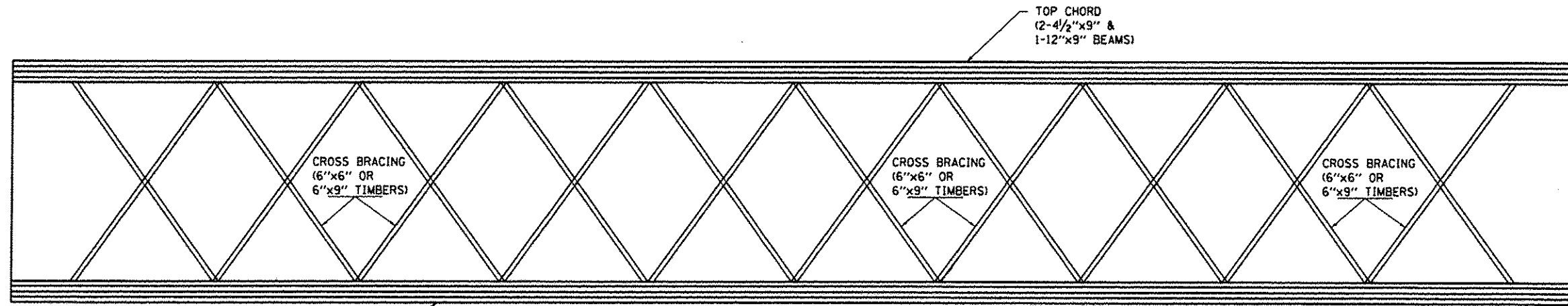

**ROOF CROSS BRACING**  
CROSS FRAMING  
AS VIEWED FROM BOTTOM

FILE NAME :	USER NAME :	DESIGNED :	REVISED :
at:\pwork\p1dot\woodshank\1\02282068	woodshank-1	RON WOODSHANK	-
		DRAWN :	REVISED :
		RON WOODSHANK	-
		CHECKED :	REVISED :
			-
		DATE :	REVISED :
			-

STATE OF ILLINOIS  
DEPARTMENT OF TRANSPORTATION

**ROOF DETAILS**  
FOR SN 006-134

SCALE: SHEET NO. 4 OF 6 SHEETS STA. TO STA.

T.P. RATE:	SECTION:	COUNTY:	TOTAL SHEETS:	SHEET NO.:
246	(ORCBIP-2)	BUREAU	11	9
			CONTRACT NO. 66872	
ILLINOIS FED. AID PROJECT				

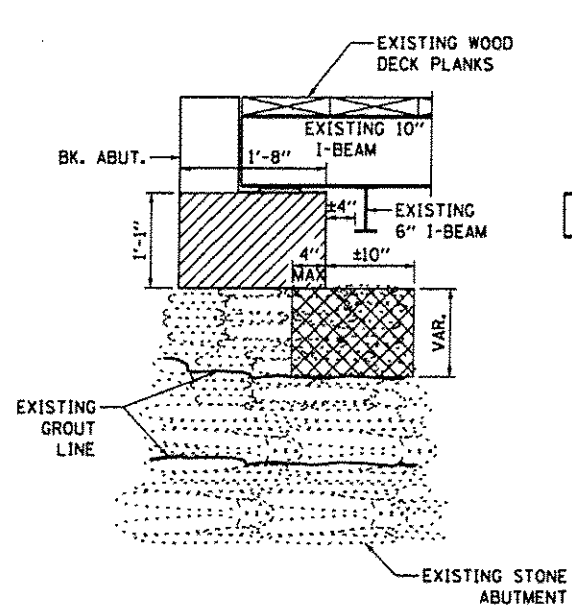

**END ELEVATION  
EAST END**

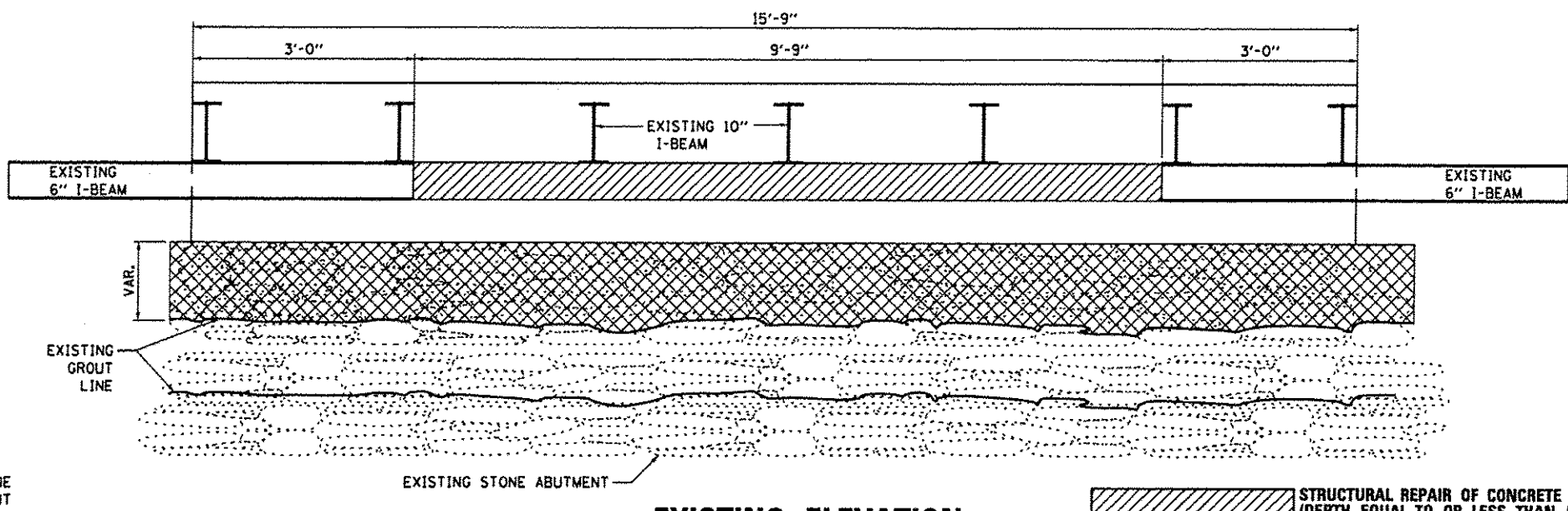

**EXISTING ELEVATION  
SOUTH APPROACH**

STRUCTURAL REPAIR OF CONCRETE (DEPTH EQUAL TO OR LESS THAN 5")  
 STONE MASONRY REMOVAL

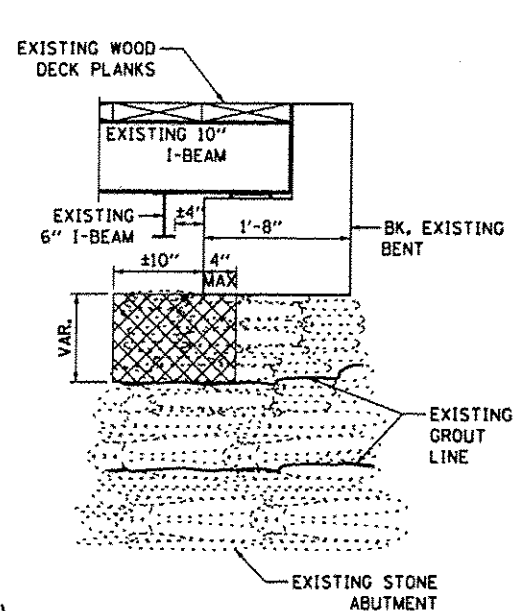

**END ELEVATION  
WEST END**

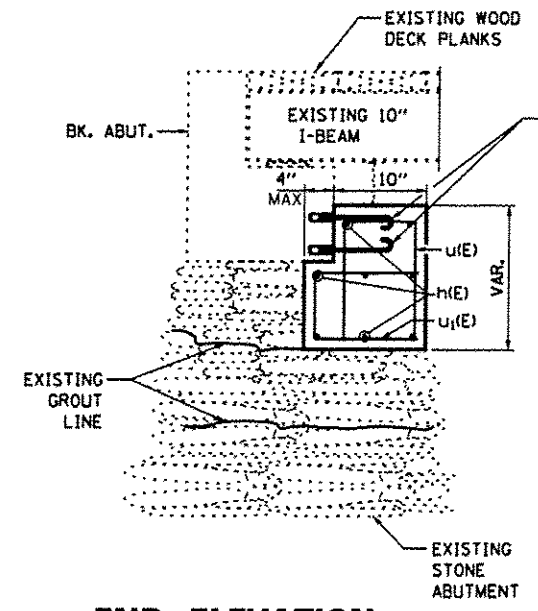

**END ELEVATION  
EAST END**

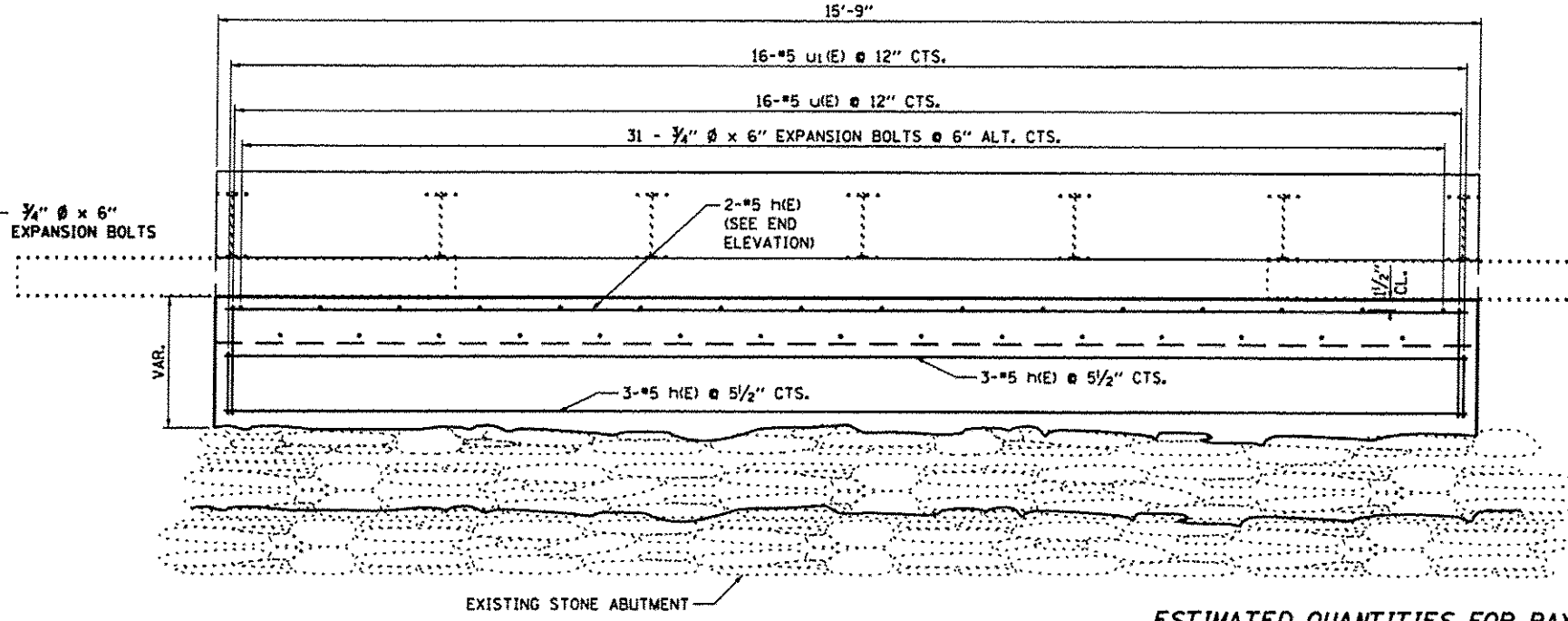

**PROPOSED ELEVATION  
SOUTH APPROACH**

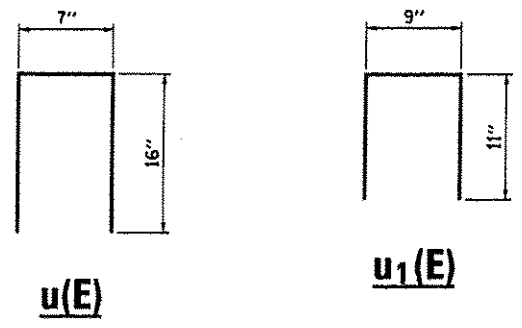

**ESTIMATED QUANTITIES FOR PAY ITEM  
"STONE MASONRY REPAIRS & REPLACEMENT"  
FOR INFORMATION ONLY**

Bar	No.	Size	Length	Shape
h(E)	8	#5	15'-0"	
u(E)	16	#5	1'-11"	
u1(E)	16	#5	1'-8"	
STONE REMOVAL			CU. YD.	1.2
CONCRETE			CU. YD.	1.2
SUPERSTRUCTURE REINFORCEMENT BARS EPOXY COATED			POUND	185
EXPANSION BOLTS 3/4" x 6"			EACH	31
MASONRY CLEANING AND TUCK POINTING			SQ YD	11

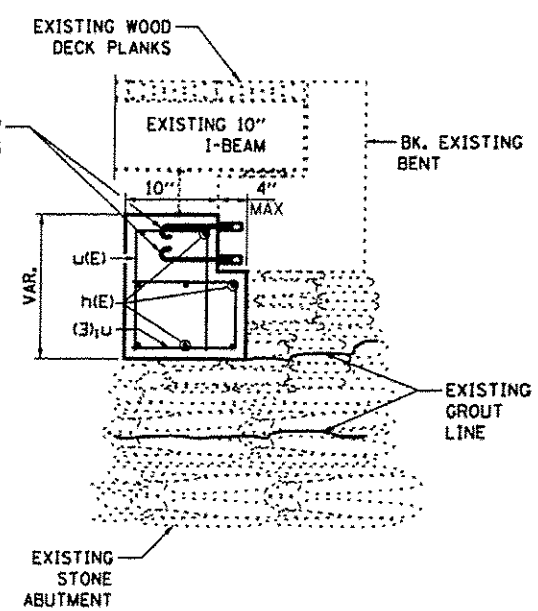

**END ELEVATION  
WEST END**

**BILL OF MATERIAL**

ITEM	UNIT	SUPER	SUB	TOTAL
STRUCTURAL REPAIR OF CONCRETE (DEPTH LESS THAN OR EQUAL TO 5")	SQ FT		7	7
STONE MASONRY REPAIRS AND REPLACEMENT	L SUM		1	1

FILE NAME :	USER NAME :	DESIGNED :	REVISED :
c:\pwwork\psidat\woodshankr1\d0202068	woodshankr1	RON WOODSHANK	-
		DRAWN :	REVISED :
		RON WOODSHANK	-
		CHECKED :	REVISED :
			-
		DATE :	REVISED :
			-

STATE OF ILLINOIS  
DEPARTMENT OF TRANSPORTATION

**SOUTH APPROACH DETAILS**  
SCALE: SHEET NO. 5 OF 6 SHEETS STA. TO STA.

T.R. RTE. 246	SECTION IORCBP-2	COUNTY BUREAU	TOTAL SHEETS 11	SHEET NO. 10
CONTRACT NO. 66B72				
ILLINOIS FED. AID PROJECT				

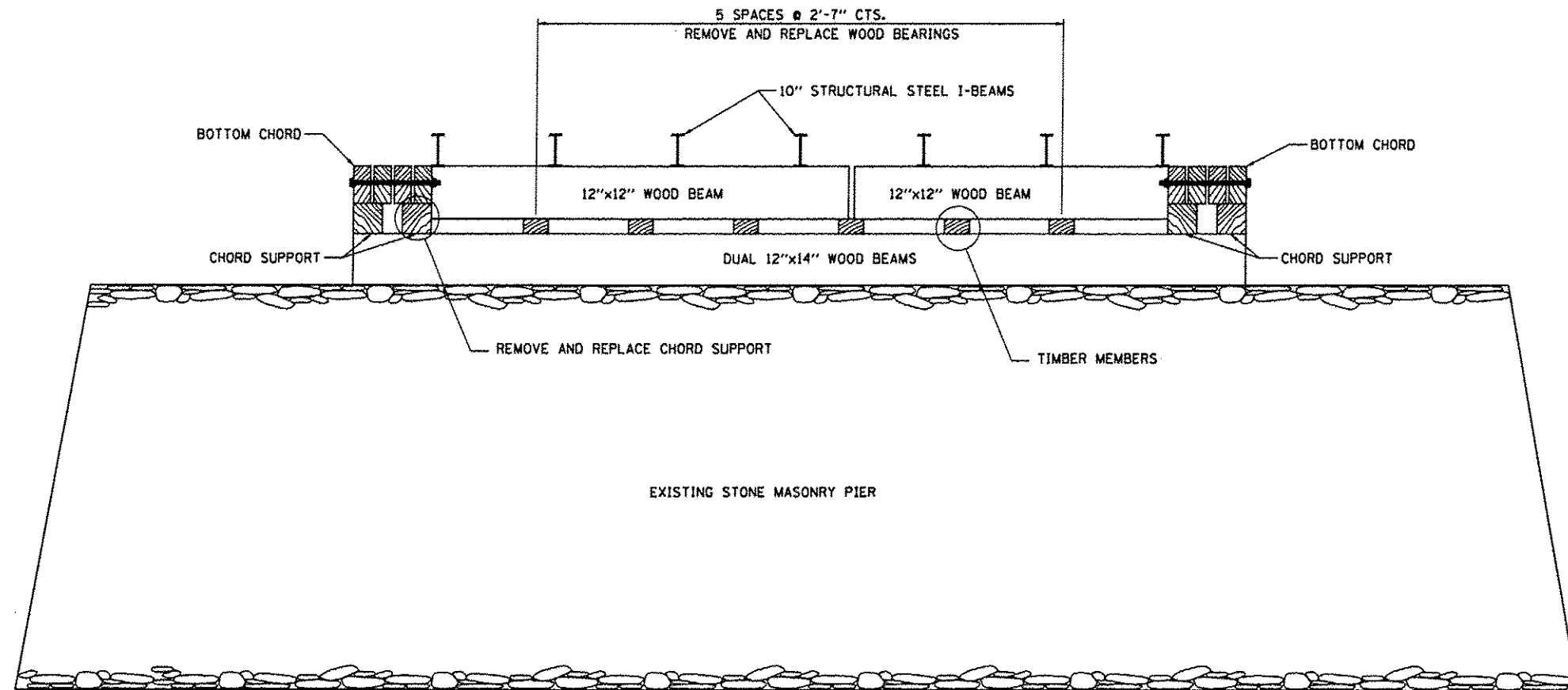

**SOUTH ELEVATION  
SOUTH ABUTMENT**

NOTE: THE CONTRACTOR SHALL FIELD VERIFY ALL DIMENSIONS PRIOR TO ORDERING OF MATERIALS.

REMOVAL OF THE DESIGNATED STRUCTURAL TIMBER MEMBERS (INCLUDING BEARINGS AND CHORD SUPPORTS) SHALL BE ACCORDING TO THE SPECIAL PROVISION FOR "REMOVAL OF EXISTING TIMBER MEMBERS".

REPLACEMENT OF THE STRUCTURAL TIMBER MEMBERS SHALL BE ACCORDING TO SECTION 507 OF THE STANDARD SPECIFICATIONS.

NO BEARING WORK TO BE DONE AT THE NORTH PIER (#2)

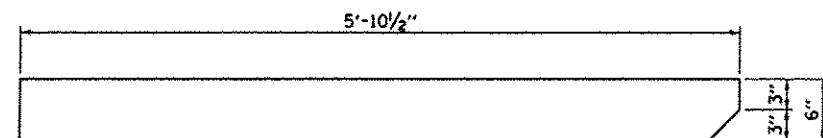

**ELEVATION**

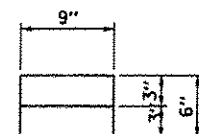

**END VIEW**

**CHORD SUPPORT**

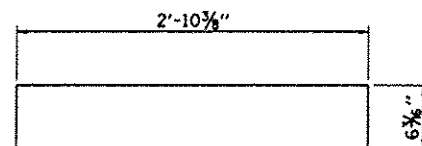

**ELEVATION**

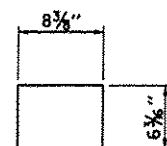

**END VIEW**

**BEARING**

**BILL OF MATERIAL**

ITEM	UNIT	SUPER	SUB	TOTAL
JACKING AND CRIBBING	L. SUM		1	1
REMOVAL OF EXISTING TIMBER MEMBERS	L. SUM		1	1
TREATED TIMBER	F.B.M		105	105

FILE NAME :	USER NAME : woodshankr1	DESIGNED <i>RON WOODSHANK</i>	REVISED -	<b>STATE OF ILLINOIS DEPARTMENT OF TRANSPORTATION</b>	<b>SOUTH ABUTMENT DETAILS</b>	T.R. RTE.	SECTION	COUNTY	TOTAL SHEETS	SHEET NO.
c:\pwwork\pwwork\woodshankr1\d0282866	366872-ehc-detailed.dgn	DRAWN <i>RON WOODSHANK</i>	REVISED -			246	(ORCB)BP-2	BUREAU	11	11
PLOT SCALE = 100:1 @ 1/4" = 1'-0"	CHECKED -	REVISOR -	REVISOR -			CONTRACT NO. 66B72		ILLINOIS FED. AID PROJECT		
PLOT DATE = 6/28/2012	DATE -	REVISOR -	REVISOR -			SCALE:	SHEET NO. 6 OF 6 SHEETS	STA.	TO STA.	