

08-03-2018 LETTING ITEM 006

STATE OF ILLINOIS

DEPARTMENT OF TRANSPORTATION

PLANS FOR PROPOSED FEDERAL-AID HIGHWAY

HAWK HOLLOW TRAIL: LAWRENCE AVE/COUNTY FARM ROAD TO
LAWRENCE AVE/MORTON ROAD

BIKE/PED PATH

SECTION 15-00063-00-BT

PROJECT: LBBW(388)

VILLAGE OF HANOVER PARK

DUPAGE COUNTY

C-91-149-17

F.A. RTE.	SECTION	COUNTY	TOTAL SHEETS	SHEET NO.
	15-00063-00-BT	DUPAGE	10	1
	ILLINOIS			CONTRACT NO. 61E39

FOR INDEX OF SHEETS, SEE SHEET NO. 2

DESIGN DESIGNATION
HAWK HOLLOW PATH: SHARED USED PATH

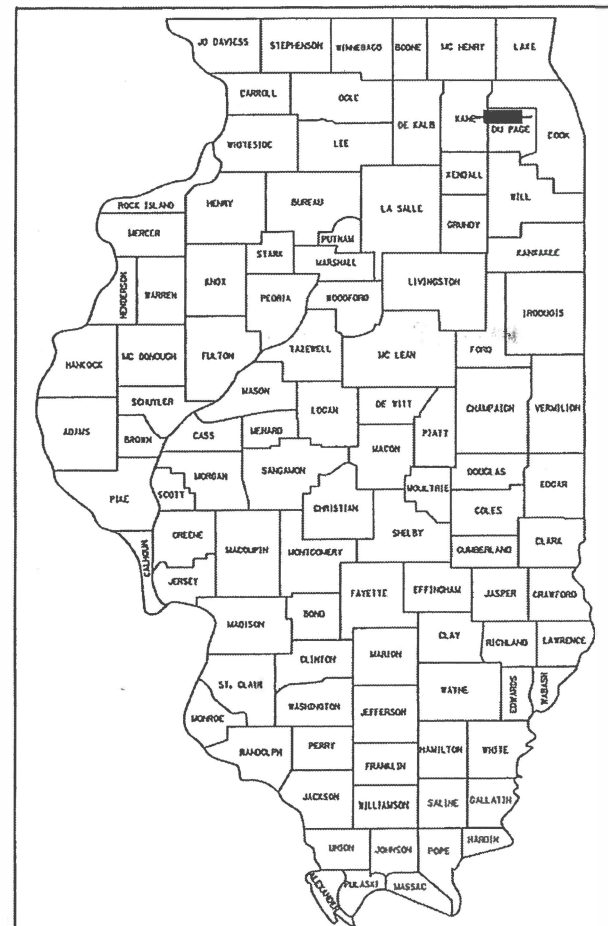

LOCATION OF SECTION INDICATED THUS: - [Symbol]

PROGRAM AND OFFICE ENGINEER: CHARLES F. RIDDLE, P.E., SCHAMBERG, IL

PROFESSIONAL ENGINEER'S SIGN & SEAL
EXCLUDING SHEET(S):

[Signature]
JACK R. MELHUISH, P.E.
EXPIRES: 11-30-19

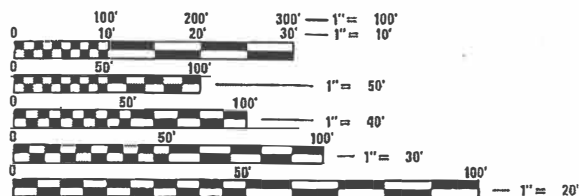

FULL SIZE PLANS HAVE BEEN PREPARED USING STANDARD ENGINEERING SCALES. REDUCED SIZED PLANS WILL NOT CONFORM TO STANDARD SCALES. IN MAKING MEASUREMENTS ON REDUCED PLANS, THE ABOVE SCALES MAY BE USED.

J.U.L.I.E.
JOINT UTILITY LOCATION INFORMATION FOR EXCAVATION
1-800-892-0123
OR 811

PROJECT ENGINEER J. HORWITZ
PROJECT MANAGER J. MELHUISH

CONTRACT NO. 61E39

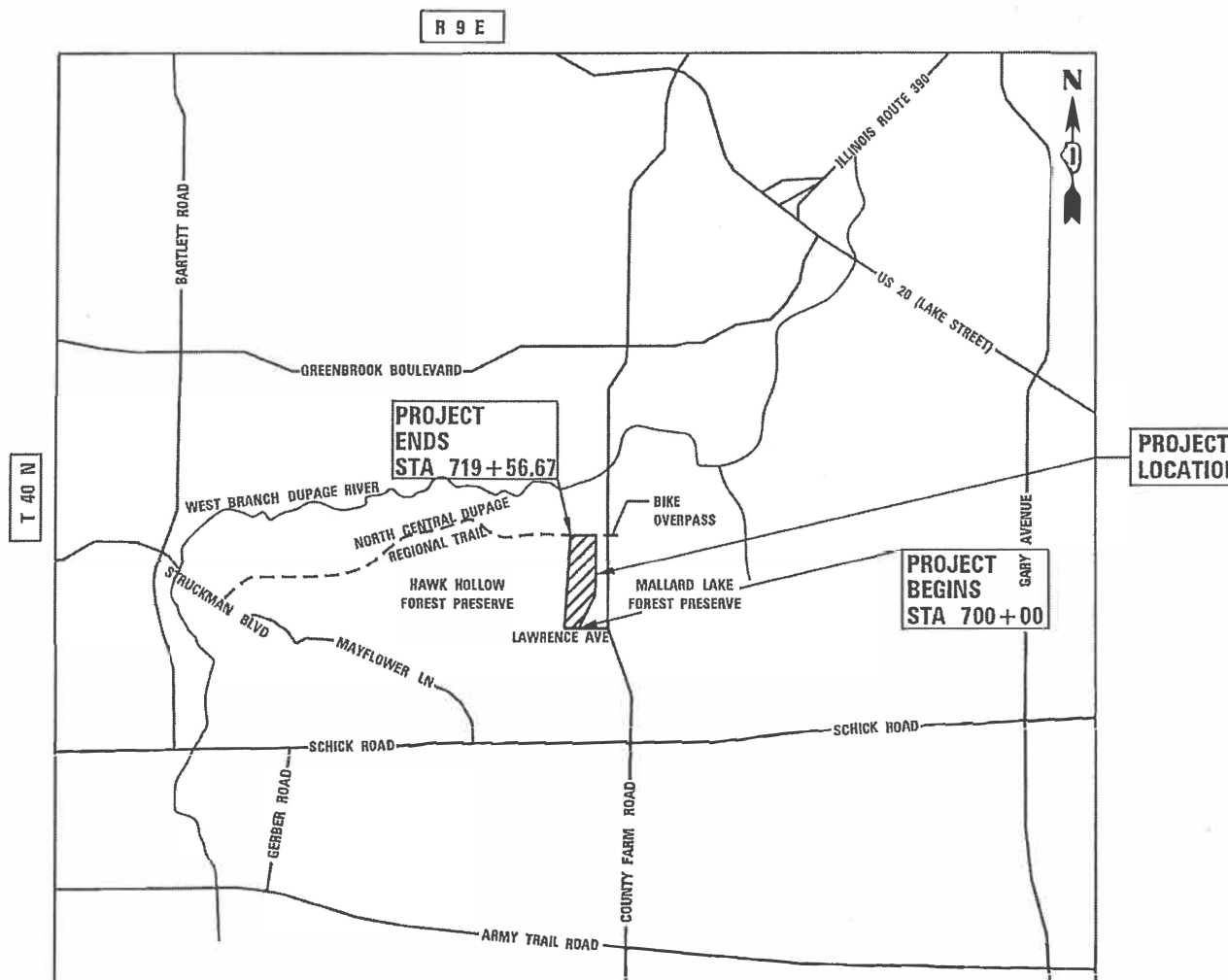

GROSS LENGTH = 1,957 FT. = 0.37 MILE
NET LENGTH = 1,957 FT. = 0.37 MILE

3 PM

STATE OF ILLINOIS
DEPARTMENT OF TRANSPORTATION

APPROVED *May 3 2018*

VILLAGE OF HANOVER PARK

PASSED *May 8 2018*

[Signature]
DISTRICT ONE ENGINEER OF LOCAL ROADS AND STREETS

RELEASING FOR BID
BASED ON LIMITED REVIEW

May 8 2018
[Signature]
REGIONAL ENGINEER



HRGreen

420 NORTH FRONT STREET, SUITE 100 | McHENRY, ILLINOIS 60050
Phone: 815.385.1778 | Toll Free: 800.728.7805 | Fax: 815.385.1781 | HRGreen.com
ILLINOIS PROFESSIONAL DESIGN FIRM #184-001322

PRINTED BY THE AUTHORITY
OF THE STATE OF ILLINOIS

INDEX OF SHEETS

1	COVER SHEET
2	INDEX OF SHEETS AND LIST OF HIGHWAY STANDARDS
3	GENERAL NOTES
4	SUMMARY OF QUANTITIES
5	TYPICAL SECTIONS
6	ALIGNMENT, TIES AND BENCHMARKS
7	REMOVAL PLAN
8 - 9	PLAN AND PROFILE
10	TC-22 ARTERIAL ROAD INFORMATION SIGN

STATE STANDARDS

STANDARD NO.	LIST OF DESCRIPTION
000001-06	STANDARD SYMBOLS, ABBREVIATIONS AND PATTERNS
280001-07	TEMPORARY EROSION CONTROL SYSTEMS
424001-10	PERPENDICULAR CURB RAMPS FOR SIDEWALKS
542401-03	METAL FLARED END SECTION FOR PIPE CULVERT
701001-02	OFF-RD OPERATIONS, 2L, 2W, MORE THAN 15' AWAY
701006-05	OFF-RD OPERATIONS, 2L, 2W, 15' TO 24" FROM PAVEMENT EDGE
701801-06	SIDEWALK, CORNER OR CROSSWALK CLOSURE
701901-07	TRAFFIC CONTROL DEVICES

PLAN	SURVEYED	BY	DATE
NOTE BOOK NO.	PLOTTED		
	GRADES CHECKED		
	STRUCTURE NOTATIONS CHECKED		
	CADD FILE NAME		

PROFILE	SURVEYED	BY	DATE
NOTE BOOK NO.	PLOTTED		
	GRADES CHECKED		
	STRUCTURE NOTATIONS CHECKED		

HRG PROJECT NO.: 8660203
 HRG PROJ CONTACT: 8660203-shr-gen-01.dgn
 PLOT DRIVER: pldrvr.ctb
 PEN TABLE: pnttbl.tbl



USER NAME = jmelhui	DESIGNED - JH	REVISED -
	DRAWN - DMS	REVISED -
PLOT SCALE = N.T.S.	CHECKED -	REVISED -
PLOT DATE = 6/18/2018	DATE - 6/18/18	REVISED -

**STATE OF ILLINOIS
DEPARTMENT OF TRANSPORTATION**

INDEX OF SHEETS AND STATE STANDARDS	
HAWK HOLLOW TRAIL	
SCALE: N.T.S.	SHEET NO. 1 OF 2 SHEETS STA. TO STA.

F.A.U. RTE.	SECTION NO.	COUNTY	TOTAL SHEETS	SHEET NO.
	15-00063-00-BT		10	2
CONTRACT NO. 61E39			FED. ROAD DIST. NO. ILLINOIS FED. AID PROJECT	

GENERAL NOTES

- ALL REFERENCES TO "STANDARD SPECIFICATIONS" IN THESE GENERAL NOTES SHALL BE INTERPRETED TO MEAN THE "STANDARD SPECIFICATIONS FOR ROAD AND BRIDGE CONSTRUCTION" ADOPTED BY THE ILLINOIS DEPARTMENT OF TRANSPORTATION, APRIL 1, 2016. ALL WORK TO BE COMPLETED IN ACCORDANCE WITH THE STANDARD SPECIFICATIONS.
- ALL REFERENCES TO "ENGINEER" SHALL BE INTERPRETED TO MEAN THE RESIDENT ENGINEER.
- PRIOR TO COMMENCEMENT OF CONSTRUCTION, THE CONTRACTOR SHALL VERIFY ALL DIMENSIONS AND CONDITIONS AFFECTING THEIR WORK WITH THE ACTUAL CONDITIONS AT THE JOB SITE. IF THERE ARE ANY DISCREPANCIES FROM WHAT IS SHOWN ON THE CONSTRUCTION PLANS, HE MUST IMMEDIATELY REPORT THEM TO THE ENGINEER BEFORE DOING ANY WORK, OTHERWISE THE CONTRACTOR ASSUMES FULL RESPONSIBILITY. IN THE EVENT OF DISAGREEMENT BETWEEN THE CONSTRUCTION PLANS, STANDARD SPECIFICATIONS AND/OR SPECIAL DETAILS, THE CONTRACTOR SHALL SECURE WRITTEN INSTRUCTIONS FROM THE ENGINEER PRIOR TO PROCEEDING WITH ANY PART OF THE WORK AFFECTED BY OMISSIONS OR DISCREPANCIES. FAILING TO SECURE SUCH INSTRUCTIONS, THE CONTRACTOR WILL BE CONSIDERED TO HAVE PROCEEDED AT HIS OWN RISK. IN THE EVENT OF ANY DOUBT OR QUESTION ARISING WITH RESPECT TO THE TRUE MEANING OF THE CONSTRUCTION PLANS OR SPECIFICATIONS, THE DECISION OF THE ENGINEER SHALL BE FINAL AND CONCLUSIVE.
- IT IS THE CONTRACTOR'S RESPONSIBILITY TO ASCERTAIN EXISTING FIELD CONDITIONS PRIOR TO BIDDING ON THE PROJECT.
- BEFORE STARTING ANY EXCAVATION, THE CONTRACTOR SHALL CALL "JULIE" (JOINT UTILITY LOCATION INFORMATION FOR EXCAVATION) AT 8-1-1 FOR FIELD LOCATIONS OF BURIED UTILITIES (48 HOURS NOTIFICATION IS REQUIRED). THE CONTRACTOR SHALL CONTACT THE FOREST PRESERVE DIRECTLY.
- ALL ELEVATIONS SHOWN ON THE PLANS ARE ON THE NAVD88 DATUM.
- ABANDONED UNDERGROUND UTILITIES THAT CONFLICT WITH CONSTRUCTION SHALL BE DISPOSED OF OUTSIDE THE LIMITS OF THE RIGHT OF WAY ACCORDING TO ARTICLE 202.03 OF THE STANDARD SPECIFICATIONS AND AS DIRECTED BY THE ENGINEER.
- THE ELEVATIONS SHOWN ON THE PLANS ARE FINISHED GRADES OF PROPOSED PATH, UNLESS OTHERWISE NOTED.
- THE CONTRACTOR WILL NOT BE ALLOWED TO SET UP A YARD OR FIELD OFFICE ON VILLAGE OR FOREST PRESERVE PROPERTY WITHOUT WRITTEN CONSENT FROM THE VILLAGE OR FOREST PRESERVE.
- THE CONTRACTOR SHALL PLACE BARRICADES AND PATH CLOSED SIGNS AT BOTH ENDS OF THE EXISTING TRAIL FOR THE DURATION OF THE PROJECT.

STORM SEWERS, WATER MAINS, AND UTILITIES

- THE CONTRACTOR SHALL BE RESPONSIBLE FOR CONTACTING THE OWNERS OF ALL UTILITIES PRIOR TO CONSTRUCTION TO DETERMINE THE LOCATION OF ALL UTILITY EQUIPMENT. THE CONTRACTOR SHALL COOPERATE WITH ALL UTILITY OWNERS IN ACCORDANCE WITH THE STANDARD SPECIFICATIONS IF UTILITY RELOCATION, ADJUSTMENT, OR PROTECTION IS NECESSARY.
- THE LOCATION OF EXISTING DRAINAGE STRUCTURES, STORM SEWERS, WATER MAINS, SANITARY SEWERS, AND ANY OTHER PUBLIC OR PRIVATE UTILITIES AS SHOWN ON THE PLANS IS APPROXIMATE AND THEIR EXACT LOCATION IS TO BE DETERMINED IN THE FIELD BY THE CONTRACTOR.
- THE CONTRACTOR SHALL BE RESPONSIBLE FOR THE PROTECTION OF ALL UNDERGROUND AND SURFACE UTILITIES EVEN THOUGH THEY MIGHT NOT BE SHOWN ON THE PLANS. ANY UTILITY PROPERTY DAMAGED DURING CONSTRUCTION SHALL BE REPAIRED OR REPLACED TO THE SATISFACTION OF THE OWNER.
- THE CONTRACTOR SHALL COOPERATE WITH THE VILLAGE AND FOREST PRESERVE IF ANY UTILITY IMPROVEMENTS ARE REQUIRED BY THE VILLAGE OR FOREST PRESERVE WITHIN THE DURATION OF THE CONTRACT.
- WHERE NEW WORK MEETS EXISTING FEATURES TO REMAIN, FIELD CHECK ALL DIMENSIONS AND ELEVATIONS BEFORE PROCEEDING WITH CONSTRUCTION, NOTIFY ENGINEER IMMEDIATELY OF ANY DISCREPANCIES.
- ANY LOOSE MATERIAL DEPOSITED IN THE FLOW LINE OF DRAINAGE STRUCTURES, WHICH OBSTRUCTS THE NATURAL FLOW OF WATER, SHALL BE REMOVED AT THE CLOSE OF EACH WORKING DAY. PRIOR TO ACCEPTANCE OF THE IMPROVEMENT, ALL DRAINAGE STRUCTURES SHALL BE FREE OF DIRT AND DEBRIS.
- WHEN EXISTING DRAINAGE FACILITIES ARE DISTURBED, THE CONTRACTOR SHALL PROVIDE AND MAINTAIN, IN AN OPERATING CONDITION, TEMPORARY OUTLETS AND CONNECTIONS FOR ALL DRAINS, SEWERS, AND CATCH BASINS. THE CONTRACTOR SHALL PROVIDE FACILITIES WHICH HAVE THE CAPACITY TO RECEIVE AND DISCHARGE THE STORM WATER FLOW RATES NORMALLY ACCEPTED AND RELEASED BY THE EXISTING DRAINAGE FACILITIES.
- THE INDISCRIMINATE USE OF FIRE HYDRANTS, EXISTING STREAMS, CREEKS, WETLANDS, OR PONDS IS STRICTLY PROHIBITED. THE CONTRACTOR SHALL PROVIDE A WATER TRUCK AND DRIVER AS REQUIRED TO OBTAIN AND TRANSPORT THIS WATER. THE CONTRACTOR SHALL BE RESPONSIBLE FOR OBTAINING WATER FROM AN APPROVED SOURCE. IF THIS WATER IS FROM A SOURCE OTHER THAN HIS YARD, WRITTEN APPROVAL FROM THE AGENCY HAVING JURISDICTION FOR THE SOURCE OF THE WATER MUST BE RECEIVED BY THE CONTRACTOR PRIOR TO THE USE OF THE WATER.
- THE APPLICATION OF NITROGEN FERTILIZER SHOULD BE 10 POUNDS PER 1000 SQ. FT.

SIGNING

- SIGNS SHALL NOT BE MOVED OR COVERED UNTIL PROGRESS OF WORK NECESSITATES IT.
- ANY SIGNS THAT ARE GOING TO BE DISTURBED DURING CONSTRUCTION MUST BE APPROPRIATELY STORED AND PROTECTED OR RETURNED TO THE OWNERS OF THE SIGN FOR STORAGE. THE SIGNS WILL BE RE-ERECTED UPON COMPLETION.

GENERAL NOTES (CONT.)

- THE CONTRACTOR WILL BE REQUIRED TO TEMPORARILY RESET ALL SUCH SIGNS THAT INTERFERE WITH THE CONSTRUCTION OPERATIONS. ALL SUCH SIGNS MUST BE MAINTAINED STRAIGHT AND CLEAN FOR THE DURATION OF THE TEMPORARY SETTING AND MUST BE RE-ERECTED AT A TEMPORARY LOCATION IN A WORKMANLIKE MANNER AND BE VISIBLE TO THE TRAFFIC FOR WHICH IT IS INTENDED.

EARTHWORK

- PRIOR TO ANY EMBANKMENT PLACEMENT, ALL VEGETATION AND UNSTABLE MATERIAL SHOULD BE REMOVED TO DEPTH ENCOUNTERED AND REPLACED WITH SUITABLE EMBANKMENT MATERIAL AS APPROVED BY THE ENGINEER.

SEDIMENTATION AND EROSION CONTROL

- SOIL DISTURBANCE SHALL BE CONDUCTED IN SUCH A MANNER AS TO MINIMIZE EROSION. SOIL STABILIZATION MEASURES SHALL CONSIDER THE TIME OF YEAR, SITE CONDITIONS, AND THE USE OF TEMPORARY AND PERMANENT MEASURES.
- SOIL EROSION AND SEDIMENT CONTROL FEATURES SHALL BE CONSTRUCTED PRIOR TO THE COMMENCEMENT OF HYDROLOGIC DISTURBANCE OF UPLAND AREAS.
- TEMPORARY EROSION CONTROL SEEDING AND EROSION CONTROL BLANKET SHALL BE APPLIED ON ALL DISTURBED AREAS IN ACCORDANCE WITH SECTIONS 250 AND 251 OF THE STANDARD SPECIFICATIONS. SEEDING SHALL NOT BE PERMITTED AT ANY TIME WHEN THE GROUND IS FROZEN, WET, OR IN AN UNTILLABLE CONDITION. LOCATIONS TO BE SEEDED SHALL BE DETERMINED BY THE ENGINEER.
- DISTURBED AREAS SHALL BE STABILIZED WITH TEMPORARY OR PERMANENT MEASURES WITHIN 14 CALENDAR DAYS OF THE END OF THE ACTIVE HYDROLOGIC DISTURBANCE, OR REDISTURBANCE IN ACCORDANCE WITH SECTIONS 250 AND 280 OF THE STANDARD SPECIFICATIONS.
- ALL TEMPORARY EROSION CONTROL MEASURES SHALL BE REMOVED WITHIN 30 DAYS AFTER FINAL SITE STABILIZATION IS ACHIEVED OR AFTER THE TEMPORARY MEASURES ARE NO LONGER NEEDED AS DIRECTED BY THE ENGINEER.
- ANY SEDIMENT OR SOIL REACHING AN IMPROVED PUBLIC RIGHT-OF-WAY, STREET, ALLEY, OR PARKING AREA SHALL BE REMOVED BY SCRAPING OR STREET CLEANING AS ACCUMULATIONS WARRANT OR AS DIRECTED BY THE ENGINEER AND TRANSPORTED TO A CONTROLLED SEDIMENT DISPOSAL AREA.
- SOIL STOCKPILES SHALL NOT BE LOCATED IN A FLOOD-PRONE AREA OR A DESIGNATED BUFFER PROTECTING WATERS OF THE UNITED STATES. IF DE-WATERING SERVICES ARE USED, ADJOINING PROPERTIES AND DISCHARGE LOCATIONS SHALL BE PROTECTED FROM EROSION. DISCHARGES SHALL BE ROUTED THROUGH AN EFFECTIVE SEDIMENT CONTROL MEASURE (SEDIMENT TRAP, SEDIMENT BASIN, OR OTHER APPROPRIATE MEASURE).
- THE EROSION CONTROL MEASURES INDICATED IN THE PLANS ARE THE MINIMUM REQUIREMENTS. ADDITIONAL MEASURES MAY BE REQUIRED, AS DIRECTED BY THE ENGINEER OR GOVERNING AGENCY.

PLAN	SURVEYED	DATE
NOTE BOOK NO.	PLOTTED	
	ALIGNMENT	
	CHECKED	
	FILE NAME	
	FILE NO.	

PROFILE	SURVEYED	DATE
NOTE BOOK NO.	GRADES CHECKED	
	STRUCTURE	
	NOTATION	
	STATUS	

HRG PROJECT NO.: 8660203
 HRG PROJ. CONTACT: 8660203-sht-gen-02.dgn
 FILE NAME: 8660203-sht-gen-02.dgn
 PEN TABLE: 8660203-sht-gen-02.dgn



USER NAME = jmelhu	DESIGNED - JH	REVISED -
	DRAWN - DMS	REVISED -
PLOT SCALE = N.T.S.	CHECKED -	REVISED -
PLOT DATE = 6/1/2018	DATE - 6/1/18	REVISED -

**STATE OF ILLINOIS
DEPARTMENT OF TRANSPORTATION**

GENERAL NOTES		F.A.U. RTE.	SECTION NO.	COUNTY	TOTAL SHEETS	SHEET NO.
HAWK HOLLOW TRAIL			15-00063-00-BT		10	3
SCALE: N.T.S.		SHEET NO. 2 OF 2 SHEETS		STA.	TO STA.	
		FED. ROAD DIST. NO.		ILLINOIS FED. AID PROJECT		

CONTRACT NO. 6IE39

DATE	
BY	
PLAN	
NO. _____	
NOTE BOOK	
NO. _____	
PLAN	
NO. _____	
NOTE BOOK	
NO. _____	
PLAN	
NO. _____	
NOTE BOOK	
NO. _____	
PLAN	
NO. _____	
NOTE BOOK	
NO. _____	

DATE	
BY	
PROFILE	
NO. _____	
NOTE BOOK	
NO. _____	
PROFILE	
NO. _____	
NOTE BOOK	
NO. _____	
PROFILE	
NO. _____	
NOTE BOOK	
NO. _____	

HRG PROJECT NO.: 8660203
 HRG PROJ. CONTACT: 8660203-shr-tyo.dgn
 PLOT DRIVER: 8660203-shr-tyo.dgn
 PEN TABLE: pchtable.tbl

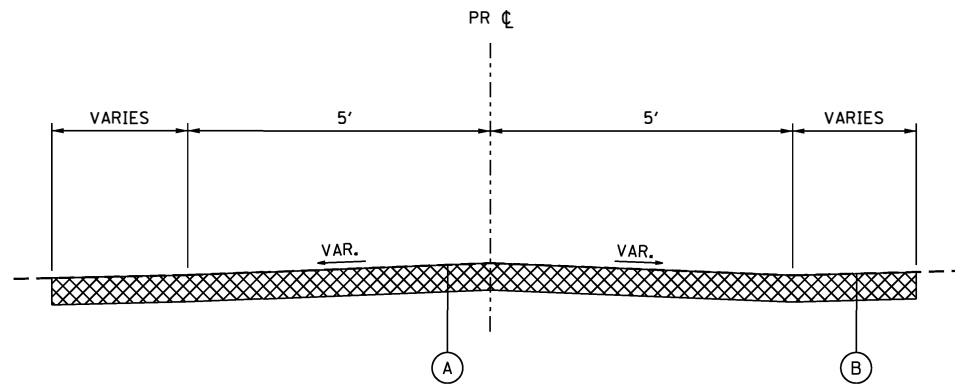

EXISTING TYPICAL SECTION
 HAWK HOLLOW TRAIL
 STA 700+00.00 TO STA 719+56.67

EXISTING TYPICAL SECTION

- (A) EXISTING GRASS PATH
- (B) EXISTING GROUND
- TOPSOIL STRIPPING 4" (PAID FOR AS REMOVAL AND DISPOSAL OF UNSUITABLE MATERIAL AND TOPSOIL EXCAVATION & PLACEMENT)

PROPOSED TYPICAL SECTION

- ① AGGREGATE SURFACE COURSE, TYPE B 2" (FA-5)
- ② AGGREGATE BASE COURSE, TYPE B 6" (CA-6)
- ③ TRIAXIAL GEOGRID REINFORCEMENT, TYPE I
- ④ COMPACTED SUBGRADE
- ⑤ SEEDING, CLASS 1B
- ⑥ TOPSOIL EXCAVATION & PLACEMENT, NATIVE SEED MIX

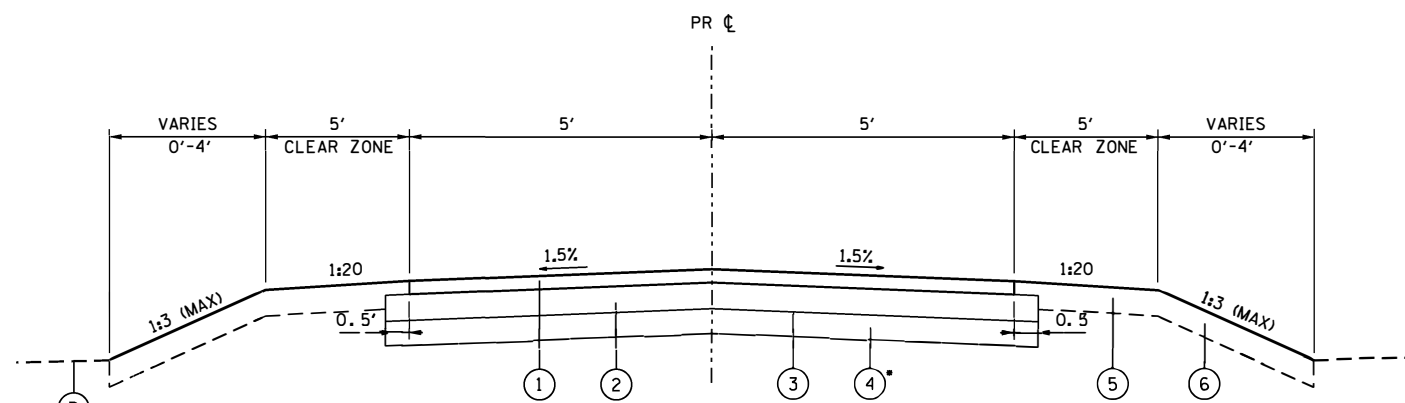

PROPOSED TYPICAL SECTION
 HAWK HOLLOW TRAIL
 STA 700+00.00 TO STA 719+56.67
 • TO BE DETERMINED BY FIELD ENGINEER



USER NAME = jmelhui	DESIGNED - JH	REVISED -
	DRAWN - DMS	REVISED -
PLOT SCALE = N.T.S.	CHECKED -	REVISED -
PLOT DATE = 6/1/2018	DATE - 6/1/18	REVISED -

**STATE OF ILLINOIS
 DEPARTMENT OF TRANSPORTATION**

TYPICAL SECTIONS	
HAWK HOLLOW TRAIL	
SCALE: N.T.S.	SHEET NO. 1 OF 1 SHEETS
STA.	TO STA.

F.A.U. RTE.	SECTION NO.	COUNTY	TOTAL SHEETS	SHEET NO.
	15-00063-00-BT		10	5
FED. ROAD DIST. NO.			ILLINOIS FED. AID PROJECT	
			CONTRACT NO. 61E39	



PROJECT BEGINS
STA 700+00.00

PROJECT ENDS
STA 719+56.67

PLAN	SURVEYED	DATE
NOTE BOOK	PLOTTED	BY
NO.	GRADES CHECKED	
	STRUCTURE NOTATIONS CHECKED	
	CADD FILE NAME	

PROFILE	SURVEYED	DATE
NOTE BOOK	PLOTTED	BY
NO.	GRADES CHECKED	
	STRUCTURE NOTATIONS CHECKED	
	CADD FILE NAME	

PROP. CURVE PRPATH-1	PROP. CURVE PRPATH-2	PROP. CURVE PRPATH-3	PROP. CURVE PRPATH-4	PROP. CURVE PRPATH-5	PROP. CURVE PRPATH-6	PROP. CURVE PRPATH-7	PROP. CURVE PRPATH-8
$\Delta = 34^\circ 16' 10"$ (RT)	$\Delta = 29^\circ 22' 39"$ (RT)	$\Delta = 30^\circ 12' 27"$ (LT)	$\Delta = 58^\circ 58' 47"$ (LT)	$\Delta = 47^\circ 21' 57"$ (RT)	$\Delta = 38^\circ 14' 05"$ (LT)	$\Delta = 61^\circ 02' 01"$ (LT)	$\Delta = 96^\circ 40' 54"$ (RT)
D = 81' 51' 04"	D = 30' 09' 20"	D = 27' 17' 01"	D = 38' 11' 50"	D = 62' 16' 41"	D = 38' 11' 50"	D = 163' 42' 08"	D = 67' 24' 24"
R = 70.00'	R = 190.00'	R = 210.00'	R = 150.00'	R = 92.00'	R = 150.00'	R = 35.00'	R = 85.00'
T = 21.58'	T = 49.81'	T = 56.68'	T = 84.83'	T = 40.35'	T = 124.89'	T = 20.63'	T = 95.54'
L = 41.87'	L = 97.42'	L = 110.72'	L = 154.41'	L = 76.06'	L = 100.10'	L = 37.28'	L = 143.43'
E = 3.25'	E = 6.42'	E = 7.51'	E = 22.33'	E = 8.46'	E = 8.76'	E = 5.63'	E = 42.88'
P.C. STA. = 701+52.14	P.C. STA. = 702+58.84	P.C. STA. = 704+88.43	P.C. STA. = 708+13.44	P.C. STA. = 710+82.52	P.C. STA. = 712+99.16	P.C. STA. = 715+13.18	P.C. STA. = 717+99.38
N: 1927873.72	N: 1927968.88	N: 1928087.41	N: 1928306.88	N: 1928559.24	N: 1928750.55	N: 1928958.87	N: 1929095.65
E: 1032799.65	E: 1032843.91	E: 1033034.67	E: 1033268.00	E: 1033238.75	E: 1033317.48	E: 1033337.23	E: 1033092.78
PI STA. = 701+73.72	PI STA. = 703+08.64	PI STA. = 705+45.10	PI STA. = 708+98.27	PI STA. = 711+22.87	PI STA. = 713+51.15	PI STA. = 715+33.81	PI STA. = 718+94.92
N: 1927895.28	N: 1928011.31	N: 1928103.91	N: 1928375.88	N: 1928596.61	N: 1928793.24	N: 1928979.46	N: 1929112.84
E: 1032798.64	E: 1032870.00	E: 1033088.89	E: 1033317.36	E: 1033223.53	E: 1033347.16	E: 1033336.00	E: 1033013.47
P.T. STA. = 701+94.01	P.T. STA. = 703+56.26	P.T. STA. = 705+99.14	P.T. STA. = 709+67.85	P.T. STA. = 711+58.58	P.T. STA. = 713+99.25	P.T. STA. = 715+50.46	P.T. STA. = 719+42.81
N: 1927913.66	N: 1928035.48	N: 1928145.46	N: 1928453.73	N: 1928633.12	N: 1928845.14	N: 1928988.35	N: 1929217.66
E: 1032809.94	E: 1032913.55	E: 1033127.44	E: 1033283.66	E: 1033240.71	E: 1033344.05	E: 1033317.38	E: 1033057.51

BENCHMARKS

SOURCE BENCHMARK:
HANOVER PARK BM-7
DISK ON THE NORTHEAST CORNER OF COUNTY FARM ROAD
BRIDGE OVER WEST BRANCH OF DUPAGE RIVER.
ELEV: 771.33 (NAVD 88)

BM #7

HRG PROJECT NO.: 8660203
HRG PROJ. CONTACT: 8660203-shr-07b.dgn
PLC. DRIVER: pac/fab/bt/fcl
PEN. TABLE:



USER NAME = jme1hu1	DESIGNED - JH	REVISED -
	DRAWN - DMS	REVISED -
PLOT SCALE = N.T.S.	CHECKED -	REVISED -
PLOT DATE = 6/1/2018	DATE - 6/1/18	REVISED -

STATE OF ILLINOIS
DEPARTMENT OF TRANSPORTATION

ALIGNMENT, TIES & BENCHMARKS
HAWK HOLLOW TRAIL

SCALE: N.T.S. SHEET NO. 1 OF 1 SHEETS STA. TO STA.

F.A.U. RTE.	SECTION NO.	COUNTY	TOTAL SHEETS	SHEET NO.
	15-00063-00-BT	DUPAGE	10	6
CONTRACT NO. 61E39				
FED. ROAD DIST. NO. ILLINOIS FED. AID PROJECT				

REMOVAL
(TO BE PAID FOR AS REMOVAL & DISPOSAL
OF UNSUITABLE MATERIAL)

PLAN	SURVEYED	DATE
	PLOTTED	
	GRADES CHECKED	
	STRUCTURE NOTATIONS CHECKED	
	NOTE BOOK NO.	
	BY	
	DATE	

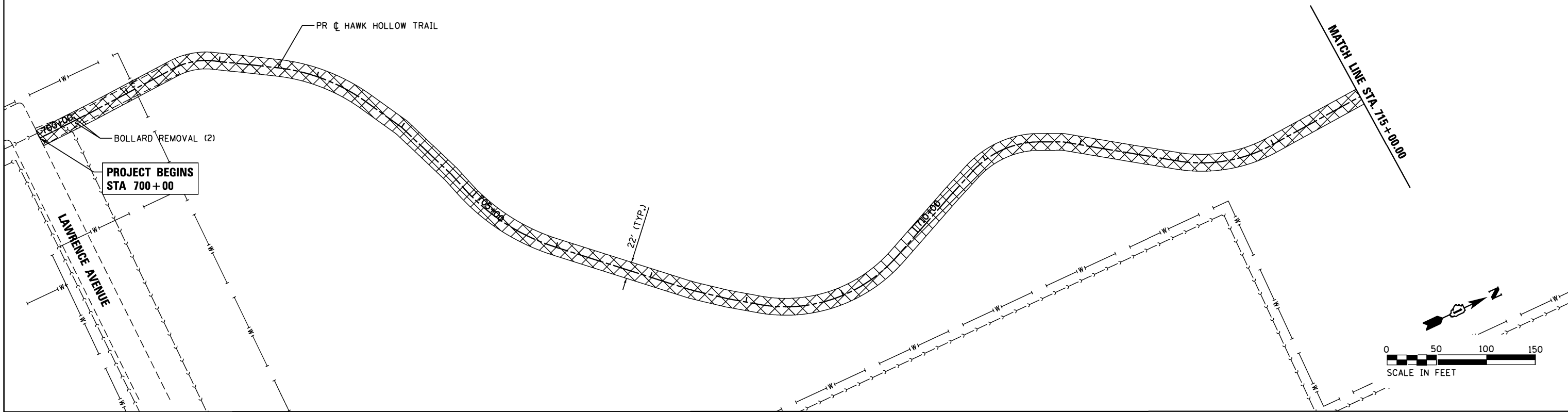

PROFILE	SURVEYED	DATE
	PLOTTED	
	GRADES CHECKED	
	STRUCTURE NOTATIONS CHECKED	
	NOTE BOOK NO.	
	BY	
	DATE	

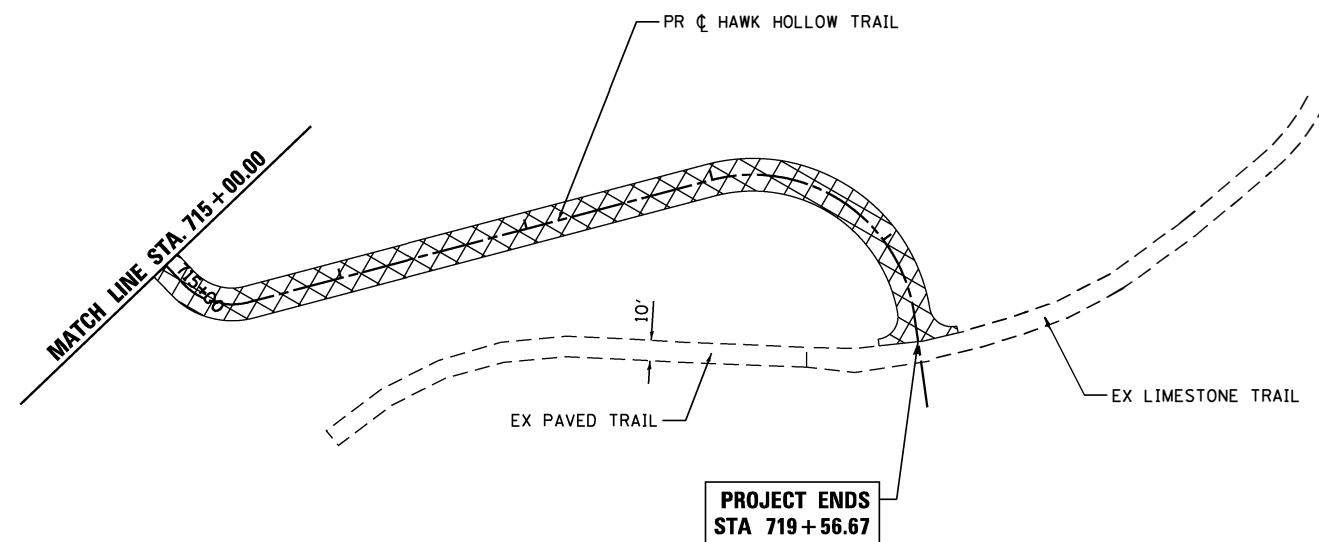

HRG PROJECT NO.: 8660203
 HRG PROJ. CONTACT: 8660203-shr+em.d.dgn
 PLOT DRIVER: hrhobart
 PEN TABLE: hrhobart.tbl



USER NAME = jmelhus	DESIGNED - JH	REVISED -
	DRAWN - DMS	REVISED -
PLOT SCALE = 1"=50'	CHECKED -	REVISED -
PLOT DATE = 6/1/2018	DATE - 6/1/18	REVISED -

STATE OF ILLINOIS
DEPARTMENT OF TRANSPORTATION

REMOVAL PLAN	
HAWK HOLLOW TRAIL	
SCALE: 1"=50'	SHEET NO. 1 OF 1 SHEETS
STA.	TO STA.

F.A.U. RTE.	SECTION NO.	COUNTY	TOTAL SHEETS	SHEET NO.
	15-00063-00-BT	DUPAGE	10	7
CONTRACT NO. 61E39				
FED. ROAD DIST. NO.	ILLINOIS	FED. AID PROJECT		

- NOTES:
- ALL WORK IS WITHIN FOREST PRESERVE DISTRICT OF DUPAGE COUNTY ROW
 - THE PATH HAS BEEN DESIGNED FOR A 20° LEAN AND A DESIGN SPEED OF 18 MPH

DATE	
BY	
PLAN	
NO.	
NO.	
NO.	
NO.	
NO.	

DATE	
BY	
PROFILE	
NO.	
NO.	
NO.	
NO.	
NO.	

HRG PROJECT NO.: 8660203
 HRG PROJ. CONTACT: 8660203-srt-p@hrgrf.du.edu
 FILE NAME: 15-00063-00-BT.dwg
 PEN TABLE: pen.tbl

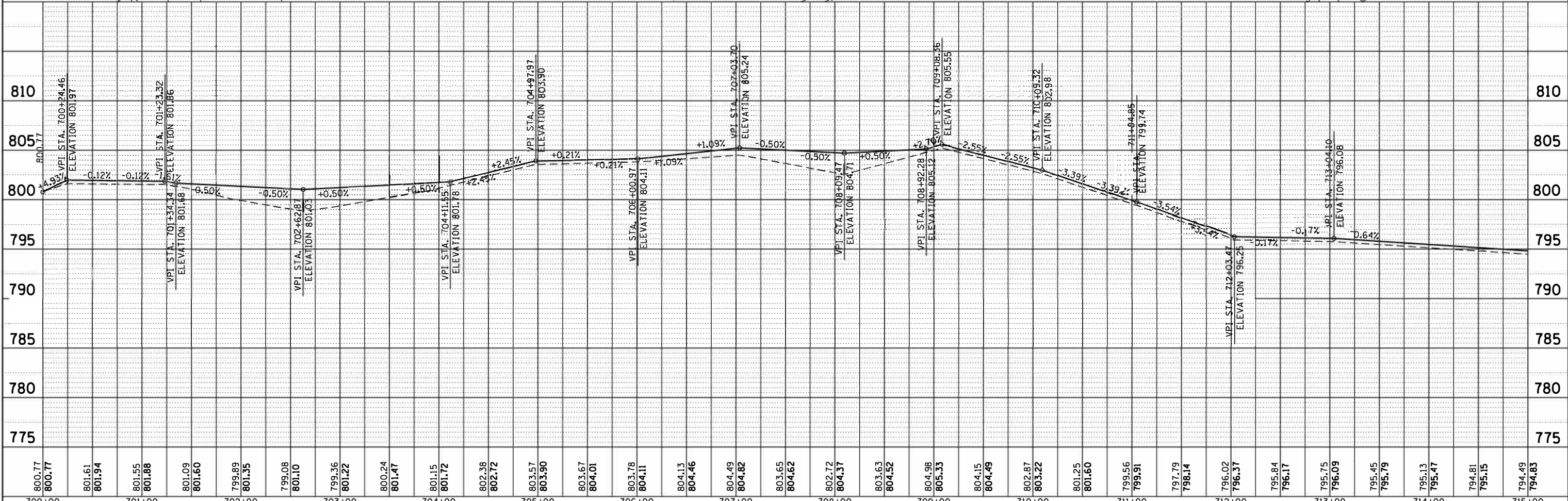
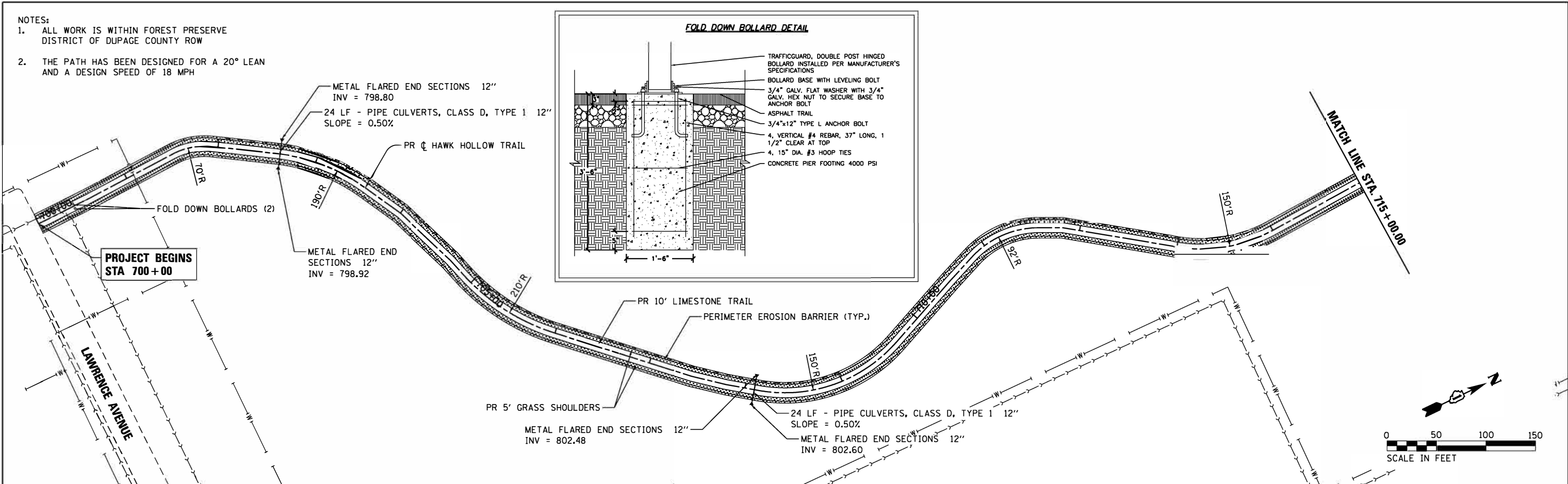

800.77	800.77	801.61	801.94	801.55	801.88	801.09	801.60	799.89	801.35	799.08	801.10	799.36	801.22	800.24	801.47	801.15	801.72	802.38	802.72	803.57	803.90	803.67	804.01	803.78	804.11	804.13	804.46	804.49	804.82	803.65	804.62	802.72	804.37	803.63	804.52	804.98	805.33	804.15	804.49	802.87	803.22	801.25	801.60	799.56	799.91	797.79	798.14	796.02	796.37	795.84	796.17	795.75	796.09	795.45	795.79	795.13	795.47	794.81	795.15	794.49	794.83
700+00	701+00	702+00	703+00	704+00	705+00	706+00	707+00	708+00	709+00	710+00	711+00	712+00	713+00	714+00	715+00																																														

HRGreen.com
 Illinois Professional Design Firm
 #184-001322

USER NAME = jmelhu	DESIGNED - JH	REVISED -
	DRAWN - DMS	REVISED -
PLOT SCALE = 1"=50'	CHECKED -	REVISED -
PLOT DATE = 6/1/2018	DATE - 6/1/18	REVISED -

STATE OF ILLINOIS
 DEPARTMENT OF TRANSPORTATION

PLAN & PROFILE
 HAWK HOLLOW TRAIL
 SCALE: 1"=50' SHEET NO. 1 OF 2 SHEETS STA. TO STA.

F.A.U. RTE.	SECTION NO.	COUNTY	TOTAL SHEETS
	15-00063-00-BT	DUPAGE	10 8
FED. ROAD DIST. NO.	ILLINOIS FED. AID PROJECT	CONTRACT NO. 61E39	

- NOTES:
- ALL WORK IS WITHIN FOREST PRESERVE
DISTRICT OF DUPAGE COUNTY ROW
 - THE PATH HAS BEEN DESIGNED FOR A 20° LEAN
AND A DESIGN SPEED OF 18 MPH

PLAN	SURVEYED	BY	DATE
	PLOTTED		
	GRADES CHECKED		
	NOTE BOOK		
	NO.		

PROFILE	SURVEYED	BY	DATE
	PLOTTED		
	GRADES CHECKED		
	NOTE BOOK		
	NO.		

HRG PROJECT NO.: 8666203
 HRG PROJ. CONTACT: 8666203-sht-p01pr-f_02.dgn
 FILE NAME: 15-00063-00-BT.dwg
 PEN TABLE: pen.tbl

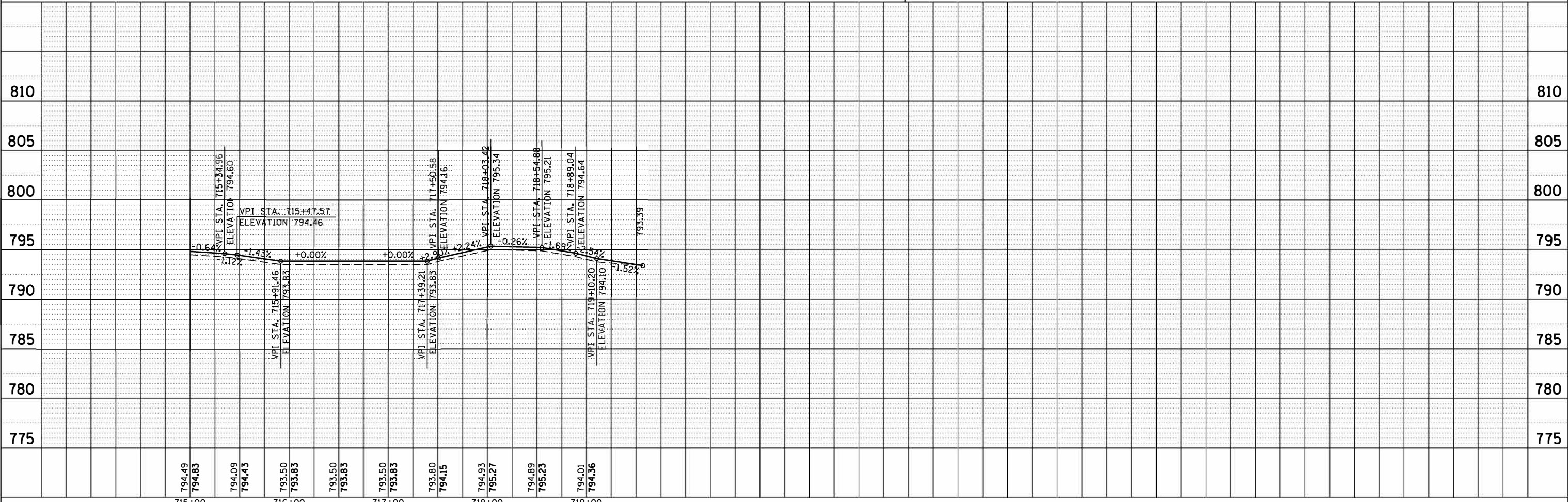
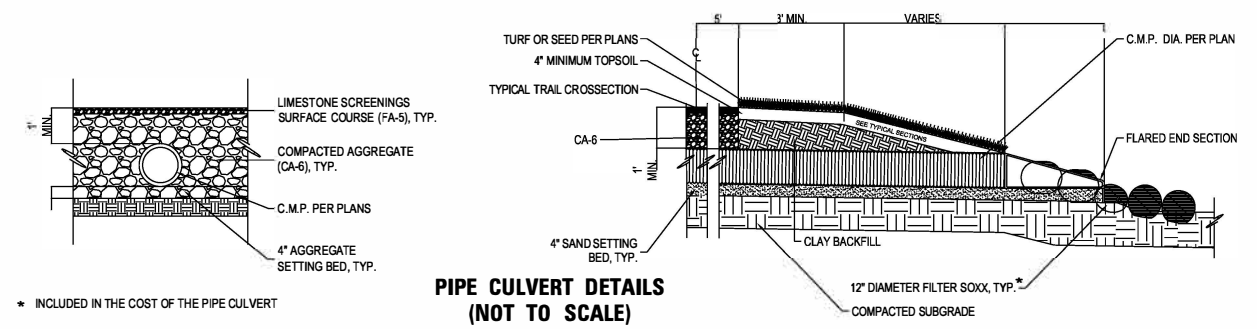
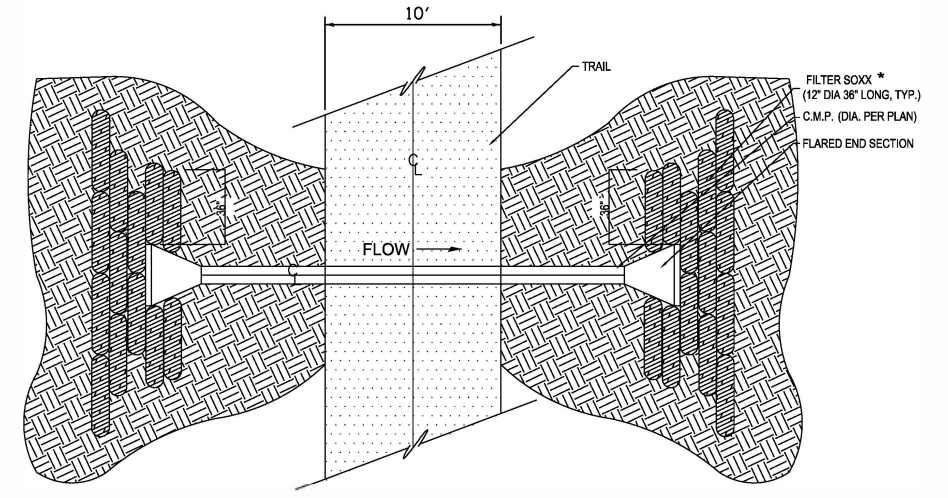
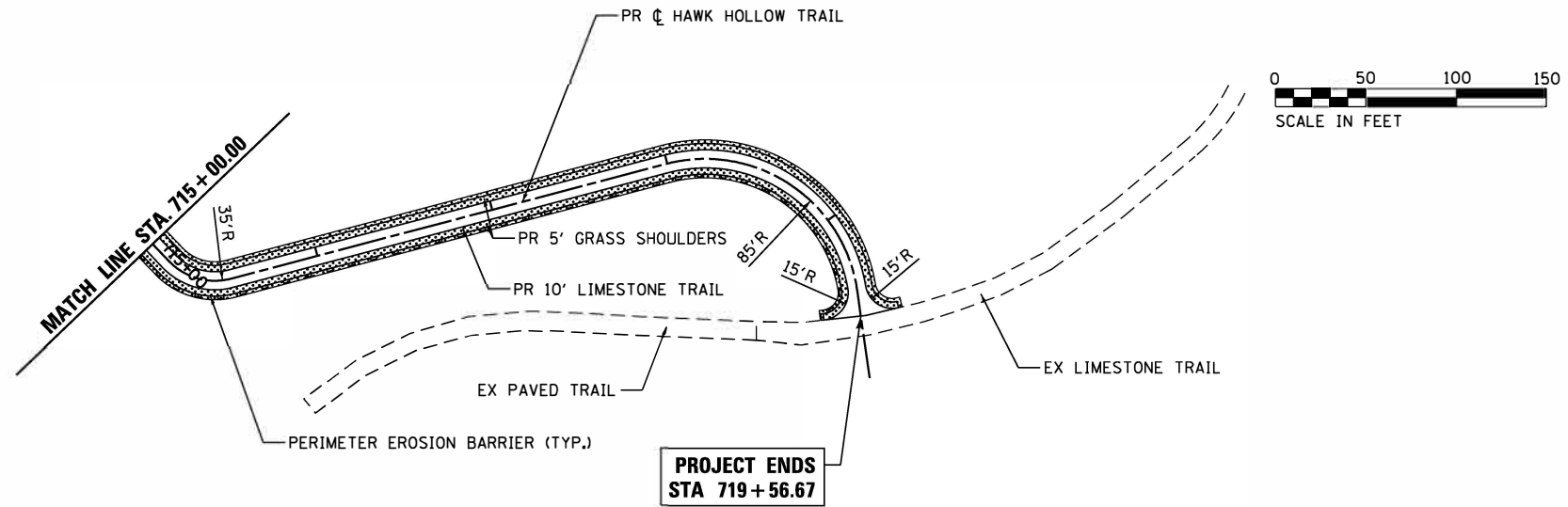

USER NAME = jmelhus	DESIGNED - JH	REVISED -
PLOT SCALE = 1"=50'	DRAWN - DMS	REVISED -
PLOT DATE = 6/1/2018	CHECKED -	REVISED -
	DATE - 6/1/18	REVISED -

STATE OF ILLINOIS
DEPARTMENT OF TRANSPORTATION

PLAN & PROFILE
HAWK HOLLOW TRAIL
SCALE: 1"=50' SHEET NO. 2 OF 2 SHEETS STA. TO STA.

F.A.U. RTE.	SECTION NO.	COUNTY	TOTAL SHEETS	SHEET NO.
	15-00063-00-BT	DUPAGE	10	9
CONTRACT NO. 61E39				
FED. ROAD DIST. NO. ILLINOIS FED. AID PROJECT				

COMPANY NAME: #COMPANY_NAME
 PROJECT CONTACT: #PROJECT_CONTACT#
 CLIENT: #CLIENT#
 DATE PLOTTED: 6/1/2018 2:50:42 PM
 FILE NAME: 66160203-sh1-detailed-TC22.dgn
 PLOT DRIVER: IL_per_bwp1c1c7g
 PEN TABLE: plottable.tbl

FILE NAME: \\dotatd\22\34\tc22.dgn	USER NAME: gagliarobt	DESIGNED: -	REVISED: - R. MIRS 09-15-97
		DRAWN: -	REVISED: - R. MIRS 12-11-97
		CHECKED: -	REVISED: - T. RAMMACHER 02-02-99
		DATE: -	REVISED: - C. JUCIUS 01-31-07

**STATE OF ILLINOIS
DEPARTMENT OF TRANSPORTATION**

**ARTERIAL ROAD
INFORMATION SIGN**

SCALE: NONE SHEET NO. 1 OF 1 SHEETS STA. TO STA.

F.A.U. RTE.	SECTION	COUNTY	TOTAL SHEETS	SHEET NO.
	15-00063-00-BT	DuPAGE	10	10
TC-22			CONTRACT NO. 61E39	
FED. ROAD DIST. NO. 1 ILLINOIS FED. AID PROJECT				

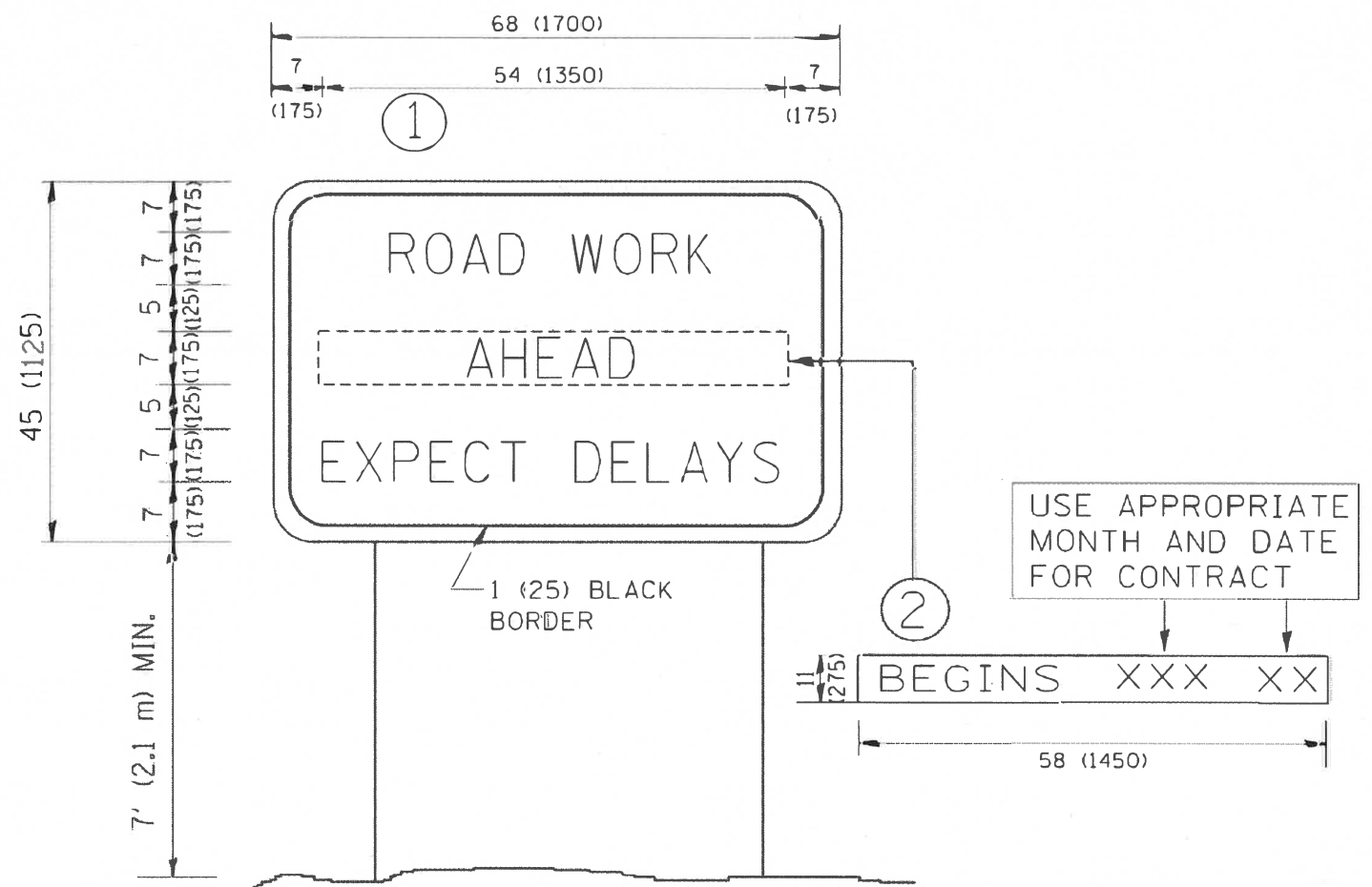

NOTES:

1. USE BLACK LETTERING ON ORANGE BACKGROUND.
2. ERECT SIGNS IN ADVANCE OF THE LOCATION FOR THE "ROAD CONSTRUCTION AHEAD" SIGN AT LOCATIONS AS DIRECTED BY THE ENGINEER.
3. ERECT SIGN ① WITH INSTALLED PANEL ② ONE WEEK PRIOR TO THE START OF CONSTRUCTION.
4. REMOVE PANEL ② SOON AFTER THE START OF CONSTRUCTION.
5. SEE SPECIAL PROVISION FOR "TEMPORARY INFORMATION SIGNING" FOR ADDITIONAL INFORMATION.
6. ONE SIGN ASSEMBLY EQUALS 25.70 SQ. FT. (2.3 SQ. M.)
7. SHALL BE PAID FOR AS TEMPORARY INFORMATION SIGNING.

ALL DIMENSIONS ARE IN INCHES (MILLIMETERS)
UNLESS OTHERWISE SHOWN.