

STATE OF ILLINOIS  
DEPARTMENT OF TRANSPORTATION

F.A.I. RTE.	SECTION	COUNTY	TOTAL SHEETS	SHEET NO.
39	2019-1 WEED SPRAY	LASALLE	7	1
		ILLINOIS	CONTRACT NO. 66J39	

# PROPOSED HIGHWAY PLANS

## F.A.I. ROUTE 39 (I-39) SECTION 2019-1 WEED SPRAY WEED CONTROL LASALLE COUNTY

**INDEX OF SHEETS**

1. COVER SHEET
2. GENERAL NOTES
3. SUMMARY OF QUANTITIES
- 4-6. SPRAY LOCATION MAPS
7. HERBICIDE RESTRICTION MAPS

**LIST OF ILLINOIS DOT HIGHWAY STANDARDS**

000001-06	STANDARD SYMBOLS, ABBREVIATIONS AND PATTERNS
701101-05	OFF-ROAD OPERATIONS, MULTILANE, 15' (4.5 m) TO 24" (600 mm) FROM PAVEMENT EDGE
701106-02	OFF-ROAD OPERATIONS, MULTILANE, MORE THAN 15' (4.5 m) AWAY
701426-09	LANE CLOSURE, MULTILANE INTERMITTENT OR MOVING OPERATION, FOR SPEEDS ≥ 45 MPH
701456-05	PARTIAL EXIT RAMP CLOSURE FREEWAY/EXPRESSWAY
701901-07	TRAFFIC CONTROL DEVICES

C-93-086-18

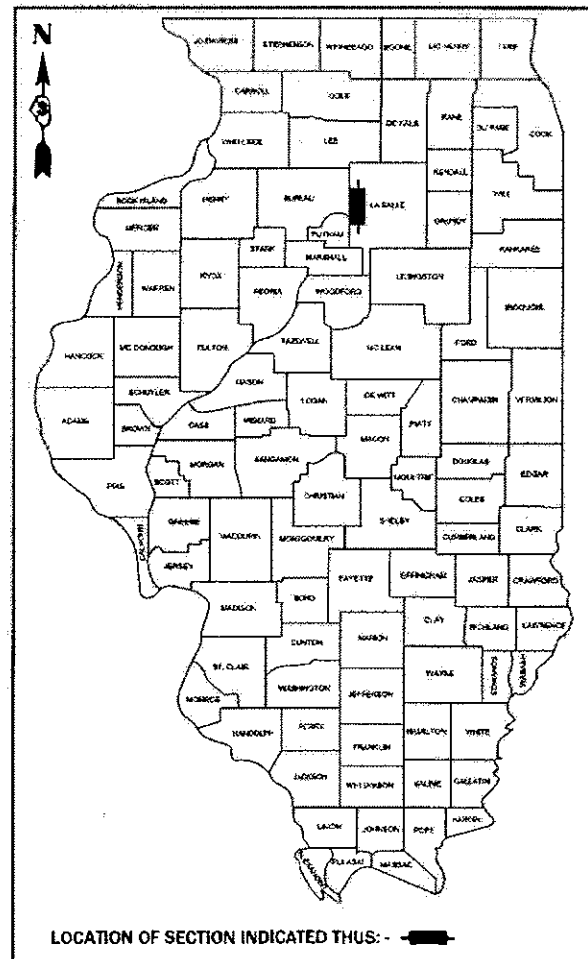

RURAL	
INTERSTATE	
FA39 (I-39)	
ADT YEAR = 2017	
ADT	22400
P.V.	63.2%
S.U.	4.7%
M.U.	32.1%

PROJECT ENDS  
LEE COUNTY LINE  
MP 76.8

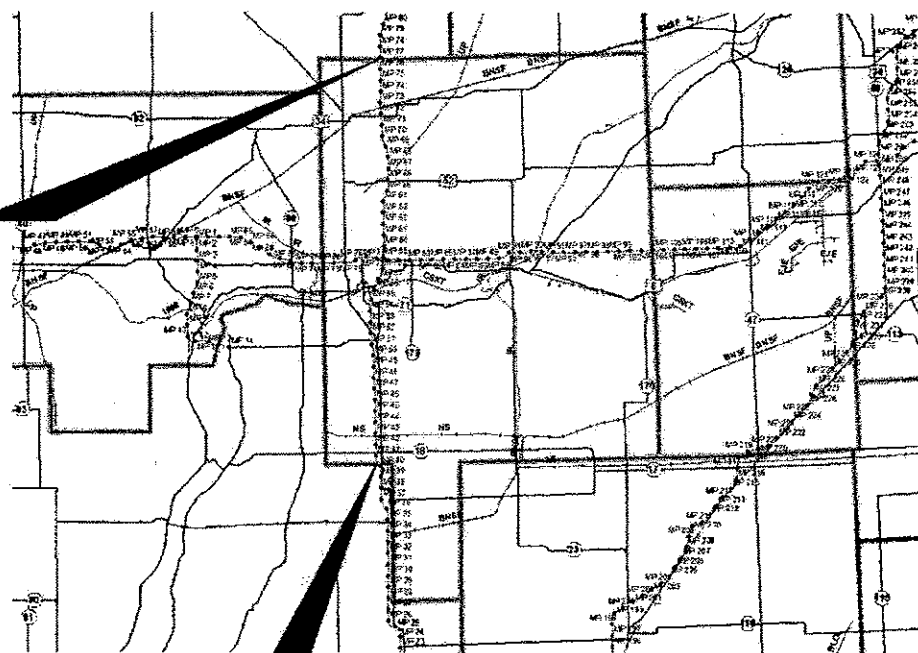

PROJECT BEGINS  
MARSHALL COUNTY LINE  
MP 40.3

GROSS LENGTH = 192,720.0 FT. = 36.5 MILES

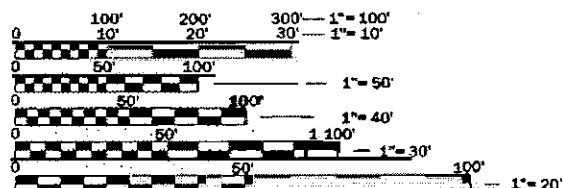

FULL SIZE PLANS HAVE BEEN PREPARED USING STANDARD ENGINEERING SCALES. REDUCED SIZED PLANS WILL NOT CONFORM TO STANDARD SCALES. IN MAKING MEASUREMENTS ON REDUCED PLANS, THE ABOVE SCALES MAY BE USED.

J.U.L.I.E.  
JOINT UTILITY LOCATION INFORMATION FOR EXCAVATION  
1-800-892-8123  
OR 811

PROJECT ENGINEER: BRAD DUNCAN, P.E.  
UNIT CHIEF: DARCY CARPENTER  
DISTRICT 3 NO. (815) 434-6131  
CONTRACT NO. 66J39

STATE OF ILLINOIS  
DEPARTMENT OF TRANSPORTATION

SUBMITTED *May 17 2018*  
*K. Mark*  
REGIONAL ENGINEER

*June 29 2018*  
*A. E. K.*  
ENGINEER OF DESIGN AND ENVIRONMENT

*June 29 2018*  
*Paul P. [Signature]*  
DIRECTOR OF HIGHWAYS PROJECT IMPLEMENTATION

PRINTED BY THE AUTHORITY  
OF THE STATE OF ILLINOIS

**GENERAL NOTES**

ANY REFERENCE TO A STANDARD IN THESE PLANS SHALL BE INTERPRETED TO MEAN THE EDITION AS INDICATED BY THE SUBNUMBER SHOWN IN THE LIST OF STANDARDS OR THE COPY INCLUDED IN THESE PLANS.

THE FOLLOWING RATES OF APPLICATION HAVE BEEN USED IN CALCULATING PLAN QUANTITIES:

HERBICIDE / INGREDIENTS		APPLICATION RATE	PAY ITEM
RODEO	1	QUART / ACRE (OR 32 OUNCES / ACRE)	AQUATIC WEED CONTROL, GLYPHOSATE
ARSENAL	6	PINTS / ACRE (OR 96 OUNCES / ACRE)	AQUATIC WEED CONTROL, IMAZAPYR
M50 CONCENTRATE WITH LECI-TECH	2	PINTS / ACRE (OR 32 OUNCES / ACRE)	N/A
WATER	30	GALLONS MINIMUM / ACRE	N/A

**COMMITMENTS:**

RESIDENT ENGINEER SHOULD ALSO CONTACT DAVE RENNELS, LASALLE COUNTY FIELD ENGINEER AT (815) 224-1800, AND GO OVER ALL SPRAY LOCATIONS WITH HIM BEFORE SPRAYING COMMENCES. SUBSEQUENT SPRAYINGS WILL BE CONDUCTED BY THE YARD ITSELF. SO IT WILL BE USEFUL FOR THE YARD TO KNOW.

STATE OF ILLINOIS  
DEPARTMENT OF TRANSPORTATION  
DISTRICT THREE  
AS BUILT INFORMATION

\_\_\_\_\_  
SUPERVISING CONSTRUCTION FIELD ENGINEER

\_\_\_\_\_  
RESIDENT ENGINEER / TECHNICIAN

START & END DATES  
OF CONSTRUCTION:

INSPECTORS:

STATE OF ILLINOIS  
DEPARTMENT OF TRANSPORTATION  
DISTRICT THREE

PREPARED BY: Tom Beaulieu  
DISTRICT STUDIES & PLANS ENGINEER

DATE: May 17, 2018

EXAMINED BY: Andy Valenzuela  
DISTRICT CONSTRUCTION ENGINEER

Michael A. Shott  
DISTRICT MATERIALS ENGINEER

Ron H. Hargrave  
DISTRICT OPERATIONS ENGINEER

FILE NAME =	USER NAME = pletc@tr	DESIGNED -	REVISED -	<b>STATE OF ILLINOIS DEPARTMENT OF TRANSPORTATION</b>	<b>GENERAL NOTES</b>	F.A.I. RTE.	SECTION	COUNTY	TOTAL SHEETS	SHEET NO.
pa\11084EBD\INTEG.#hols.gpr\FW\DOT\Documents\DOT Office\District 3\Projects\2016\2016CADD\20160519-01-corr	DRAWN -	REVISED -	39			2019-1 WEED SPRAY	LASALLE	7	2	
PLOT SCALE = 100.0000' / 1".	CHECKED -	REVISED -	CONTRACT NO. 66J39							
Default	PLOT DATE = 01/16/2018	DATE -	REVISED -			SCALE: _____	SHEET 1 OF 1 SHEETS	STA _____	TO STA. _____	ILLINOIS FED. AID PROJECT

CODE NO.	ITEM	UNIT	TOTAL QUANTITY	CONSTR. CODE	
				100% STATE	
				ROADWAY 0031	RURAL
67100100	MOBILIZATION	L SUM	1	1	
X0324857	AQUATIC WEED CONTROL, GLYPHOSATE	GALLON	13.2	13.2	
X0324858	AQUATIC WEED CONTROL, IMAZAPYR	GALLON	39.6	39.6	

FILE NAME * pwr\104EBID\INTEG\@ncs.gov\PW007\Documents\104EBID\Office\District 3\Project\10365136\CAOData\66J39-ehi-cover	USER NAME * pletschr	DESIGNED - _____	REVISED - _____	<b>STATE OF ILLINOIS DEPARTMENT OF TRANSPORTATION</b>	<b>SUMMARY OF QUANTITIES</b>			F.A.I. RTE. 39	SECTION 2019-1 WEED SPRAY	COUNTY LASALLE	TOTAL SHEETS 7	SHEET NO. 3
PLOT SCALE * 100.0000' / in.	CHECKED - _____	REVISED - _____	SCALE: _____					SHEET 1 OF 1 SHEETS	STA. _____ TO STA. _____	CONTRACT NO. 66J39		
PLOT DATE * 5/17/2018	DATE - _____	REVISED - _____				ILLINOIS   FED. AID PROJECT						
Default												

NORTH BOUND I-39				
MILE POST	RAMP/INFIELD	LENGTH	WIDTH	ACRES
40.3		200	20	0.09
41.1	OFF RAMP	20	30	0.01
41.15	OFF RAMP	200	20	0.09
41.2	SE INFIELD	50	15	0.02
41.3	SE INFIELD	100	250	0.57
41.6		80	20	0.04
45.75		30	20	0.01
46		20	20	0.01
47.35		30	20	0.01
47.7		300	40	0.28
47.95		150	100	0.34
48.1	OFF RAMP	200	30	0.14
	OFF RAMP	80	5	0.01
48.5	ON RAMP	400	70	0.64
48.5	NE INFIELD	125	30	0.09
49.1		120	30	0.08
50.85		760	40	0.70
51.1		150	100	0.34
51.2	OFF RAMP	80	20	0.04
51.3	OFF RAMP	150	20	0.07
51.4	SE INFIELD (TRIANGLE)			0.21
51.6	NE INFIELD	30	5	0.00
	ON RAMP	80	20	0.04
	ON RAMP	30	10	0.01
51.7	ON RAMP	60	40	0.06
51.8		300	200	1.38
52.1	SE INFIELD	50	20	0.02
52.15	SE INFIELD	30	10	0.01
52.3	NE INFIELD (TRIANGLE)			0.14
52.3	NE INFIELD	40	30	0.03
52.3	NE INFIELD	82	20	0.04
52.3	ON RAMP	100	20	0.05
52.3	ON RAMP	1120	70	1.80
52.55		200	20	0.09
52.65		415	25	0.24
52.7		500	30	0.34
52.9		50	30	0.03
52.9		100	25	0.06
53.4	OFF RAMP	120	30	0.08
53.4	SE INFIELD			0.15
53.5	NE INFIELD	180	60	0.25
53.6	NE INFIELD	100	40	0.09
	ON RAMP	30	20	0.01
53.95		30	15	0.01
54.2		80	10	0.02
56		400	20	0.18
56.05		160	120	0.44
SUB TOTAL				9.36

NORTH BOUND I-39				
MILE POST	RAMP/INFIELD	LENGTH	WIDTH	ACRES
56.1		160	20	0.07
56.2		80	15	0.03
56.25	OFF RAMP	825	100	1.89
56.3	SE INFIELD (TRIANGLE)			0.28
56.3	OFF RAMP			2.00
56.4	SE INFIELD			4.00
56.45	NE INFIELD			1.50
56.65	ON RAMP	50	20	0.02
56.7		60	10	0.01
56.8		86.3	60	0.12
57		240	20	0.11
57.1		240	20	0.11
57.2		60	15	0.02
57.3		90	50	0.10
57.4		160	60	0.22
57.5		200	60	0.28
57.5		100	60	0.14
57.65		120	50	0.14
57.8		30	15	0.01
57.85		40	30	0.03
58.4	SE INFIELD (TRIANGLE)			0.29
58.5	SE INFIELD	30	15	0.01
58.6	SE INFIELD	60	40	0.06
58.6	SE INFIELD	20	20	0.01
59.1		15	20	0.01
59.3		15	5	0.00
59.75		160	20	0.07
60.4		10	5	0.00
60.5		30	5	0.00
61		20	10	0.00
62.2		20	40	0.02
63.5		20	5	0.00
63.6		30	20	0.01
63.7		20	20	0.01
63.9		20	20	0.01
64		30	10	0.01
64.4		10	5	0.00
64.8		5	5	0.00
65		20	30	0.01
65.5		20	20	0.01
65.6		30	15	0.01
	OFF RAMP	10	50	0.01
65.7	SE INFIELD	20	10	0.00
65.8	SE INFIELD	200	75	0.34
65.9	SE INFIELD	100	45	0.10
	NE INFIELD	100	200	0.46
	NE INFIELD	50	75	0.09
SUB TOTAL				12.64

NORTH BOUND I-39				
MILE POST	RAMP/INFIELD	LENGTH	WIDTH	ACRES
	NE INFIELD	50	60	0.07
	NE INFIELD	60	60	0.08
	NE INFIELD	40	15	0.01
	ON RAMP	10	10	0.00
	ON RAMP	140	40	0.13
66.7		280	120	0.77
66.7		10	10	0.00
66.9		60	15	0.02
66.9		30	10	0.01
67.1		30	10	0.01
68.3		15	10	0.00
68.3		510	100	1.17
68.4		200	35	0.16
68.6		10	15	0.00
69		20	10	0.00
69.1		10	10	0.00
69.4		30	20	0.01
69.5		30	30	0.02
69.7		30	20	0.01
70.1		240	40	0.22
70.2		50	20	0.02
70.5		40	15	0.01
71.3		30	15	0.01
71.6	OFF RAMP	30	60	0.04
71.6	SE INFIELD	250	30	0.17
71.7	SE INFIELD	15	15	0.01
71.9	NE INFIELD	240	25	0.14
72	NE INFIELD	80	80	0.15
72	ON RAMP	350	50	0.40
72.1		30	30	0.02
73		10	5	0.00
74.6		20	10	0.00
74.8		20	20	0.01
74.9		200	60	0.28
75		20	10	0.00
75.1		30	15	0.01
75.3		80	20	0.04
SUB TOTAL				4.03
TOTAL				26.02

**OMISSIONS:  
I-80 INTERCHANGE AND  
HERBICIDE RESTRICTION AREAS**

SOUTH BOUND I-39				
MILE POST	RAMP/INFIELD	LENGTH	WIDTH	ACRES
74.9		350	80	0.64
72.3		10	10	0.00
72.2		10	15	0.00
70.8		140	25	0.08
69.2		20	5	0.00
69.1		440	25	0.25
69		480	40	0.44
68.6		150	50	0.17
68.5		20	30	0.01
68.3		120	20	0.06
67.2		150	20	0.07
67.1		80	20	0.04
66.7		140	40	0.13
66.3		100	120	0.28
66.1	NW INFIELD	60	80	0.11
65.9	NW INFIELD	168	80	0.31
EXIT 66	NW INFIELD	80	60	0.11
EXIT 66	NW INFIELD	30	15	0.01
EXIT 66	NW INFIELD	60	60	0.08
65.8	SW INFIELD	200	150	0.69
65.7	SW INFIELD	15	10	0.00
EXIT 66	SW INFIELD	15	15	0.01
EXIT 66	SW INFIELD	40	40	0.04
65.5		30	20	0.01
65.4		100	40	0.09
65.3		80	20	0.04
65.2		15	15	0.01
65.1		40	20	0.02
64.9		15	10	0.00
63.7		20	10	0.00
63.6		10	5	0.00
61		40	20	0.02
60.5		40	40	0.04
60.2		200	20	0.09
60.1		250	30	0.17
59.4		80	20	0.04
59.2	OFF RAMP	60	50	0.07
59	NW INFIELD	300	250	0.50
58.4		200	20	0.09
57.9		120	40	0.11
57.8		180	20	0.08
57.6		200	15	0.07
57.4		895	50	1.03
57.3		160	30	0.11
57.3		20	10	0.00
57.2		160	10	0.04
57		60	10	0.01
56.9		160	20	0.07
56.8		200	30	0.14
56.8		30	15	0.01
56.7		300	10	0.07
SUBTOTAL				6.47

SOUTH BOUND I-39				
MILE POST	RAMP/INFIELD	LENGTH	WIDTH	ACRES
	OFF RAMP	20	5	0.00
	OFF RAMP	200	15	0.07
	OFF RAMP	10	10	0.00
	OFF RAMP	150	20	0.07
	OFF RAMP	160	30	0.11
56.6	NW INFIELD			5.30
56.5	SW INFIELD			2.98
56.3		100	40	0.09
56.2		360	40	0.33
56.2		20	10	0.00
53.9		200	20	0.09
	OFF RAMP	350	40	0.32
	OFF RAMP	40	30	0.03
53.7	NW INFIELD	20	20	0.01
53.6	NW INFIELD	50	100	0.11
53.6	SW INFIELD	75	150	0.26
	ON RAMP	250	40	0.23
	ON RAMP	150	30	0.10
53.2		60	40	0.06
53.1		50	50	0.06
53		440	80	0.81
52.8		1760	30	1.21
52.3	NW INFIELD	120	20	0.06
52.1		80	30	0.06
52		80	20	0.04
51.9		280	40	0.26
51.8		280	60	0.39
51.7		240	60	0.33
	OFF RAMP	80	5	0.01
51.7	NW INFIELD	25	5	0.00
51.6	NW INFIELD	20	10	0.00
51.5	NW INFIELD	90	50	0.10
51.4	SW INFIELD	160	60	0.22
	ON RAMP	150	60	0.21
	ON RAMP	400	40	0.37
51.1		40	10	0.01
50.5		60	60	0.08
49.4		80	20	0.04
49.3		160	30	0.11
48.2	ON RAMP	120	25	0.07
	ON RAMP	20	10	0.00
48.1		240	40	0.22
48.1		80	30	0.06
47.7		240	30	0.17
47.6		250	25	0.14
47.5		120	10	0.03
46.2		280	30	0.19
	OFF RAMP	180	20	0.08
41.2		250	20	0.11
41.1		30	10	0.01
40.8		30	10	0.01
SUBTOTAL				15.60
TOTAL				22.07

**OMISSIONS:  
I-80 INTERCHANGE AND  
HERBICIDE RESTRICTION AREAS**

MEDIAN I-39			
MILE POST	LENGTH	WIDTH	ACRES
40.5	50	12	0.01
40.8	15	10	0.00
41	40	10	0.01
41.7	10	10	0.00
42.5	120	20	0.06
44.8	40	12	0.01
45.3	40	10	0.01
46.9	10	10	0.00
49.2	15	10	0.00
49.45	20	10	0.00
49.9	80	10	0.02
50.6	100	10	0.02
50.9	100	15	0.03
51	15	15	0.01
51.55	200	20	0.09
51.7	20	20	0.01
52	60	12	0.02
52.2	120	15	0.04
52.5	125	15	0.04
52.6	160	12	0.04
52.7	160	15	0.06
52.75	40	20	0.02
52.8	50	12	0.01
53.05	10	10	0.00
54.3	40	5	0.00
54.35	10	10	0.00
56.4	200	5	0.02
56.45	240	10	0.06
56.5	160	20	0.07
56.65	120	30	0.08
56.7	120	50	0.14
56.8	200	50	0.23
56.9	160	50	0.18
57	50	40	0.05
57	50	40	0.05
57.1	10	5	0.00
57.3	160	40	0.15
57.35	160	40	0.15
57.45	240	40	0.22
57.5	240	40	0.22
<b>SUBTOTAL</b>			<b>2.15</b>

MEDIAN I-39			
MILE POST	LENGTH	WIDTH	ACRES
57.65	120	40	0.11
57.8	80	30	0.06
57.85	100	40	0.09
57.95	120	40	0.11
58.05	130	45	0.13
58.1	160	30	0.11
58.3	10	15	0.00
59.1	20	20	0.01
59.2	30	25	0.02
59.2	240	50	0.28
59.5	25	20	0.01
59.7	50	20	0.02
59.7	20	40	0.02
60.1	100	20	0.05
60.2	100	35	0.08
60.8	60	40	0.06
63.3	20	10	0.00
64.3	10	15	0.00
64.7	10	10	0.00
65.8	250	50	0.29
65.9	180	40	0.17
66.3	30	25	0.02
66.5	40	60	0.06
66.6	60	40	0.06
66.7	80	50	0.09
67.2	30	25	0.02
67.4	80	50	0.09
68.3	15	25	0.01
68.3	15	25	0.01
69.6	200	40	0.18
69.8	15	10	0.00
70.9	30	25	0.02
72.4	40	40	0.04
72.7	10	15	0.00
72.8	10	10	0.00
74.8	20	20	0.01
74.9	170	50	0.20
76.2	100	50	0.11
76.4	50	45	0.05
<b>SUBTOTAL</b>			<b>2.58</b>
<b>TOTAL</b>			<b>4.73</b>

**OMISSIONS:  
I-80 INTERCHANGE AND  
HERBICIDE RESTRICTION AREAS**



**Location Map - Contract # 66J39**  
**I-39 Weed spraying project**  
**LaSalle County - MP48-MP50**  
**Environmental Resources**

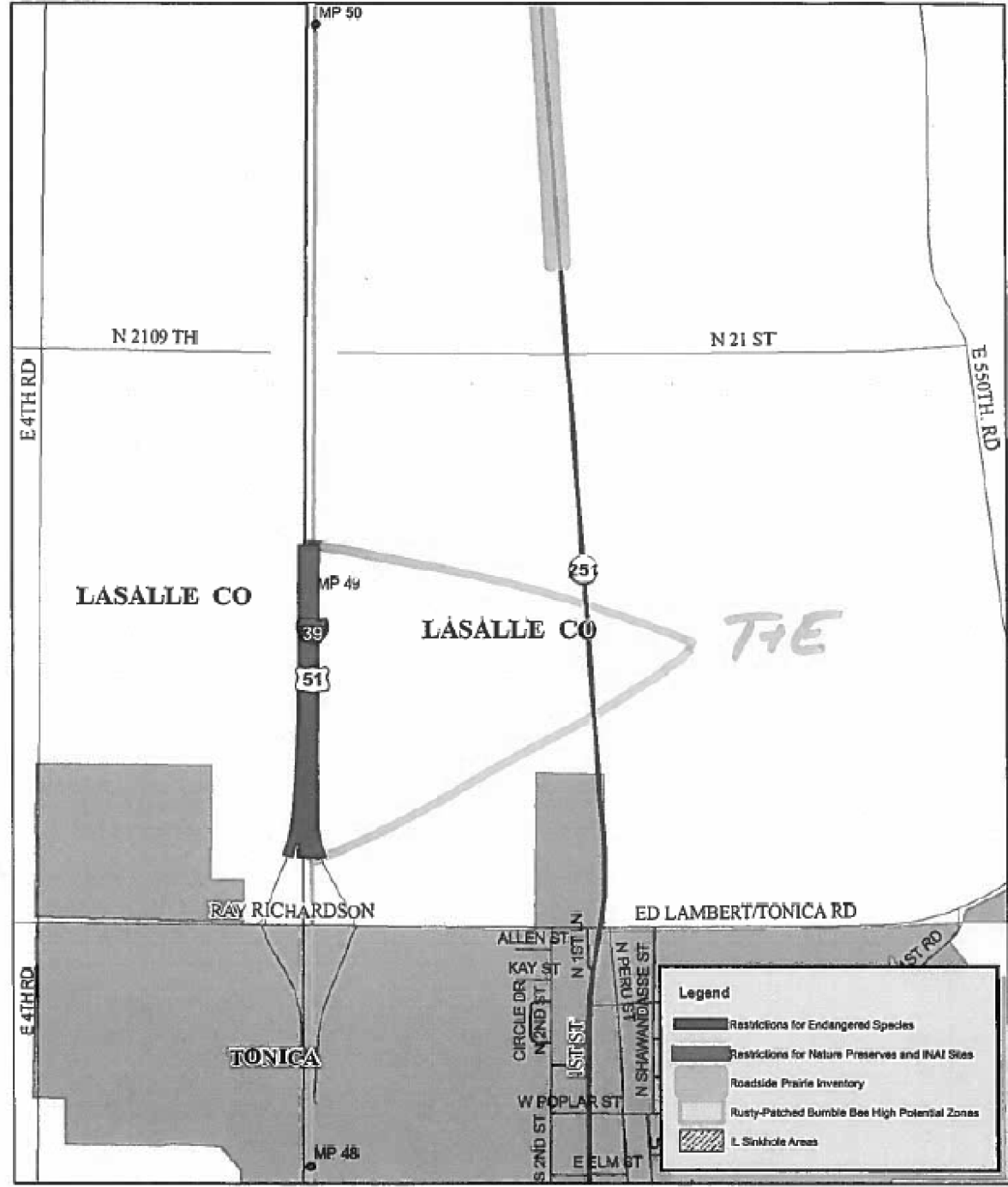

**Location Map - Contract # 66J39**  
**I-39 Weed spraying project**  
**LaSalle County - MP54-MP56**  
**Environmental Resources**

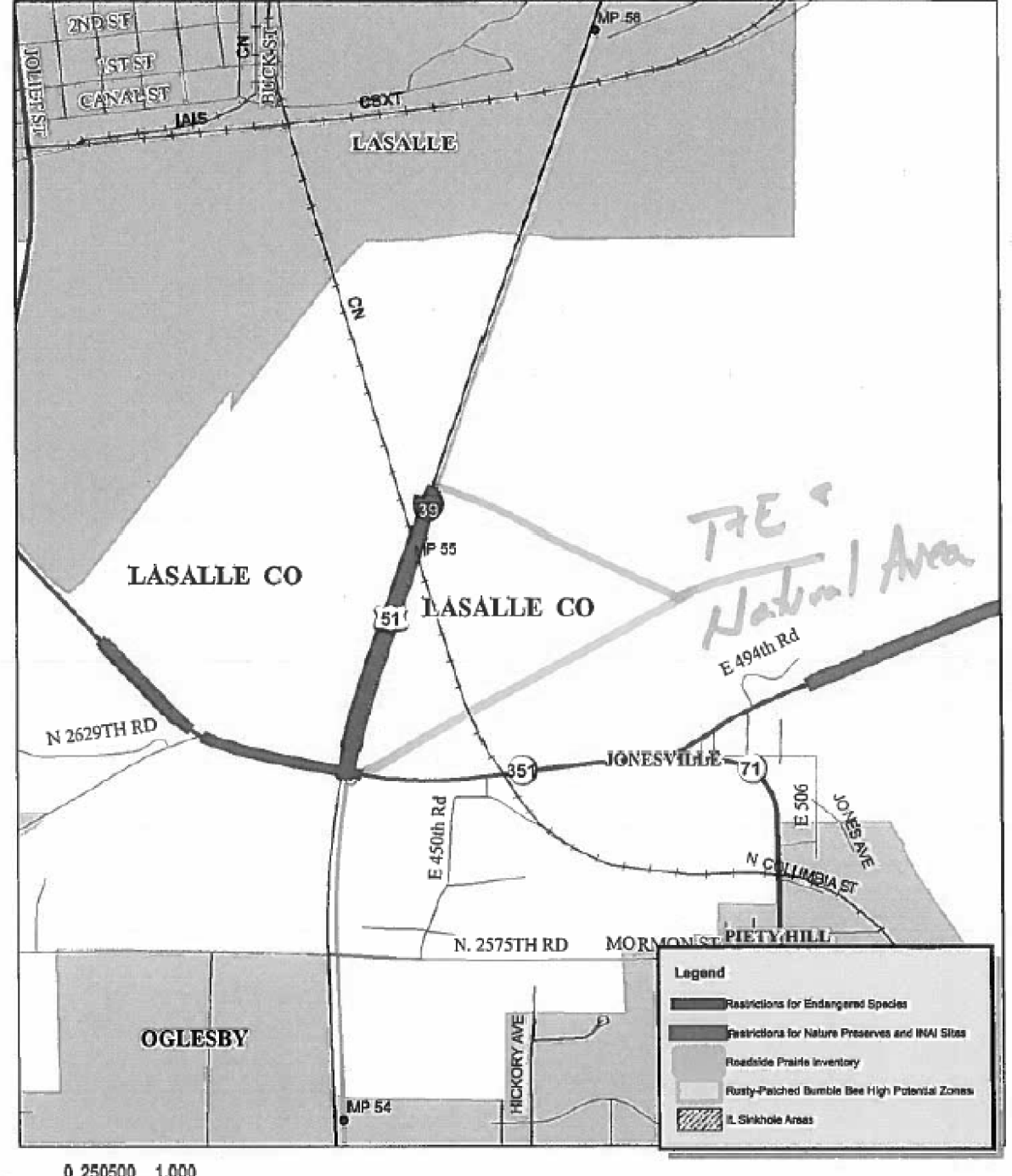

FILE NAME =	USER NAME = pletschr	DESIGNED -	REVISED -
pw\11084EB\INTEG\Illinois.gov\PWIDOT\Documents\DOT Offices\District 3\Projects\0366\39\CADD\066J39-ehd-details		DRAWN -	REVISED -
Default		CHECKED -	REVISED -
	PLOT DATE = 5/16/2018	DATE -	REVISED -

**STATE OF ILLINOIS**  
**DEPARTMENT OF TRANSPORTATION**

**HERBICIDE RESTRICTION MAPS**  
 SCALE: \_\_\_\_\_ SHEET 1 OF 1 SHEETS STA. \_\_\_\_\_ TO STA. \_\_\_\_\_

F.A.I. RTE.	SECTION	COUNTY	TOTAL SHEETS	SHEET NO.
39	2019-1 WEED SPRAY	LASALLE	7	7
CONTRACT NO. 66J39				
ILLINOIS FED. AID PROJECT				