

STATE OF ILLINOIS
DEPARTMENT OF TRANSPORTATION

F.A.P. 318	SECTION (3) I-1, DR	COUNTY MARSHALL	TOTAL SHEETS 27	SHEET NO. 1
RTE IL 29		ILLINOIS CONTRACT NO. 68E55		

INDEX SHEETS,

1. COVER /SIGNATURE SHEET
- 2-3. GENERAL NOTES
- 4-6. SUMMARY OF QUANTITIES
7. TYPICAL SECTION
8. SCHEDULE OF QUANTITIES
9. TIES & BM
10. PROPOSED PLAN & PROFILE
11. REMOVAL/PATCHES/EROSION CONTROL/PAVEMENT MARKING
- 12-20. D4 CADD STANDARDS
- 21-27. CROSS SECTIONS

PROPOSED HIGHWAY PLANS

IL 29 ROUTE FAP 318
SECTION (3) I-1,DR
PROJECT

TYPE of IMPROVEMENT: ROADWAY & DRAINAGE
MARSHALL COUNTY

D-94-068-18

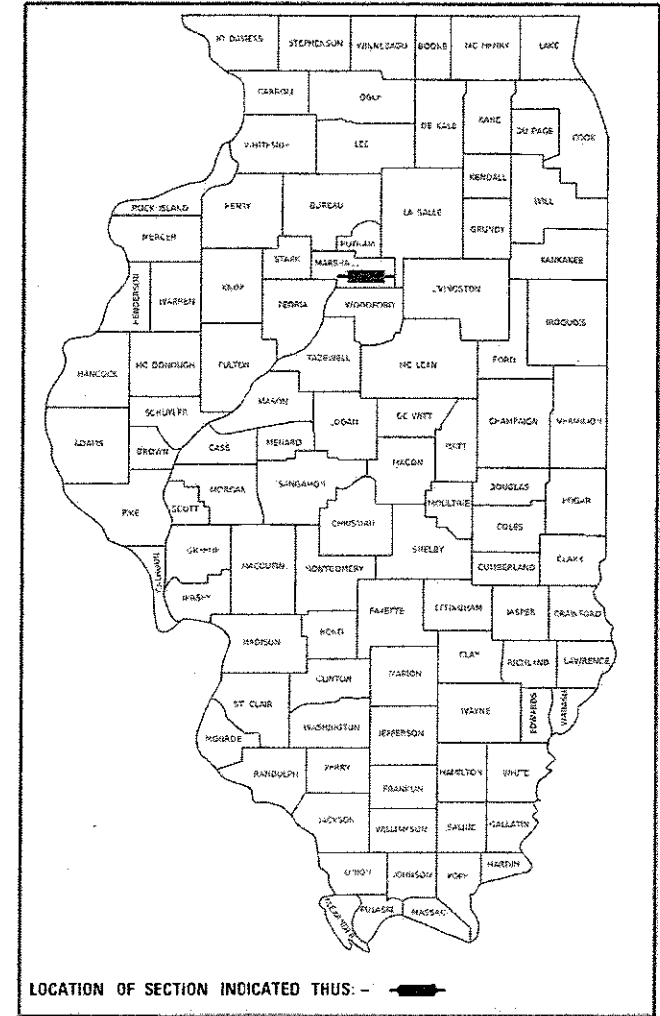

HIGHWAY STANDARDS			
701201-04	701301-04	280001-07	601101-02
701306-04	701311-03	442201-03	606101-05
701901-07	780001-05	601001-05	

CADD STANDARDS	
406101-D4	440001-D4
780001-D4	

AADT: 3550/2017
SU: 7.04%
MU: 7.04%

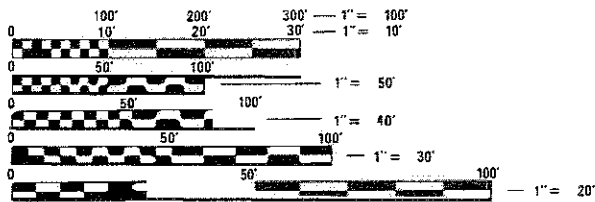

FULL SIZE PLANS HAVE BEEN PREPARED USING STANDARD ENGINEERING SCALES. REDUCED SIZED PLANS WILL NOT CONFORM TO STANDARD SCALES. IN MAKING MEASUREMENTS ON REDUCED PLANS, THE ABOVE SCALES MAY BE USED.

J.U.L.I.E.
JOINT UTILITY LOCATION INFORMATION FOR EXCAVATION
1-800-892-0123
OR 811

PROJECT ENGINEER: Christopher Maushard 309-671-3453
PROJECT MANAGER: Michael Hudelson 309-671-3466
George Elias 309-671-3467
CONTRACT NO. 68E55
CATALOG NO. 035647-00D

C-94-092-18

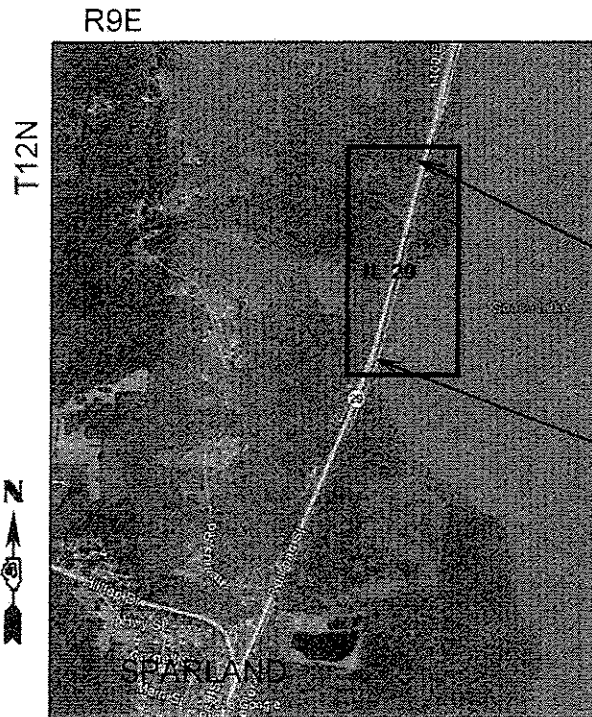

JOB STARTS
STA. 312+00

JOB END
STA. 322+00

JOB DESCRIPTION:
PROFILE CORRECTION & UNDERDRAIN
INSTALLATION ON IL 29, 0.7 MILE
NORTH OF SPARLAND.

GROSS LENGTH = 1000 FT. = 0.20 MILE
NET LENGTH = 1000 FT. = 0.20 MILE

STATE OF ILLINOIS
DEPARTMENT OF TRANSPORTATION

SUBMITTED May 17 20 18
Paul A. James
REGION THREE ENGINEER

June 29 20 18
Sec. E. E. K.
ENGINEER OF DESIGN AND ENVIRONMENT

June 29 20 18
Paul J. [Signature]
DIRECTOR OF HIGHWAYS PROJECT IMPLEMENTATION

PRINTED BY THE AUTHORITY
OF THE STATE OF ILLINOIS

COMMITMENTS

Commitments are not to be altered without the written approval of all parties to which the commitment was made. **NO COMMITMENTS HAVE BEEN MADE FOR THIS PROJECT.**

ENVIRONMENTAL REVIEWS

Prior to the use of any proposed borrow areas, use areas (temporary access roads, detours, run-arounds, etc.) and/or waste areas, the Contractor shall file the required environmental resource request surveys according to Section 107.22 of the Standard Specifications. These surveys are required in order for the Department to conduct cultural and biological resource surveys for the proposed site.

Prior to any waste materials being removed from the construction site the required environmental resource surveys will need to be obtained and filed by the Contractor. Excess waste products removed from the construction site shall be disposed of as required in Section 202.03 of the Standard Specifications.

Any protruding metal bars shall be removed prior to the disposal of broken concrete at approved disposal sites.

The required environmental resource documentation shall include the following:

- * BDE Form 2289 (Environmental Survey Request)
- * BDE Form 2290 (Waste/Use Area Review)
- * A location map showing the size limits and location of the use area
- * Color photographs depicting the use area
- * Borrow Area Entry Agreement form-D4 PI0101

Please note that a minimum of four weeks shall be allowed for the District to obtain the required environmental clearances and six weeks for the required borrow site environmental clearances.

BUTT JOINT CUTTING TIME RESTRICTION

Butt joints shall not be milled more than three (3) days prior to placement of the HMA surface course.

PAVING SURFACE COURSE

Continuous paving operations on the main roadway shall be maintained at all times during the construction of the hot-mix asphalt surface. No interruptions for side roads, entrances, turn lanes, etc. will be allowed.

PAVEMENT STATIONING NUMBERS & PLACEMENT

The Contractor shall provide labor and materials required to imprint pavement station numbers in the finished surface of the pavement and/or overlay. The numbers shall be approximately 3/4 inch (20mm) wide, 5 inches (125 mm) high and 5/8 inch (15 mm) deep.

The pavement station numbers shall be installed as specified herein:

Interval – 200 feet (English stationing) or 100 meters (metric stationing)

Bottom of Numbers – 6 inches (150 mm) from the inside edge of the pavement marking

Location:

- * 2,3, & 5 Lane Pavements – right edge of pavement in direction of increasing stations
- * Multi-Lane Divided Roadways – outside edge of pavement in both directions
- * Ramps – along baseline edge of pavement

Position – stations shall be placed so they can be read from the adjacent shoulder

Format – English (Metric) pavement stations shall use this format "XXX (XX + X00)" where X represents the pavement station

This work will not be paid for separately, but will be considered included in the cost of the associated pavement and/or overlay pay items.

MODEL: Default FILE NAME: P:\MAIL\PRIVACY\DOT Documents\DOT Office\District 4\Project\04_18258\CAD\Drawings\DOT 29 of Springfield.Dwg

USER NAME = ellaspj	DESIGNED -	REVISED -	STATE OF ILLINOIS DEPARTMENT OF TRANSPORTATION	GENERAL NOTES			F.A.P 318	SECTION	COUNTY	TOTAL SHEETS	SHEET NO.
	DRAWN -	REVISED -					(3)-1.DR	MARSHAL	27	2	
PLOT SCALE = 100.0000' / in.	CHECKED -	REVISED -		SCALE:	SHEET	OF	SHEETS	STA.	TO STA.	CONTRACT NO. 68E55	
PLOT DATE = 5/17/2018	DATE -	REVISED -		RTE. IL 29 ILLINOIS FED. AID PROJECT							

POLYMERIZED BITUMINOUS MATERIALS (TACK COAT) RATES

Surface Type	Residual Rate
Milled (HMA or PCC)	0.08 lb /sq ft
Existing Pavement	0.04 lb /sq ft
Fog Coat (between lifts)	0.04 lb /sq ft

HOT-MIX ASPHALT MIXTURE REQUIREMENTS

Mixture Use(s):	ALL LIFTS, SURFACE, BINDER & SHOULDER
AC/PC:	64-22
Design Air Voids:	4.0% N=50
Mixture Composition: (Gradation Mixture):	IL 9.5
Friction Aggregate:	MIX D
Mix Weights:	112 lb/sy/in
Quality Management:	QC/QA

Notes: Individual lift thickness of each mix type will be no less than 3 times nominal maximum aggregate size and no more than 6 times nominal aggregate size.

CLEARING

At locations where clearing is indicated on the plans beyond the limits of the proposed excavation or embankment, the Contractor shall restore the disturbed earth by blading and shaping to blend with the adjacent ground. The clearing will not be paid for separately but shall be included in the cost of excavation pay items in the plans. Payment for reseeding or resodding will be as provided in the plans.

TREE REMOVAL

No tree removal is to take place without the approval of the district.
We can't remove any trees between April 1 & October 1.

MODEL: Default
 FILE NAME: \\ms01104480\DOTNET\Illinois\p2p\DOT Documents\DOT Offices\District 4\Projects\04_2018\68E55\CADD\Sub\CD\Sheet\1129_11 of 51\land.Dwg

USER NAME = eliasgs	DESIGNED -	REVISED -
	DRAWN -	REVISED -
PLOT SCALE = 300,0000' / in.	CHECKED -	REVISED -
PLOT DATE = 5/17/2018	DATE -	REVISED -

**STATE OF ILLINOIS
DEPARTMENT OF TRANSPORTATION**

GENERAL NOTES

SCALE: SHEET OF SHEETS STA. TO STA.

F.A.P 318	SECTION	COUNTY	TOTAL SHEETS	SHEET NO.
	(3)-1.DR	MARSHAL	27	3
RTE. IL 29		CONTRACT NO. 68E55		
ILLINOIS FED. AID PROJECT				

CODE NO.	ITEM	UNIT	TOTAL QUANTITY	CONST. CODE
				MARSHALL CO. 100% STATE
20400800	FURNISHED EXCAVATION	CU YD	76.2	0005 ROADWAY
21101615	TOPSOIL FURNISH & PLACE, 4"	SO YD	456	
21400100	GRADING AND SHAPING DITCHES	FOOT	350	
25100630	EROSION CONTROL BLANKET	SQ YD	389	
28000400	PERIMETER EROSION BARRIER	FOOT	1375	
28000500	INLET AND PIPE PROTECTION	EACH	1	
28100825	STONE DUMPED RIPRAP, CLASS B3	TON	4.4	
28200200	FILTER FABRIC	SQ YD	13.3	
40600295	POLYMERIZED BITUMINOUS MATERIALS (TACK COAT)	POUND	6049	
40600982	HOT - MIX ASPHALT SURFACE REMOVAL - BUTT JOINT	SQ YD	84.4	
40600990	TEMPORARY RAMP	SO YD	88.8	
40602978	HOT-MIX ASPHALT BINDER COURSE, IL-9.5, N50	TON	550.9	
40603335	HOT - MIX ASPHALT SURFACE COURSE, MIX "D", N50	TON	233.3	
44000400	GUTTER REMOVAL	FOOT	445	

14

MODEL: Defect1
 FILE NAME: P:\1108\BIB\BIB\ITEG\11\mst\gpr\WDDT\Documents\11011 Ofraaa\District 4\Projects\04_68055\CD\Draws\CD\Sheet500p_Cross_Section.dgn

USER NAME = hudeisonme	DESIGNED -	REVISED -
PLOT SCALE = 100.0000' / 1" =	DRAWN -	REVISED -
PLOT DATE = 5/17/2018	CHECKED -	REVISED -
	DATE -	REVISED -

**STATE OF ILLINOIS
DEPARTMENT OF TRANSPORTATION**

SUMMARY OF QUANTITIES

F.A.P. RTE. 318	SECTION (311)-1,DR	COUNTY MARSHALL	TOTAL SHEETS 27	SHEET NO. 4
CONTRACT NO. 68E55			ILLINOIS FED. AID PROJECT	

MODEL: De fault
 FILE NAME: P:\11\BBS\BBS\INTEC\Illinois\gov\FW\DOT\Documents\DOT - IT\Task\District 4\Projects\Dr_68BE55\CDData\CDItems\Op_Cross_Section.dgn

CODE NO.	ITEM	UNIT	TOTAL QUANTITY	CONST. CODE
				0005 ROADWAY MARSHALL CO. 100% STATE
44201741	CLASS D PATCHES, TYPE 11, 8 INCH	SQ YD	24.4	24.4
48101200	AGGREGATE SHOULDERS, TYPE B	TON	65.2	65.2
48203100	HOT - MIX ASPHALT SHOULDERS	TON	418.1	418.1
60100060	CONCRETE HEADWALL FOR PIPE DRAINS	EACH	1	1
60108200	PIPE UNDERDRAINS 6" (SPECIAL)	FOOT	36	36
67100100	MOBILIZATION	L SUM	1	1
70100450	TRAFFIC CONTROL AND PROTECTION, STANDARD 701201	L SUM	1	1
70100460	TRAFFIC CONTROL AND PROTECTION, STANDARD 701306	L SUM	1	1
70300100	SHORT-TERM PAVEMENT MARKING	FOOT	900	900
70300150	SHORT TERM PAVEMENT MARKING REMOVAL	SQ FT	300	300
70300220	TEMPORARY PAVEMENT MARKING - LINE 4"	FOOT	2250	2250
* 78001110	PAINT PAVEMENT MARKING - LINE 4"	FOOT	2250	2250
* 78100100	RAISED REFLECTIVE PAVEMENT MARKER	EACH	13	13
78300200	RAISED REFLECTIVE PAVEMENT MARKER REMOVAL	EACH	13	13

*= SPECIALTY ITEM

USER NAME = hudeisonme PLOT SCALE = 100.0000' / 1" = PLOT DATE = 5/17/2018	DESIGNED - DRAWN - CHECKED - DATE -	REVISED - REVISED - REVISED - REVISED -	STATE OF ILLINOIS DEPARTMENT OF TRANSPORTATION	SUMMARY OF QUANTITIES	F.A.P. RTE. 318	SECTION (311)-1,DR	COUNTY MARSHALL	TOTAL SHEETS 27	SHEET NO. 5	CONTRACT NO. 68E55	ILLINOIS FED. AID PROJECT
--	--	--	---	------------------------------	-----------------------	-----------------------	--------------------	--------------------	----------------	--------------------	---------------------------

RESURFACING TABLE															
LOCATION				WIDTH FT	LENGTH FT	AREA SQ YD	HMA SURF REM	TEMP RAMP	HMA SURF REM	POLY BIT	HMA BNDR CSE	HMA SURF CSE	HMA SHLDRS	AGG SHLDRS	MATERIAL
							BUTT JT	SQ YD	VAR DEPTH	TACK COAT	IL-9.5, N50 (VAR DEPTH)	MIX "D" N50 1-1/2"	(VAR DEPTH)	TYPE B	TRANSFER DEVICE
							SQ YD	SQ YD	POUND	TON	TON	TON	TON	TON	
312+00	TO	322+00	MAINLINE	25	1000	2777.8	55.6	88.8	2722.2	527	550.9	233.3	0	0	233.3
312+00	TO	322+00	LT SHLDR	3	1000	333.3	6.6	0	326.7	3946	0	0	104.5	65.2	0
312+00	TO	322+00	RT SHLDR	10	1000	1111.1	22.2	0	1088.9	1576	0	0	313.6	0	0
TOTAL							84.4	88.8	4137.8	6049	550.9	233.3	418.1	65.2	233.3

FURNISHING EXCAVATION				
LOCATION				CU YD
312+00	TO	322+00	RT	68.3
312+00	TO	322+00	LT	7.9
TOTAL				76.2

TOPSOIL FURNISH & PLACE 4"				
LOCATION				SQ YD
312+00	TO	322+00	RT	221.9
312+00	TO	322+00	LT	234.1
TOTAL				456

GRADING AND SHAPING DITCHES				
LOCATION				FOOT
317+50	TO	321+00	RT	350
TOTAL				350

EROSION CONTROL BLANKET				
LOCATION				SQ YD
317+50	TO	321+00	RT	389
350 FT X 10' WIDTH				
TOTAL				389

PERIMETER EROSION BARRIER				
LOCATION				FOOT
312+00	TO	321+00	LT	900
316+25	TO	321+00	LT	475
TOTAL				1375

INLET AND PIPE PROTECTION				
LOCATION				EACH
321+12 40 FT RT				1
TOTAL				1

STONE DUMPED RIP RAP CL B3				
LOCATION				TON
321+12 42 FT RT				4.4
TOTAL				4.4

FILTER FABRIC				
LOCATION				SQ YD
321+12 42 FT RT				13.3
TOTAL				13.3

GUTTER REMOVAL				
LOCATION				FOOT
316+25	TO	320+70	RT	445
TOTAL				445

CLASS D PATCHES, TYPE II, 8"				
LOCATION				SQ YD
317+00	TO	317+25	RT	11.1
25 FT X 4 FT IN RT SHLDR				
317+73	TO	318+03	RT	13.3
30 FT X 4 FT IN RT SHLDR				
TOTAL				24.4

CONCRETE HEADWALL FOR PIPE DRAINS				
LOCATION				EACH
321+00 40 FT RT				1
TOTAL				1

PIPE UNDERDRAINS 6" (MODIFIED)				
LOCATION				FOOT
315+70	TO	320+70	RT	500
TOTAL				500

PIPE UNDERDRAINS 6" (SPECIAL)				
LOCATION				FOOT
320+70	TO	321+00	RT	36
TOTAL				36

CONCRETE GUTTER, TYPE A (SPECIAL)				
LOCATION				FOOT
316+25	TO	320+70	RT	445
TOTAL				445

FILL EXISTING PIEZOMETER				
LOCATION				EACH
315+38 RT SHLDR (7 FT RT OF EOP)				1
317+12 RT SHLDR (6 FT RT OF EOP)				1
TOTAL				2

MOBILIZATION				
LOCATION				L SUM
JOBSITE				1
TOTAL				1

TRAFFIC CONTROL & PROTECTION STD 701201				
LOCATION				L SUM
JOBSITE				1
TOTAL				1

TRAFFIC CONTROL & PROTECTION STD 701306				
LOCATION				L SUM
JOBSITE				1
TOTAL				1

TEMPORARY PAVEMENT MARKING - LINE 4"				
LOCATION				FOOT
312+00	TO	322+00	1000 FT	
RT & LT EDGE LINES (WHITE)				2000
SKIP DASH CENTER (YELLOW)				250
TOTAL				2250

PAINT PAVEMENT MARKING - LINE 4"				
LOCATION				FOOT
312+00	TO	322+00	1000 FT	
RT & LT EDGE LINES (WHITE)				2000
SKIP DASH CENTER (YELLOW)				250
TOTAL				2250

RAISED REFLECTIVE PAVEMENT MARKER				
LOCATION				EACH
317+50	TO	321+00	CENTER	13
TOTAL				13

RAISED REFLECTIVE PAVEMENT MARKER REMOVAL				
LOCATION				EACH
317+50	TO	321+00	CENTER	13
TOTAL				13

CONSTRUCTION LAYOUT				
LOCATION				L SUM
JOBSITE				1
TOTAL				1

SHORT TERM PAVEMENT MARKING				
LOCATION				FOOT
312+00	TO	322+00	1000 FT	
RT & LT SHOULDER DIAGONALS (WHITE)				80
SKIP DASH CENTER (YELLOW)				100
SUB TOTAL				180
X 5 APPLICATIONS				
SUB TOTAL				900

SHORT TERM PAVEMENT MARKING REMOVAL				
LOCATION				SQ FT
312+00	TO	322+00		300
TOTAL				300

MODEL: \$MODELNAME
FILE: \$NAME\$. \$FILE

USER NAME = \$USERS	DESIGNED -	REVISED -
	DRAWN -	REVISED -
PLOT SCALE = \$SCALE\$	CHECKED -	REVISED -
PLOT DATE = \$DATE\$	DATE -	REVISED -

**STATE OF ILLINOIS
DEPARTMENT OF TRANSPORTATION**

SCHEDULE OF QUANTITIES				
SCALE:	SHEET	OF	SHEETS	STA. TO STA.

F.A.P. RTE.	SECTION	COUNTY	TOTAL SHEETS	SHEET NO.
318	(S)-1,DR	MARSHALL	27	8
CONTRACT NO. 68E55				
ILLINOIS FED. AID PROJECT				

RECOVERY TIES

IL 29 Pavement – North of Sparland

W.P. 10 – P.K. Nail in Bit Shldr

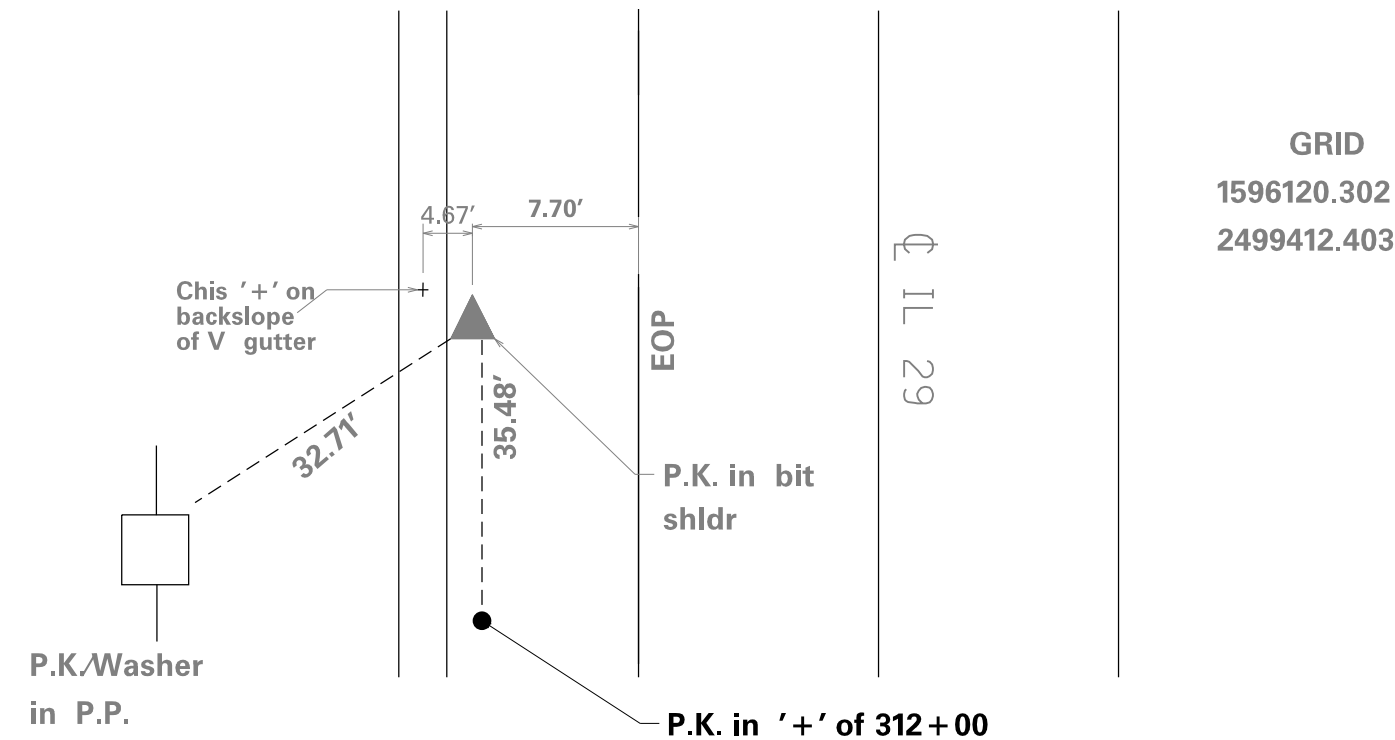

RECOVERY TIES

IL 29 Pavement – North of Sparland

W.P. 11 – P.K. Nail in Bit Shldr

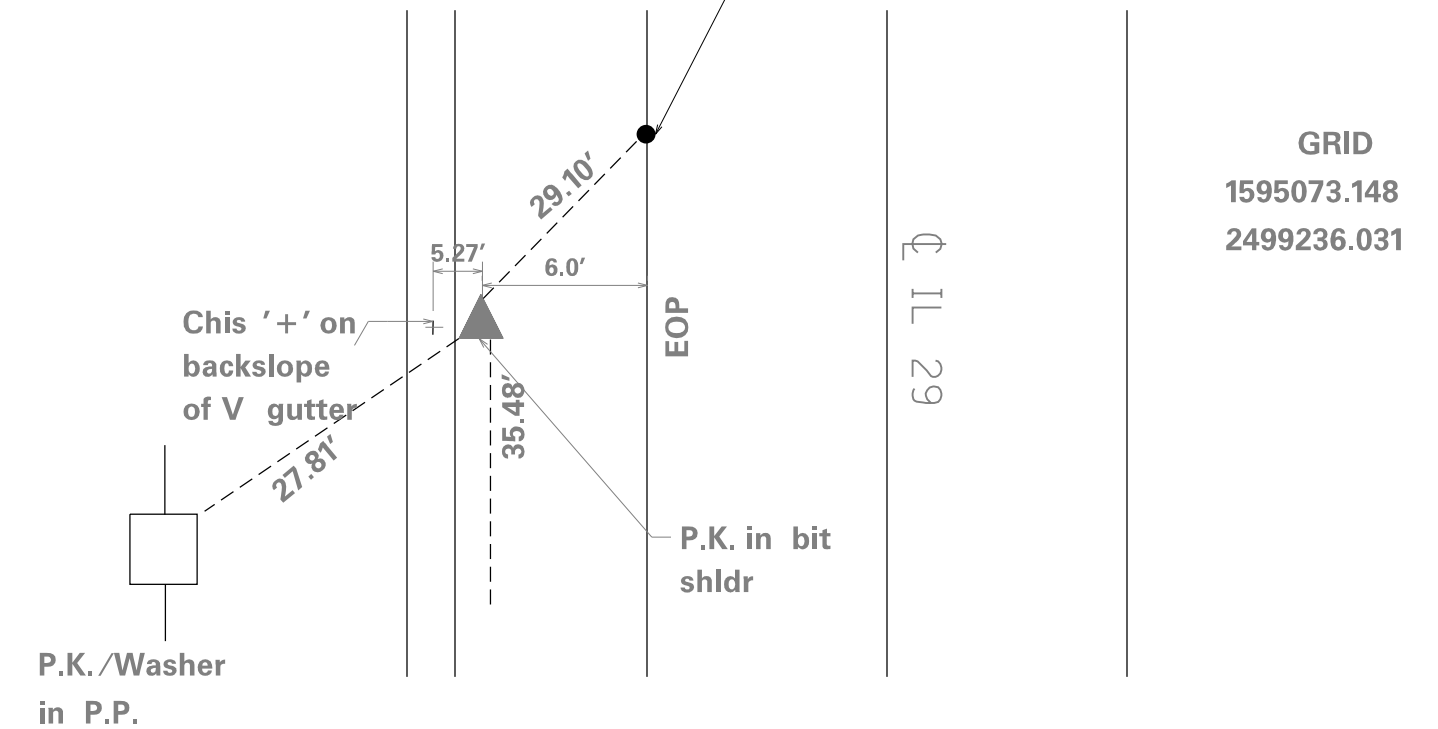

Not to Scale

BM# 902

P.T. ID 13

RAW ELEVATION = 470.299

NAVD88 ADJ ELEVATION = 470.288

Chisel " " on East side of 3' wide V-gutter, 185' south of P.T. 11

STA. 324 + 00, 21' RT.

BM# 901

P.T. ID 18

RAW ELEVATION = 476.321

NAVD88 ADJ ELEVATION = 476.309

Chisel " " on East side of 3' wide V-gutter, 175' North of P.T. 10

STA. 310 + 00, 21' RT.

STATE OF ILLINOIS
DEPARTMENT OF TRANSPORTATION

TIES AND BENCHMARKS

SCALE: SHEET OF SHEETS STA. TO STA.

F.A.P. RTE.	SECTION	COUNTY	TOTAL SHEETS	SHEET NO.
318	(S)-1,DR	MARSHALL	27	9
CONTRACT NO. 68E55				
ILLINOIS FED. AID PROJECT				

POT Sta 307+73.80 PC Sta 321+36.09
 1,596,501.58 1,595,157.20
 2,499,496.58 2,499,269.92

EXIST. CURVE IL29
 PI STA. = 326+48.17
 $\Delta = 8^\circ 50' 23''$ (RT)
 $D = 0^\circ 51' 53''$
 $R = 6,625.04'$
 $T = 512.08'$
 $L = 1,022.12'$
 $E = 19.76'$
 $e =$
 T.R. =
 S.E. RUN =
 P.C. STA. = 321+36.09
 P.T. STA. = 331+58.21

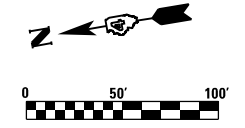

NOTE: CROWN OF PAVEMENT LOCATION VARIES FROM IL 29 CENTERLINE
 PROPOSED RESURFACING TO FOLLOW EXISTING ROADWAY

PLAN	SURVEYED	BY	DATE
	PLOTTED		
	ALIGNED		
	CHECKED		
	FILED		
	NO.		

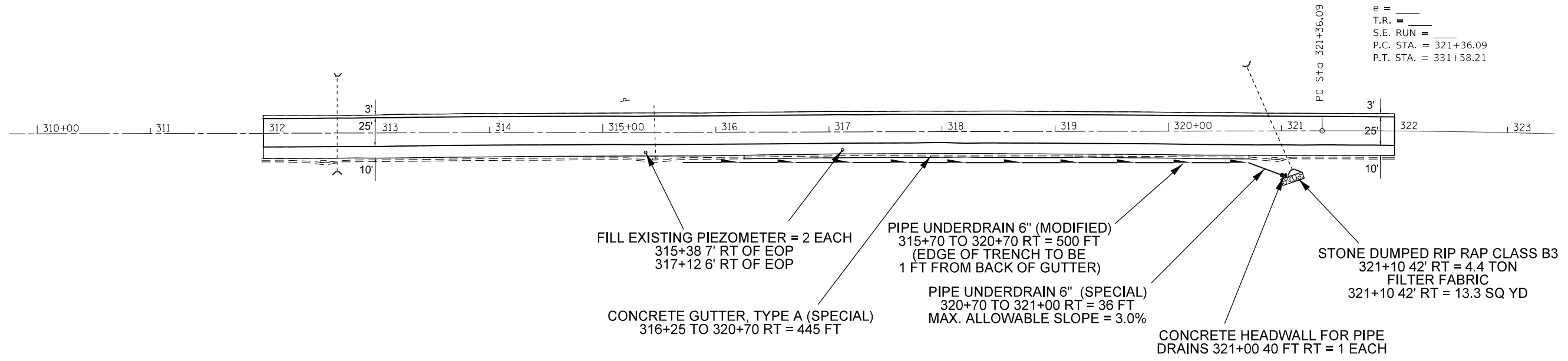

PROFILE	SURVEYED	BY	DATE
	PLOTTED		
	GRADES CHECKED		
	STRUCTURE NOTATIONS CHECKED		
	NO.		

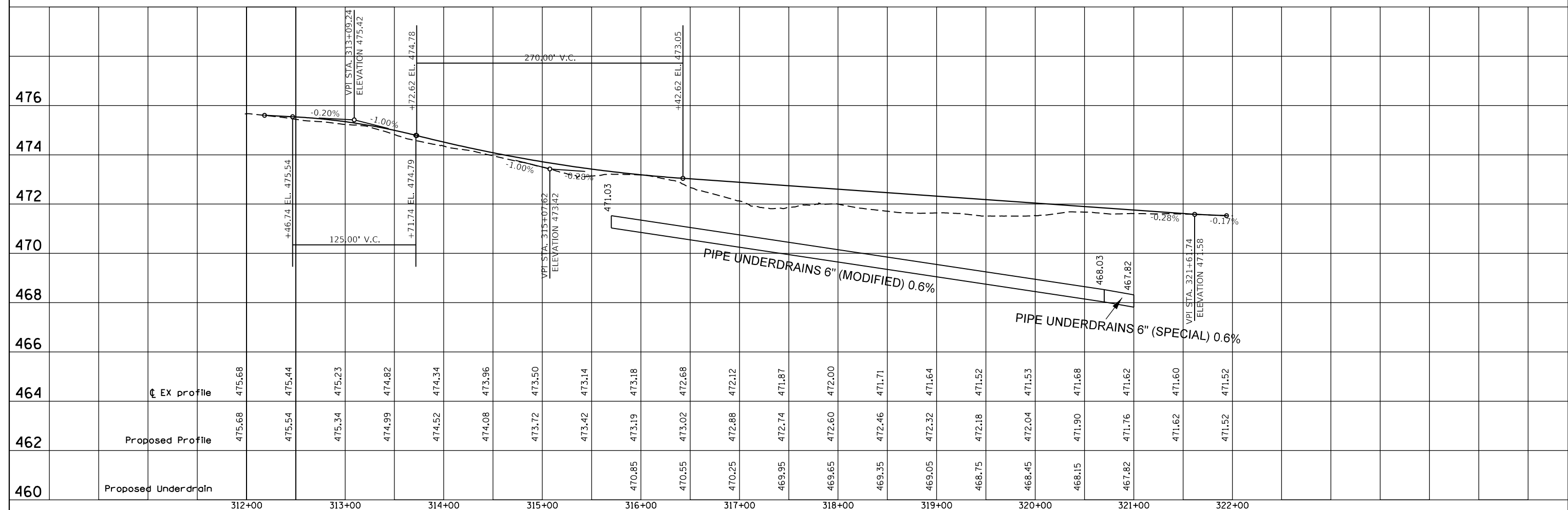

FILE NAME =	USER NAME = *USER*	DESIGNED -	REVISIED -	STATE OF ILLINOIS DEPARTMENT OF TRANSPORTATION	PROPOSED PLAN AND PROFILE				F.A.P. RTE.	SECTION	COUNTY	TOTAL SHEETS	SHEET NO.
*FILEL#		DRAWN -	REVISIED -		318	(3)1-1,DR	MARSHALL	27	10				
*MODELNAME#		CHECKED -	REVISIED -		CONTRACT NO. 68E55				ILLINOIS FED. AID PROJECT				
		DATE -	REVISIED -		SCALE:	SHEET	OF	SHEETS	STA.	TO	STA.		

REMOVAL ITEMS AND PATCHES

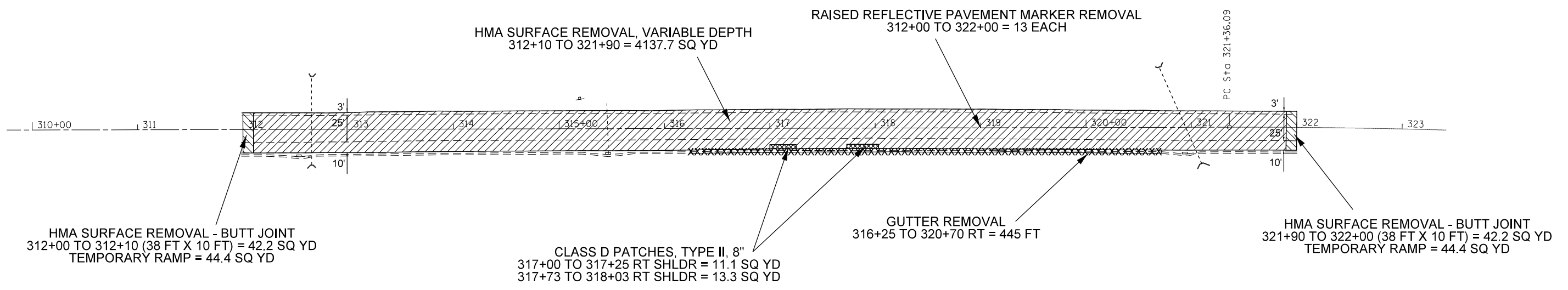
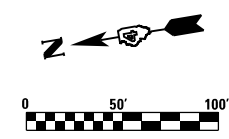

EROSION CONTROL AND PAVEMENT MARKINGS

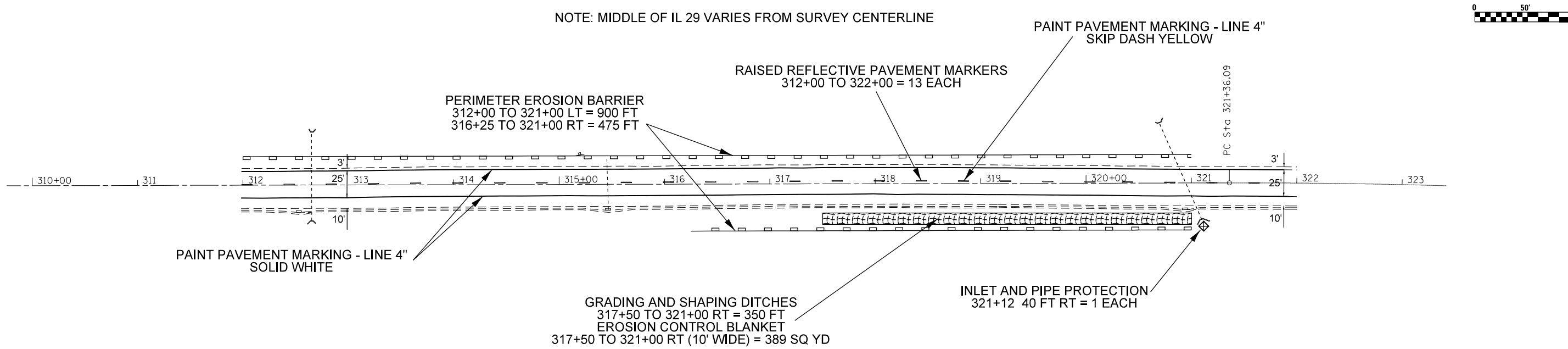
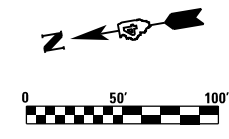

MODEL: 140DELENAME
FILE NAME: 311E5

USER NAME = \$USERS	DESIGNED -	REVISED -
	DRAWN -	REVISED -
PLOT SCALE = \$SCALE\$	CHECKED -	REVISED -
PLOT DATE = \$DATE\$	DATE -	REVISED -

**STATE OF ILLINOIS
DEPARTMENT OF TRANSPORTATION**

**REMOVAL ITEMS, PATCHES,
EROS CONTROL & PAVT MARKINGS**

SCALE: SHEET OF SHEETS STA. TO STA.

F.A.P. RTE.	SECTION	COUNTY	TOTAL SHEETS	SHEET NO.
318	(S)-1,DR	MARSHALL	27	11
CONTRACT NO. 68E55				
ILLINOIS FED. AID PROJECT				

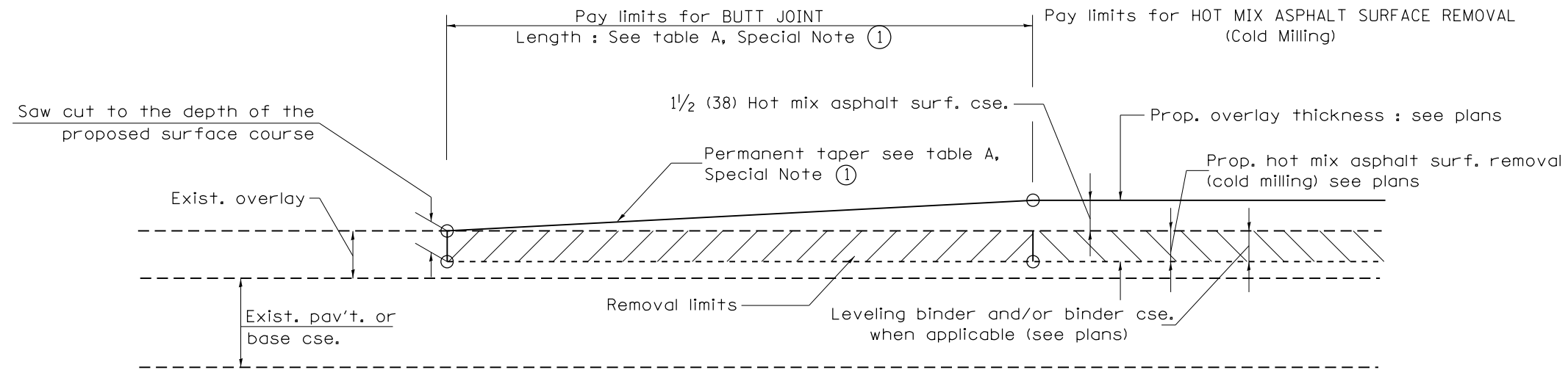

CASE 1 : WITH HOT MIX ASPHALT SURFACE REMOVAL (COLD MILLING)

**TABLE A
TAPER RATES**

SPECIAL NOTE NUMBER	ELEMENT	MAINLINE INTERSTATES & 4-LANE EXPRESSWAYS	ALL OTHERS
①	BUTT JOINT TAPER RATE	1:480	1:240
②	TEMPORARY RAMP TAPER RATE	1:80	1:40

GENERAL NOTES

1. The work shall be done in accordance with Article 406.08 and the Special Provision for Butt Joints.
2. The pavement surface to be removed may be either bituminous or P.C. concrete. The work shall be performed in accordance with Article 440.04 and the Special Provisions for Butt Joints.
3. The saw cut joints shall be primed just prior to the placing of bituminous material. The work will be in accordance with the applicable portions of Article 406.05.
4. The length of butt joint is based on the taper rate times change in cold milling depth within the butt joint pay limits, unless otherwise indicated.
5. Temporary ramps are paid for separately and not included in the cost of the butt joints.

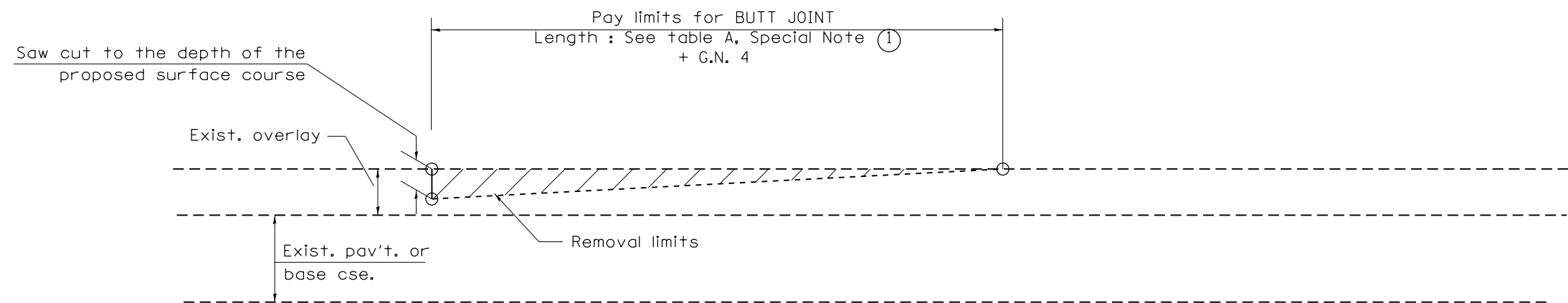

CASE 2 : NO HOT MIX ASPHALT SURFACE REMOVAL (COLD MILLING)

All dimensions are in inches (millimeters) unless otherwise noted.

01-01-97	RENUM. C-23.01, NEW REVISION BOX	T.P.	08-21-13	MAJOR MODIFICATIONS	R.D.	STATE OF ILLINOIS DEPARTMENT OF TRANSPORTATION	BUTT JOINTS	SHT. 1 OF 3 CADD STD. 406101-D4	F.A.P. 318	SECTION	COUNTY	TOTAL SHEETS	SHEET NO.
04-01-97	CORRECTION TO DEPTH	J.A.	02-29-16	MINOR CORRECTIONS	R.D.				(3)-1,DR	MARSHAL	27	12	
09-15-05	REVISED DESIGNER NOTE	M.M.A.	04-12-16	MINOR CORRECTIONS	R.D.				RT. IL 29	CONTRACT NO. 68E55			
10-16-06	REVISED TO 2007 SPEC.	M.A.	02-14-17	ADDED NOTE 5	R.D.				FED. ROAD DIST. NO.	ILLINOIS	FED. AID PROJECT		

NOT TO SCALE

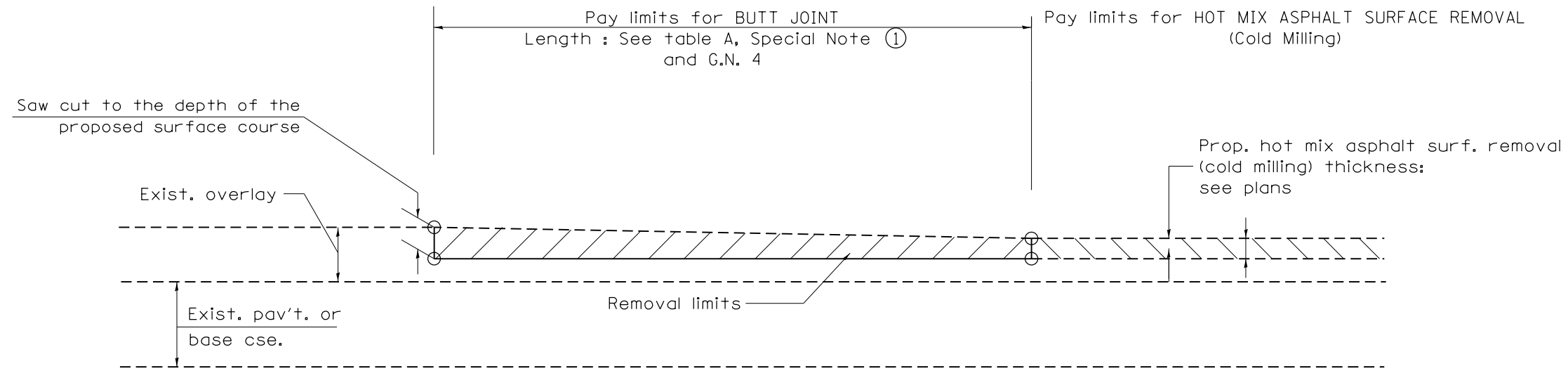

CASE 3 : HOT MIX ASPHALT SURFACE REMOVAL (COLD MILLING)
TIE-IN TO EXISTING BITUMINOUS TAPER

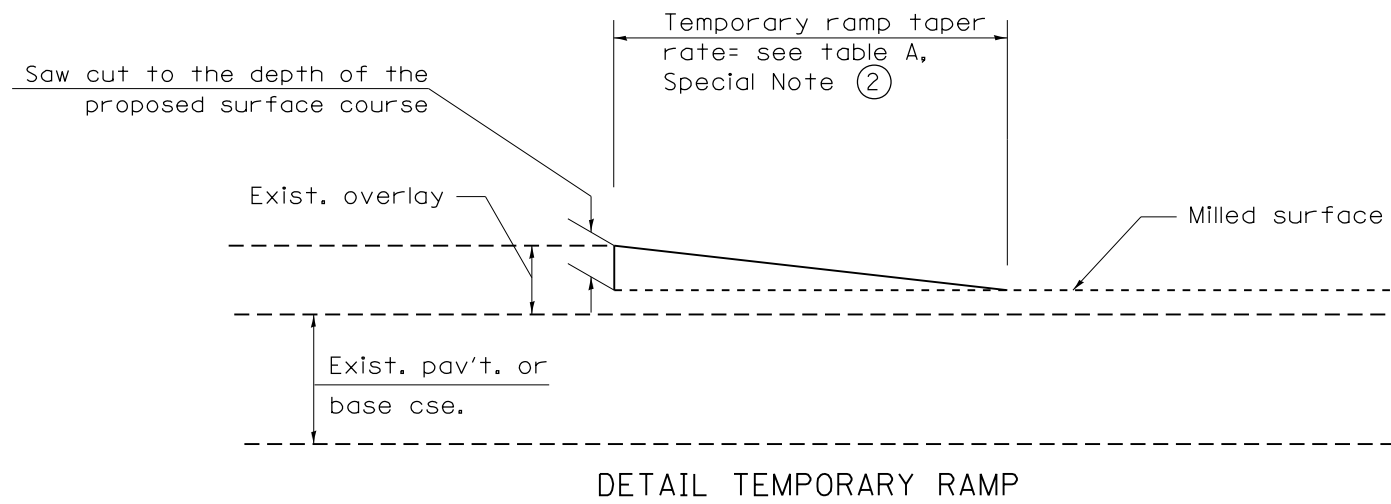

All dimensions are in inches (millimeters) unless otherwise noted.

				STATE OF ILLINOIS DEPARTMENT OF TRANSPORTATION		BUTT JOINTS		SHT. 2 OF 3 CADD STD. 406101-D4	
				NOT TO SCALE				F.A.P. 318	
								SECTION (3)I-1,DR	
								COUNTY MARSHAL	
								TOTAL SHEETS 27	
								SHEET NO. 13	
								RTE. IL 29	
								CONTRACT NO. 68E55	
								FED. ROAD DIST. NO. ILLINOIS FED. AID PROJECT	

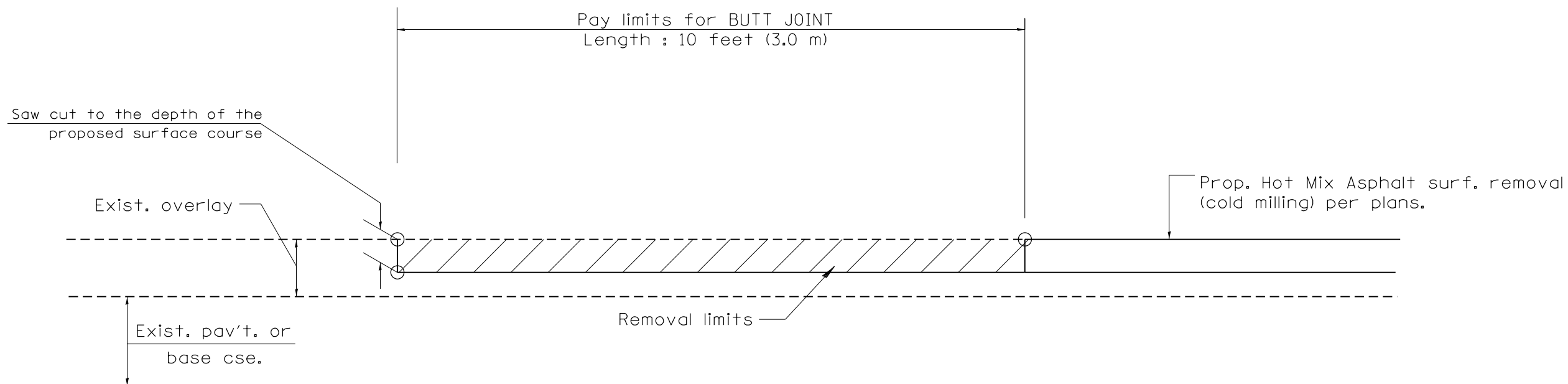

CASE 4 : SINGLE LIFT OVERLAY WITH EQUIVALENT DEPTH
HOT MIX ASPHALT SURFACE REMOVAL (COLD MILLING)
TIE-IN TO EXISTING BITUMINOUS TAPER

All dimensions are in inches (millimeters) unless otherwise noted.

				STATE OF ILLINOIS DEPARTMENT OF TRANSPORTATION		BUTT JOINTS		SHT. 3 OF 3 CADD STD. 406101-D4		<table border="1"> <tr> <td>F.A.P 318</td> <td>SECTION (3)1-1,DR</td> <td>COUNTY MARSHAL</td> <td>TOTAL SHEETS 27</td> <td>SHEET NO. 14</td> </tr> <tr> <td colspan="2">RTE. IL 29</td> <td colspan="3">CONTRACT NO. 68E55</td> </tr> <tr> <td colspan="2">FED. ROAD DIST. NO.</td> <td colspan="3">ILLINOIS FED. AID PROJECT</td> </tr> </table>		F.A.P 318	SECTION (3)1-1,DR	COUNTY MARSHAL	TOTAL SHEETS 27	SHEET NO. 14	RTE. IL 29		CONTRACT NO. 68E55			FED. ROAD DIST. NO.		ILLINOIS FED. AID PROJECT		
F.A.P 318	SECTION (3)1-1,DR	COUNTY MARSHAL	TOTAL SHEETS 27	SHEET NO. 14																						
RTE. IL 29		CONTRACT NO. 68E55																								
FED. ROAD DIST. NO.		ILLINOIS FED. AID PROJECT																								
NOT TO SCALE																										

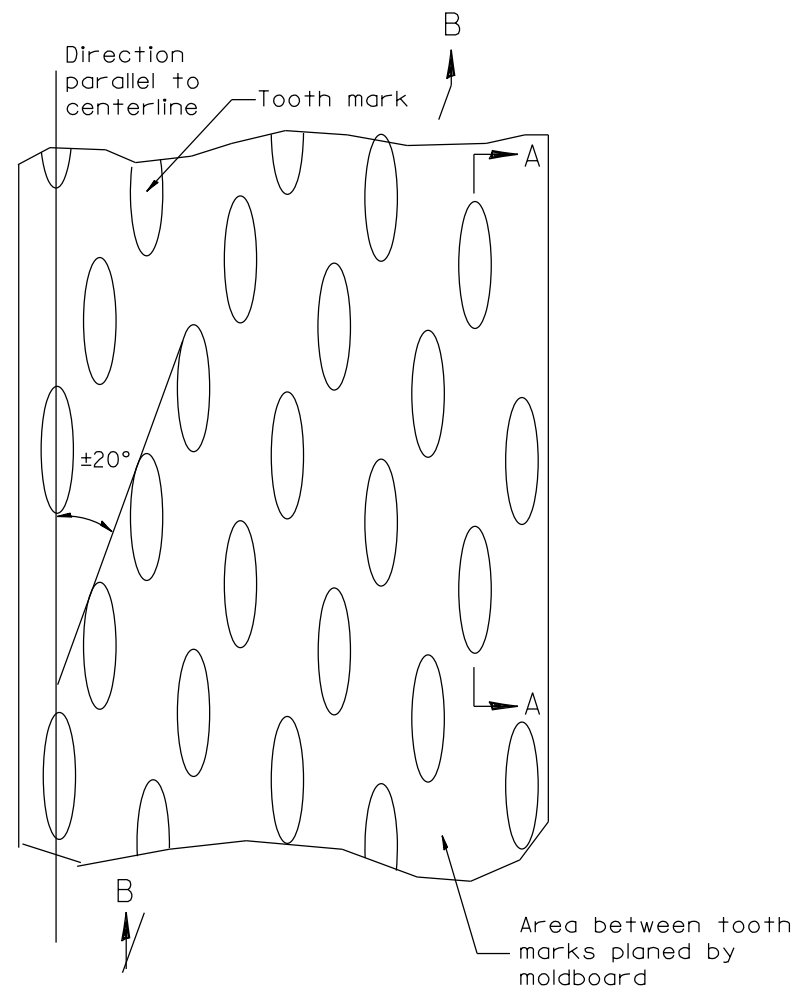

PLAN

General notes:

1. Coldmilling shall consist of two processes: Cutting with carbide teeth mounted on a rotating drum, and planing with a moldboard mounted immediately behind the cutting drum.
2. Other similar patterns will be acceptable if they consist of a smooth, flat, planed surface interspersed with a pattern of discontinuous longitudinal striations.

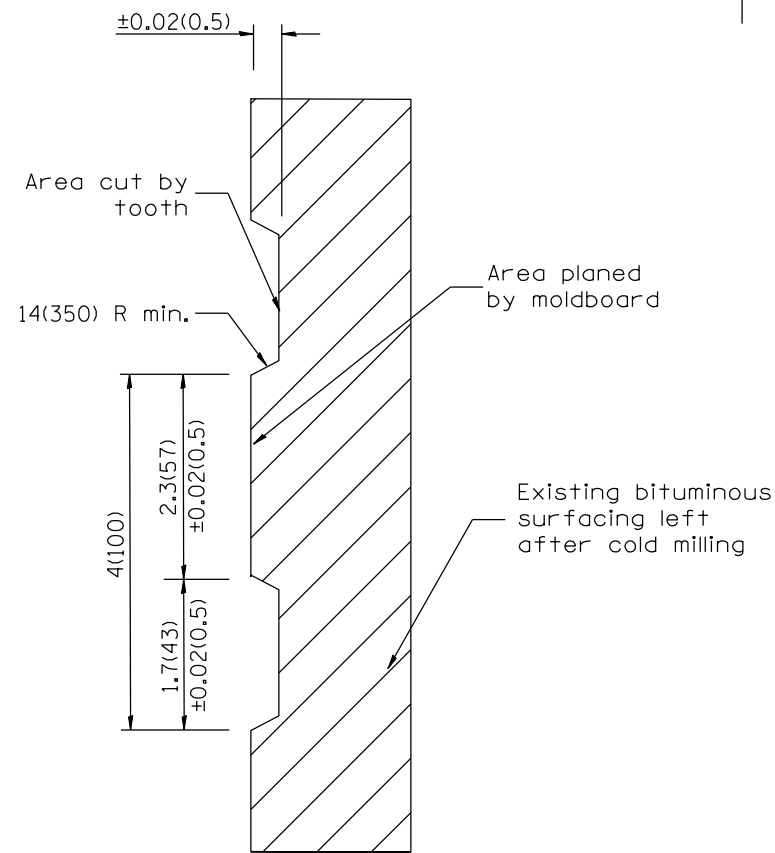

SECTION A-A

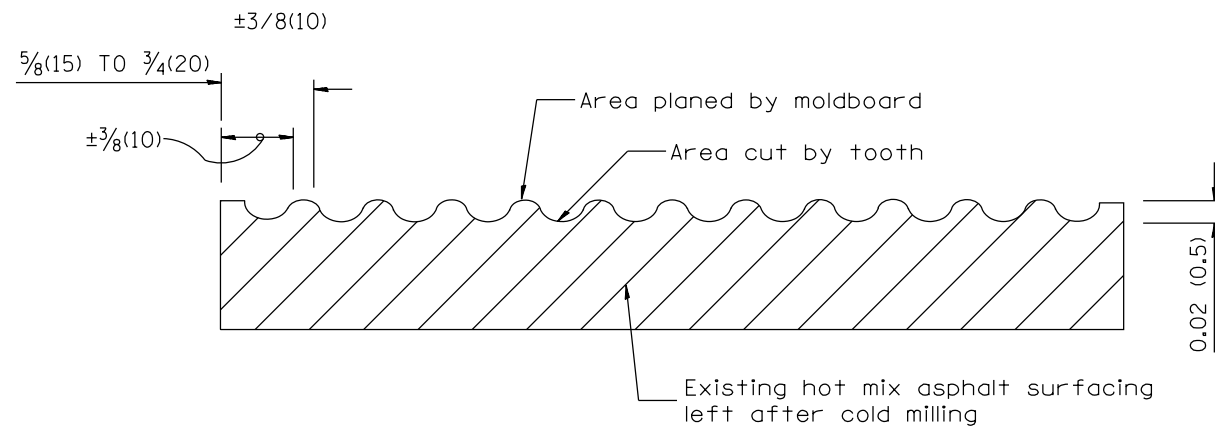

SECTION B-B PROJECTED
PERPENDICULAR TO CENTERLINE

DESIGNER NOTES:
1. INCLUDE DISTRICT SPECIAL PROVISION, IF APPLICABLE.

All dimensions are in inches (millimeters) unless otherwise noted.

01-01-97	RENUM. C-104.01, NEW REVISION BOX	T.P.
04-20-98	REMOVED MILLING DETAIL FROM STANDARD	J.A.
09-08-98	CORRECT NOTE LEADER PLACEMENT	R.W.
10-16-06	REVISED TO 2007 SPEC.	M.A.

STATE OF ILLINOIS
DEPARTMENT OF TRANSPORTATION

HOT MIX ASPHALT SURFACE REMOVAL (COLD MILLING)

NOT TO SCALE

CADD STD. 440001-D4

F.A.P. 318	SECTION	COUNTY	TOTAL SHEETS	SHEET NO.
	(3)-1,DR	MARSHAL	27	15
RTE. IL 29	CONTRACT NO. 68E55			
FED. ROAD DIST. NO.	ILLINOIS	FED. AID PROJECT		

DESIGNER NOTES:
1. Include State Standard 780001 (Typical Pavement Markings)

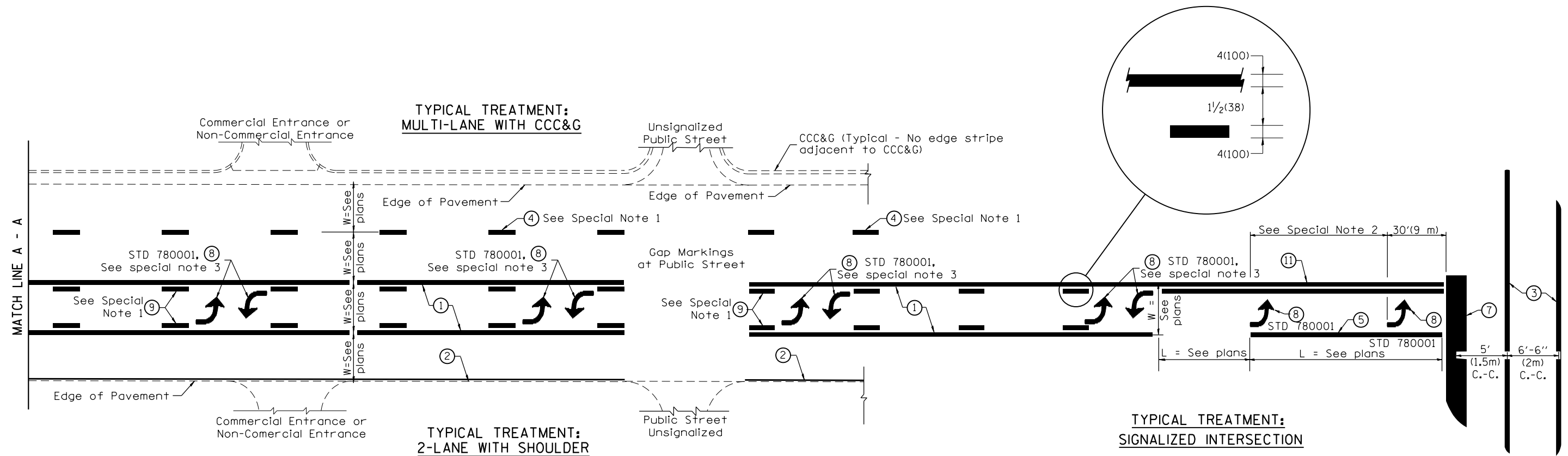

FLUSH PAVED MEDIAN: TWO-WAY LEFT TURN LANE WITH ONE-WAY LEFT TURN LANE AT SIGNALIZED INTERSECTION

TYPICAL PAVEMENT MARKING LEGEND

(Note: This is a District Standard Legend. Some elements may not apply to specific project.)

- ① 4(100) Solid (Yellow)
- ② 4(100) Solid (White)
- ③ 2-6(150) Crosswalk @ 6'-6" (2m)min C.-C. (White)
2-8(200) Crosswalk @ 6'-6" (2m)min C.-C. (White) (When traffic signals are present.)
- ④ 6(150) Skip-Dash (White) (See Special Note 1)
- ⑤ 8(200) Solid (White)
- ⑥ 12(300) Diagonal (White) (Item ⑥ is shown on Std. 780001)
- ⑦ 24(600) Stop Bar (White)
- ⑧ Letters & Arrows (See Std. 780001 and Special Notes 2 & 3)
- ⑨ 4(100) Skip-Dash (Yellow) (See Special Note 1)
- ⑩ 12(300) Diagonal (Yellow) (See Table A) ⑩
- ⑪ 4(100) Double Solid (Yellow) ⑪

SPECIAL NOTES

1. Skip-Dash markings will be centered between both ends of city blocks and shall be placed in alignment transversely across the pavement.
2. The following shall apply to arrows located in one-way left turn lanes:
 - A. A minimum of two (2) arrows is required.
 - B. The maximum spacing between arrows is 80' (24 m).
 - C. Arrows shall be evenly spaced if three (3) or more are required.
3. The following shall apply to arrow pairs located in two-way left turn lanes:
 - A. A minimum of two (2) arrow pairs is required.
 - B. The maximum spacing between arrow pairs is 200' (61 m).
 - C. Arrow pairs shall be evenly spaced if three (3) or more are required.
 - D. The spacing between Bi Directional Left Turn Arrows is 33' (10 m).

GENERAL NOTES

1. Refer to State Standard 780001 for additional Pavement Markings including letters & arrows.
2. See Plans for Pavement Markings adjacent to curbed islands and medians, and through lane reductions.
3. Refer to Article 780.13 for letter, number and symbol areas (sq. ft.)
4. Areas are grooved 1" beyond each edge for the following symbols:
 - Through Arrow= 14.8 sq. ft.
 - Large Left or Right Arrow= 21.9 sq. ft.
 - 2 Arrow Combination Left (or Right) and Through= 34.9 sq. ft.
 - Wrong Way Arrow= 29.5 sq. ft.
 - Railroad Crossing Symbol= 69.8 sq. ft.
 (For further information, refer to BDE Special Provision: Grooving for Recessed Pavement Markings)

01-01-97	RENUM. F-8.03, NEW REVISION BOX	T.P.	10-16-06	REVISED TO 2007 SPEC.	
02-07-97	ADD BI DIRECTIONAL DIMENSION	J.A.	2/29/16	ADDED GROOVING AREAS	R.D.
10-97	CORRECT BI DIRECTIONAL DIMENSION	J.A.			
08-02	ADD CROSSWALK DMNS. WITH T.S.	M.A.			

**STATE OF ILLINOIS
DEPARTMENT OF TRANSPORTATION**

NOT TO SCALE

TYPICAL PAVEMENT MARKINGS

SHT. 1 OF 2
CADD STD. 780001-D4

F.A.P 318	SECTION	COUNTY	TOTAL SHEETS	SHEET NO.
	(3)-1,DR	MARSHAL	27	16
RTE. IL 29		CONTRACT NO. 68E55		
FED. ROAD DIST. NO.		ILLINOIS FED. AID PROJECT		

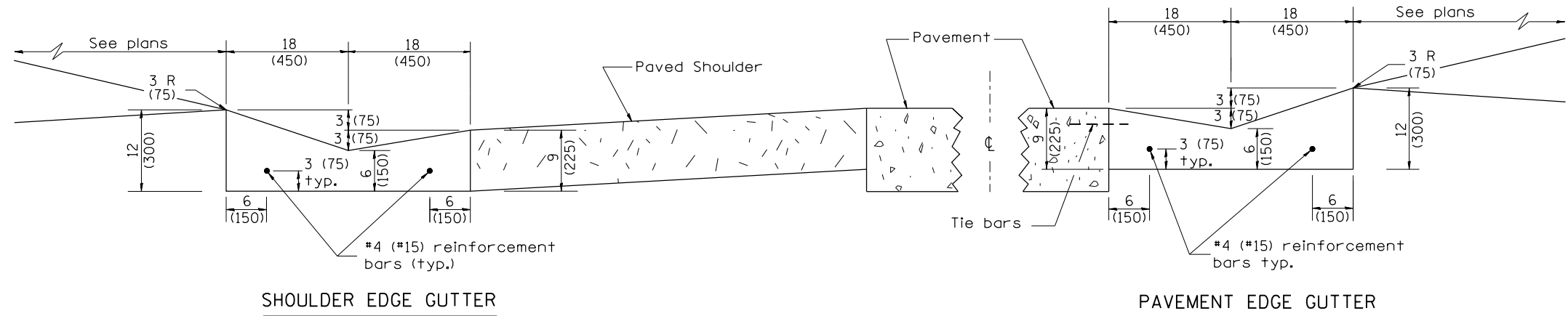

SHOULDER EDGE GUTTER

PAVEMENT EDGE GUTTER

CONCRETE GUTTER, TYPE A, (SPECIAL)

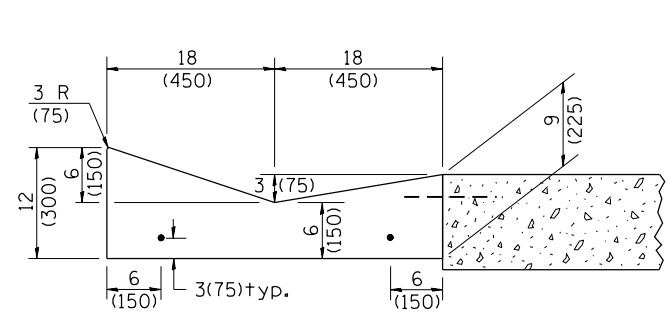

SECTION A-A

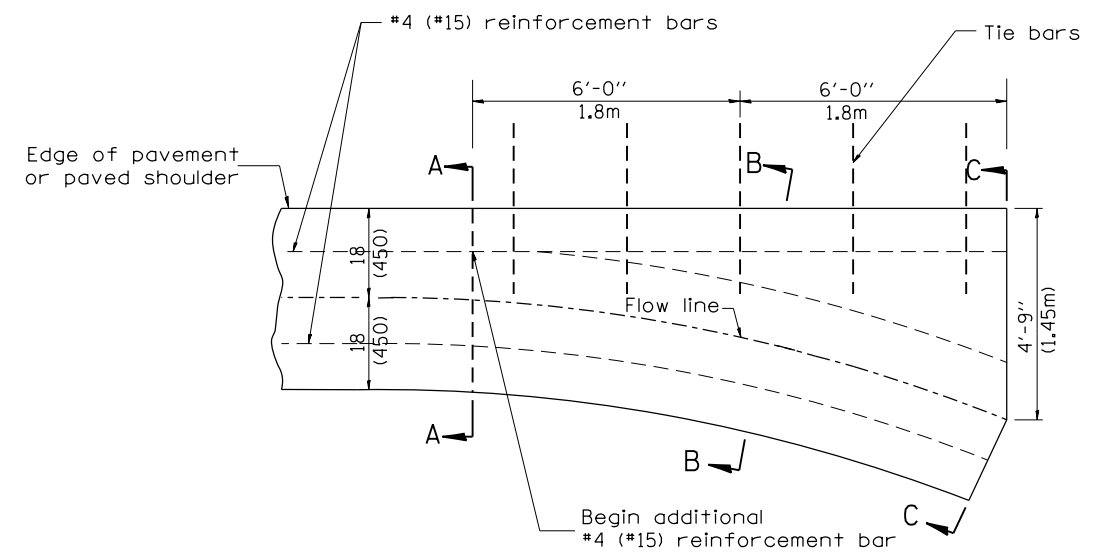

PLAN

QUANTITY
Section C-C to A-A= 1.2 cu. yd.
(0.92 m³) concrete.

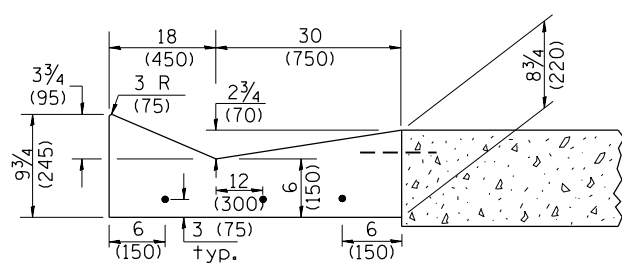

SECTION B-B

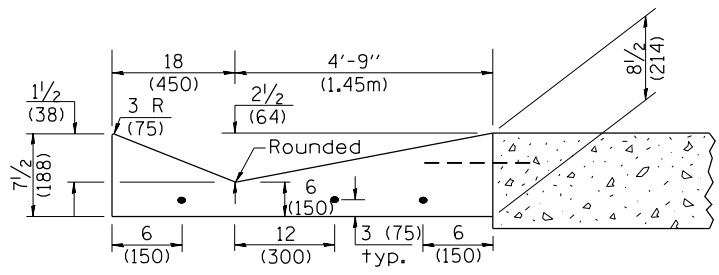

SECTION C-C

INLET

GENERAL NOTES:

1. CONCRETE GUTTER, TYPE A, (SPECIAL) shall conform to the applicable portions of Section 606.
2. Tie bars shall be No. 6x24 (No. 19x600) at 36" (900mm) centers unless otherwise shown.
3. Gutter, gutter inlets, gutter outlets, and gutter entrances shall be tied to rigid pavement in accordance with details shown on Standard 420001.
4. Joints shall be constructed in accordance with Article 606.06.
5. Welded wire fabric shall conform to Article 1006.10(c)(1), and shall not be less than 58 lbs/100 sq.ft. (2.83 kg/m²).

DESIGNER NOTES:
 1. INCLUDE STATE STANDARD 420001.
 2. PAY ITEM FOR INLETS, OUTLETS, AND ENTRANCES IS X6060097 CLASS SI CONCRETE (OUTLET), SPECIAL

QUANTITIES	
CALC. BY:	DATE:
CHECKED BY:	DATE:
QUANTITY CALCULATIONS ARE ON FILE AT THE DISTRICT 4 OFFICE; BUREAU OF PROJECT IMPLEMENTATION; DOCUMENTATION SECTION	

01-01-97	RENUM. A-1.02, NEW REVISION BOX, ELIMINATED	T.P.	01-10-07	REVISED QUANTITY	M.A.
	EXPANSION ANCHOR TIES		11-16-07	REVISED QUANTITY	M.A.
02-28-02	ENTRANCE TYPICALS REVISED	M.A.	02-15-11	CHANGED MODIFIED TO SPECIAL	R.D.
10-16-06	REVISED TO 2007 SPEC.	M.A.	01-31-18	REVISED TIE BAR SIZE & SPACING	R.D.

STATE OF ILLINOIS
DEPARTMENT OF TRANSPORTATION

CONCRETE GUTTER, TYPE A, (SPECIAL)
(INLET, OUTLET & ENTRANCE)

NOT TO SCALE

SHT. 1 OF 3
CADD STD. 606101-D4

All dimensions are in inches (millimeters) unless otherwise noted.

F.A.P.	SECTION	COUNTY	TOTAL SHEETS	SHEET NO.
318	(3)I-1,DR	MARSHAL	27	18
RTE. IL 29			CONTRACT NO. 68E55	
FED. ROAD DIST. NO.			ILLINOIS FED. AID PROJECT	

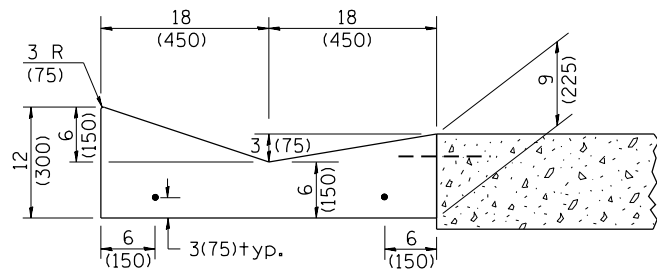

SECTION A-A

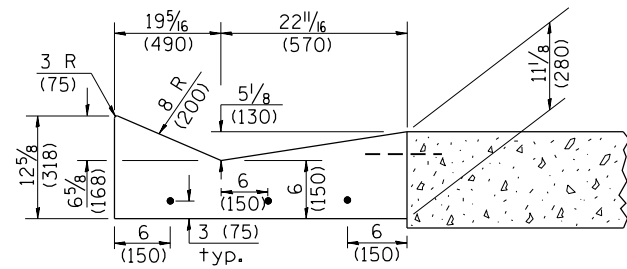

SECTION B-B

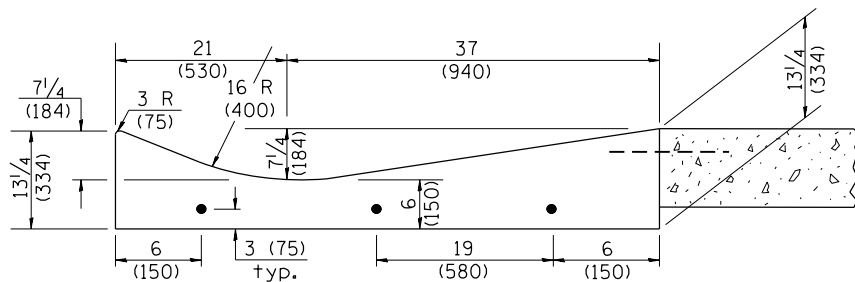

SECTION C-C

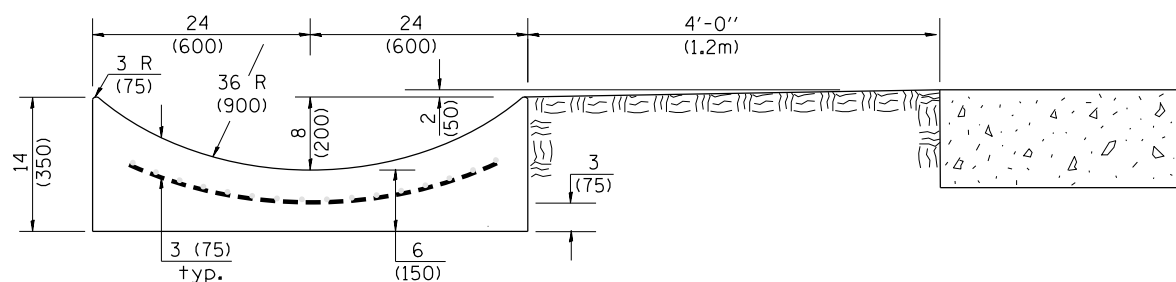

SECTION E-E

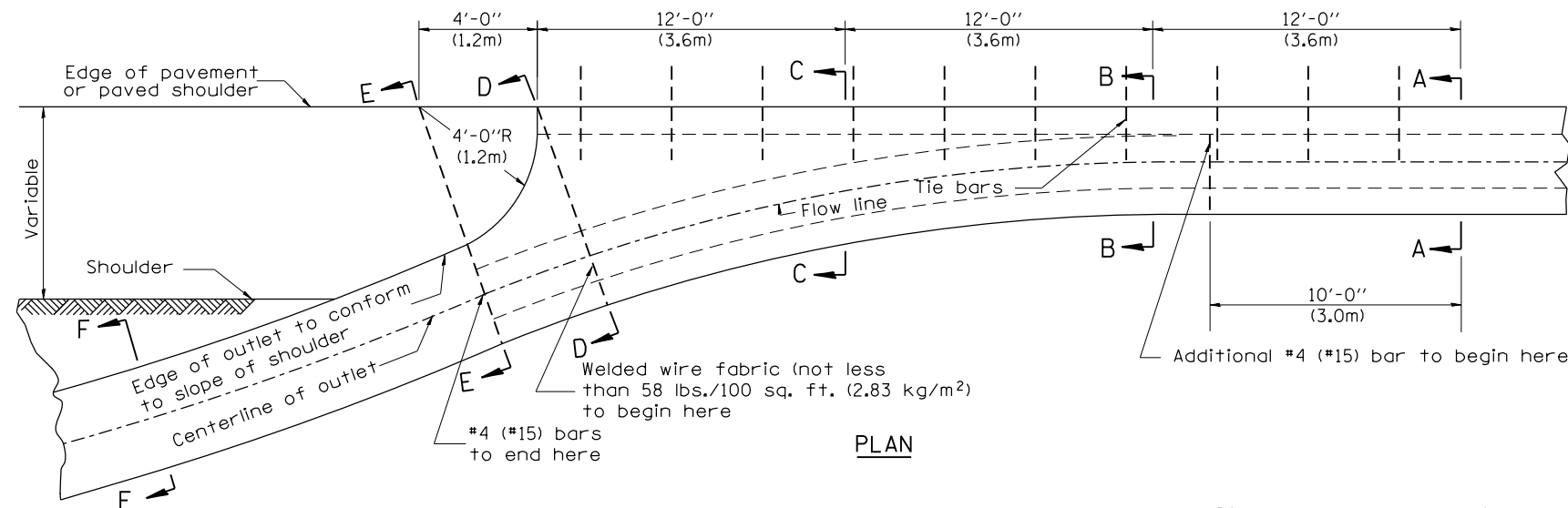

PLAN

QUANTITY
 Section A-A to E-E = 4.5 cu. yd. (3.36 m³) concrete.
 Section E-E to F-F = 0.10 cu. yd./ft. (0.26 m³/m) concrete.

If the average grade of pavement for the distance from section A-A to section D-D exceeds 2%, this distance shall be increased 6 ft. (1.8 m) for each 1% increase in grade. A quantity adjustment is required.

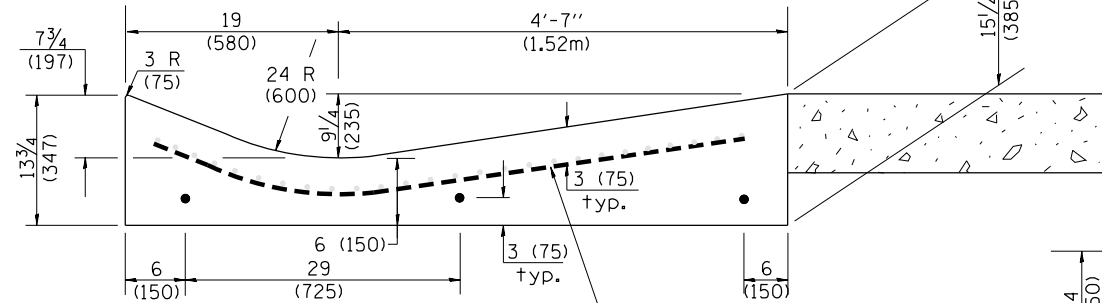

SECTION D-D

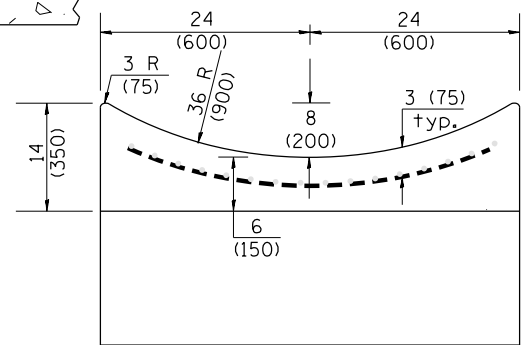

SECTION F-F

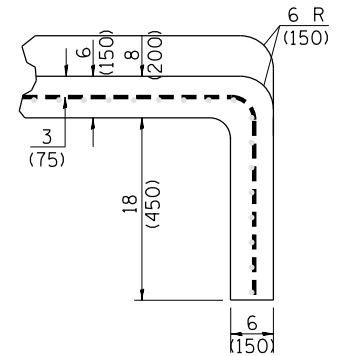

SECTIONS AT END OF OUTLET (CURTAIN WALL)

QUANTITY
 Curtain Wall = 0.1 cu. yd. (0.08 m³) concrete.

QUANTITIES
 CALC. BY: _____ DATE: _____
 CHECKED BY: _____ DATE: _____
 QUANTITY CALCULATIONS ARE ON FILE AT THE DISTRICT 4 OFFICE; BUREAU OF PROJECT IMPLEMENTATION; DOCUMENTATION SECTION

OUTLET

F.A.P. NO.	SECTION	COUNTY	TOTAL SHEETS	SHEET NO.
318	(3)-1,DR	MARSHAL	27	19
RTE. IL 29	CONTRACT NO. 68E55			
FED. ROAD DIST. NO.	ILLINOIS	FED. AID PROJECT		

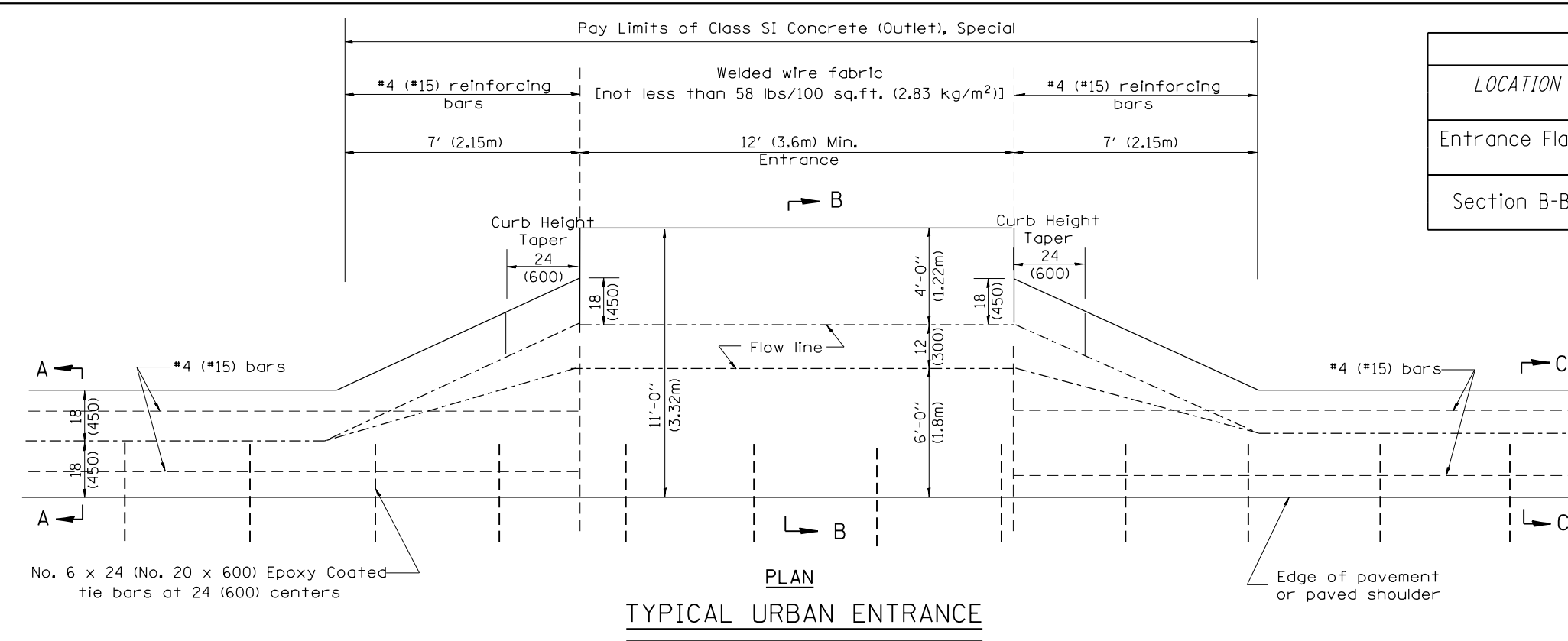

No. 6 x 24 (No. 20 x 600) Epoxy Coated tie bars at 24 (600) centers

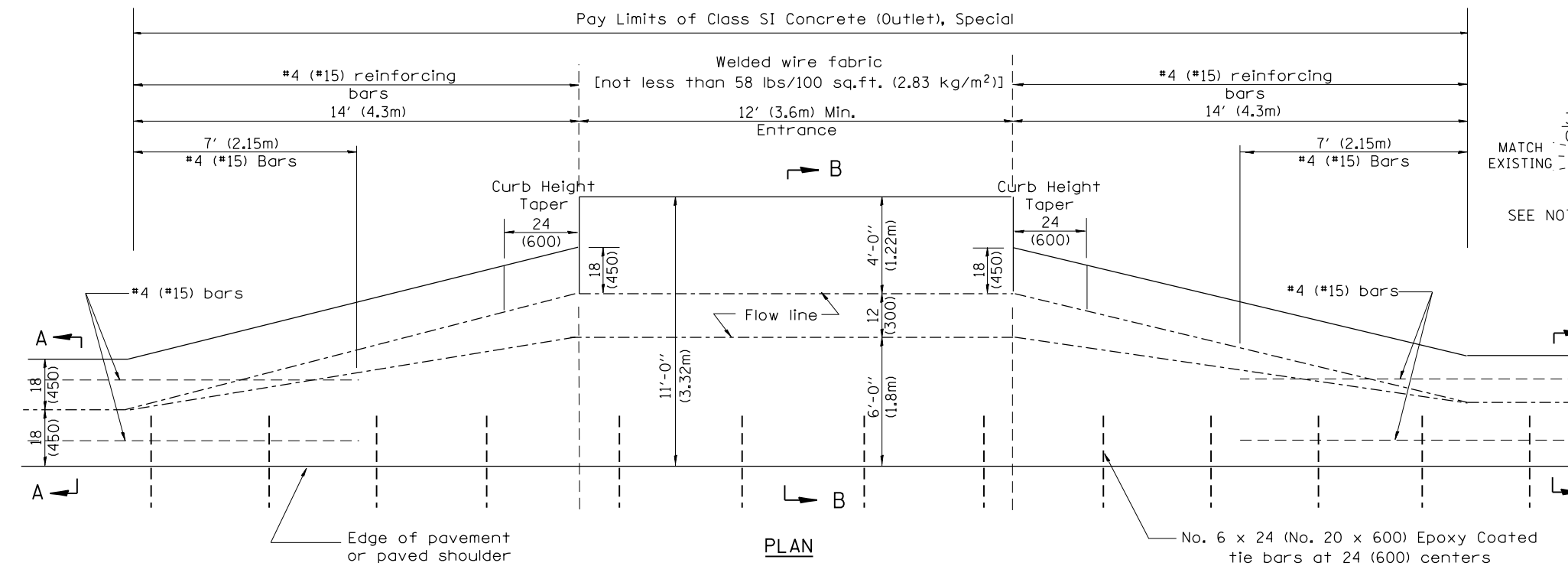

QUANTITIES

CALC. BY: _____ DATE: _____

CHECKED BY: _____ DATE: _____

QUANTITY CALCULATIONS ARE ON FILE AT THE DISTRICT 4 OFFICE; BUREAU OF PROJECT IMPLEMENTATION; DOCUMENTATION SECTION

QUANTITY CALCULATION			
LOCATION	LENGTH	NON-COMMERCIAL 6 (150)	COMMERCIAL ENTRANCE 8 (200)
Entrance Flare	7 Ft (2.15 m) Urban 14 Ft (4.30 m) Rural	0.15 Cu Yd / Ft (0.37 Cu M / M)	0.18 Cu Yd / Ft (0.45 Cu M / M)
Section B-B	See Plans	0.23 Cu Yd / Ft (0.57 Cu M / M)	0.28 Cu Yd / Ft (0.70 Cu M / M)

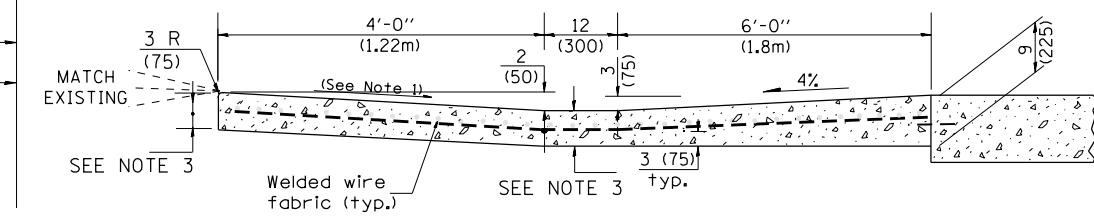
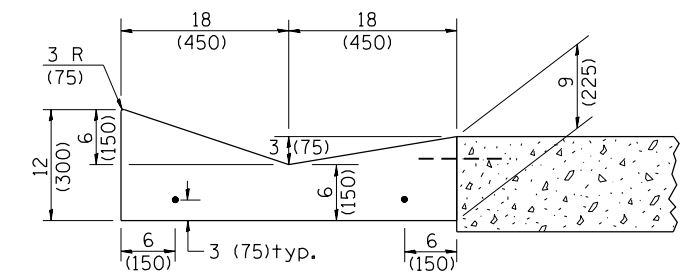

- GENERAL NOTES**
- Slope may be increased from 4% (min.) to 6% (max.) in order to match the existing.
 - The cross-slope is to be constructed as given in the plans from back turnout to where driveway matches existing.
 - For Non-Commercial Entrances the driveway thickness shall be 6 (150). For Commercial Entrances the driveway thickness shall be 8 (200).

All dimensions are in inches (millimeters) unless otherwise noted.

STATE OF ILLINOIS
DEPARTMENT OF TRANSPORTATION

CONCRETE GUTTER, TYPE A, (SPECIAL)
(INLET, OUTLET & ENTRANCE)

SHT. 3 OF 3
CADD STD. 606101-D4

F.A.P 318	SECTION	COUNTY	TOTAL SHEETS	SHEET NO.
	(3)-1,DR	MARSHAL	27	20
RTE. IL 29			CONTRACT NO. 68E55	
FED. ROAD DIST. NO.	ILLINOIS	FED. AID PROJECT		

NOT TO SCALE

DATE	
BY	
SURVEYED	
PLOTTED	
TEMPLATE	
AREAS CHECKED	
FINAL SURVEY NO.	
NOTE BOOK NO.	
AREAS CHECKED	

DATE	
BY	
SURVEYED	
PLOTTED	
TEMPLATE	
AREAS CHECKED	
ORIGINAL SURVEY NO.	
NOTE BOOK NO.	
AREAS CHECKED	

MODEL: Defnair
 FILE NAME: D:\ILLINOIS\BID\INT\ILLINOIS\pwp\DOT Documents\DOT Office\District 4\Projects\04_6808\CAD\Drawn\CADsheets\01ps Recovery_This.dgn

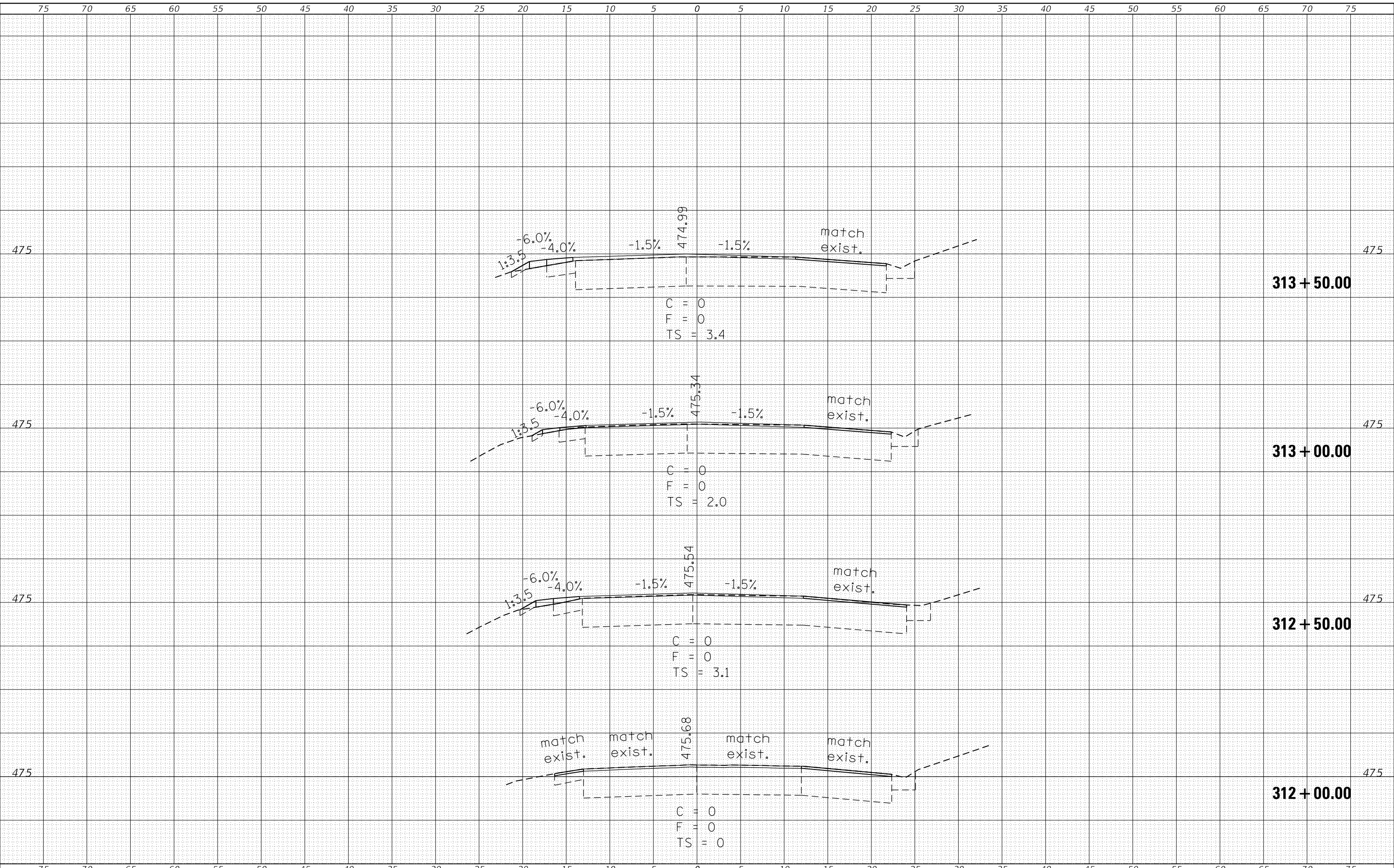

USER NAME = hudelsonme	DESIGNED -	REVISED -
	DRAWN -	REVISED -
PLOT SCALE = 10.0000 ' / in.	CHECKED -	REVISED -
PLOT DATE = 5/17/2018	DATE -	REVISED -

**STATE OF ILLINOIS
DEPARTMENT OF TRANSPORTATION**

SCALE: SHEET OF SHEETS STA. 312+00.00 TO STA. 313+50.00

F.A.P. RTE.	SECTION	COUNTY	TOTAL SHEETS	SHEET NO.
318	(3)-1,DR	MARSHALL	27	21
CONTRACT NO. 68E55				
ILLINOIS FED. AID PROJECT				

DATE	
BY	
SURVEYED	
PLOTTED	
TEMPLATE	
NOTE BOOK	
AREAS CHECKED	
NO.	

DATE	
BY	
SURVEYED	
PLOTTED	
TEMPLATE	
NOTE BOOK	
AREAS CHECKED	
NO.	

MODEL: Defaulr
 FILE NAME: D:\ILLINOIS\EBID\NTC\Illinois\pwp\DOT Documents\DOT Office\District 4\Projects\04_6808\CAD\Drawn\CADsheets\Dis Recovery_This.dgn

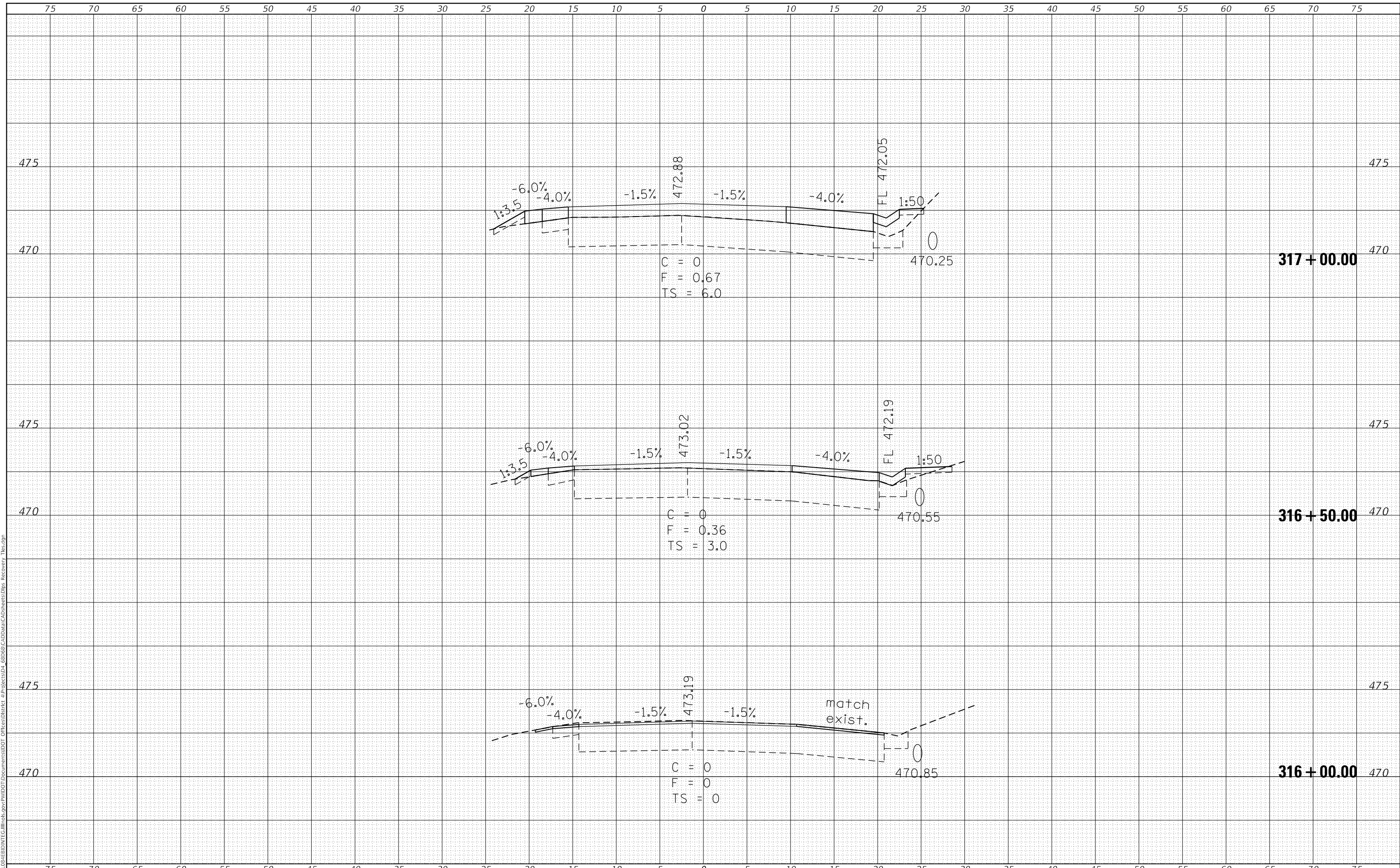

USER NAME = hudelsonme	DESIGNED -	REVISED -
	DRAWN -	REVISED -
PLOT SCALE = 10.0000' / in.	CHECKED -	REVISED -
PLOT DATE = 5/17/2018	DATE -	REVISED -

**STATE OF ILLINOIS
 DEPARTMENT OF TRANSPORTATION**

SCALE: SHEET OF SHEETS STA. 316+00.00 TO STA. 317+00.00

F.A.P. RTE.	SECTION	COUNTY	TOTAL SHEETS	SHEET NO.
318	(3)-1,DR	MARSHALL	27	23
CONTRACT NO. 68E55				
ILLINOIS FED. AID PROJECT				

DATE	
BY	
FINAL SURVEY NO.	
SURVEYED PLOTTED TEMPLATE AREAS CHECKED	

DATE	
BY	
ORIGINAL SURVEY NO.	
SURVEYED PLOTTED TEMPLATE AREAS CHECKED	

MODEL: Defaul
 FILE NAME: D:\ILLINOIS\BID\INT\Ca Illinois\pwp\DOT Documents\DOT Office\District 4\Projects\04_68E55\CAD\Drawn\CADsheets\03\Recovery_This.dgn

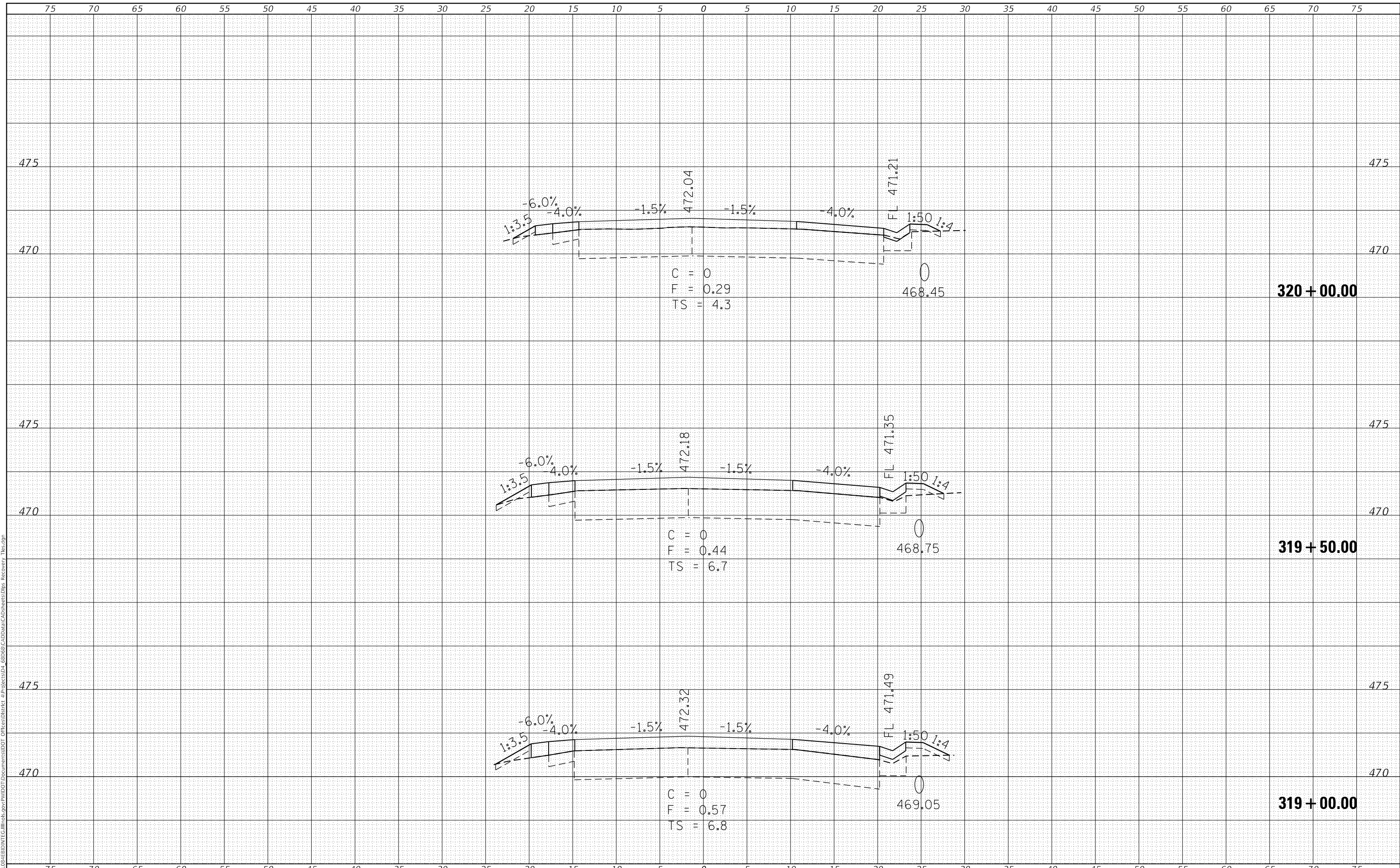

USER NAME = hudelsonme	DESIGNED -	REVISED -
	DRAWN -	REVISED -
PLOT SCALE = 10.0000' / in.	CHECKED -	REVISED -
PLOT DATE = 5/17/2018	DATE -	REVISED -

**STATE OF ILLINOIS
 DEPARTMENT OF TRANSPORTATION**

SCALE: SHEET OF SHEETS STA. 319+00.00 TO STA. 320+00.00

F.A.P. RTE.	SECTION	COUNTY	TOTAL SHEETS	SHEET NO.
318	(3)-1,DR	MARSHALL	27	25
CONTRACT NO. 68E55				
ILLINOIS FED. AID PROJECT				

DATE	
BY	
FINAL SURVEY	SURVEYED
NOTE BOOK	PLOTTED
NO.	TEMPLATE
	AREAS CHECKED

DATE	
BY	
ORIGINAL SURVEY	SURVEYED
NOTE BOOK	PLOTTED
NO.	TEMPLATE
	AREAS CHECKED

MODEL: Defnair
 FILE NAME: D:\ILLINOIS\BID\INTC\Illinois\pwp\DOT Documents\DOT Office\District 4\Projects\04_68058\CAD\Drawn\CADsheets\04\Recovery_This.dgn

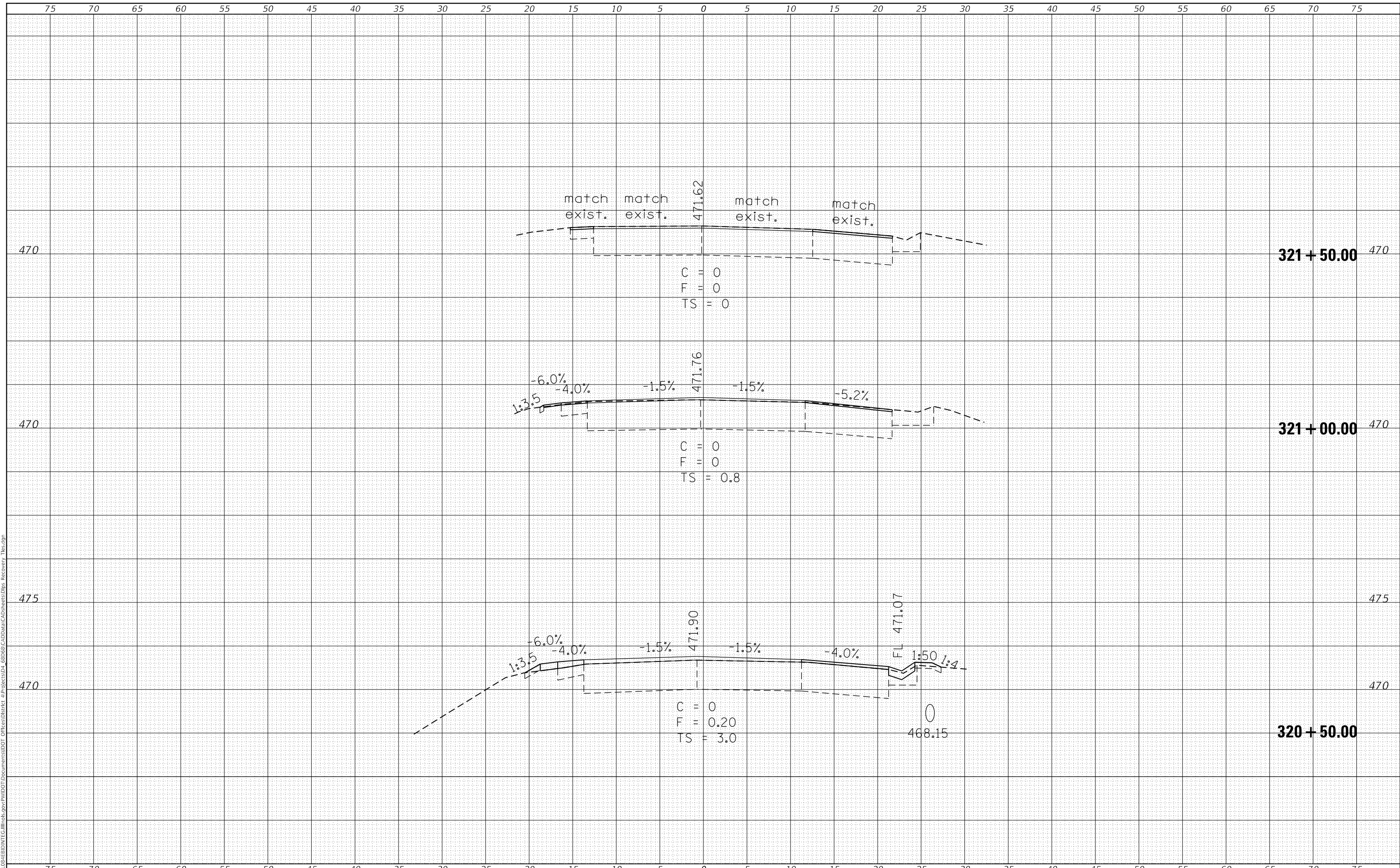

USER NAME = hudelsonme	DESIGNED -	REVISED -
	DRAWN -	REVISED -
PLOT SCALE = 10.0000' / in.	CHECKED -	REVISED -
PLOT DATE = 5/17/2018	DATE -	REVISED -

**STATE OF ILLINOIS
 DEPARTMENT OF TRANSPORTATION**

SCALE: SHEET OF SHEETS STA. 320+50.00 TO STA. 321+50.00

F.A.P. RTE.	SECTION	COUNTY	TOTAL SHEETS	SHEET NO.
318	(3)-1,DR	MARSHALL	27	26
CONTRACT NO. 68E55				
ILLINOIS FED. AID PROJECT				

75 70 65 60 55 50 45 40 35 30 25 20 15 10 5 0 5 10 15 20 25 30 35 40 45 50 55 60 65 70 75

FINAL SURVEY NO.	SURVEYED PLOTTED AREAS CHECKED	BY	DATE
NOTE BOOK	TEMPLATE		

ORIGINAL SURVEY NO.	SURVEYED PLOTTED AREAS CHECKED	BY	DATE
NOTE BOOK	TEMPLATE		

MODEL: Defnair
FILE NAME: D:\ILLINOIS\BIDDING\Illinois\pwp\WIDOT\Documents\DOT Office\District 4\Projects\04_68088\CAD\Drawn\CADsheets\04is Recovery_This.dgn

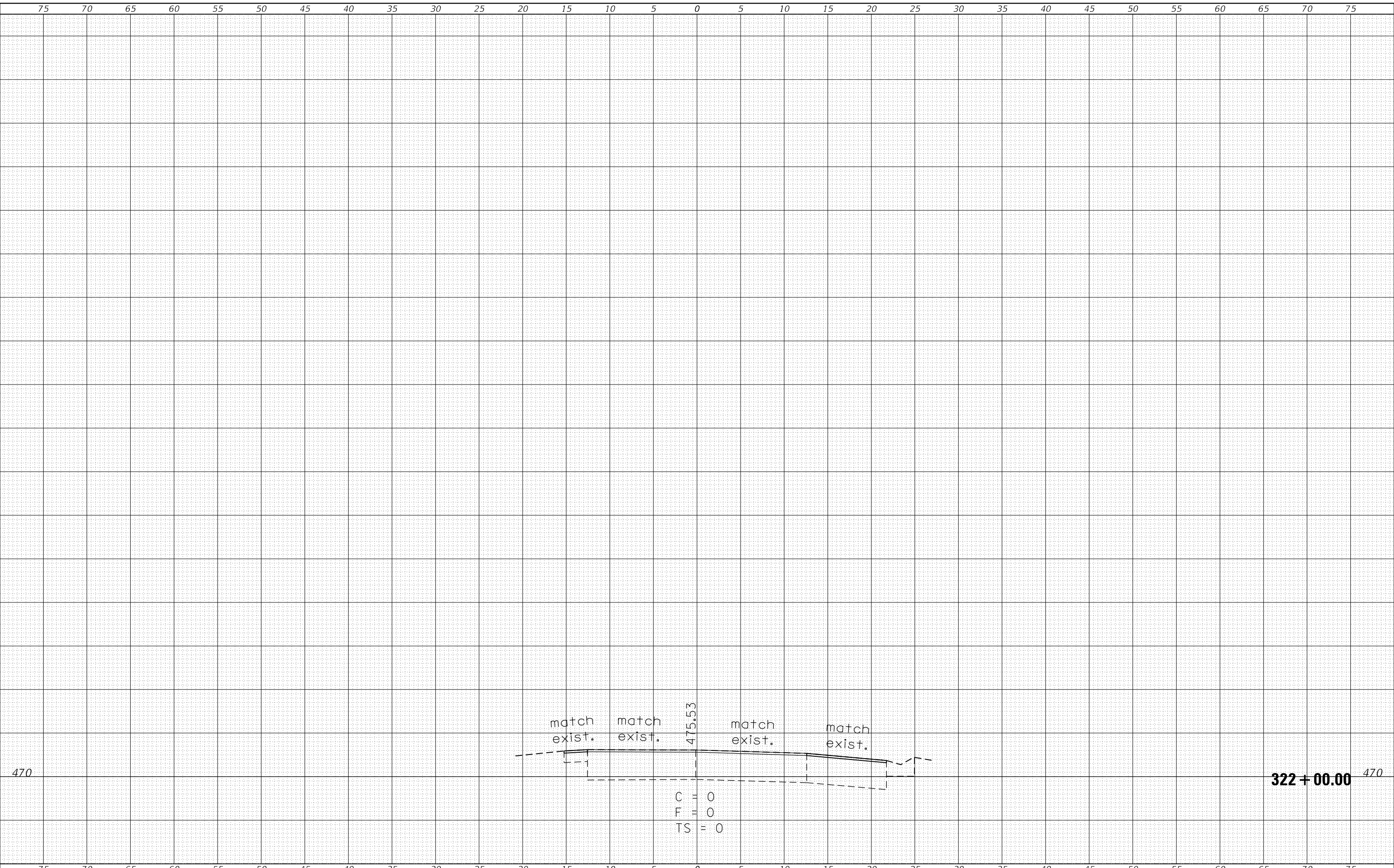

USER NAME = hudelsonme	DESIGNED -	REVISED -
PLOT SCALE = 10.0000 ' / in.	DRAWN -	REVISED -
PLOT DATE = 5/17/2018	CHECKED -	REVISED -
	DATE -	REVISED -

**STATE OF ILLINOIS
DEPARTMENT OF TRANSPORTATION**

SCALE: SHEET OF SHEETS STA. 322+00.00 TO STA. 322+00.00

F.A.P. RTE.	SECTION	COUNTY	TOTAL SHEETS	SHEET NO.
318	(3)-1,DR	MARSHALL	27	27
CONTRACT NO. 68E55				
ILLINOIS FED. AID PROJECT				