

STATE OF ILLINOIS
DEPARTMENT OF TRANSPORTATION

F.A.U. RTE.	SECTION	COUNTY	TOTAL SHEETS	SHEET NO.
5952	(Q)C	GRUNDY	9	1
		ILLINOIS	CONTRACT NO. 66F68	

INDEX OF SHEETS

1	COVER SHEET
2	GENERAL NOTES AND COMMITMENTS
3-4	SUMMARY OF QUANTITIES
5	TYPICAL SECTIONS
6	SCHEDULES
7	PLAN SHEET
8-9	CLASS B PATCHING DETAILS

STANDARDS

000001-06	STANDARD SYMBOLS, ABBREVIATIONS AND PATTERNS
001001-02	AREAS OF REINFORCEMENT BARS
001006	DECIMAL OF AN INCH AND OF A FOOT
202001-01	EARTH MEDIAN DITCH CHECK
280001-07	TEMPORARY EROSION CONTROL SYSTEMS
442101-07	CLASS B PATCHES
542306-03	PRECAST REINFORCED CONCRETE ELLIPTICAL FLARED END SECTION
701001-02	OFF-ROAD OPERATIONS 2L, 2W, MORE THAN 15' (4.5 m) AWAY
701006-05	OFF-ROAD OPERATIONS 2L, 2W, 15' (4.5 m) TO 24" (600 mm) FROM PAVEMENT EDGE
701201-04	LANE CLOSURE, 2L, 2W, DAY ONLY, FOR SPEEDS ≥ 45 MPH
701206-03	LANE CLOSURE, 2L, 2W, NIGHT ONLY, FOR SPEEDS ≥ 45 MPH
701301-04	LANE CLOSURE, 2L, 2W, SHORT TIME OPERATIONS
701901-06	TRAFFIC CONTROL DEVICES

**PROPOSED
HIGHWAY PLANS**

F.A.U. 5952 (US 6)

SECTION (Q)C

CULVERT REMOVAL AND REPLACEMENT

GRUNDY

C-93-107-16

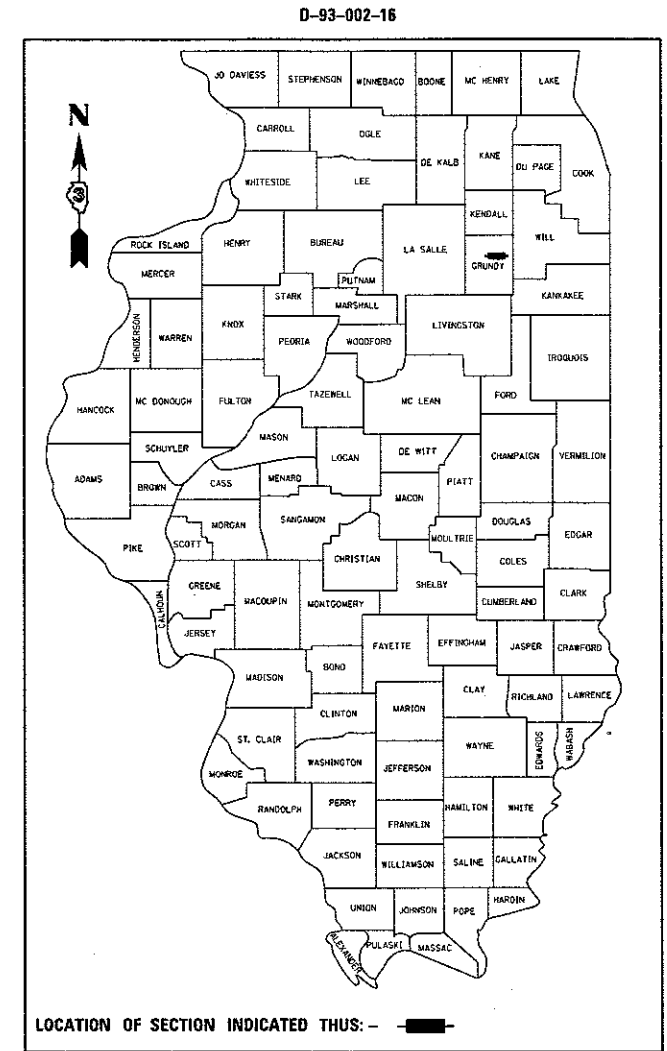

LOCATION OF SECTION INDICATED THIS: - [Black Rectangle] -

FUNCTIONAL CLASSIFICATION

URBAN - MINOR ARTERIAL
F.A.U. 5952 (US 6)
ADT YR. 2015
P.V. 77.37% S.U. 18.42% M.U. 4.21%

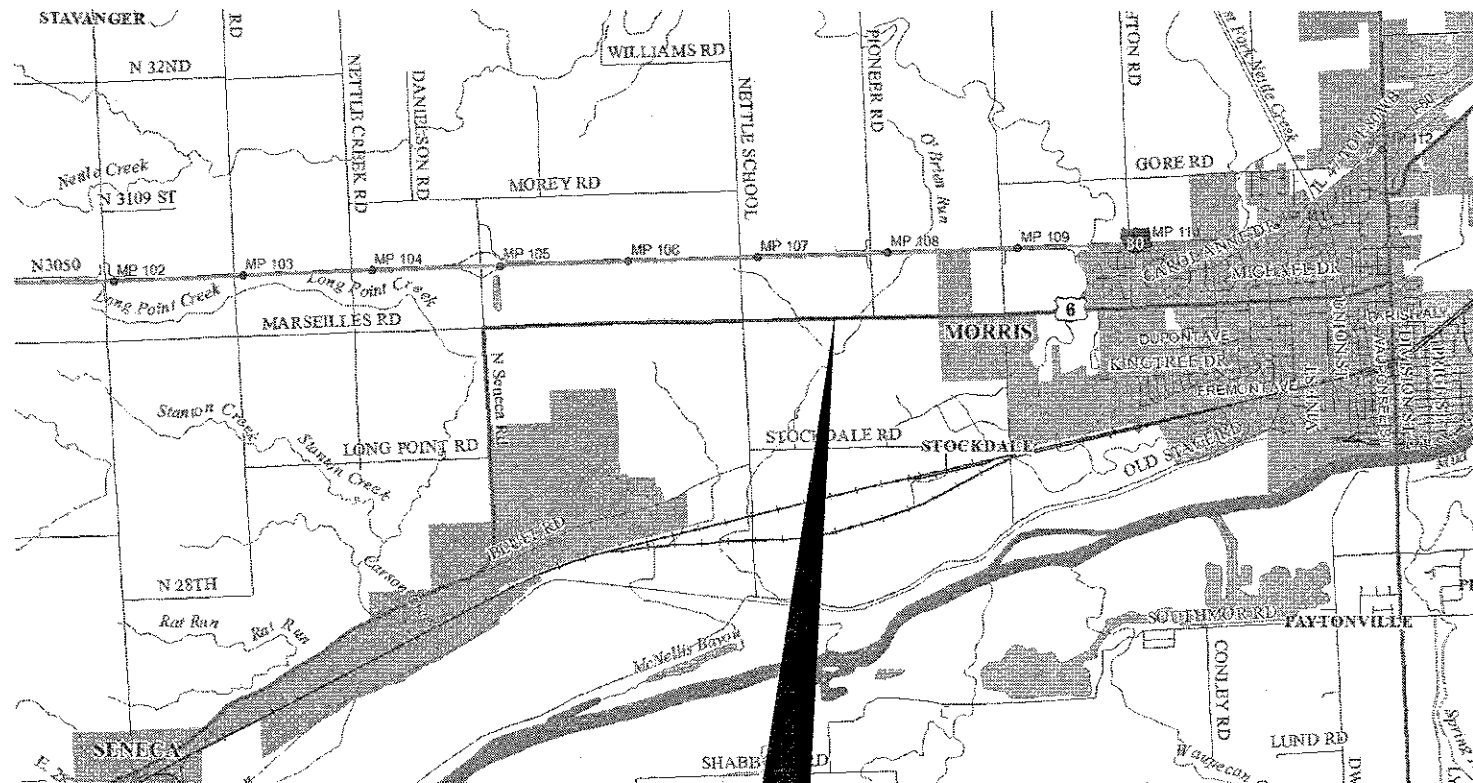

POINT LOCATION

PROJECT LOCATION

FAU 5952 (US 6)
2.80 MILES (STA. 873+57) EAST OF SENECA RD.

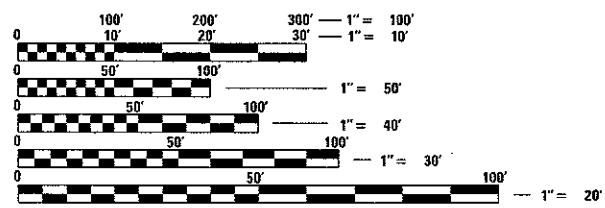

FULL SIZE PLANS HAVE BEEN PREPARED USING STANDARD ENGINEERING SCALES. REDUCED SIZED PLANS WILL NOT CONFORM TO STANDARD SCALES. IN MAKING MEASUREMENTS ON REDUCED PLANS, THE ABOVE SCALES MAY BE USED.

J.U.L.I.E.
JOINT UTILITY LOCATION INFORMATION FOR EXCAVATION
1-800-892-0123
OR 811

DISTRICT NO. 3 (815) 434-6131
PROJECT ENGINEER: JOE KANNEL P.E.
UNIT CHIEF: RON WOODSHANK
CONTRACT NO. 66F68

STATE OF ILLINOIS
DEPARTMENT OF TRANSPORTATION

SUBMITTED May 23 2017
[Signature]
REGIONAL ENGINEER

June 30 2017
Maura M. Addis P.E.
ENGINEER OF DESIGN AND ENVIRONMENT

June 30 2017
[Signature]
DIRECTOR OF PROGRAM DEVELOPMENT

**PRINTED BY THE AUTHORITY
OF THE STATE OF ILLINOIS**

GENERAL NOTES

THE THICKNESS OF HMA SHOWN ON THE PLANS IS THE NOMINAL THICKNESS. DEVIATIONS FROM THE NOMINAL THICKNESS WILL BE PERMITTED WHEN SUCH DEVIATIONS OCCUR DUE TO IRREGULARITIES IN THE EXISTING SURFACE OR BASE ON WHICH THE HMA IS PLACED.

EXCEPT AS NOTED ON THE PLANS, PAVEMENT GRADES SHOWN ARE AT THE TOP OF PAVEMENT SURFACES.

BEFORE ORDERING PIPE CULVERTS OR PIPE DRAINS, THE CONTRACTOR SHALL CONSULT THE ENGINEER FOR EXACT LENGTHS.

THE ENGINEER WILL BE THE SOLE JUDGE CONCERNING CURING TIME FOR THE VARIOUS HMA LIFTS.

FOR STABILIZATION, ALL TYPE III BARRICADES WILL REQUIRE A MINIMUM OF FOUR SAND BAGS PER BARRICADE.

SEEDING WILL NOT BE PERMITTED AT ANY TIME WHEN THE GROUND IS FROZEN, WET, OR IN AN UNTILLABLE CONDITION. LOCATIONS TO BE SEEDED WILL BE DETERMINED BY THE ENGINEER.

THE FINISHED EARTHWORK SHALL HAVE A VEGETATION SUSTAINING SOIL COVERING THE TOP FOUR INCHES IN AREAS TO BE SEEDED OR SODDED. THE VEGETATION SUSTAINING SOIL REQUIRED WILL NOT BE PAID FOR SEPARATELY BUT WILL BE INCLUDED IN THE COST OF FURNISHED EXCAVATION.

ON EXISTING PAVEMENT WHICH MAY BE SUPERELEVATED, THE NEW HMA PAVEMENT SHALL BE BUILT WITH THE SAME SUPERELEVATION UNLESS NEW SUPERELEVATION RATES ARE GIVEN ON THE PLANS.

ALL ELEVATIONS REFERRING TO U.S.G.S. MEAN SEA LEVEL DATUM.

ABANDONED UNDERGROUND UTILITIES THAT CONFLICT WITH CONSTRUCTION SHALL BE DISPOSED OF OUTSIDE THE LIMITS OF THE RIGHT OF WAY ACCORDING TO ARTICLE 202.03 OF THE STANDARD SPECIFICATIONS AND AS DIRECTED BY THE ENGINEER. THIS WORK WILL NOT BE PAID FOR SEPARATELY, BUT WILL BE INCLUDED IN THE COST OF EARTH EXCAVATION.

ANY REFERENCE TO A STANDARD IN THESE PLANS SHALL BE INTERPRETED TO MEAN THE EDITION AS INDICATED BY THE SUBNUMBER SHOWN IN THE LIST OF STANDARDS OR THE COPY INCLUDED IN THESE PLANS.

THE FOLLOWING RATES OF APPLICATION HAVE BEEN USED IN CALCULATING PLAN QUANTITIES:

GRANULAR MATERIALS	2.05	TONS / CU YD
--------------------	------	--------------

THE CONTRACTOR SHALL CONTACT JULIE AT LEAST 48 HOURS PRIOR TO EXCAVATION TO DETERMINE WHICH UTILITIES ARE IN THE AREA.

COMMITMENTS

STATE OF ILLINOIS
DEPARTMENT OF TRANSPORTATION
DISTRICT THREE
AS BUILT INFORMATION

DATE: 5-23-17

SUPERVISING CONSTRUCTION FIELD ENGINEER

RESIDENT ENGINEER / TECHNICIAN

START & END DATES
OF CONSTRUCTION:

INSPECTORS:

PREPARED BY: Don Beaudin
DISTRICT STUDIES & PLANS ENGINEER

EXAMINED BY: John W. [Signature]
DISTRICT CONSTRUCTION ENGINEER

Wesley D. [Signature]
DISTRICT MATERIALS ENGINEER

Jan [Signature]
DISTRICT OPERATIONS ENGINEER

FILE NAME =	USER NAME = petersonec	DESIGNED -- AE	REVISED --	STATE OF ILLINOIS DEPARTMENT OF TRANSPORTATION	GENERAL NOTES	F.A.U. RTE.	SECTION	COUNTY	TOTAL SHEETS	SHEET NO.	
pet\11084EBIDINTEG.illinois.gov\PIWIDT\Documents\DOT Offices\District 3\Projects\0366\B366F9E\Sheet-details.dgn		CHECKED -- EP	REVISED --			5952	(O/C)	GRUNDY	9	2	
PLOT SCALE = 100.0000' / in.		DATE -- 1/24/17	REVISED --			CONTRACT NO. 66F68					
PLOT DATE = 5/23/2017						SCALE:	SHEET 1	OF 1	SHEETS	STA.	TO STA.

CONSTR. CODE
CONT. MAINT.
100% STATE
PIPE CULVERT
0004
URBAN

CODE NO.	ITEM	UNIT	TOTAL QUANTITY	
20400800	FURNISHED EXCAVATION	CU YD	10	10
25000210	SEEDING, CLASS 2A	ACRE	0.1	0.1
25000400	NITROGEN FERTILIZER NUTRIENT	POUND	9	9
25000500	PHOSPHORUS FERTILIZER NUTRIENT	POUND	9	9
25000600	POTASSIUM FERTILIZER NUTRIENT	POUND	9	9
25100630	EROSION CONTROL BLANKET	SQ YD	80	80
28000250	TEMPORARY EROSION CONTROL SEEDING	POUND	25	25
44201067	CLASS B PATCHES, TYPE III, 18 INCH	SQ YD	38	38
44201299	DOWEL BARS 1 1/2"	EACH	24	24
44213100	PAVEMENT FABRIC	SQ YD	24	24
44213200	SAW CUTS	FOOT	102	102
48101200	AGGREGATE SHOULDERS, TYPE B	TON	2	2
50100100	REMOVAL OF EXISTING STRUCTURES	EACH	1	1
542A5485	PIPE CULVERTS, CLASS A, TYPE 1 EQUIVALENT ROUND-SIZE 30"	FOOT	56	56

FILE NAME =	USER NAME = petersonec	DESIGNED - AE	REVISED -	STATE OF ILLINOIS DEPARTMENT OF TRANSPORTATION	SUMMARY OF QUANTITIES	F.A.U. RTE.	SECTION	COUNTY	TOTAL SHEETS	SHEET NO.	
pw\N\1094EBID\NTEG\Illinois.gov\PWIDOT\Documents\1001 Offices\District 3\Projects\0366\BRAWN\0366\Sheet\details.dgn	PLotted\1001 Offices\District 3\Projects\0366\BRAWN\0366\Sheet\details.dgn	CHECKED - EP	REVISED -			5952	IOJC	GRUNDY	9	3	
Default	PLotted\1001 Offices\District 3\Projects\0366\BRAWN\0366\Sheet\details.dgn	DATE - 1/24/17	REVISED -			SCALE: _____ SHEET 1 OF 2 SHEETS STA. _____ TO STA. _____		CONTRACT NO. 66F68			
						ILLINOIS FED. AID PROJECT					

REV

CODE NO.	ITEM	UNIT	TOTAL QUANTITY	CONSTR. CODE
				CONT. MAINT. 100% STATE PIPE CULVERT <i>0004</i> URBAN
54214725	PRECAST REINFORCED CONCRETE FLARED END SECTIONS - ELLIPTICAL, EQUIVALENT ROUND-SIZE 30"	EACH	2	2
59300100	CONTROLLED LOW-STRENGTH MATERIAL	CU YD	22	22
* 66900200	NON-SPECIAL WASTE DISPOSAL	CU YD	50	50
* 66900450	SPECIAL WASTE PLANS AND REPORTS	LSUM	1	1
* 66900530	SOIL DISPOSAL ANALYSIS	EACH	1	1
67100100	MOBILIZATION	LSUM	1	1
70100450	TRAFFIC CONTROL AND PROTECTION, STANDARD 701201	LSUM	1	1
70100455	TRAFFIC CONTROL AND PROTECTION, STANDARD 701206	LSUM	1	1
Z0030850	TEMPORARY INFORMATION SIGNING	SQ FT	42	42

* SPECIALTY ITEMS

REV

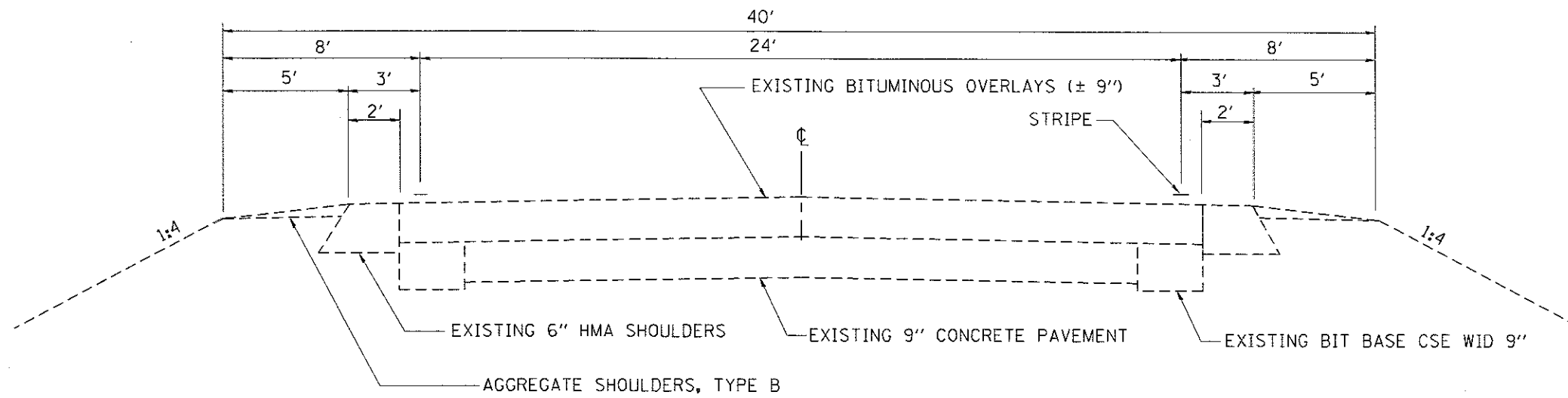

EXISTING TYPICAL SECTION

STA 873+00 TO STA 874+50

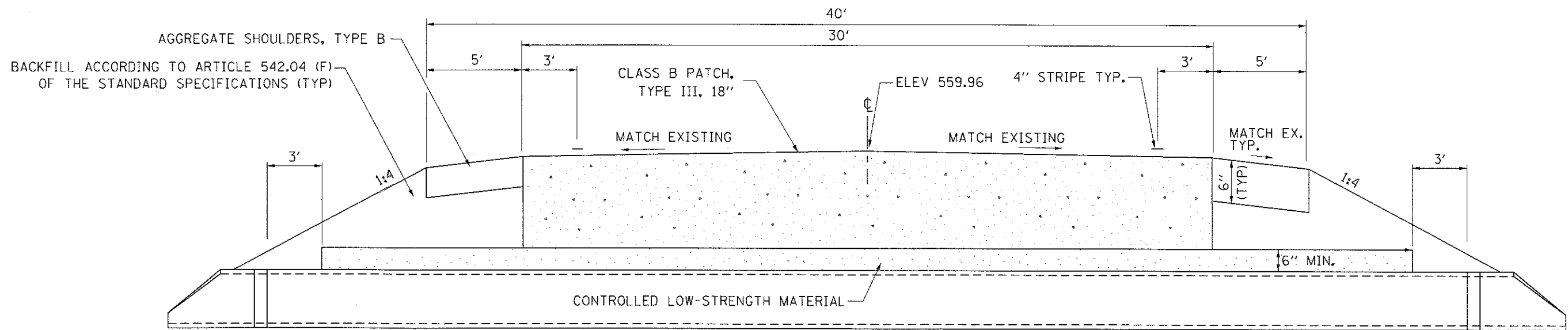

PROPOSED TYPICAL SECTION

STA 873+57

FILE NAME =	USER NAME = petersonec	DESIGNED - AE	REVISED -	STATE OF ILLINOIS DEPARTMENT OF TRANSPORTATION	TYPICAL SECTION		F.A.U. RTE.	SECTION	COUNTY	TOTAL SHEETS	SHEET NO.
Documents\DOT Offices\District 3\Projects\0368\BRAND\Date\83685\Sheet-details.dgn	CHECKED - EP	REVISED -	5952				IOIC	GRUNDY	9	5	
PLOT SCALE = 100.0000 / in.	DATE - 1/24/17	REVISED -	SCALE: _____ SHEET 1 OF 1 SHEETS STA. _____ TO STA. _____		CONTRACT NO. 66F68		ILLINOIS FED. AID PROJECT				
Default	PLOT DATE = 5/25/2017	REVISED -									

DRAINAGE SCHEDULE				
LOCATION	REMOVE EXISTING STRUCTURE	CONTROLLED LOW STRENGTH MATERIAL	PIPE CULVERTS CL A, TY 1 ELLIPTICAL EQRS 30"	PRC FLARED END SECTION ELLIPTICAL, EQRS 30"
STATION	EACH	CU YD	FOOT	EACH
873+50	1	22	56	2
TOTAL	1	22	56	2

PATCHING SCHEDULE				
LOCATION	CLASS B PATCH TYPE III 17"	SAW CUTS	DOWEL BARS	PATCHING REINFORCEMENT
STATION	SQ YD	FT	EACH	SQ YD
873+50	38	102	24	38
TOTAL	38	102	24	38

SEEDING SCHEDULE						
LOCATION	FURNISHED EXCAVATION	SEEDING CLASS 2A	NITROGEN FERTILIZER NUTRIENT	PHOSPHORUS FERTILIZER NUTRIENT	POTASSIUM FERTILIZER NUTRIENT	EROSION CONTROL BLANKET
STATION	CU YD	ACRES	LBS	LBS	LBS	SQ YD
873+50	10	0.1	9	9	9	80
TOTAL	10	0.1	9	9	9	80

AGGREGATE SCHEDULE	
LOCATION	AGGREGATE SHOULDERS TYPE B
STATION	TONS
873+50	2
TOTAL	2

BM ELEV = 572.95
 60D NAIL IN PP 53' LT STA 877+61.5
 TEMP BM AT&T HANDHOLE ABOUT 73+00 LT

- NOTES:
- EXISTING 3'x2' BOX HAS CMP EXTENSIONS AND METAL END SECTIONS. THE REMOVAL OF THE CMP EXTENSIONS AND END SECTIONS SHALL BE INCLUDED IN THE COST OF REMOVE EXISTING STRUCTURE.
 - ANY EXCAVATION REQUIRED TO REMOVE THE EXISTING STRUCTURE SHALL BE INCLUDED IN THE COST OF REMOVE EXISTING STRUCTURE.
 - WORK WILL BE COMPLETED WITH 24 HOUR FLAGGING AS TRAFFIC CONTROL. ALL NON-EMERGENCY WORK WILL BE COMPLETED DURING DAYLIGHT HOURS.

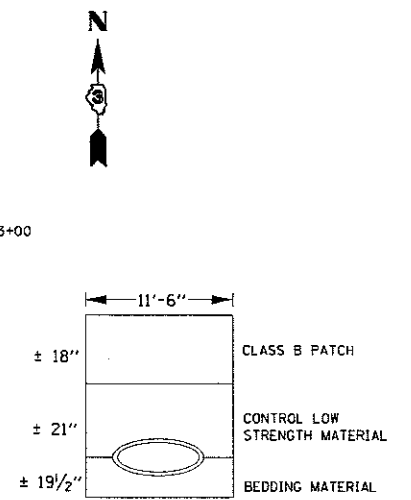
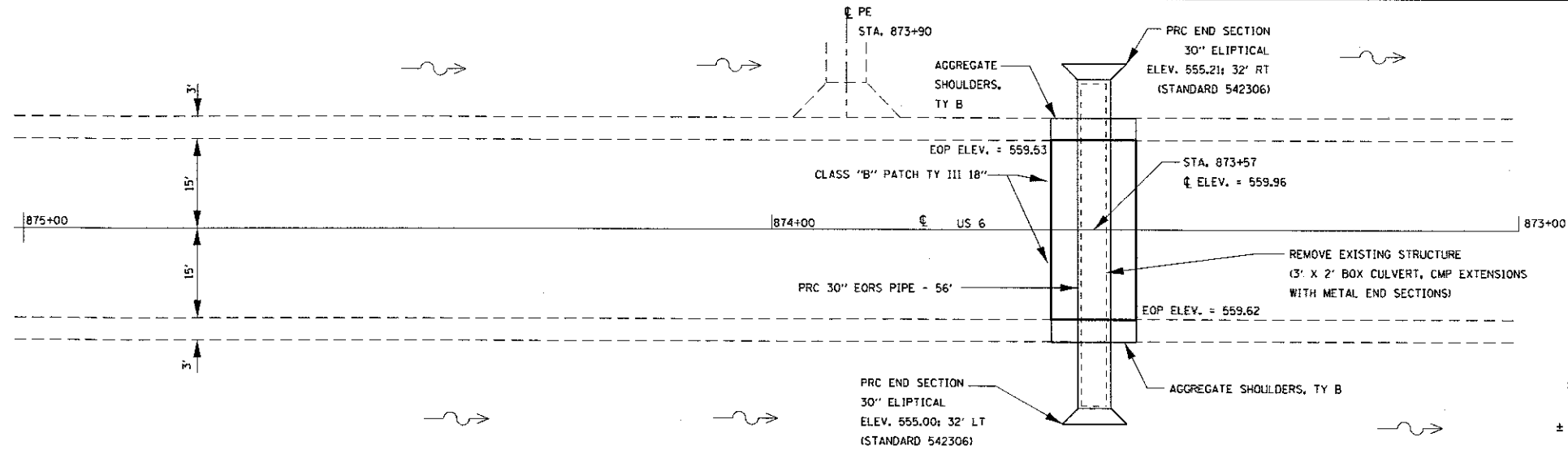

DATE	
BY	
PROFILE	
SURVEYED	
CONFORMS	
UPDATES CHECKED	
REVISIONS CHECKED	
NOTE BOOK	
NO.	
STRUCTURE	
STATISTCS	
CRFD	

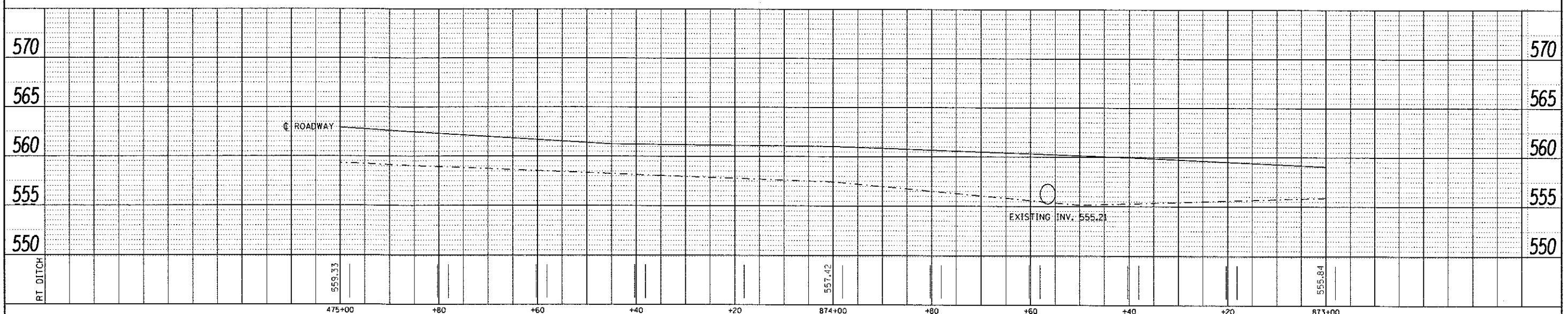
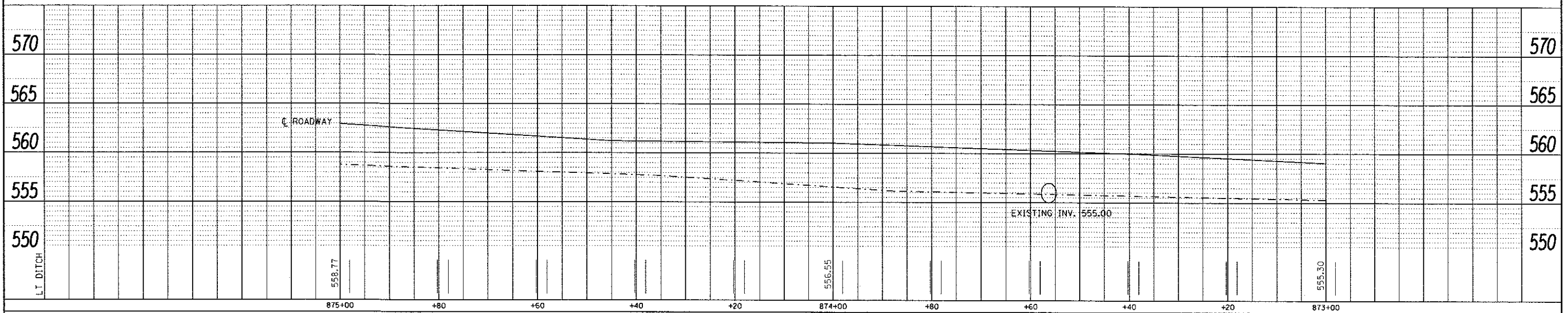

FILE NAME =	USER NAME = petersonec	DESIGNED - ECP	REVISIONS -	STATE OF ILLINOIS DEPARTMENT OF TRANSPORTATION	PLAN AND PROFILE STA. 875+00 TO STA. 873+00	F.A.U. RTE. 5952	SECTION IOIC	COUNTY GRUNDY	TOTAL SHEETS 9	SHEET NO. 7
PLOT SCALE = 1/8" = 1' in.	CHECKED - RLW	DATE - 4/18/17	REVISIONS -			CONTRACT NO. 66F68				
PLOT DATE = 5/25/2017						ILLINOIS FED. AID PROJECT				

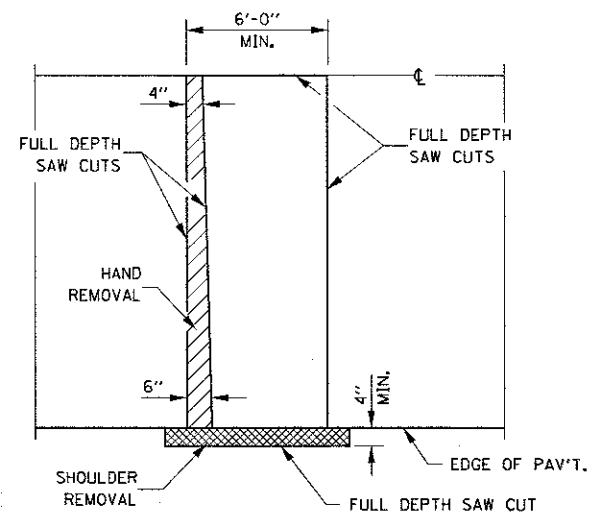

PAVEMENT SAWING DETAIL
(HMA SHOULDER)

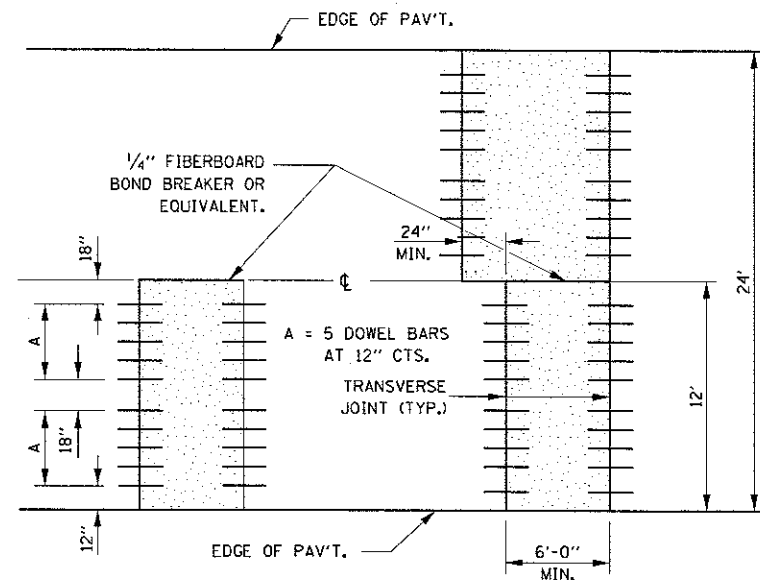

12' WIDE LANES

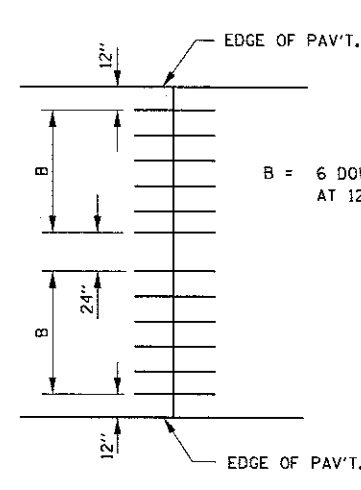

14' WIDE RAMP

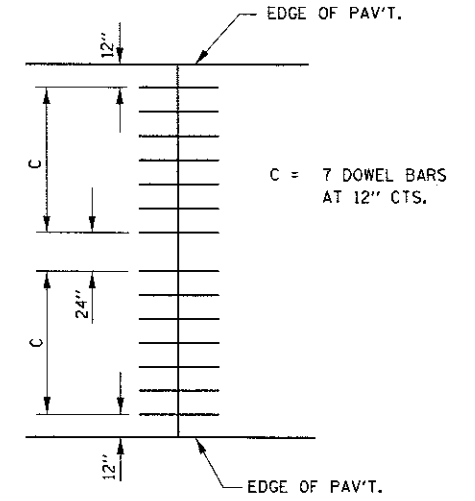

16' WIDE RAMP

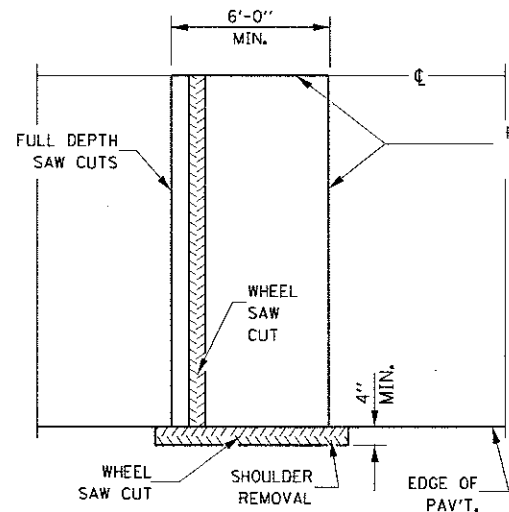

ALTERNATE SAWING DETAIL
(HMA SHOULDER)

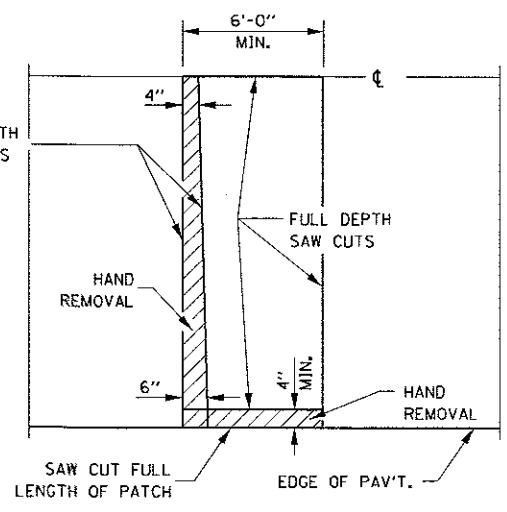

PAVEMENT SAWING DETAIL
(PCC SHOULDER)

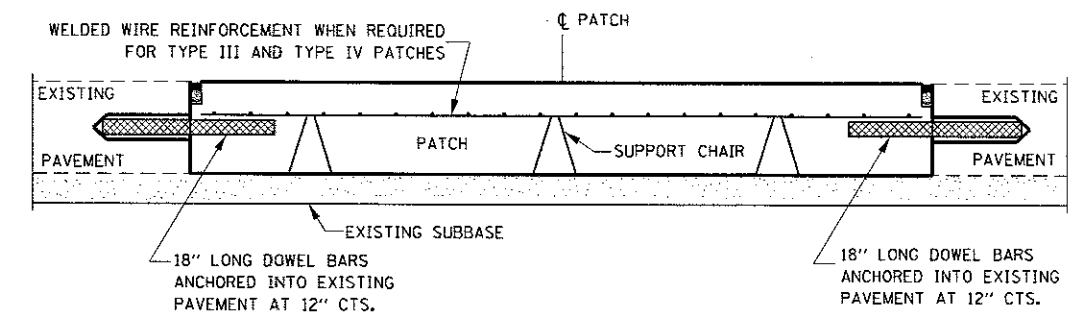

PATCHING WITHOUT HMA OVERLAY

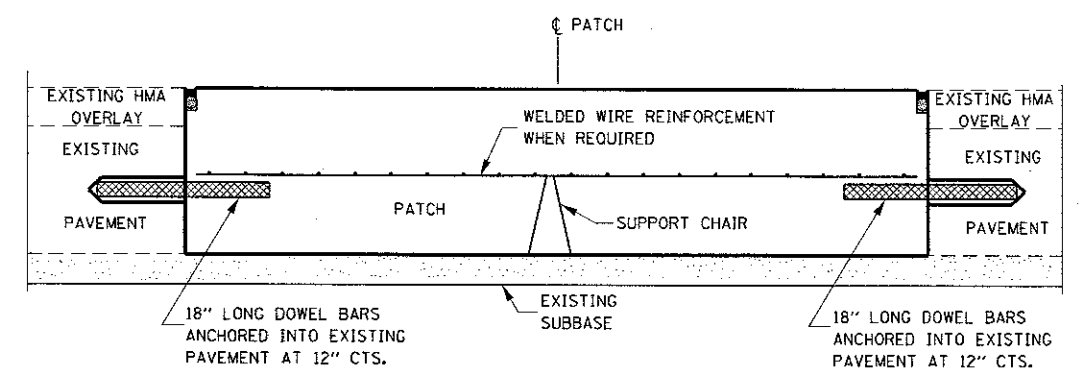

PATCHING WITH HMA OVERLAY

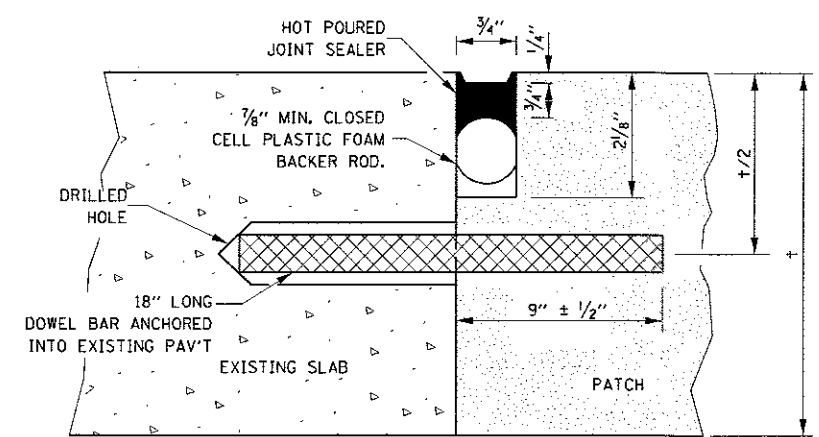

TRANSVERSE JOINT

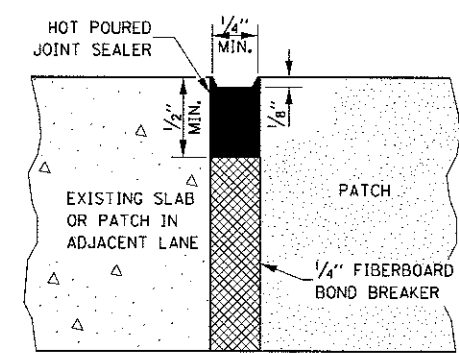

CENTERLINE JOINT

DOWEL BAR TABLE		
PAVEMENT THICKNESS	DOWEL BAR DIAMETER	HOLE DIAMETER
8" OR GREATER	1 1/2"	1 3/8"
7" THRU 7.99"	1 1/4"	1 3/8"
LESS THAN 7"	1"	1 1/8"

GENERAL NOTES

THE TRANSVERSE JOINTS FOR CLASS B PATCHES SHALL ALIGN WITH JOINTS OR CRACKS IN THE ADJACENT LANE WHENEVER POSSIBLE.
SEE STANDARD 420701 FOR DETAILS OF PAVEMENT WELDED WIRE REINFORCEMENT.

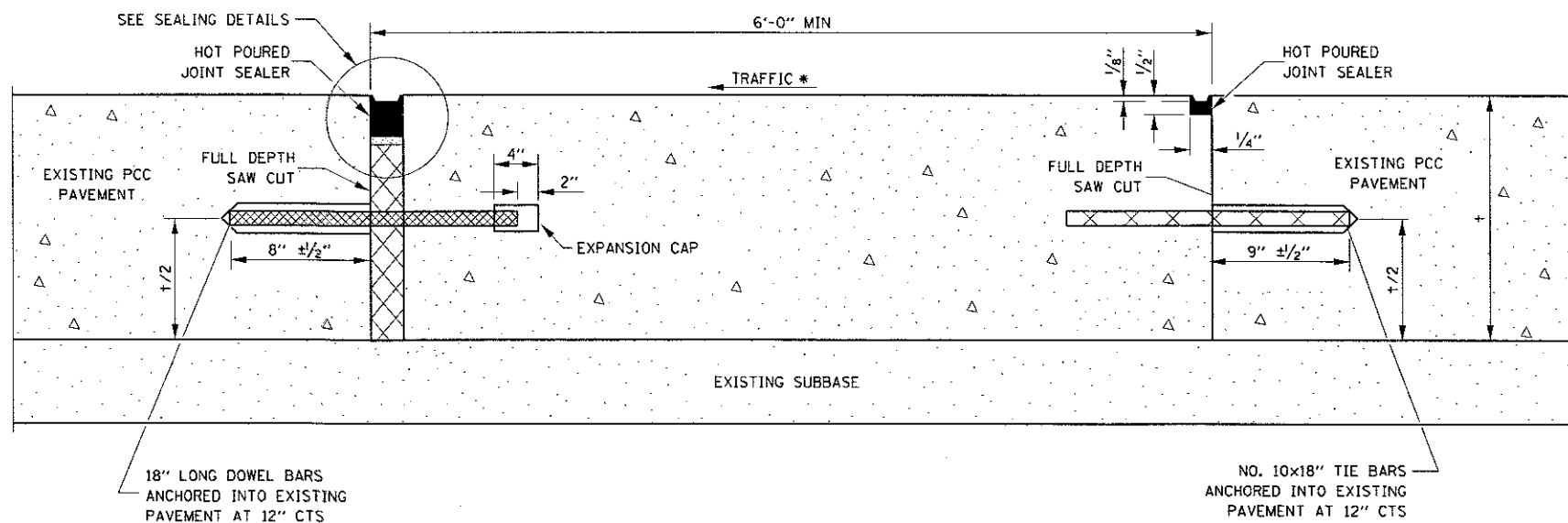

METHOD I
(WITHOUT HMA OVERLAY)

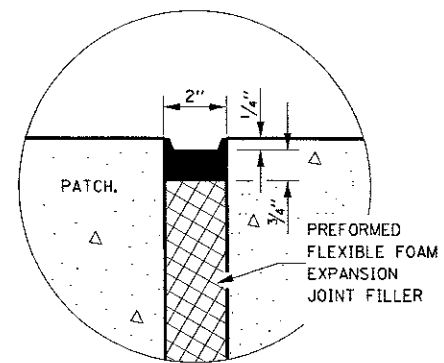

SEALING DETAIL

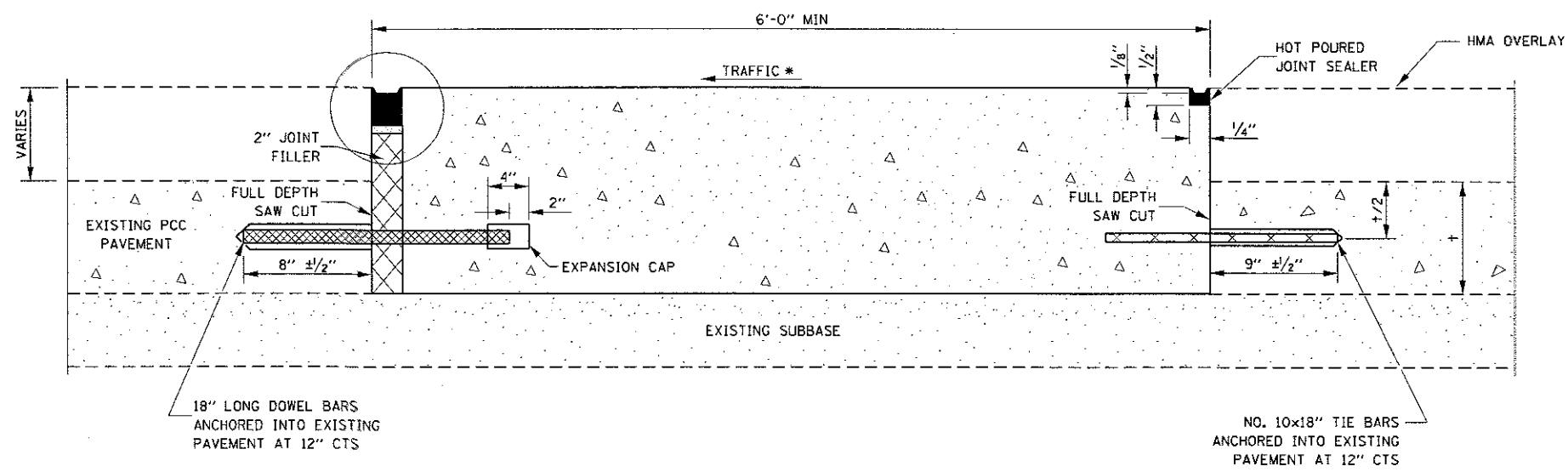

METHOD II
(WITH HMA OVERLAY)

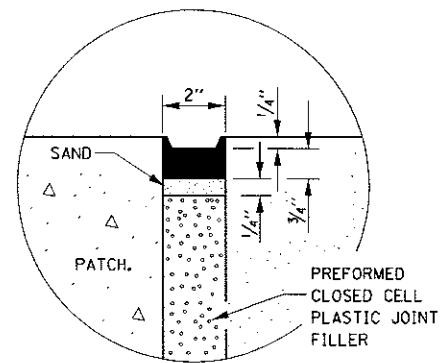

SEALING DETAIL

NOTE

* WHEN RE-ESTABLISHING A TRANSVERSE EXPANSION JOINT ON A TWO-WAY ROAD, REVERSE THE ORIENTATION OF THE DOWEL BARS WITH RESPECT TO TRAFFIC FOR ONE OF THE PATCHES SUCH THAT THE JOINT WILL BE CONTINUOUS ACROSS BOTH LANES.

FILE NAME =	USER NAME = petersonec	DESIGNED -	REVISED -	STATE OF ILLINOIS DEPARTMENT OF TRANSPORTATION	CLASS B PATCHING DETAILS	F.A.U. RTE.	SECTION	COUNTY	TOTAL SHEETS	SHEET NO.
pw\11084EBIDINTEG\Illinois.gov\PWIDOT\Documents\DOT Offices\District 3\Projects\ND364\Drawings\B366F88-ght-details.dgn	DRWN	REVISED	REVISED			5952	IQIC	GRUNDY	25	9
PLOT SCALE = 1/8" = 1' / in.	CHECKED -	REVISED -	REVISED -			CONTRACT NO. 66F68				
PLOT DATE = 5/25/2017	DATE -	REVISED -	REVISED -			FED. ROAD DIST. NO. ILLINOIS FED. AID PROJECT				
SCALE: _____ SHEET NO. 2 OF 2 SHEETS STA. _____ TO STA. _____										